

F.A.P. RTE.	SECTION	COUNTY	TOTAL SHEETS	SHEET NO.
808		DOUGLAS	42	1

(12,Y-15D)10RS-2

D-95-069-02

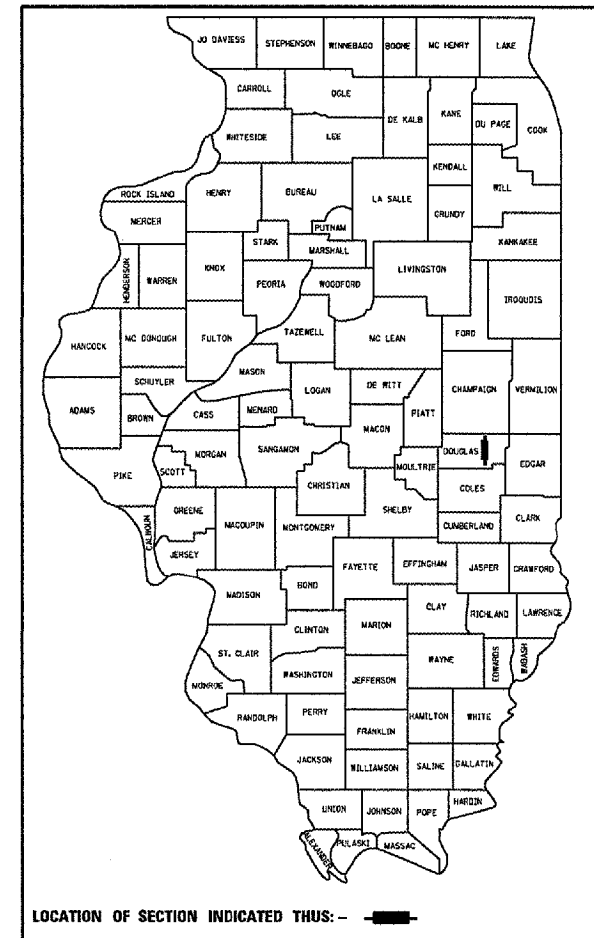

STATE OF ILLINOIS  
DEPARTMENT OF TRANSPORTATION  
DIVISION OF HIGHWAYS

# PROPOSED HIGHWAY PLANS

F.A.P. ROUTE 808 (IL ROUTE 130)  
SECTION (12,Y-15D)10RS-2  
PROJECT ACF-0808(035)  
DOUGLAS COUNTY

C-95-117-02  
RESURFACING (3P) FROM NCL OF VILLA GROVE TO U.S. ROUTE 36

FOR INDEX OF SHEETS, SEE SHEET NO. 2  
FOR SUMMARY OF QUANTITIES, SEE SHEET NO. 4-5

PROJECT ENGINEER: KEVIN TRAPP (217)465-4181  
SQUAD LEADER: CHRIS GREESON  
DESIGNER: GREG EAGLIN

CURRENT ADT	
U. S. 36 TO NCL CAMARGO	= 2,650 (2006)
NCL CAMARGO TO SCL VILLA GROVE	= 3,400 (2006)
SCL VILLA GROVE TO F. A. S. 522	= 4,550 (2006)
F. A. S. 522 TO NCL VILLA GROVE	= 5,400 (2006)

**DESIGN DESIGNATION**  
N/A

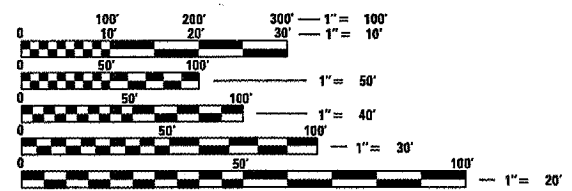

FULL SIZE PLANS HAVE BEEN PREPARED USING STANDARD ENGINEERING SCALES. REDUCED SIZED PLANS WILL NOT CONFORM TO STANDARD SCALES. IN MAKING MEASUREMENTS ON REDUCED PLANS, THE ABOVE SCALES MAY BE USED.

J.U.L.I.E.  
JOINT UTILITY LOCATION INFORMATION FOR EXCAVATION  
1-800-892-0123

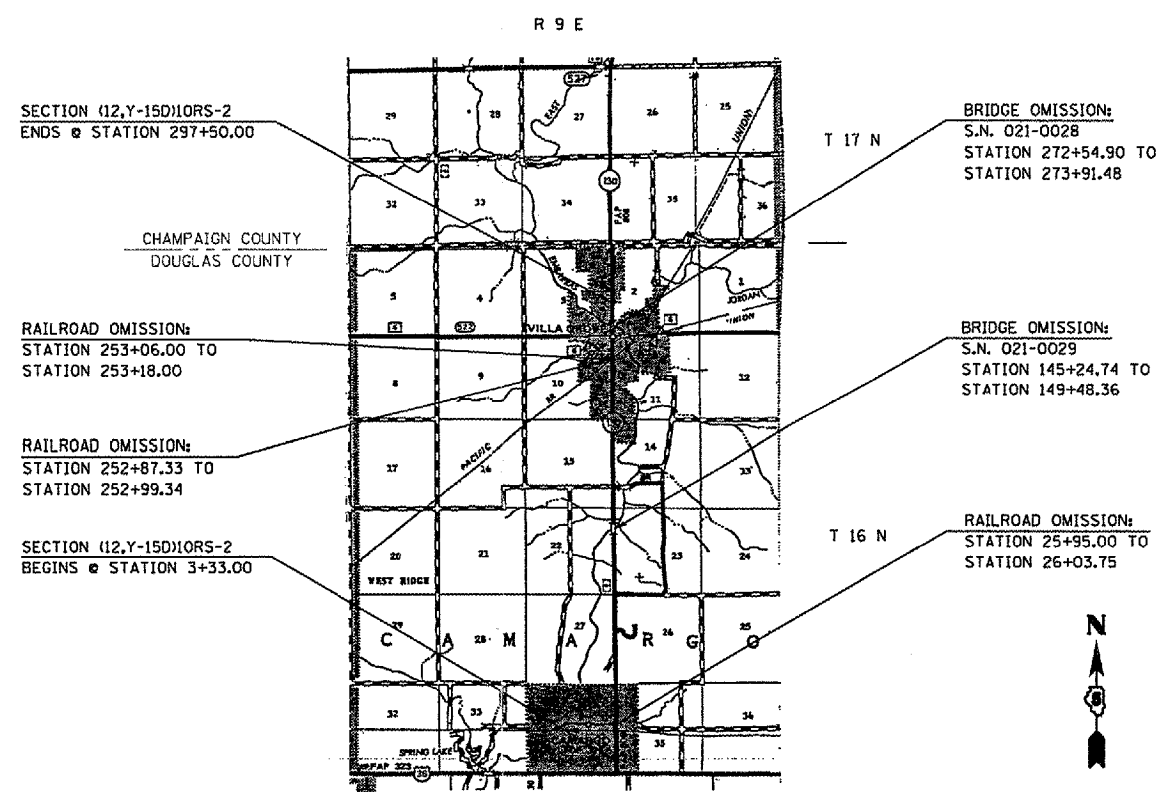

TOTAL LENGTH OF SECTION & PROJECT = 29,417.00 FEET = 5.571 MILES  
NET LENGTH OF SECTION & PROJECT = 28,824.04 FEET = 5.459 MILES

STATE OF ILLINOIS  
DEPARTMENT OF TRANSPORTATION  
DIVISION OF HIGHWAYS

SUBMITTED 10/19/07  
*Don E. Gougeon*  
 DEPUTY DIRECTOR OF HIGHWAYS, REGION ENGINEER  
 Dec 7, 20 07  
*Eric E. Harn*  
 ENGINEER OF DESIGN AND ENVIRONMENT  
 Dec 7, 20 07  
*Christine M. Reed*  
 DIRECTOR OF HIGHWAYS, CHIEF ENGINEER

**PRINTED BY THE AUTHORITY  
OF THE STATE OF ILLINOIS**

PLOT DATE = 10/16/2007  
FILE NAME = c:\nrc\projects\70275\text\dgn  
PLOT SCALE = 43.19517 IN.  
USER NAME = callanrbv

CONTRACT NO. 70275