

F.A.P. 323 (U.S. 36) & U.S. 150 / IL. 1 LIGHTING MODERNIZATION PLAN SHEET

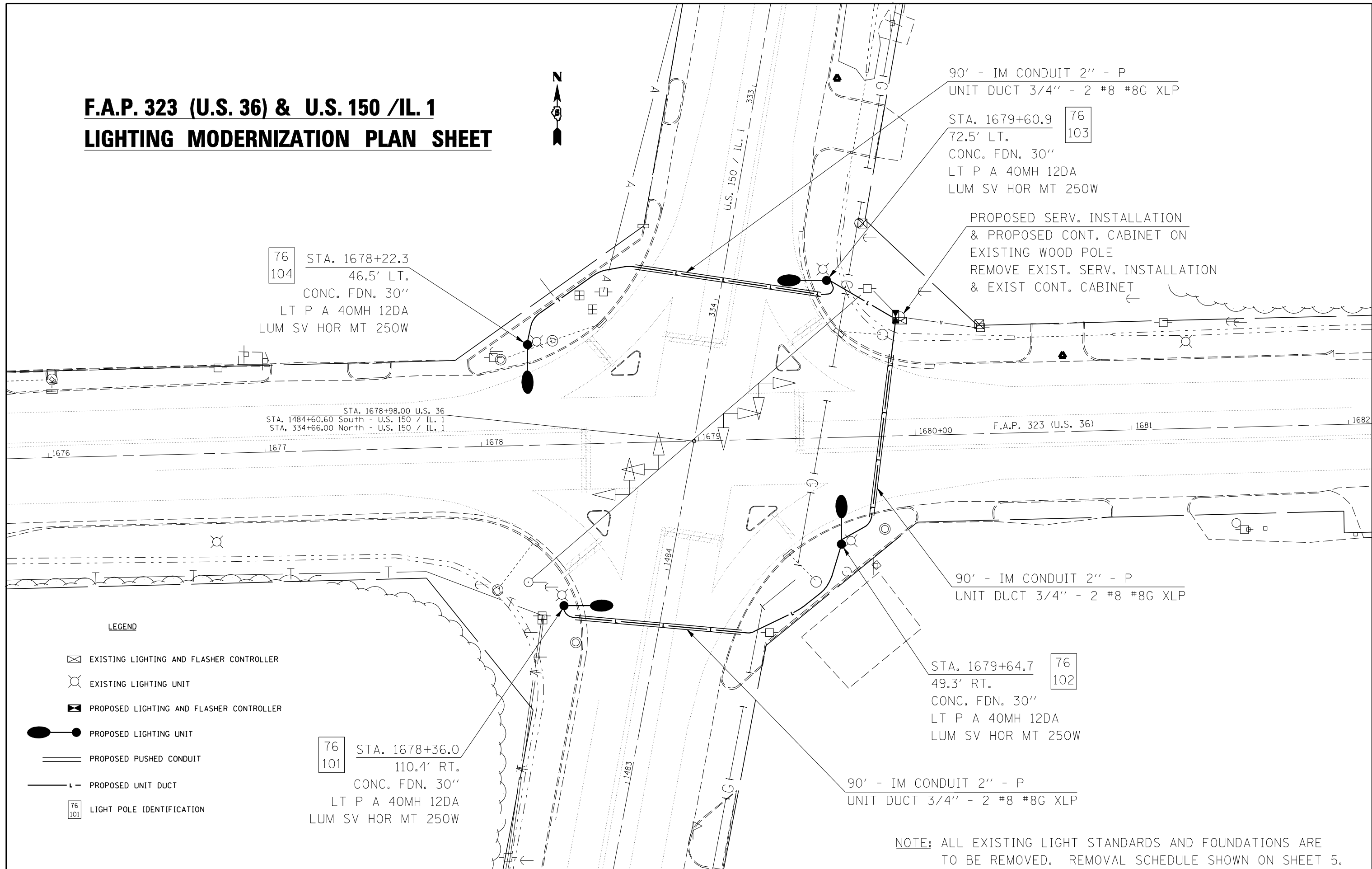

NOTE: ALL EXISTING LIGHT STANDARDS AND FOUNDATIONS ARE TO BE REMOVED. REMOVAL SCHEDULE SHOWN ON SHEET 5.

FILE NAME = c:\projects\d502807 (v8)\4735\plan.dgn	USER NAME = collierbw	DESIGNED - ---	REVISED - ---	STATE OF ILLINOIS DEPARTMENT OF TRANSPORTATION	PLAN SHEET		F.A.P. RTE. 323	SECTION 149L	COUNTY EDGAR	TOTAL SHEETS 9	SHEET NO. 4
	PLOT SCALE = 40.0000' / IN.	CHECKED - ---	REVISED - ---		SCALE: -----	SHEET NO. -- OF -- SHEETS	STA. ----- TO STA. -----	CONTRACT NO. 10656			
PLOT DATE = 11/5/2007	DATE - -----	REVISED - ---	REVISED - ---	FED. ROAD DIST. NO. - ILLINOIS FED. AID PROJECT							