

F.A. RTE.	SECTION	COUNTY	TOTAL SHEETS	SHEET NO.
VAR.	*	**	35	3

\* D5 CRACK & JOINT SEAL 2008-1  
 \*\* DEWITT/PIATT/MCLEAN

# LOCATION #1 - FAP 721 (IL 10) FROM IL 48 TO PIATT COUNTY LINE (RURAL 2-LANE)

## DEWITT COUNTY

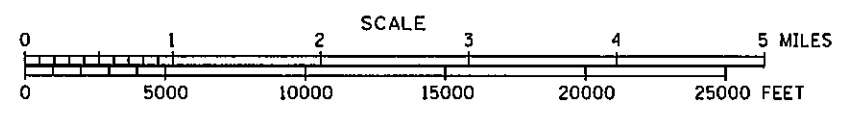
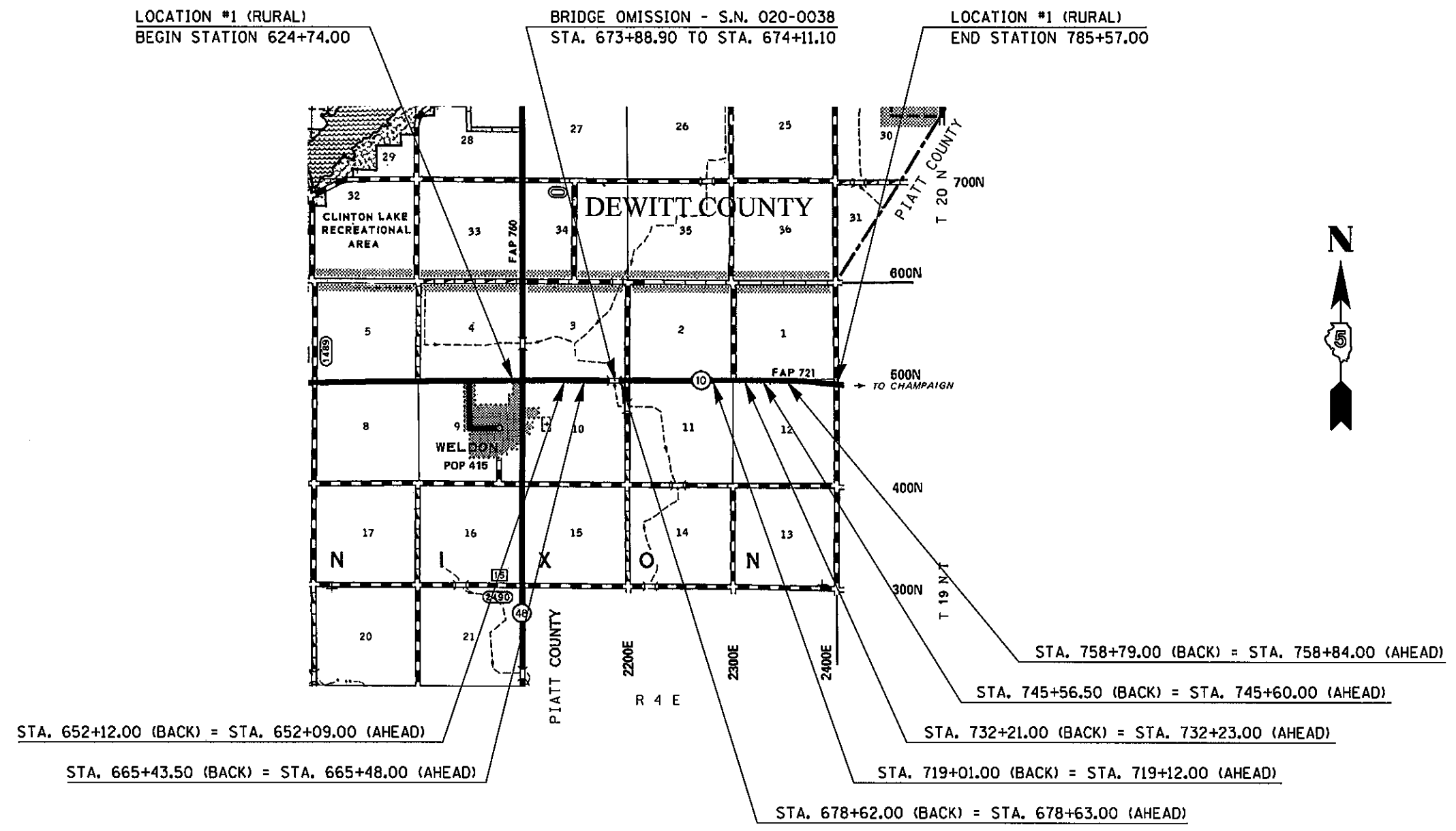

**TOTAL LENGTH OF LOCATION #1 = 16,059.00 FEET = 3.041 MILES**  
**NET LENGTH OF LOCATION #1 = 16,036.80 FEET = 3.037 MILES**

ILLINOIS DEPARTMENT OF TRANSPORTATION  
**LOCATION MAP**  
**LOCATION #1**  
 ROUTE VARIOUS  
 SECTION D5 CRACK & JOINT SEAL 2008-1  
 DEWITT, PIATT & MCLEAN COUNTIES  
 SCALE: N/A  
 DATE: 08/23/07  
 DRAWN BY: JRP  
 CHECKED BY:

PLOT DATE = 08/23/07  
 FILE NAME = C:\Users\jrp\Documents\70658\Map\70658Map.dgn  
 PLOT SCALE = 43.1931 / IN.  
 USER NAME = collinrb