

F.A. RTE.	SECTION	COUNTY	TOTAL SHEETS	SHEET NO.
VAR.	*	**	35	4

\* D5 CRACK & JOINT SEAL 2008-1  
 \*\* DEWITT/PIATT/MCLEAN

# LOCATION #2 – FAP 721 (IL 10) FROM DEWITT COUNTY LINE TO I-72 (RURAL 2-LANE)

## PIATT COUNTY

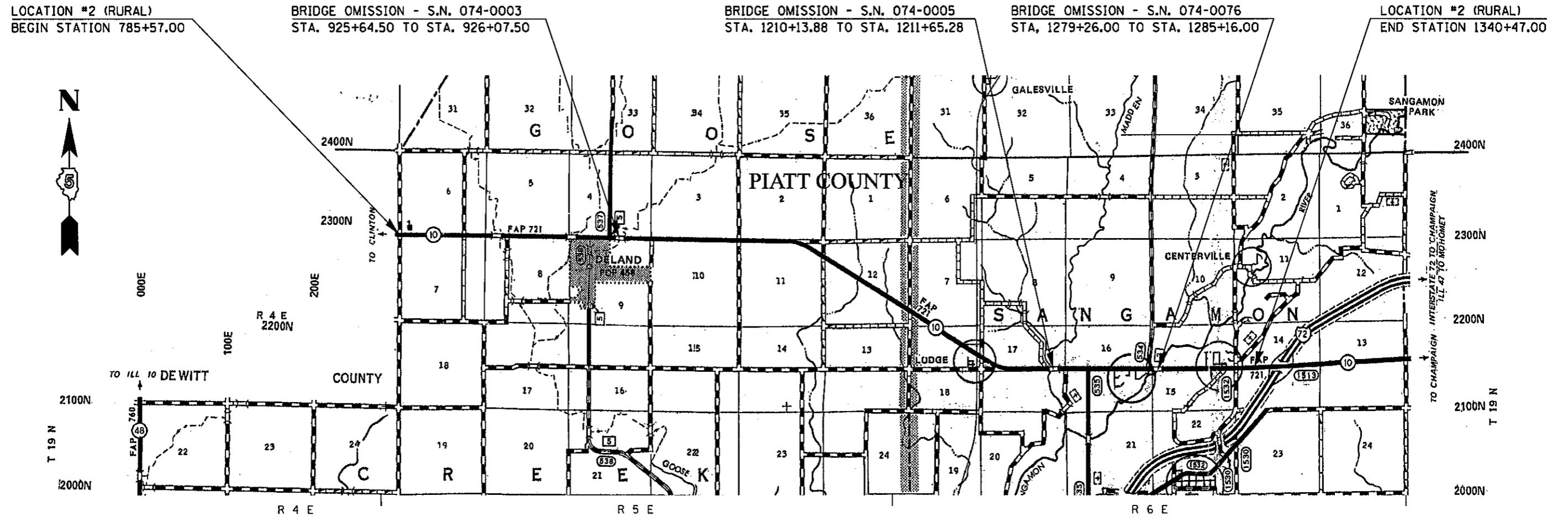

LOCATION #2 (RURAL)  
 BEGIN STATION 785+57.00

BRIDGE OMISSION - S.N. 074-0003  
 STA. 925+64.50 TO STA. 926+07.50

BRIDGE OMISSION - S.N. 074-0005  
 STA. 1210+13.88 TO STA. 1211+65.28

BRIDGE OMISSION - S.N. 074-0076  
 STA. 1279+26.00 TO STA. 1285+16.00

LOCATION #2 (RURAL)  
 END STATION 1340+47.00

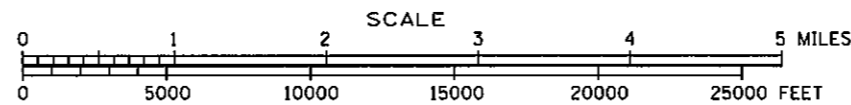

**STATION EQUATIONS:**

STA. 825+83.00 (BACK) = STA. 825+88.00 (AHEAD)  
 STA. 840+94.70 (BACK) = STA. 841+02.94 (AHEAD)  
 STA. 878+94.00 (BACK) = STA. 879+01.00 (AHEAD)  
 STA. 883+90.80 (BACK) = STA. 884+00.33 (AHEAD)  
 STA. 915+83.60 (BACK) = STA. 915+84.09 (AHEAD)  
 STA. 944+90.50 (BACK) = STA. 944+92.50 (AHEAD)  
 STA. 984+96.00 (BACK) = STA. 985+00.00 (AHEAD)  
 STA. 1024+75.00 (BACK) = STA. 1024+77.00 (AHEAD)

**STATION EQUATIONS:**

STA. 1053+90.50 (BACK) = STA. 1053+85.00 (AHEAD)  
 STA. 1085+00.00 (BACK) = STA. 1085+02.50 (AHEAD)  
 STA. 1116+22.50 (BACK) = STA. 1116+24.00 (AHEAD)  
 STA. 1142+55.50 (BACK) = STA. 1142+49.00 (AHEAD)  
 STA. 1199+97.00 (BACK) = STA. 1199+97.53 (AHEAD)  
 STA. 1273+75.50 (BACK) = STA. 1273+78.50 (AHEAD)  
 STA. 1312+04.50 (BACK) = STA. 1312+04.00 (AHEAD)  
 STA. 1330+19.00 (BACK) = STA. 1330+22.00 (AHEAD)

**RESURFACING OMISSION:**

STA. 1155+87.00 TO STA. 1177+02.00

**TOTAL LENGTH OF LOCATION #2 = 55,453.71 FEET = 10.503 MILES**  
**NET LENGTH OF LOCATION #2 = 52,554.31 FEET = 9.953 MILES**

ILLINOIS DEPARTMENT OF TRANSPORTATION  
**LOCATION MAP**  
**LOCATION #2**  
 ROUTE VARIOUS  
 SECTION D5 CRACK & JOINT SEAL 2008-1  
 DEWITT, PIATT & MCLEAN COUNTIES  
 SCALE: N/A  
 DATE: 08/23/07  
 DRAWN BY: JRP  
 CHECKED BY: