

F.A. RTE.	SECTION	COUNTY	TOTAL SHEETS	SHEET NO.
VAR.	*	**	35	6

\* D5 CRACK & JOINT SEAL 2008-1  
 \*\* DEWITT/PIATT/MCLEAN

**LOCATION #4 – FAP 693 (IL 9) FROM E. OF TOWANDA / BARNES RD TO E. OF IL 165**  
**(RURAL 2-LANE)**  
**MCLEAN COUNTY**

LOCATION #4 (RURAL)  
 BEGIN STATION 216+75.00

LOCATION #4 (RURAL)  
 END STATION 438+30.00

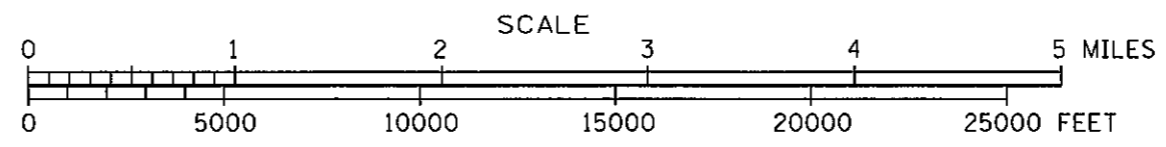
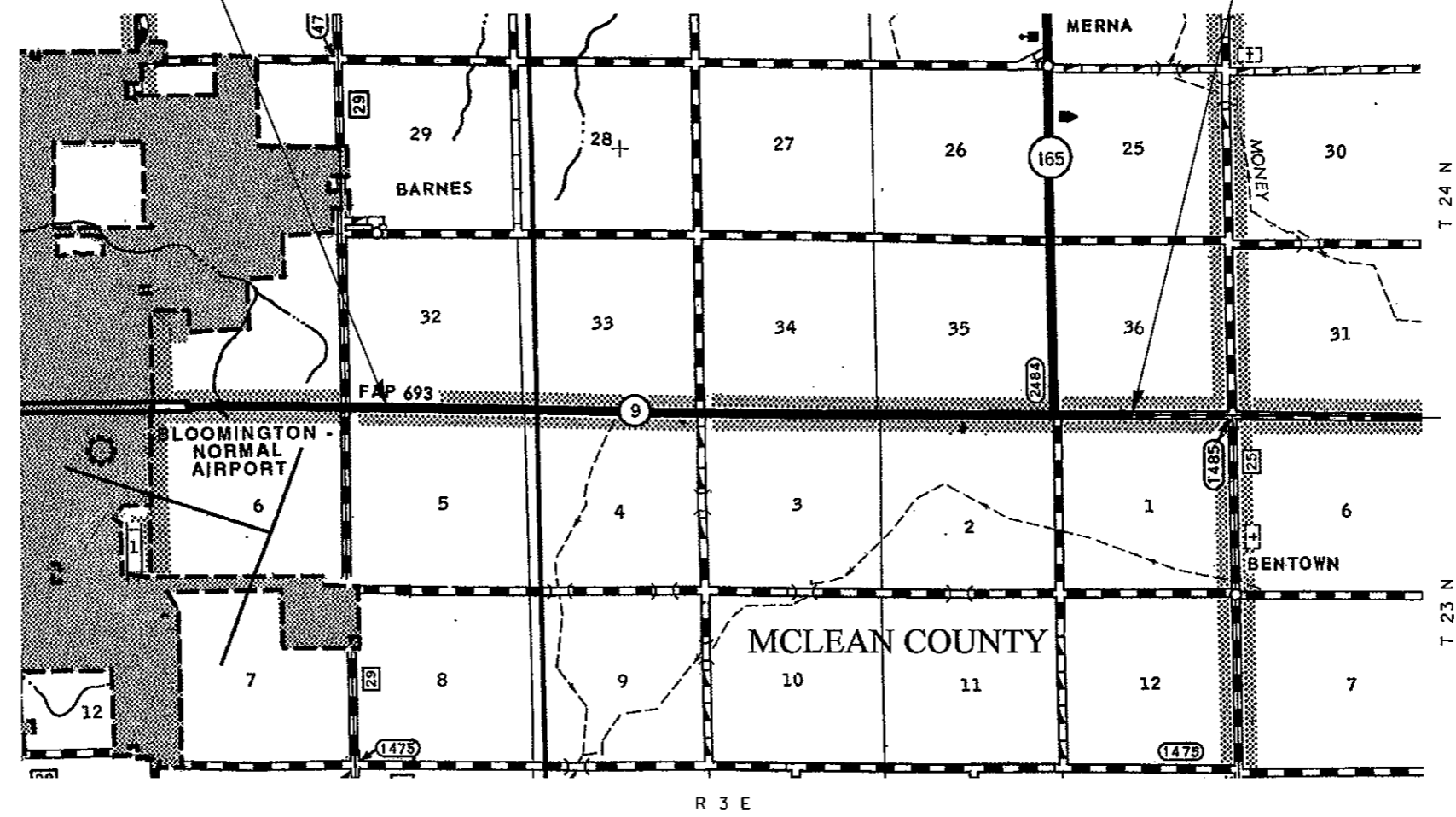

**TOTAL & NET LENGTH OF LOCATION #4 = 22,155.00 FEET = 4.196 MILES**

PLOT DATE = 9/21/2007  
 PLOT SCALE = 43.1875' / IN.  
 USER NAME = collinb

ILLINOIS DEPARTMENT OF TRANSPORTATION  
**LOCATION MAP**  
**LOCATION #4**  
 ROUTE VARIOUS  
 SECTION D5 CRACK & JOINT SEAL 2008-1  
 DEWITT, PIATT & MCLEAN COUNTIES  
 SCALE: N/A DRAWN BY: JRP  
 DATE: 08/23/07 CHECKED BY: