

F.A.I. RTE.	SECTION	COUNTY	TOTAL SHEETS	SHEET NO.
*	**	SANGAMON	248	80

STA. TO STA.
 FED. ROAD DIST. NO. ILLINOIS FED. AID PROJECT
 * FA155(I-55), FA172(I-72), FAP666(I-55 BUS)
 ** D6 INTERSTATE RS,BR,M CAB 2008

SECTION 13, T15N, R5W, 3rd PM

EXIST. CURVE 1154
 PI STA. = 154+92.02
 $\Delta = 23^\circ 26' 35''$ (LT)
 $D = 1^\circ 59' 59''$
 $R = 2,865.16'$
 $T = 594.47'$
 $L = 1,172.31'$
 $E = 61.02'$
 $\theta = \text{-----}$
 P.C. STA. = 148+97.55
 P.T. STA. = 160+69.85

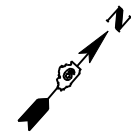

(27) GUARDRAIL REMOVAL
 REM AND RE-ERECT RAIL ELEMENT OF EX GR STEEL PLATE BEAM GUARDRAIL, TYPE A TBT TYPE TYPE 1, SPECIAL (TANGENT) TRAFFIC BARRIER TERMINAL, TYPE 2 TERMINAL MARKER - DIRECT APPLIED GUARDRAIL MARKERS, TYPE A

(6) GUARDRAIL REMOVAL
 REM AND RE-ERECT RAIL ELEMENT OF EX GR STEEL PLATE BEAM GUARDRAIL, TYPE A GUARDRAIL MARKERS, TYPE A

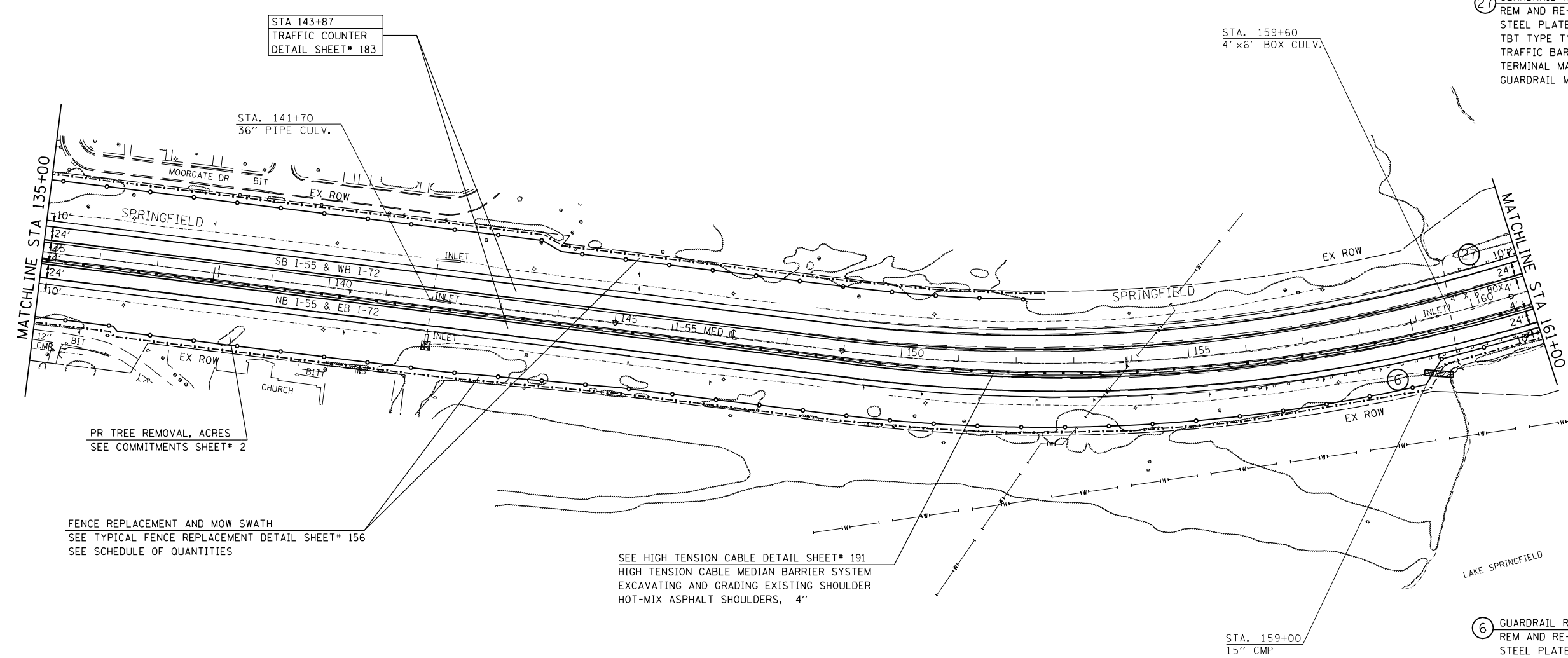

PR TREE REMOVAL, ACRES
 SEE COMMITMENTS SHEET# 2

FENCE REPLACEMENT AND MOW SWATH
 SEE TYPICAL FENCE REPLACEMENT DETAIL SHEET# 156
 SEE SCHEDULE OF QUANTITIES

SEE HIGH TENSION CABLE DETAIL SHEET# 191
 HIGH TENSION CABLE MEDIAN BARRIER SYSTEM
 EXCAVATING AND GRADING EXISTING SHOULDER
 HOT-MIX ASPHALT SHOULDERS, 4"

LEGEND

- GUARDRAIL SECTION - SEE SCHEDULES
- MOWING SWATH EDGE
- TREE REMOVAL LIMIT
- TRANSITION LOCATIONS
SEE DETAIL SHEETS# 151-155
- VERTICAL CLEARANCE
SEE DETAIL SHEET#157

REVISIONS	
NAME	DATE

ILLINOIS DEPARTMENT OF TRANSPORTATION

PLAN SHEET

FA155(I-55), FA172(I-72), FAP666(I-55 BUS)
 SECTION D6 INTERSTATE RS,BR,M CAB 2008
 SANGAMON COUNTY

SCALE: 1" = 100'
 DATE

DRAWN BY TEC
 CHECKED BY

PLOT DATE = Oct-22-2007 08:28:13AM
 FILE NAME = c:\p\projects\4652882\plan.dgn
 PLOT SCALE = 211.7647 / IN.
 USER NAME = laughlin-1