

F.A.I. RTE.	SECTION	COUNTY	TOTAL SHEETS	SHEET NO.
*	**	SANGAMON	248	91
STA.		TO STA.		
FED. ROAD DIST. NO.		ILLINOIS FED. AID PROJECT		
* FA155(I-55), FA172(I-72), FAP666(I-55 BUS)				
** D6 INTERSTATE RS,BR,M CAB 2008				

SECTION 25, T16N, R5W, 3rd PM

SECTION 30, T16N, R4W, 3rd PM

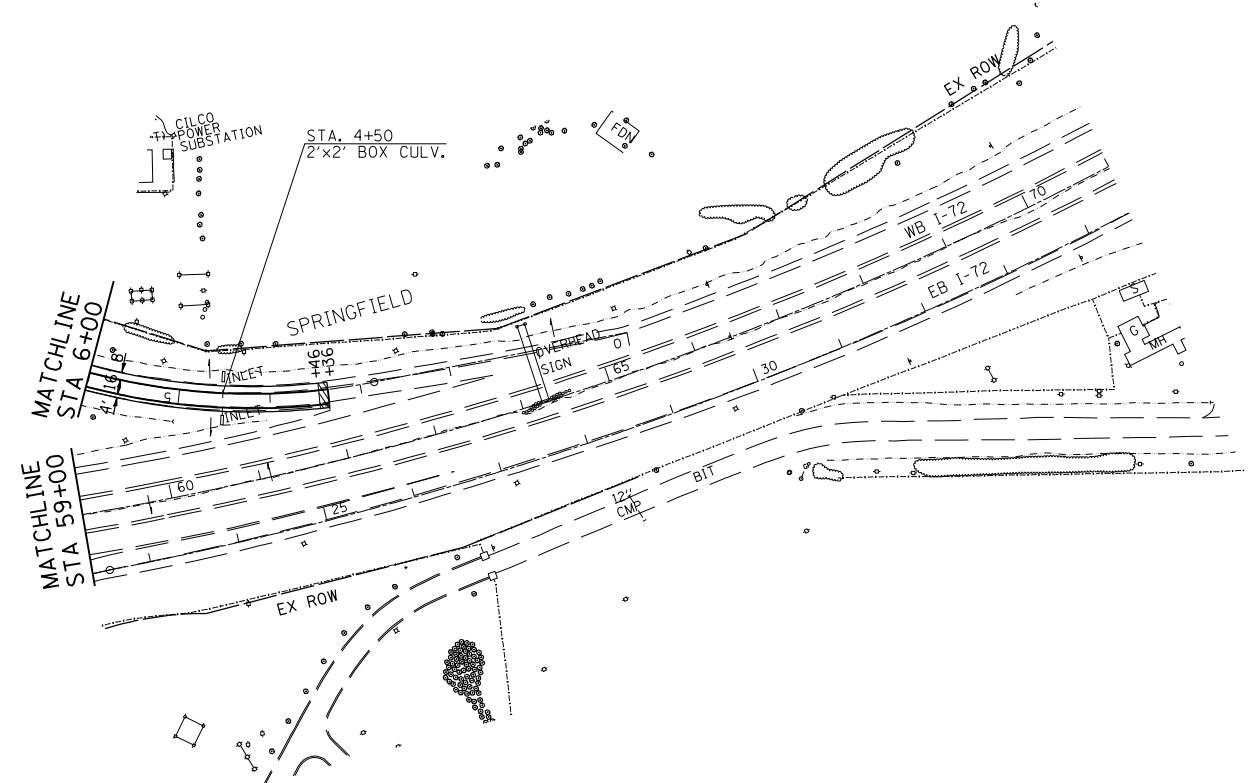
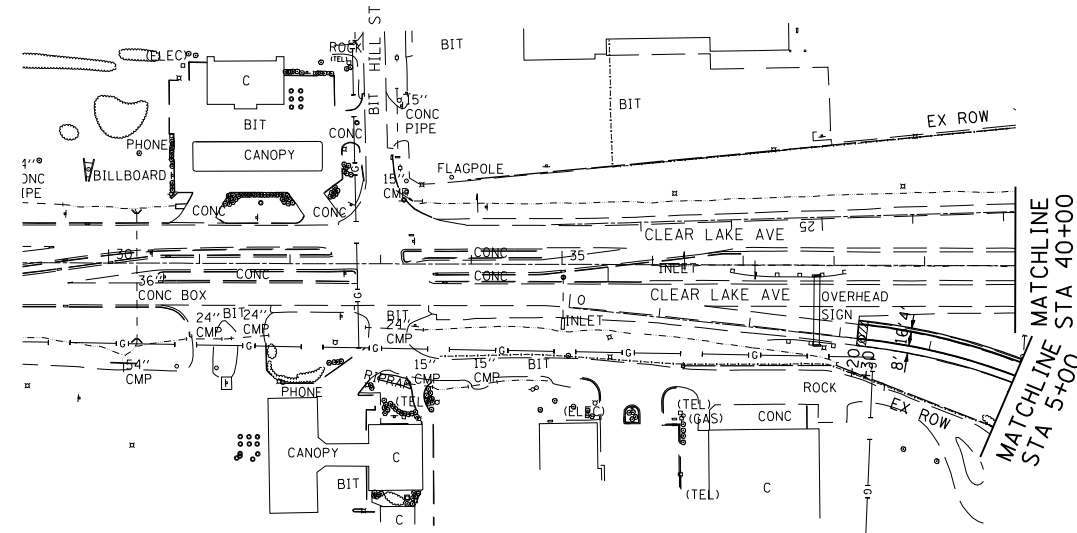

CLEAR LAKE AVE

I-72

LEGEND

- ⊕ - GUARDRAIL SECTION - SEE SCHEDULES
- MOWING SWATH EDGE
- TREE REMOVAL LIMIT
- ▨ TRANSITION LOCATIONS  
SEE DETAIL SHEETS# 151-155
- ▨ VERTICAL CLEARANCE  
SEE DETAIL SHEET#157

REVISIONS	
NAME	DATE

ILLINOIS DEPARTMENT OF TRANSPORTATION  
**PLAN SHEET**  
 FA155(I-55), FA172(I-72), FAP666(I-55 BUS)  
 SECTION D6 INTERSTATE RS,BR,M CAB 2008  
 SANGAMON COUNTY  
 SCALE: 1" = 100'  
 DATE \_\_\_\_\_ DRAWN BY TEC  
 CHECKED BY \_\_\_\_\_

**CLEAR LAKE AVE I-72**

PLOT DATE = 08-22-2007 08:26:35AM  
 FILE NAME = c:\p\projects\4652882\plan\_11.dgn  
 PLOT SCALE = 211.7647 / IN.  
 USER NAME = laughlin-1