

F.A.I. RTE.	SECTION	COUNTY	TOTAL SHEETS	SHEET NO.
*	**	SANGAMON	248	93

STA.	TO STA.
FED. ROAD DIST. NO.	ILLINOIS FED. AID PROJECT
* FA155(I-55), FA172(I-72), FAP666(I-55 BUS) ** D6 INTERSTATE RS,BR,M CAB 2008	

SECTION 21, T15N, R5W, 3rd PM



44 GUARDRAIL REMOVAL
 REM AND RE-ERECT RAIL ELEMENT OF EX GR
 TBT TYPE TYPE 1, SPECIAL (TANGENT)
 TERMINAL MARKER - DIRECT APPLIED
 GUARDRAIL MARKERS, TYPE A

FENCE REPLACEMENT
 SEE SCHEDULE OF QUANTITIES
 SEE FENCE REPLACEMENT DETAIL SHEET# 156

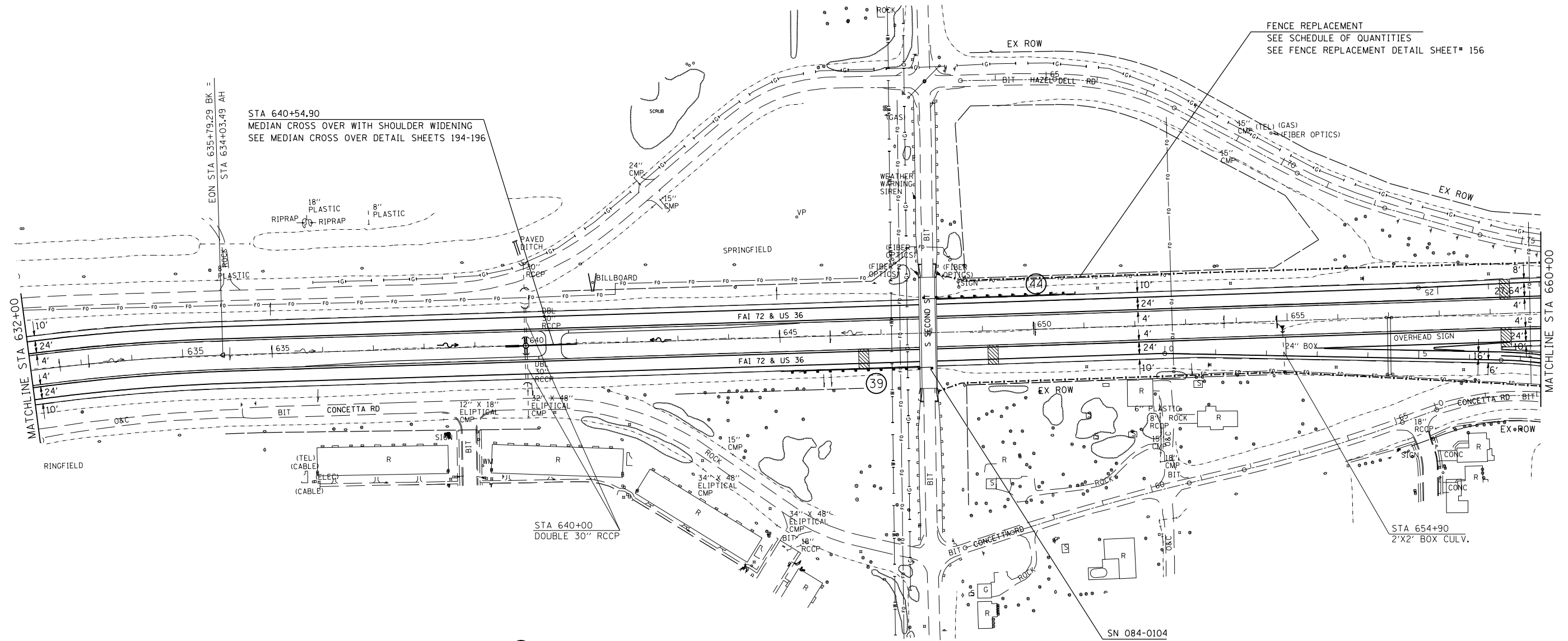

39 GUARDRAIL REMOVAL
 REM AND RE-ERECT RAIL ELEMENT OF EX GR
 TBT TYPE TYPE 1, SPECIAL (TANGENT)
 TERMINAL MARKER - DIRECT APPLIED
 GUARDRAIL MARKERS, TYPE A

LEGEND

- ⊕ - GUARDRAIL SECTION - SEE SCHEDULES
- MOWING SWATH EDGE
—○— TREE REMOVAL LIMIT
- ▨ TRANSITION LOCATIONS
SEE DETAIL SHEETS# 151-155
- ▨ VERTICAL CLEARANCE
SEE DETAIL SHEET#157

REVISIONS	
NAME	DATE

ILLINOIS DEPARTMENT OF TRANSPORTATION
PLAN SHEET
 FA155(I-55), FA172(I-72), FAP666(I-55 BUS)
 SECTION D6 INTERSTATE RS,BR,M CAB 2008
 SANGAMON COUNTY
 SCALE: 1" = 100'
 DATE _____ DRAWN BY TEC
 CHECKED BY _____

PLOT DATE = Oct-22-2007 10:13:37AM
 FILE NAME = c:\p\projects\46522882\plan_2.dgn
 PLOT SCALE = 211.7643 / IN.
 USER NAME = laughlinr1