

F.A.I. RTE.	SECTION	COUNTY	TOTAL SHEETS	SHEET NO.
*	**	SANGAMON	248	182
STA.		TO STA.		
FED. ROAD DIST. NO.	ILLINOIS	FED. AID PROJECT		
* FA155(I-55), FA172(I-72), FAP666(I-55 BUS) ** D6 INTERSTATE RS,BR,M CAB 2008				

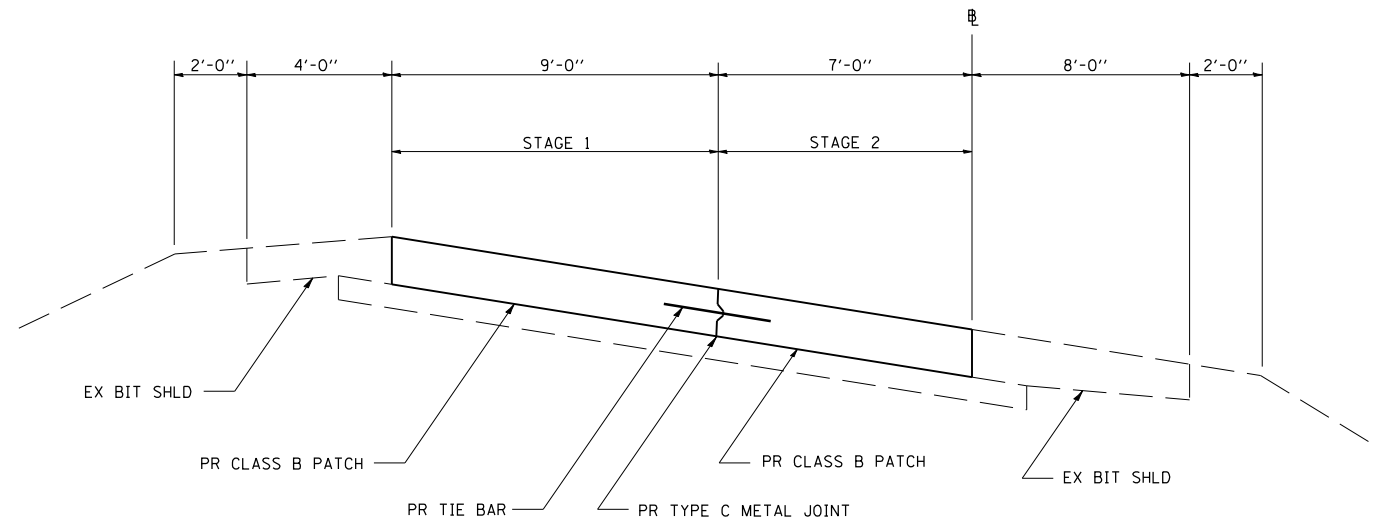

TYPICAL SECTION - CLASS B PATCH ON RAMPS

NOTE:

1. THIS DETAIL IS TO BE USED IN CONJUNCTION WITH STANDARD 442101-02.
2. TIE BARS SHALL BE NO. 6 DEFORMED BARS AT 24" CENTERS INSTALLED ACCORDING TO ARTICAL 420.10(b) OF THE STANDARD SPECIFICATIONS.
3. TYPE C METAL JOINT SHALL BE AS DETAILED ON STANDARD 420001. THE COST SHALL BE INCLUDED IN THE COST FOR CLASS B PATCHES.

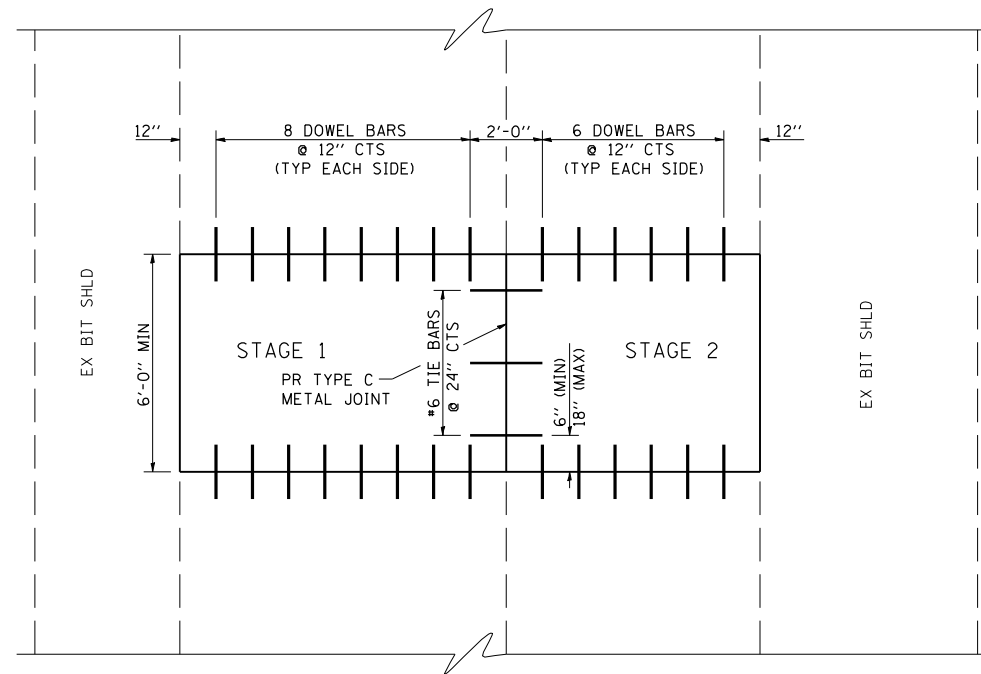

PLAN - CLASS B PATCH ON RAMPS

REVISIONS	
NAME	DATE

ILLINOIS DEPARTMENT OF TRANSPORTATION  
**CLASS B PATCHING**  
**RAMP DETAIL**  
 FA155(I-55), FA172(I-72), FAP666(I-55 BUS)  
 SECTION D6 INTERSTATE RS,BR,M CAB 2008  
 SANGAMON COUNTY

SCALE: \_\_\_\_\_ DRAWN BY \_\_\_\_\_  
 DATE \_\_\_\_\_ CHECKED BY \_\_\_\_\_

PLOT DATE = 06-22-2007 08:23:00AM  
 FILE NAME = c:\p\projects\4652882\shl\_rmpatch.dgn  
 PLOT SCALE = 1/8"=1'-0" / IN.  
 USER NAME = laughlin-1