

STATE OF ILLINOIS
DEPARTMENT OF TRANSPORTATION

CONTRACT NO. 72659				
F.A.I. RTE.	SECTION	COUNTY	TOTAL SHEETS	SHEET NO.
*	**	SANGAMON	248	226
FED. ROAD DIST. NO. ILLINOIS FED. AID PROJECT				
* F.A.I. 55, F.A.I. 72, F.A.P. 666				
** D6 Interstate R5, BR, M CAB 2008				

Sheet No. 7
of 7 Sheets

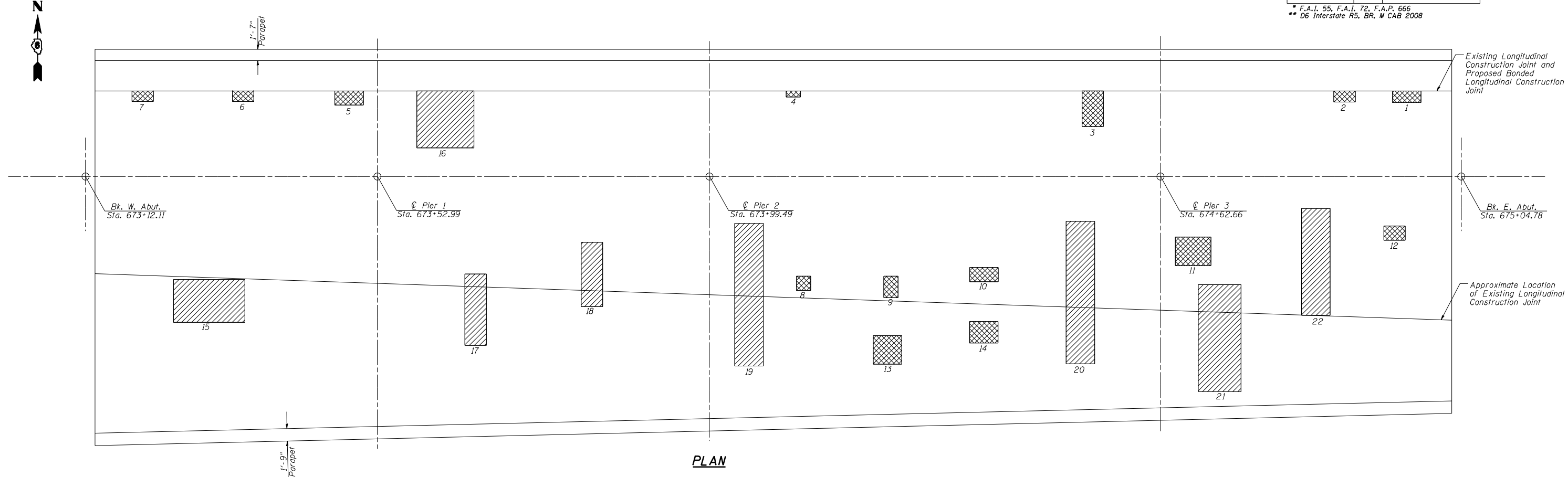

PLAN

Date of Survey: 6-27-07
Survey By: Dave Copenbarger

LEGEND

- Deck slab repair (Full depth) - Sq. Yd.
- Deck slab repair (Partial depth) - Sq. Yd.

NOTES:

1. Areas of deck slab repairs shown are estimated. The engineer shall record the actual deck slab repair areas in the "As Built" plans.

Deck Slab Repair (Full Depth)

Patch	Length (Ft)	Width (Ft)	Area Type I (Sq Yd)	Area Type II (Sq Yd)
1	4	2		0.9
2	3	2		0.7
3	3	5		1.7
4	2	1	0.2	
5	4	2		0.9
6	3	2		0.7
7	3	2		0.7
8	2	2	0.4	
9	2	3		0.7
10	4	2		0.9
11	5	4		2.2
12	3	2		0.7
13	4	4		1.8
14	4	3		1.3
Total			0.6	13.2

Deck Slab Repair (Partial Depth)

Patch	Length (Ft)	Width (Ft)	Area (Sq Yd)
15	10	6	6.7
16	8	8	7.1
17	3	10	3.3
18	3	9	3.0
19	4	20	8.9
20	4	20	8.9
21	6	15	10.0
22	4	15	6.7
Total			54.6

BILL OF MATERIAL

Item	Unit	Quantity
Deck Slab Repair (Full Depth, Type I)	Sq. Yd.	0.6
Deck Slab Repair (Full Depth, Type II)	Sq. Yd.	13.2
Deck Slab Repair (Partial Depth)	Sq. Yd.	54.6

DECK PATCHING DETAILS
F.A.I. 55, F.A.I. 72, F.A.P. 666
Section D6 Interstate R5, BR, M CAB 2008
Sangamon County
EB 1-72 Over BU-55
S.N. 084-0077