

STATE OF ILLINOIS
DEPARTMENT OF TRANSPORTATION

ROUTE NO.	SECTION	COUNTY	TOTAL SHEETS	SHEET NO.	SHEET NO. 7
*	**	Sangamon	248	239	9 SHEETS
FED. ROAD DIST. NO. 7		ILLINOIS FED. AID PROJECT			

Contract # 72659
* FAI 55 (I-55), FAI 72 (I-72) FAP 666 (I-55 BUS)
** D6 Interstate RS, BR, M CAB 2008

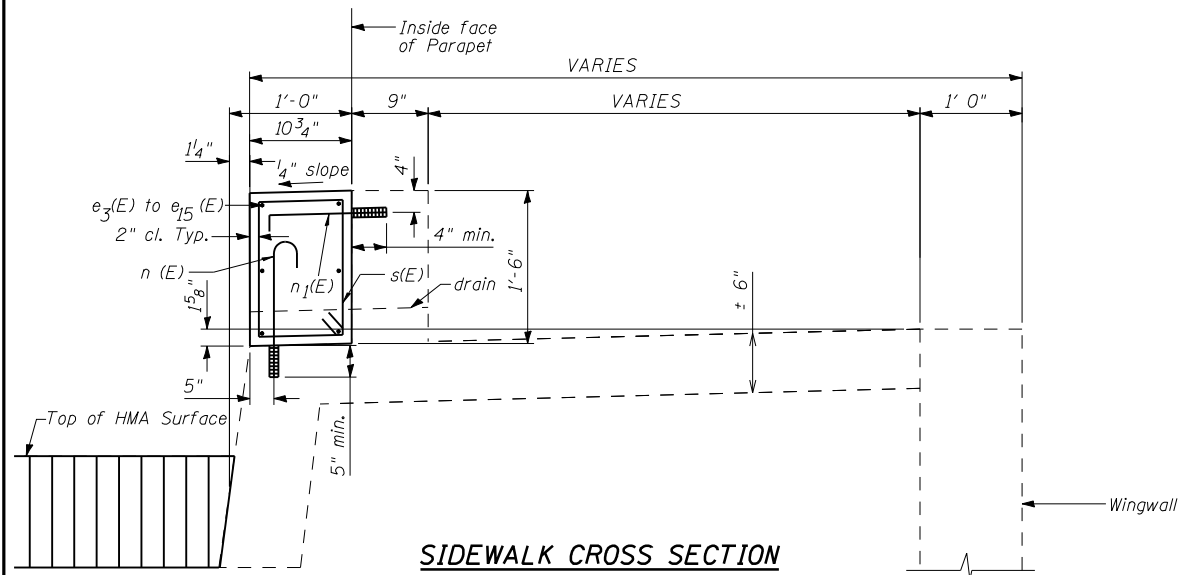

SIDEWALK CROSS SECTION

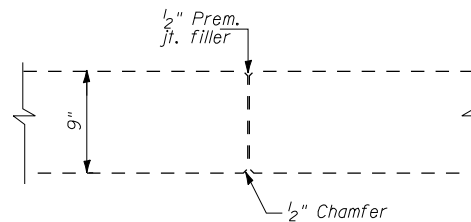

PLAN
(Typ. at all parapet const. jts)

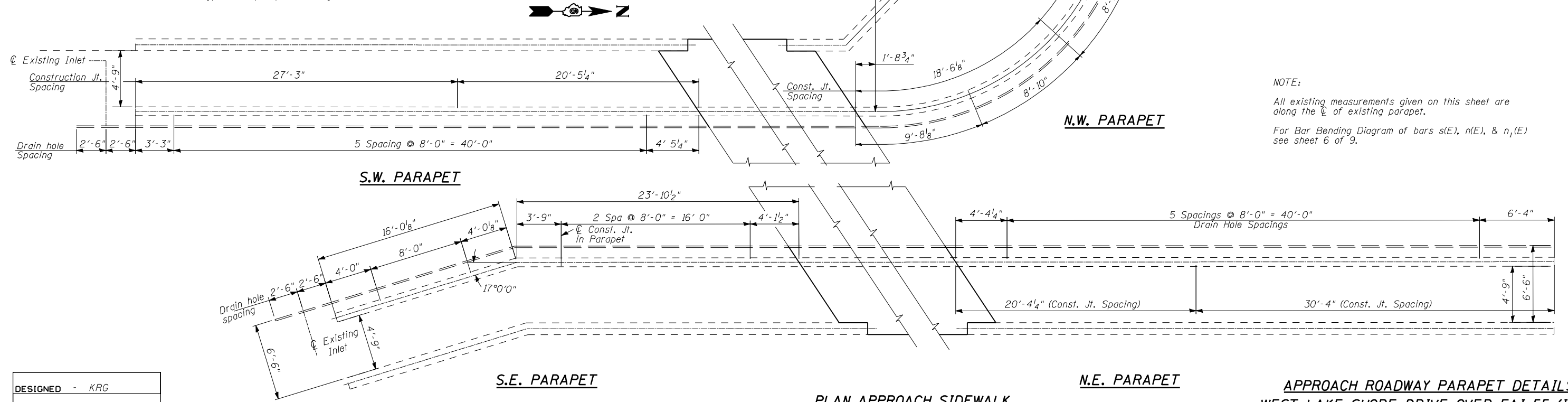

**PLAN APPROACH SIDEWALK
(SHOWING EXISTING CONDITIONS)**

NOTE:
All existing measurements given on this sheet are along the ϕ of existing parapet.
For Bar Bending Diagram of bars s(E), n(E), & n₁(E) see sheet 6 of 9.

DESIGNED	- KRG
CHECKED	- MJK
DRAWN	- GSJ
CHECKED	- MJK

MID-AMERICA ENGINEERING SERVICES

**APPROACH ROADWAY PARAPET DETAILS
WEST LAKE SHORE DRIVE OVER FAI 55 (I-55)
SECTION: D6 INTERSTATE RS, BR, M CAB 2008
SANGAMON COUNTY
Sta. 15+08.98
SN 084-0092**