

STATE OF ILLINOIS
DEPARTMENT OF TRANSPORTATION

ROUTE NO.	SECTION	COUNTY	TOTAL SHEETS	SHEET NO.
*	**	Sangamon	248	242

SHEET NO. 1
2 SHEETS

FED. ROAD DIST. NO. 7 ILLINOIS FED. AID PROJECT

Contract # 72659
* FAI 55 (I-55), FAI 72 (I-72) FAP 666 (I-55 BUS)
** D6 Interstate RS, BR, M CAB 2008

TEMPORARY SIGNAL PHASE DIAGRAM

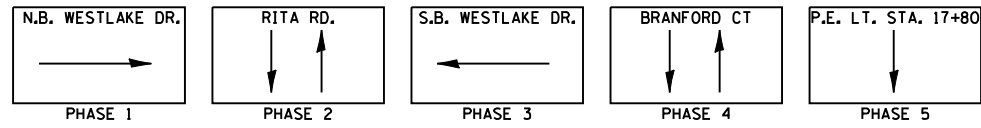

OVERLAP A = PHASE 1 + PHASE 2
OVERLAP B = PHASE 3 + PHASE 4 + PHASE 5

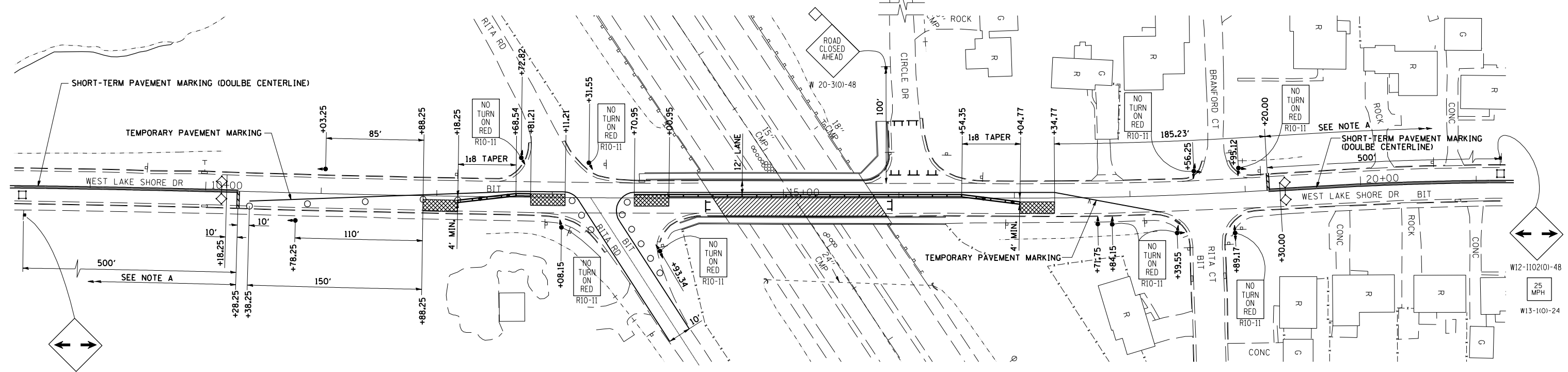
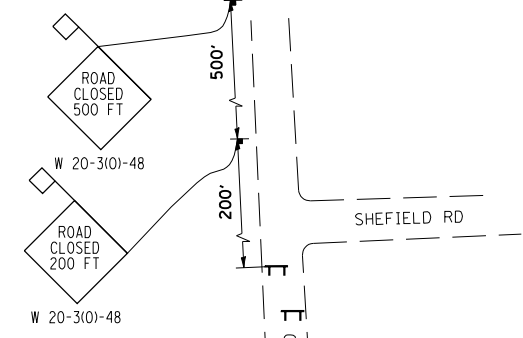

STAGE 1 TRAFFIC CONTROL

STAGE I SEQUENCE OF CONSTRUCTION
PLACE STAGE I TRAFFIC AS SHOWN AND ACCORDING TO STANDARD 701321.
DIRECT TRAFFIC TO STAGE I ROADWAY AND COMPLETE STAGE I CONSTRUCTION OF PROPOSED BRIDGE REPAIRS.

TOTAL BILL OF MATERIAL

Item	Unit	Structure	Roadway	Quantity
Temporary Bridge Traffic Signals	Each		1	1
Temporary Concrete Barrier	L.F.		368	368
Impact Attenuators Temporary (Fully Redirective, Narrow), Test Level 3	Each		4	4
Traffic Control and Protection Standard 701321 (Special)	Lum. S.		1	1

DESIGNED - JLS
CHECKED - SV
DRAWN - GSJ
CHECKED - KRG

MID-AMERICA ENGINEERING SERVICES

- LEGEND**
- WORK AREA
 - SIGN (SEE STD 701321)
 - DRUM WITH STEADY BURNING LIGHT
 - TRAFFIC SIGNAL
 - TEMPORARY CONCRETE BARRIER WALL
 - IMPACT ATTENUATOR, TEMP. (FULLY-REDIRECTIVE, NARROW), TL 3
 - TYPE III BARRICADE
 - DETECTOR LOOPS
 - STOP BAR
 - STEADY BURNING LIGHTS AND DOUBLE VERTICAL PANELS
 - TEMPORARY PAVEMENT MARKING
 - SHORT-TERM PAVEMENT MARKING (DOULBE CENTERLINE)

NOTE A
REMAINDER OF SIGNING ACCORDING TO STANDARD 701321 AND AS DIRECTED BY THE ENGINEER.
ALL SIGNING AND PAVEMENT MARKING SHOWN OR ACCORDING TO STANDARD 701321 IS INCLUDED IN THE COST OF TRAFFIC CONTROL AND PROTECTION STANDARD 701321 (SPECIAL).

**STAGE 1 TRAFFIC CONTROL
STANDARD 701321 (SPECIAL)**
WEST LAKE SHORE DRIVE OVER FAI 55 (I-55)
SECTION: D6 INTERSTATE RS, BR, M CAB 2008
SANGAMON COUNTY
Sta. 15+08.98
SN 084-0092