

STATE OF ILLINOIS
DEPARTMENT OF TRANSPORTATION

ROUTE NO.	SECTION	COUNTY	TOTAL SHEETS	SHEET NO.
*	**	Sangamon	248	243
FED. ROAD DIST. NO. 7		ILLINOIS	FED. AID PROJECT-	

SHEET NO. 2
2 SHEETS

Contract # 72659
* FAI 55 (I-55), FAI 72 (I-72) FAP 666 (I-55 BUS)
** D6 Interstate RS, BR, M CAB 2008

TEMPORARY SIGNAL PHASE DIAGRAM

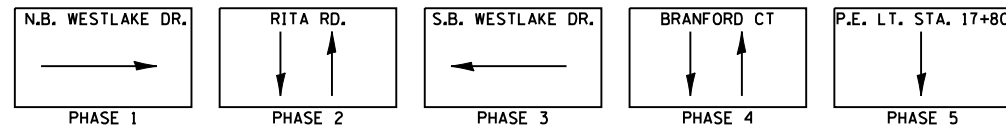

OVERLAP A = PHASE 1 + PHASE 2
OVERLAP B = PHASE 3 + PHASE 4 + PHASE 5

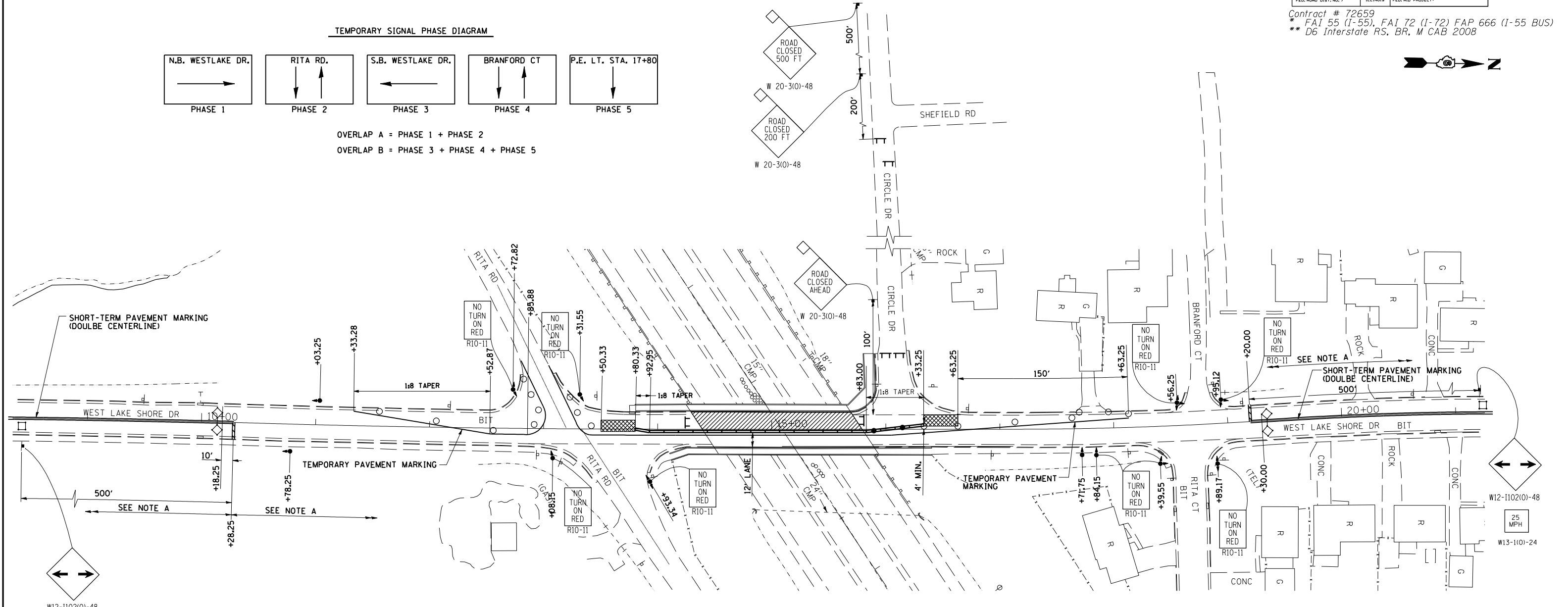

STAGE II SEQUENCE OF CONSTRUCTION

RELOCATE BARRIERS WALLS AND IMPACT ATTENUATORS AND PUT IN PLACE OTHER TRAFFIC CONTROL MEASURES AS SHOWN AND ACCORDING TO STANDARD 701321.
DIRECT TRAFFIC TO STAGE II TRAFFIC LANES AND COMPLETE STAGE II REMOVAL AND CONSTRUCTION.

STAGE 2 TRAFFIC CONTROL

- LEGEND
- WORK AREA
 - SIGN (SEE STD 701321)
 - DRUM WITH STEADY BURNING LIGHT
 - TRAFFIC SIGNAL
 - TEMPORARY CONCRETE BARRIER WALL
 - IMPACT ATTENUATOR, RELOCATE ((FULLY-REDIRECTIVE, NARROW), TL 3
 - TYPE III BARRICADE
 - DETECTOR LOOPS
 - STOP BAR
 - STEADY BURNING LIGHTS AND DOUBLE VERTICAL PANELS
 - TEMPORARY PAVEMENT MARKING
 - SHORT-TERM PAVEMENT MARKING (DOULBE CENTERLINE)

NOTE A
REMAINDER OF SIGNING ACCORDING TO STANDARD 701321 AND AS DIRECTED BY THE ENGINEER.
ALL SIGNING AND PAVEMENT MARKING SHOWN OR ACCORDING TO STANDARD 701321 IS INCLUDED IN THE COST OF TRAFFIC CONTROL AND PROTECTION STANDARD 701321 (SPECIAL).

TOTAL BILL OF MATERIAL

Item	Unit	Structure	Roadway	Quantity
Relocate Temp. Concrete Barrier	L.F.		253	253
Impact Attenuators Relocate (Fully Redirective) Test Level 3	Each		2	2

DESIGNED	- JLS
CHECKED	- SV
DRAWN	- GSJ
CHECKED	- KRG

MID-AMERICA ENGINEERING SERVICES

STAGE 2 TRAFFIC CONTROL
STANDARD 701321 (SPECIAL)
WEST LAKE SHORE DRIVE OVER FAI 55 (I-55)
SECTION: D6 INTERSTATE RS, BR, M CAB 2008
SANGAMON COUNTY
Sta. 15+08.98
SN 084-0092