

F.A.P. RTE.	SECTION	COUNTY	TOTAL SHEETS	SHEET NO.
685	(113)B-3	HANCOCK	48	18
STA.		TO STA.		
FED. ROAD DIST. NO.	ILLINOIS	FED. AID PROJECT		

STAGE I

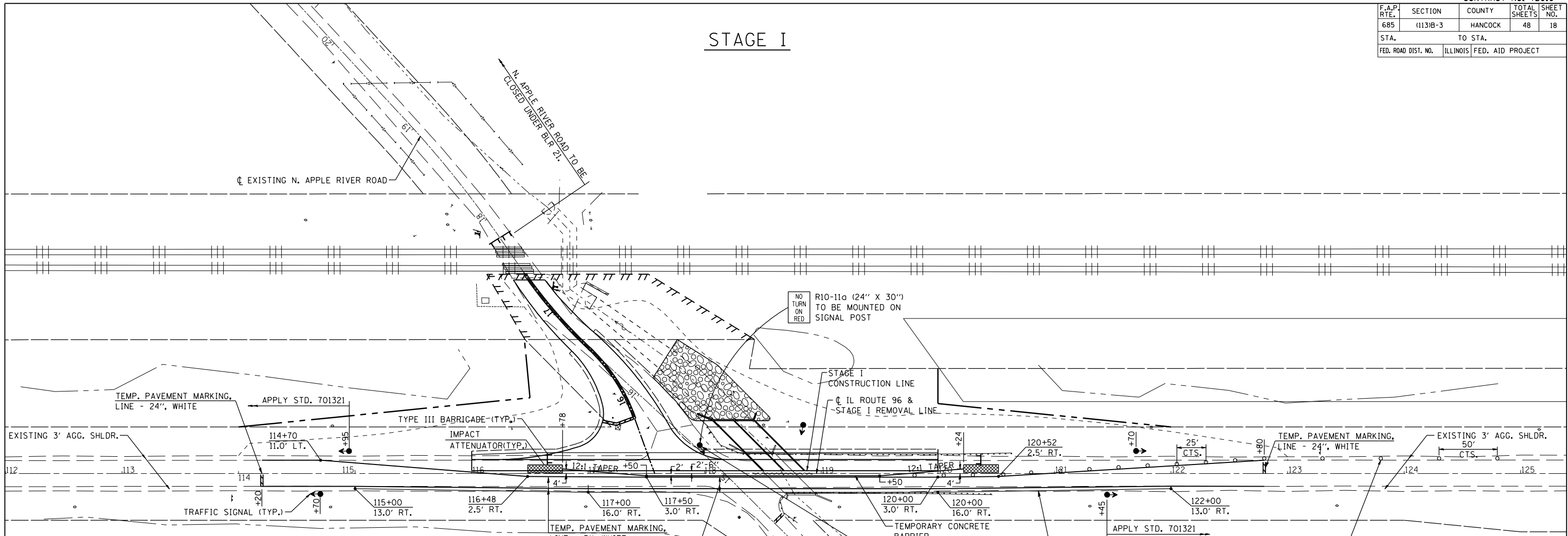

GENERAL NOTES:

1. MAINTENANCE OF TRAFFIC SHALL BE IN ACCORDANCE WITH HIGHWAY STANDARD 701321, AS SHOWN AND AS DIRECTED BY THE ENGINEER.
2. UNLESS OTHERWISE INDICATED, SIGNAL, STOP BAR, RUMBLE STRIP, LOOP DETECTOR AND ADVANCE SIGN LOCATIONS TO REMAIN IN PLACE THROUGHOUT DURATION OF STAGES I & II.
3. TEMPORARY CONCRETE BARRIER, IMPACT ATTENUATORS, AND TEMPORARY SIGNAL HEADS SHALL BE ADJUSTED IN THE FIELD TO AVOID OBSTRUCTION WITH CONSTRUCTION OPERATIONS.
4. TEMP. PAVEMENT MARKING AND ITS REMOVAL FOR STAGE 2 TRAFFIC IS PART OF TC&P 701321 (SPL.) PAY ITEM.

PRE-STAGE I CONSTRUCTION:

1. REMOVE AGG. SHOULDER AND WIDEN IL RTE 96 PAVEMENT ON THE SOUTH SIDE AS SHOWN IN ACCORDANCE WITH STANDARD 701326-02.

STAGE I CONSTRUCTION:

1. CLOSE NORTH PORTION OF IL RTE 96 (WB LANES) AS SHOWN IN ACCORDANCE WITH STANDARD 701321.
2. CLOSE NORTH PORTION OF APPLE RIVER ROAD IN ACCORDANCE WITH STANDARD BLR 21.
3. REMOVE NORTH PORTION OF EXISTING BRIDGE, BRIDGE APPROACH PAVEMENT, SHOULDER, AND PORTIONS OF PAVEMENT AS SHOWN.
4. CONSTRUCT NORTH HALF OF PROPOSED CULVERT, PAVEMENT, AND SHOULDER.
5. COMPLETE ALL GRADING, RIPRAP, AND SEEDING LEFT OF IL-96 CENTERLINE.
6. CONSTRUCT N. APPLE RIVER ROAD AGGREGATE BASE COURSE, GRADING, RIPRAP, AND SEEDING.

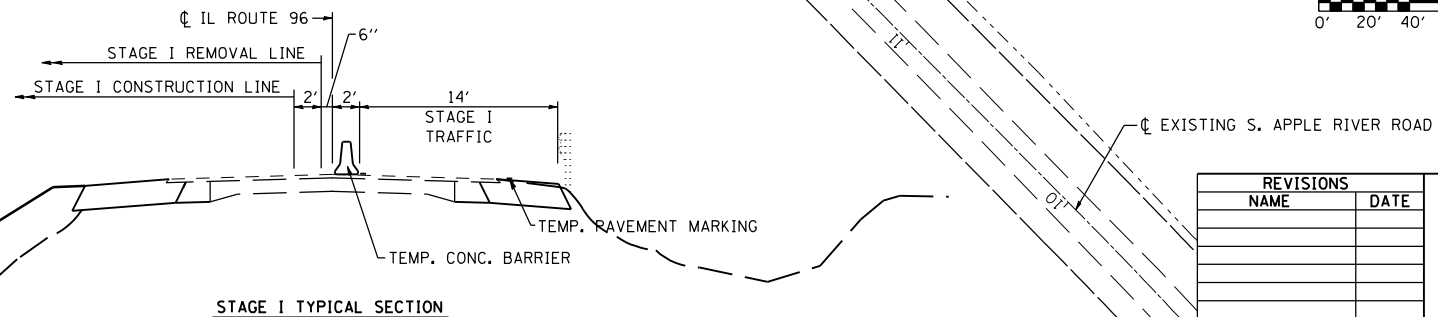

STAGE I TYPICAL SECTION

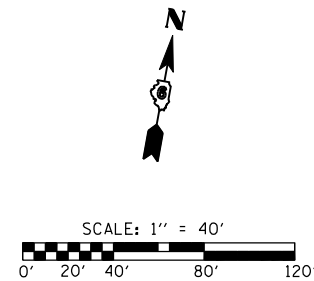

REVISIONS	
NAME	DATE

ILLINOIS DEPARTMENT OF TRANSPORTATION
STAGING PLANS
 IL ROUTE 96 & APPLE RIVER ROAD
 HANCOCK COUNTY

SCALE: 1" = 40'
 DATE: 07/2007
 DRAWN BY: SGL
 CHECKED BY: FML

PLOT DATE = Aug-23-2007 11:01:05AM
 FILE NAME = c:\projects\685480A\in\Final\staging.dgn
 PLOT SCALE = 84.7885 / IN.
 USER NAME = laughlin-1