

| F.A.P. RTE. | SECTION | COUNTY | TOTAL SHEETS | SHEET NO. |
|---------------------|------------|----------|------------------|-----------|
| 321 | 18(N-1,TS) | PIKE | 55 | 25 |
| STA. | | TO STA. | | |
| FED. ROAD DIST. NO. | | ILLINOIS | FED. AID PROJECT | |

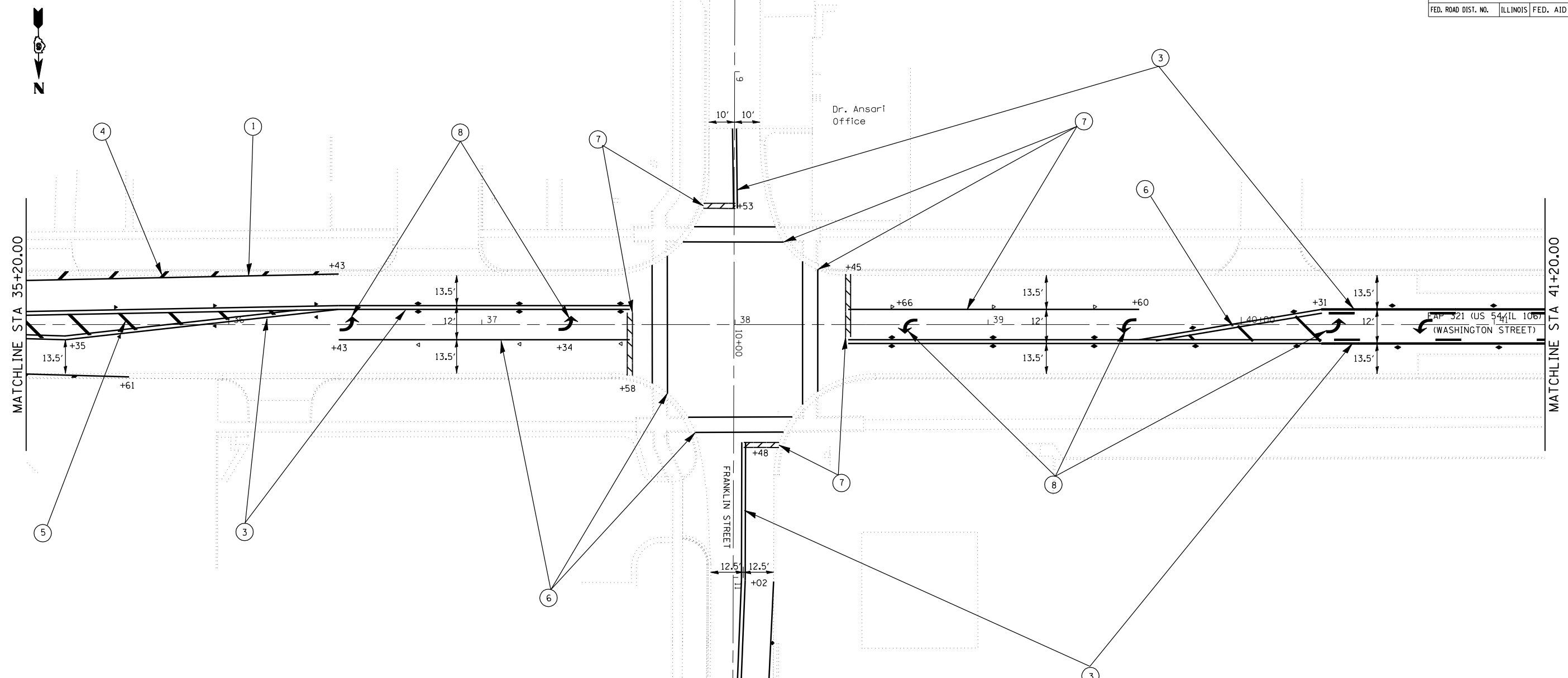

LEGEND

- ① THERMOPLASTIC PAVEMENT MARKING - LINE 5" (WHITE)
- ② THERMOPLASTIC PAVEMENT MARKING - LINE 5" (YELLOW)
- ③ THERMOPLASTIC PAVEMENT MARKING - LINE 5" (DOUBLE YELLOW)
- ④ THERMOPLASTIC PAVEMENT MARKING - LINE 12" (WHITE)
- ⑤ THERMOPLASTIC PAVEMENT MARKING - LINE 12" (YELLOW)
- ⑥ PREFORMED PLASTIC PAVEMENT MARKING, TYPE B - INLAID - LINE 6" (WHITE)
- ⑦ PREFORMED PLASTIC PAVEMENT MARKING, TYPE B - INLAID - LINE 24" (WHITE)
- ⑧ PREFORMED PLASTIC PAVEMENT MARKING, TYPE B - INLAID - LETTERS AND SYMBOLS (WHITE)
- ◆ TWO-WAY AMBER RPM
- ▶ ONE-WAY AMBER RPM
- ▷ ONE-WAY CRYSTAL RPM

| REVISIONS | |
|-----------|------|
| NAME | DATE |
| | |
| | |
| | |
| | |
| | |
| | |
| | |
| | |
| | |
| | |

ILLINOIS DEPARTMENT OF TRANSPORTATION
PAVEMENT MARKING PLAN
 FAP 321 (US 54)
 Section: 18(N-1,TS)
 Pike County

SCALE: 1" = 20'
 DATE

DRAWN BY
 CHECKED BY

PLOT DATE : 04-25-2007 01:57:24PM
 FILE NAME : c:\projects\655184\h\pavemark.dgn
 PLOT SCALE : 42.3525 / IN.
 USER NAME : laughlin-1