

F.A.P. RTE.	SECTION	COUNTY	TOTAL SHEETS	SHEET NO.
315		LOGAN	79	1

FED. ROAD DIST. NO. 6 ILLINOIS FED. AID PROJECT

* 116(BR-1) & 116(BR-2)

80

D-96-529-05

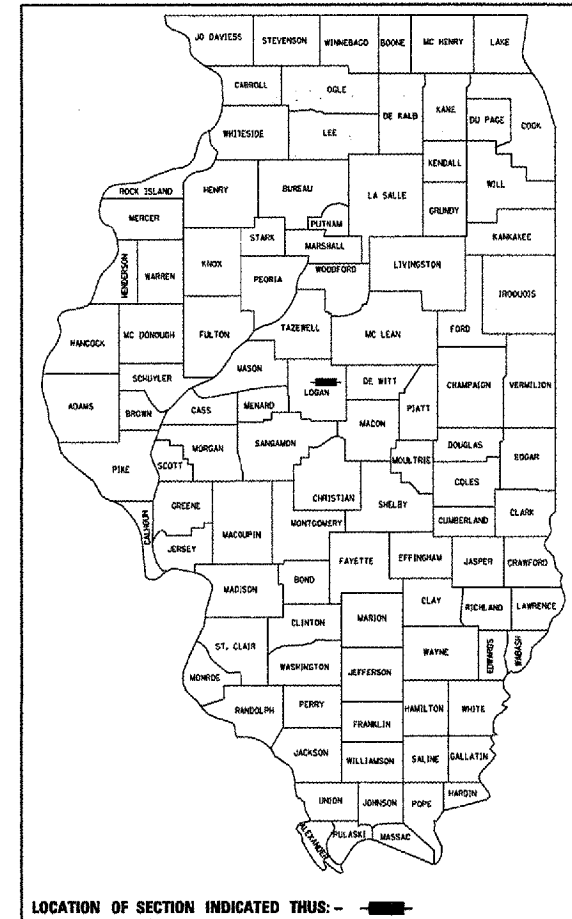

LOCATION OF SECTION INDICATED THIS: -

ADT = 2550 (2005)
 % SU = 13.7 (2005)
 % MU = 13.7 (2005)
 TOWNSHIP: PRAIRIE CREEK
 FUNCTIONAL CLASSIFICATION: MINOR ARTERIAL (NON-URBAN)

STATE OF ILLINOIS
 DEPARTMENT OF TRANSPORTATION
 DIVISION OF HIGHWAYS

SUBMITTED: *July 3, 2007*
Christopher P. Kohlbus
 DEPUTY DIRECTOR OF HIGHWAYS REGION FOUR

August 17, 2007
Eric E. Harn
 INTERIM ENGINEER OF DESIGN AND ENVIRONMENT

August 17, 2007
Milton R. See
 DIRECTOR, DIVISION OF HIGHWAYS

PRINTED BY THE AUTHORITY OF THE STATE OF ILLINOIS

STATE OF ILLINOIS
 DEPARTMENT OF TRANSPORTATION
 DIVISION OF HIGHWAYS
PROPOSED HIGHWAY PLANS
 FAP 315 (US 136)
 SECTIONS 116(BR-1, BR-2)
 PROJECT: BHF-0315(050)
 LOGAN COUNTY
 C-96-534-07

INDEX OF SHEETS

1	TITLE SHEET
2	GENERAL NOTES & MIXTURE REQUIREMENTS
3-4	SUMMARY OF QUANTITIES
5	WIDTH RESTRICTION SIGNING DETAILS
6-7	DETAILS & TYPICAL ROADWAY SECTIONS S.N. 054-0024
8-9	DETAILS & TYPICAL ROADWAY SECTIONS S.N. 054-0025
10	SCHEDULE OF QUANTITIES S.N. 054-0024
11	SCHEDULE OF QUANTITIES S.N. 054-0025
12-13	PLAN & PROFILE S.N. 054-0024
14-15	PLAN & PROFILE S.N. 054-0025
16-18	STAGE CONSTRUCTION TRAFFIC DETAILS S.N. 054-0024
19-21	STAGE CONSTRUCTION TRAFFIC DETAILS S.N. 054-0025
22-25	STORM WATER POLLUTION PREVENTION PLAN
26	EROSION CONTROL PLAN S.N. 054-0024
27	EROSION CONTROL PLAN S.N. 054-0025
28-42	STRUCTURE PLANS S.N. 054-0024
43-58	STRUCTURE PLANS S.N. 054-0025
59-69	CROSS SECTIONS S.N. 054-0024
70-79	CROSS SECTIONS S.N. 054-0025
STANDARDS	
* 21A.	TEMPORARY BRIDGE TRAFFIC SIGNAL LOOP REPLACEMENT DETAIL

LIST OF ILLINOIS DOT HIGHWAY STANDARDS

000001-04	635011-01
001001-01	701001-01
001006	701006-02
280001-03	701011-01
420001-06	701201-02
420401-05	701301-02
420601-04	701306-01
420701-01	701311-02
482006-02	701321-08
515001-02	701326-02
542401	702001-06
630001-07	704001-03
630301-04	780001-01
631032-03	781001-02
635006-02	857006

886001
886006

SECTION 116(BR-1)
 PROPOSED PRECAST PRESTRESSED CONCRETE DECK BEAM SUPERSTRUCTURE REPLACEMENT ON EXISTING THREE SPAN SUBSTRUCTURE 105'-10 1/4" BK.-BK. ABUTMENTS, 42'-0" CLEAR DECK WIDTH WITH TYPE SM STEEL BRIDGE RAILING, 54° SKEW LT. FORWARD S.N. 054-0024 STA. 85+45

PROPOSED PROJECT BEGINS -STA. 81+00

BEGIN PROJECT OMISSION -STA. 90+00

END PROJECT OMISSION -STA. 309+00

SECTION 116(BR-2)
 PROPOSED PRECAST PRESTRESSED CONCRETE DECK BEAM SUPERSTRUCTURE REPLACEMENT ON EXISTING THREE SPAN SUBSTRUCTURE 159'-2 1/2" BK.-BK. ABUTMENTS, 42'-0" CLEAR DECK WIDTH WITH TYPE SM STEEL BRIDGE RAILING, 50° SKEW LT. FORWARD S.N. 054-0025 STA. 314+50

RAILROAD OMISSION STA. 312+69 TO STA. 312+81

PROPOSED PROJECT ENDS -STA. 318+90

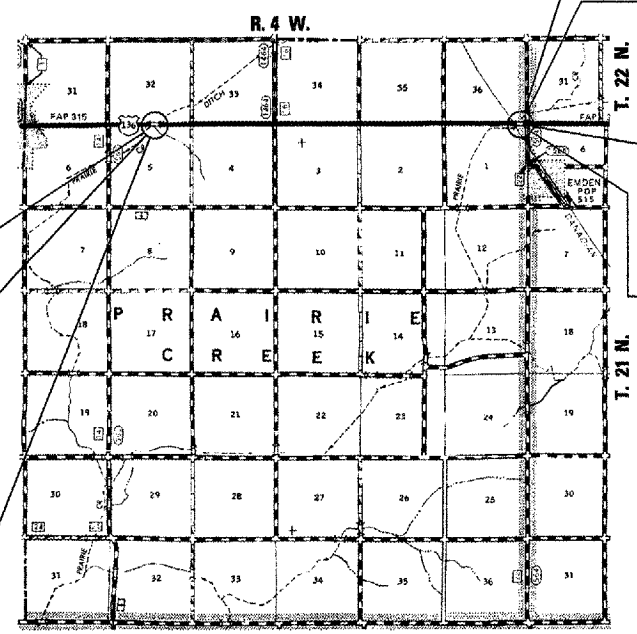

LOCATION MAP

NET LENGTH OF SECTION 116(BR-1) = 900 FEET = 0.170 MILES
 NET LENGTH OF SECTION 116(BR-2) = 978 FEET = 0.185 MILES
 NET LENGTH OF PROJECT = 1878 FEET = 0.356 MILES
 NET LENGTH OF PROJECT = 23790 FEET = 4.506 MILES

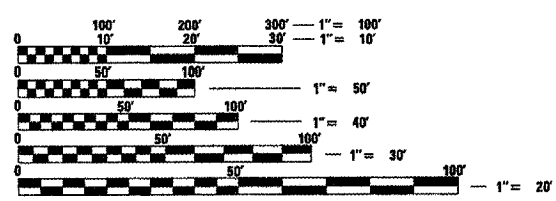
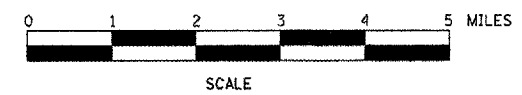

FULL SIZE PLANS HAVE BEEN PREPARED USING STANDARD ENGINEERING SCALES. REDUCED SIZED PLANS WILL NOT CONFORM TO STANDARD SCALES. IN MAKING MEASUREMENTS ON REDUCED PLANS, THE ABOVE SCALES MAY BE USED.

J.U.L.I.E.
 JOINT UTILITY LOCATION INFORMATION FOR EXCAVATION
 1-800-892-0123



Christopher P. Kohlbus 7/3/07
 EXPIRES 11/30/07

CONTRACT NO. 72997

Rev.

PROJECT ENGINEER: JOHN NEGANICARD (217)-782-6990
 SQUAD LEADER: VICTOR YOUNG (217)-557-7897