

F.A.P. RTE.	SECTION	COUNTY	TOTAL SHEETS	SHEET NO.
315	116(BR-2)	LOGAN	79	43
STA. 309+00		TO STA. 318+90		
FED. ROAD DIST. NO.		ILLINOIS FED. AID PROJECT		

Benchmark: B.M.102 - Chiseled "C" on N.W. Abutment Corner, S.N. 054-0025 Elev. 571.353

Existing Structure: S.N. 054-0025 was built as F.A. 119, Sec. 116BR, Sta. 314+50 as a three span precast prestressed concrete deck beam bridge supported on pile bent abutments and piers.

Proposed Improvement: Existing P.P.C. Deck Beams are to be removed and replaced. Traffic to be maintained utilizing stage construction.

No Salvage

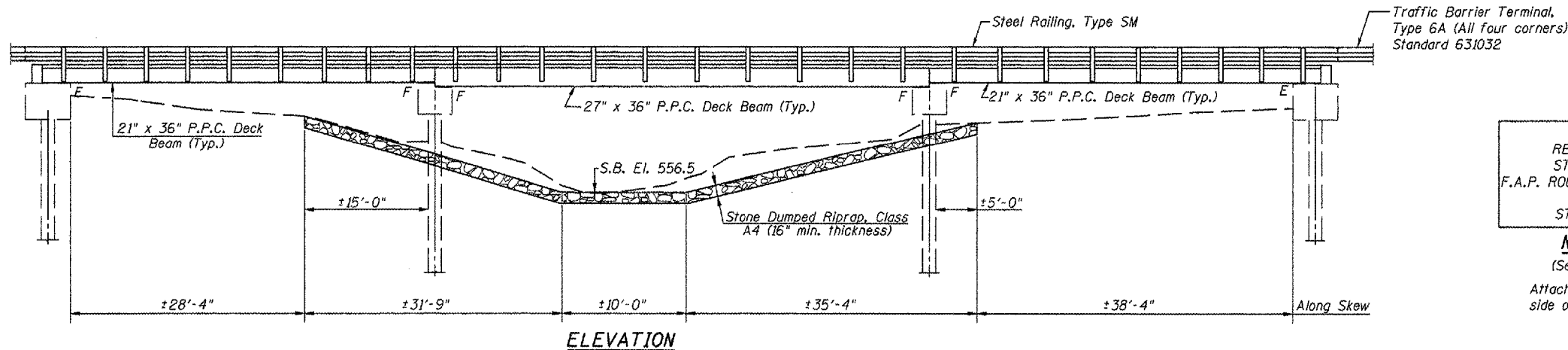

ELEVATION

STA. 314+50.00  
RE-BUILT 20 BY  
STATE OF ILLINOIS  
F.A.P. ROUTE 315 SEC. 116(BR-2)  
LOADING HS20  
STR. NO. 054-0025

**NAME PLATE**

(See Standard 515001)  
Attach new Name Plate to back side of 8" rail element.

**INDEX OF SHEETS**

1. General Plan and Elevation
2. General Notes and Bill of Material
3. Stage Construction Details
4. Temporary Concrete Barrier For Stage Construction
5. Deck Beam Details - Spans 1 & 3
6. Deck Beam Details - Span 2
7. Superstructure
8. Superstructure Details
9. Steel Railing, Type SM
10. West Abutment Removal
11. West Abutment
12. East Abutment Removal
13. East Abutment
.
14. Substructure Details
15. Bar Splicer Assembly Details
16. Substructure Repair

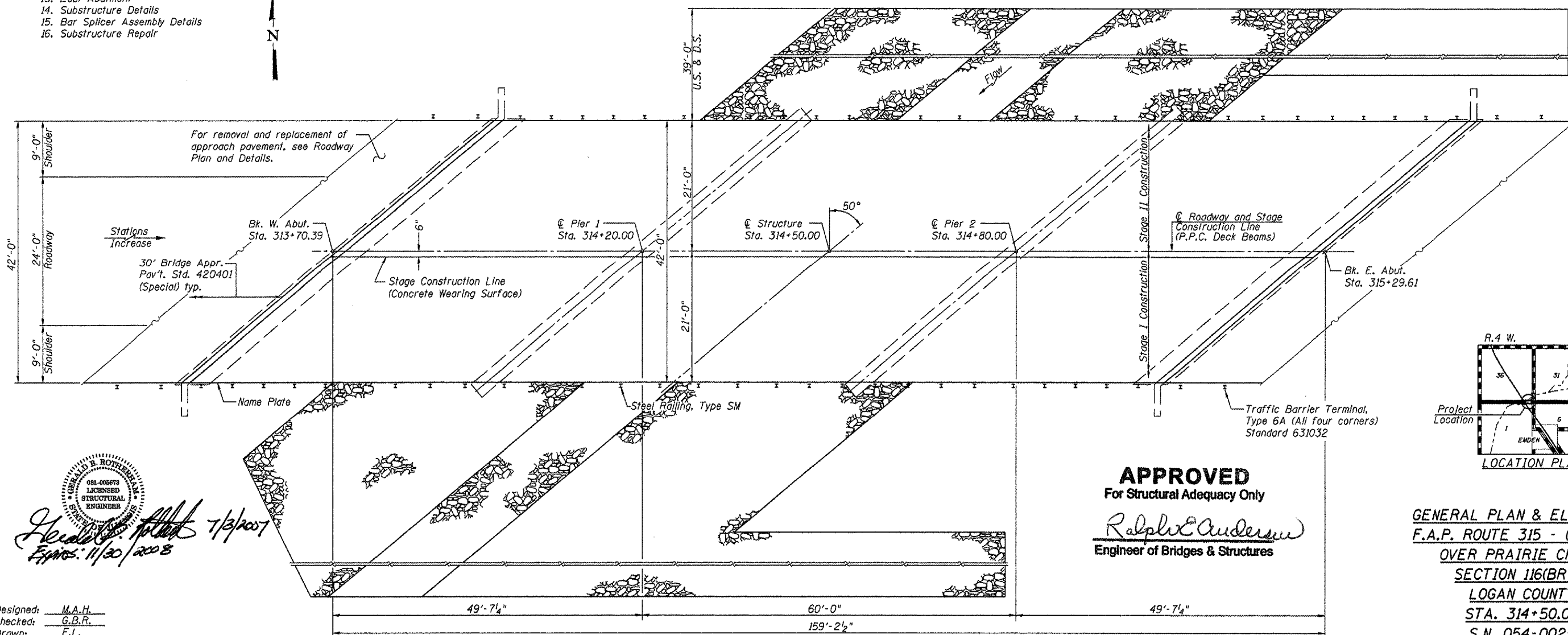
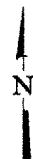

PLAN

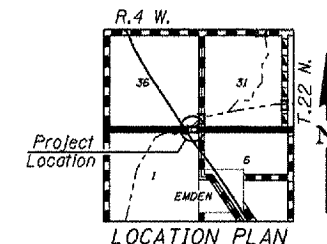

LOCATION PLAN

**APPROVED**  
For Structural Adequacy Only

*Ralph E. Anderson*  
Engineer of Bridges & Structures

**GENERAL PLAN & ELEVATION**  
F.A.P. ROUTE 315 - (U.S. 136)  
OVER PRAIRIE CREEK  
SECTION 116(BR-2)  
LOGAN COUNTY  
STA. 314+50.00  
S.N. 054-0025

Designed: M.A.H.  
Checked: G.B.R.  
Drawn: F.L.  
Checked: M.A.H.

*Henderson* 7/13/2007  
Expires: 11/30/2008



PLOT DATE - 08/07/08  
FILE NAME - 081032