

CONTRACT NO. 72997				
F.A.P. RTE.	SECTION	COUNTY	TOTAL SHEETS	SHEET NO.
315	116(BR-2)	LOGAN	79	49
STA. 309+00		TO STA. 318+90		
FED. ROAD DIST. NO. ILLINOIS FED. AID PROJECT				

SHEET NO. 7
OF 16 SHEETS

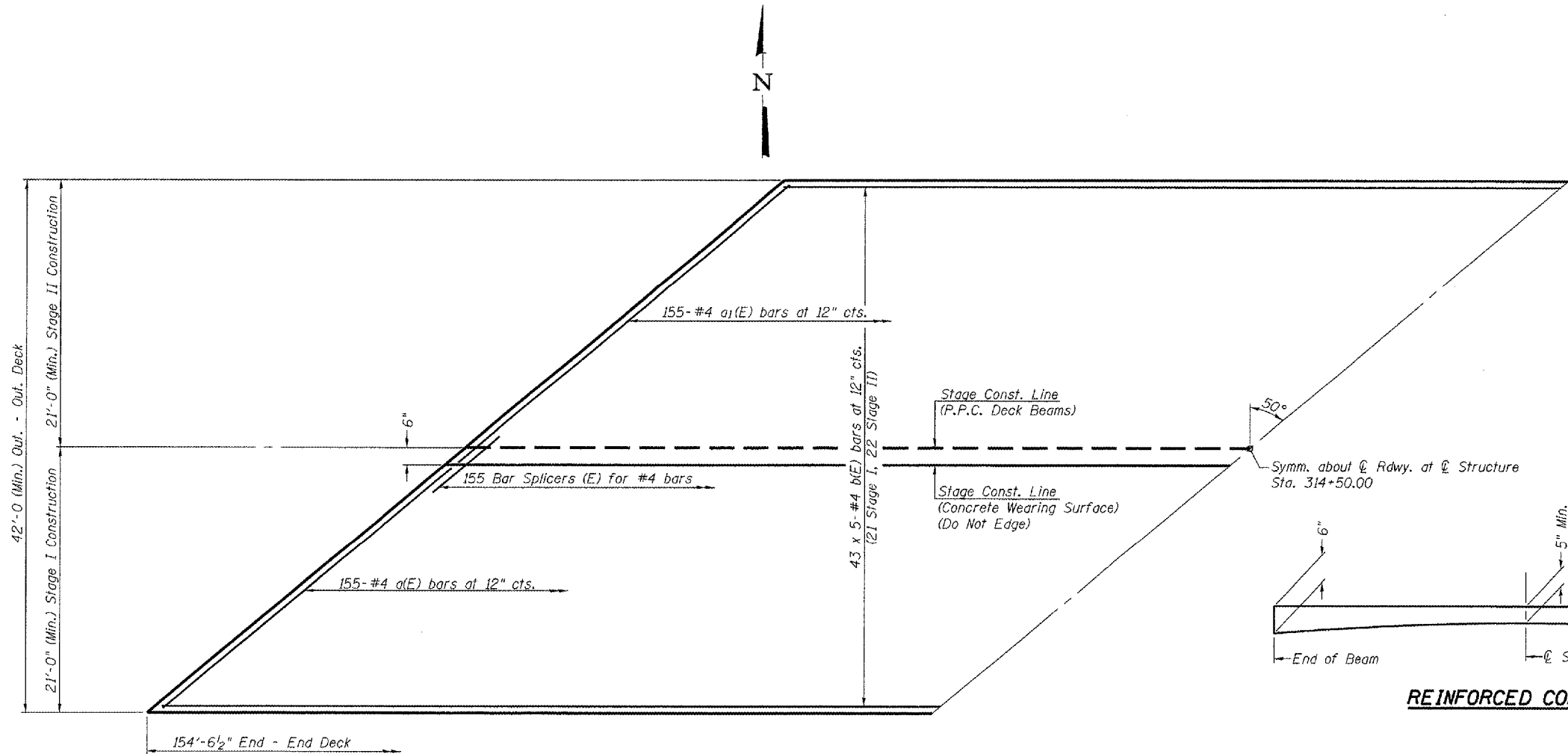

OVERLAY PLAN

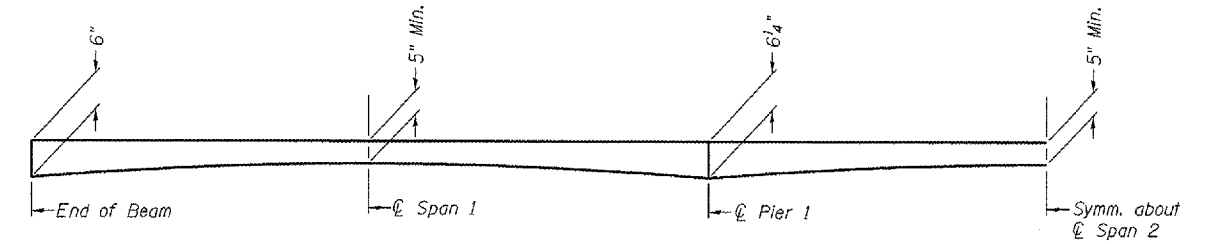

REINFORCED CONCRETE WEARING SURFACE PROFILE

Min. Bar Lap
#4 bar = 1'-4"

Note: For remainder of Superstructure Details see Sheet 8 of 16.
Bars designated 43 x 5-#4 etc. indicates 43 lines of bars with 5 lengths per line.

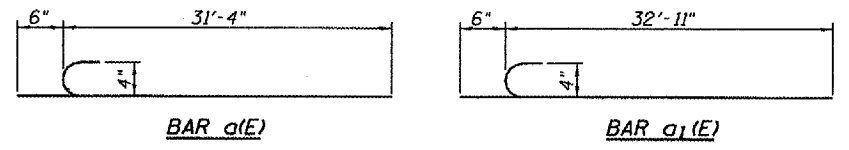

BAR a(E)

BAR a1(E)

BILL OF MATERIAL

Bar	No.	Size	Length	Shape
a(E)	155	#4	31'-10"	
a1(E)	155	#4	33'-5"	
b(E)	215	#4	32'-6"	
Reinforcement Bars, Epoxy Coated			Pound	11430
Bar Splicers			Each	155
Concrete Wearing Surface, 5"			Sq. Yd.	721.2

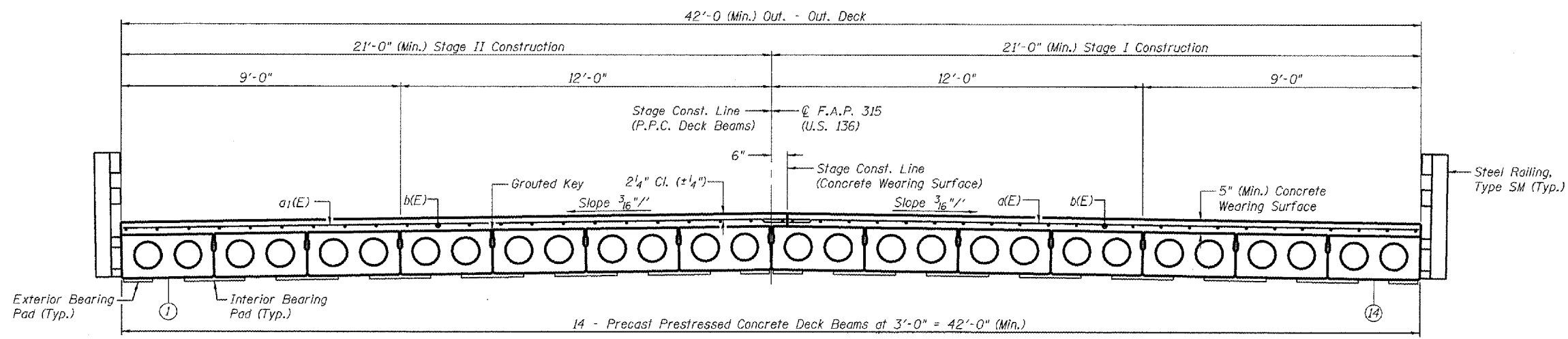

CROSS SECTION
(Looking East)

SUPERSTRUCTURE
F.A.P. ROUTE 315 - (U.S. 136)
OVER PRAIRIE CREEK
SECTION 116(BR-2)
LOGAN COUNTY
STA. 314+50.00
S.N. 054-0025

PLOT DATE = 7/1/2007
 FILE NAME = C:\p00\p00\p00\116(BR-2)\116(BR-2) - 054-0025.dgn
 MODEL NAME = 054-0025-721.2.dwg