

F.A.P. RTE.	SECTION	COUNTY	TOTAL SHEETS	SHEET NO.
315	116(BR-2)	LOGAN	79	54
STA. 309+00		TO STA. 318+90		
FED. ROAD DIST. NO.		ILLINOIS FED. AID PROJECT		

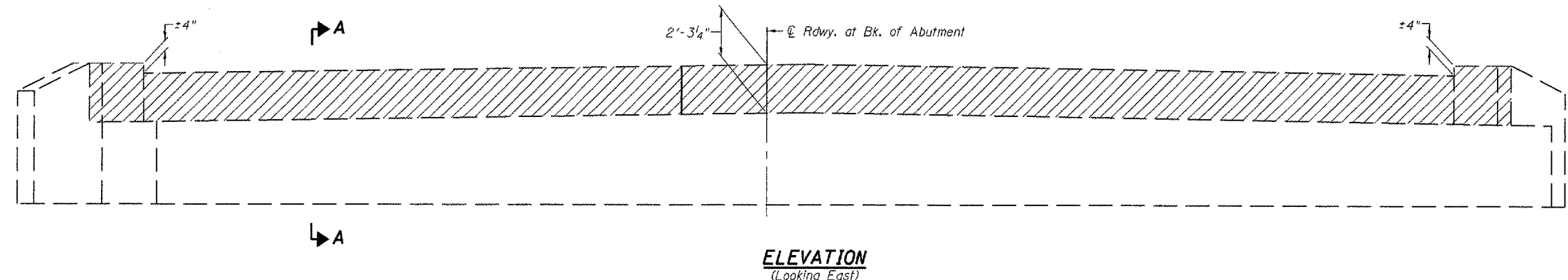

ELEVATION
(Looking East)

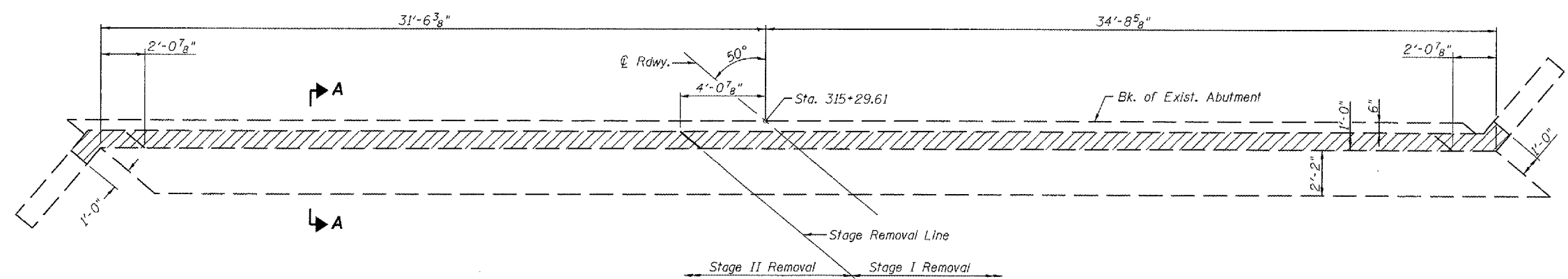

PLAN

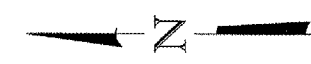

LEGEND

- Concrete Removal

Notes: Existing vertical reinforcing steel in backwall shall be cleaned, straightened, cut (if required), and incorporated into new construction. Damaged reinforcing steel shall be replaced or removed as directed by the Engineer. Cost included with "Concrete Removal".
Removal of the existing joint system is included in the cost of "Concrete Removal".

Existing P.C.C. Pavement & Bituminous Wearing Surface to be removed (See Roadway Plans)

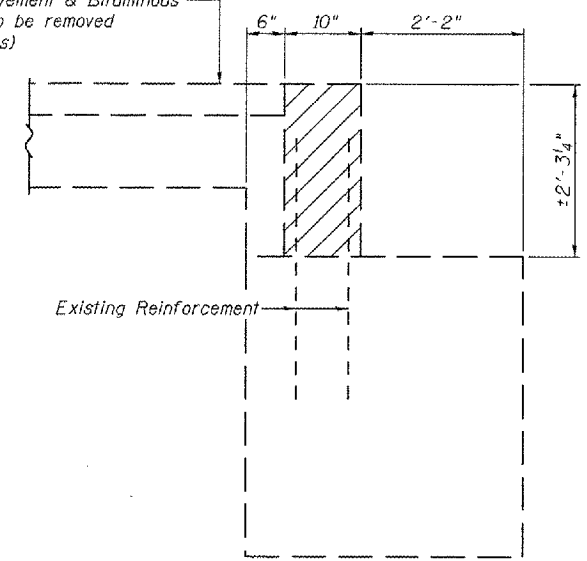

SECTION A-A

(Dimensions are at Rt. angles to abutment)

BILL OF MATERIAL

ITEM	UNIT	QUANTITY
Concrete Removal	Cu. Yd.	4.90

EAST ABUTMENT REMOVAL
F.A.P. ROUTE 315 - (U.S. 136)
OVER PRAIRIE CREEK
SECTION 116(BR-2)
LOGAN COUNTY
STA. 314+50.00
S.N. 054-0025

PLOT DATE = 7/9/2007
 FILE NAME = c:\projects\6552485\allen_henderson_final\sheet_043-055.dgn
 MODEL NAME = 02/07/2007-00-000-012