

F.A.P. RTE.	SECTION	COUNTY	TOTAL SHEETS	SHEET NO.
315	116(BR-1)	LOGAN	79	68
STA. 89+00.00 TO STA. 89+18.00				
FED. ROAD DIST. NO.		ILLINOIS FED. AID PROJECT		

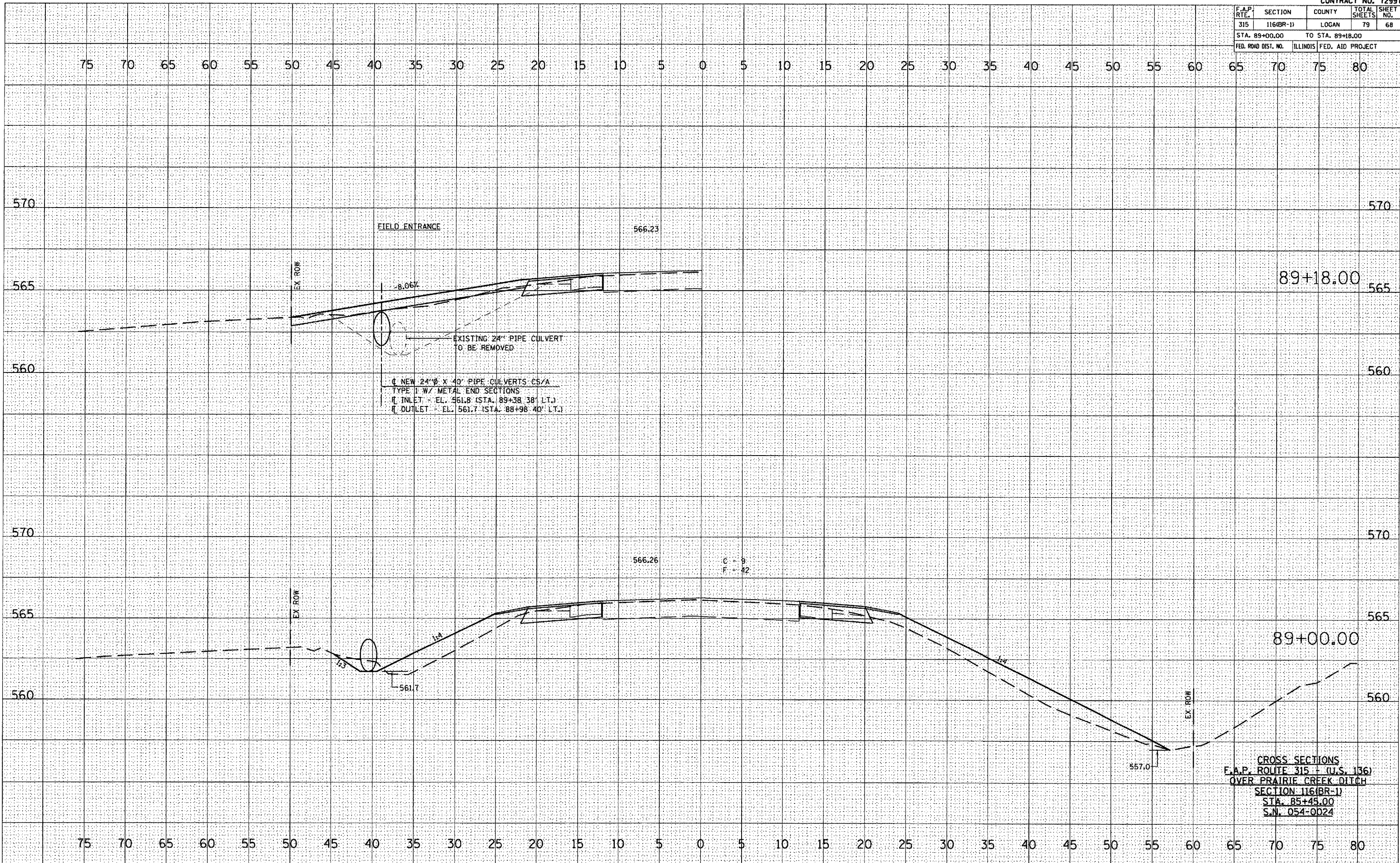

FIELD ENTRANCE
566.23

-8.06%

EXISTING 24" PIPE CULVERT TO BE REMOVED

NEW 24" Ø X 40' PIPE CULVERTS CS/A
TYPE II W/ METAL END SECTIONS
INLET - EL. 561.8 (STA. 89+38.38' LT.)
OUTLET - EL. 561.7 (STA. 88+98.40' LT.)

C - 9
F - 42

CROSS SECTIONS
F.A.P. ROUTE 315 + (U.S. 136)
OVER PRAIRIE CREEK DITCH
SECTION 116(BR-1)
STA. 85+45.00
S.N. 054-0024

FINAL SURVEY PLOTTED TEMPLATE AREAS CHECKED

BY: _____ DATE: _____

NO. _____

ORIGINAL SURVEY PLOTTED TEMPLATE AREAS CHECKED

BY: _____ DATE: _____

NO. _____

PLOT DATE = 7/10/2007
FILE NAME = 116(BR-1)68.dwg
PLOT SCALE = 1/8" = 10'-0"
USER NAME = baughlin1