

CONTRACT NO. 72B30

F.A.P. RTE.	SECTION	COUNTY	TOTAL SHEETS	SHEET NO.
315		MASON	11	8
STA. **	TO STA. **			
FED. ROAD DIST. NO.	ILLINOIS	FED. AID PROJECT		

*D-6 SHLDR RUMBLE STRIPS 2008-2

**606+14.91 TO 611+74.18
**635+00.00 TO 641+68.50

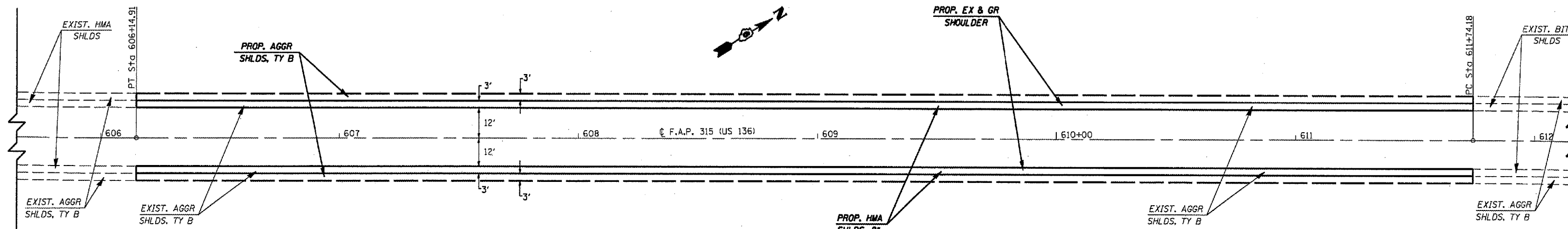

- NOTES:**
- 1 PROP. SHOULDER RUMBLE STRIPS CONTINUE FR. STA 582+77.57 TO 641+68.50 RT & LT.
 - 2 1650 N - PROP. SHOULDER RUMBLE STRIP OMISSION FR. STA 591+37.31 TO 592+59.31 RT.
 - 3 CH 4 - PROP. SHOULDER RUMBLE STRIP OMISSION FR. STA 637+14.50 TO 637+79.00 RT & LT.

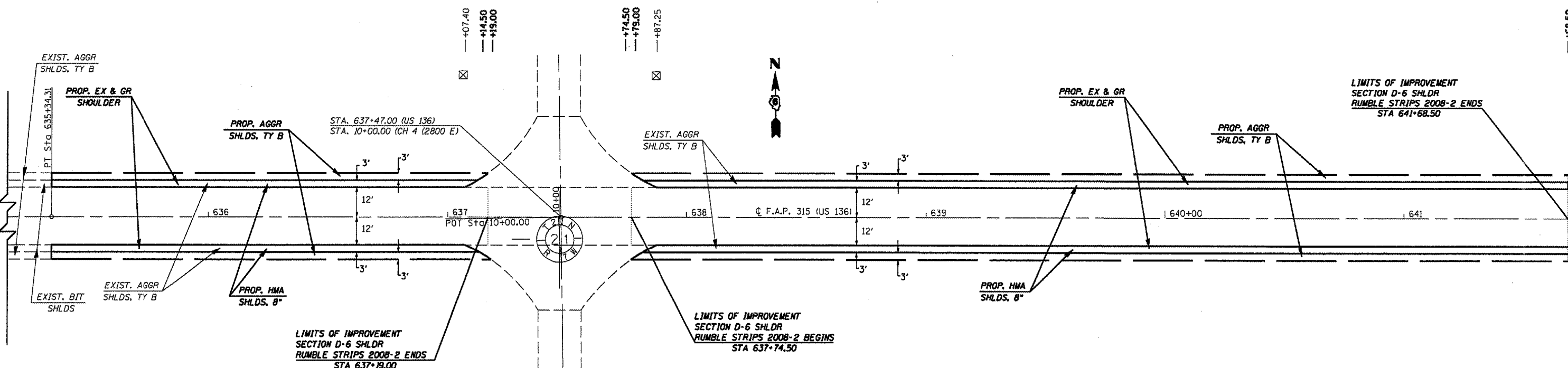

REVISIONS	
NAME	DATE

ILLINOIS DEPARTMENT OF TRANSPORTATION

PLAN VIEW

F.A.P. Route 315 (US 136)
Section D-6 SHLDR RUMBLE STRIPS 2008-2
MASON COUNTY

SCALE: VERT. DRAWN BY: JWC
HORIZ. CHECKED BY: RSC
DATE: MAY 21, 2007

PLOT DATE = 05-29-2007 10:57:59AM
 FILE NAME = c:\temp\mason\72b30\72b30plan.dgn
 PLOT SCALE = 42.3529' / 1" IN.
 USER NAME = cobyj