

F.A.I. RTE.	SECTION	COUNTY	TOTAL SHEETS	SHEET NO.
57		**	86	81

STA. 2932+00 TO STA. 2938+00
 ILLINOIS FED. AID PROJECT

• D7 SAFETY 2008-1
 • EFFINGHAM, CLAY, AND FAYETTE

GPS BASE STATION OCCUPYING
 PROJECT TRAVERSE STATION # 1
 NGS STATION DESIGNATION - FARINA
 PID - JB07B
 NAD 83 (1997)
 NORTHING = 791,709.07
 EASTING = 851,940.08
 NAVD 88
 ELEVATION = 576.17

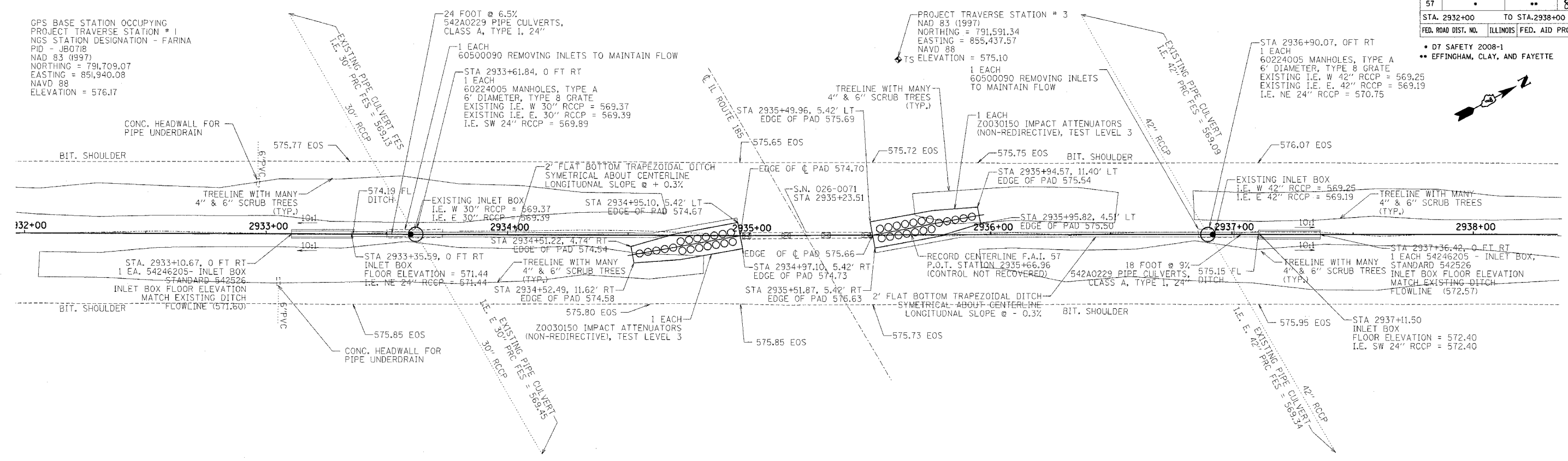

LOCATION 11

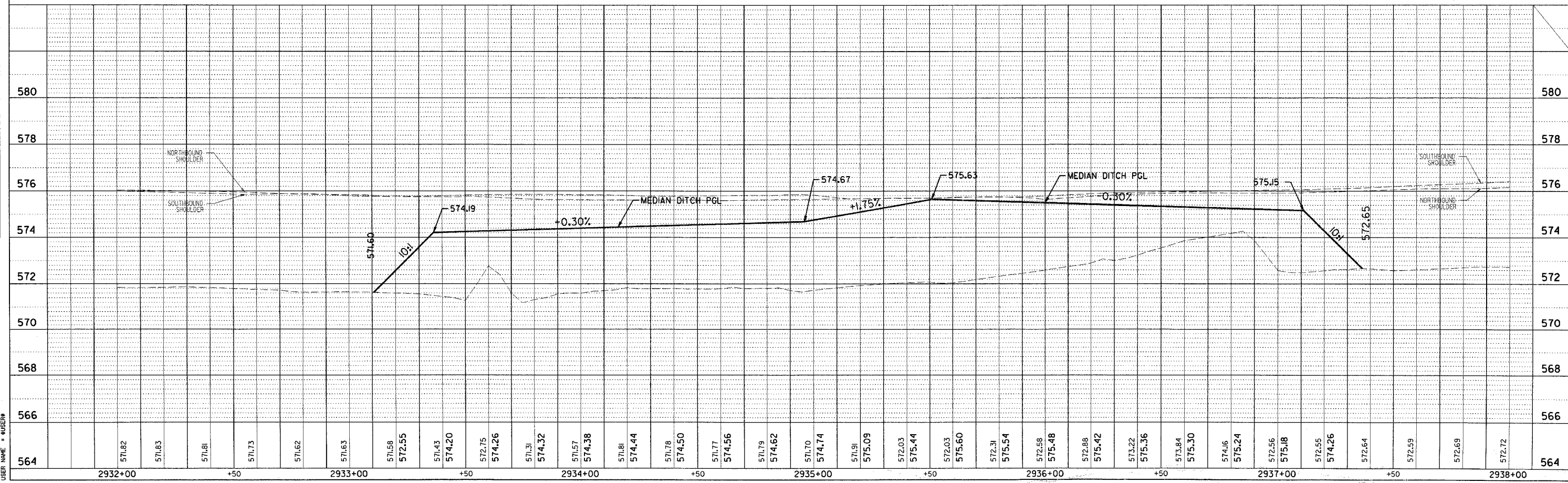

DATE	BY	REVISION

DATE	BY	REVISION

DATE = DATE
 FILE NAME = FILE
 PLOT SCALE = SCALE
 USER NAME = USER