

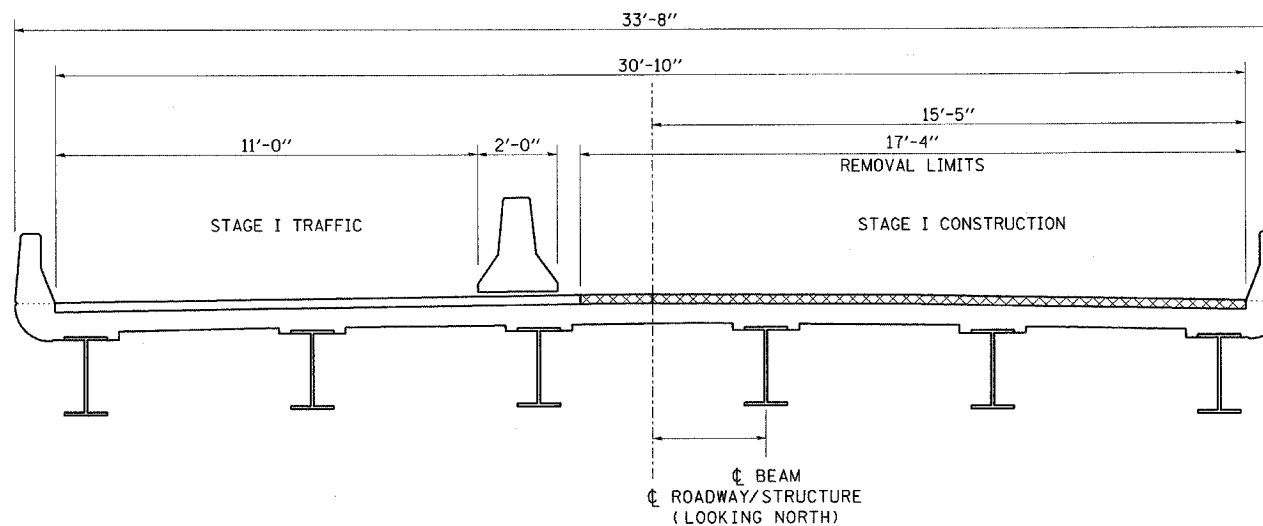



TRAFFIC CONTROL DETAILS NOT SHOWN
 ARE TO CONFORM WITH STANDARD
 701321

STAGE I CONSTRUCTION

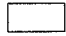

-  WORK AREA
-  HOT-MIX ASPHALT SURFACE REMOVAL
-  HOT-MIX WEARING SURFACE & WATER PROOFING MEMBRANE
-  ATTENUATOR
-  TYPE III BARRICADE
-  TEMPORARY CONCRETE BARRIER

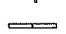
FILE NAME =	USER NAME = #USER#	DESIGNED -	REVISED -
#FILE#		DRAWN -	REVISED -
	PLOT SCALE = #SCALE#	CHECKED -	REVISED -
	PLOT DATE = #DATE#	DATE -	REVISED -

STATE OF ILLINOIS
 DEPARTMENT OF TRANSPORTATION

STAGE I CONSTRUCTION S.N. 026-0049

SCALE: SHEET NO. OF SHEETS STA. TO STA.

F.A.P. RTE. 752	SECTION	COUNTY	TOTAL SHEETS	SHEET NO.
		FAYETTE	6	6
CONTRACT NO. 74276			FED. ROAD DIST. NO. ILLINOIS FED. AID PROJECT	