

F.A.U. RTE.	SECTION	COUNTY	TOTAL SHEETS	SHEET NO.
9296	65BR	MONROE	22	8
STA.		TO STA.		
FED. ROAD DIST. NO. 8		ILLINOIS FED. AID PROJECT		

CONTRACT NO. 76387

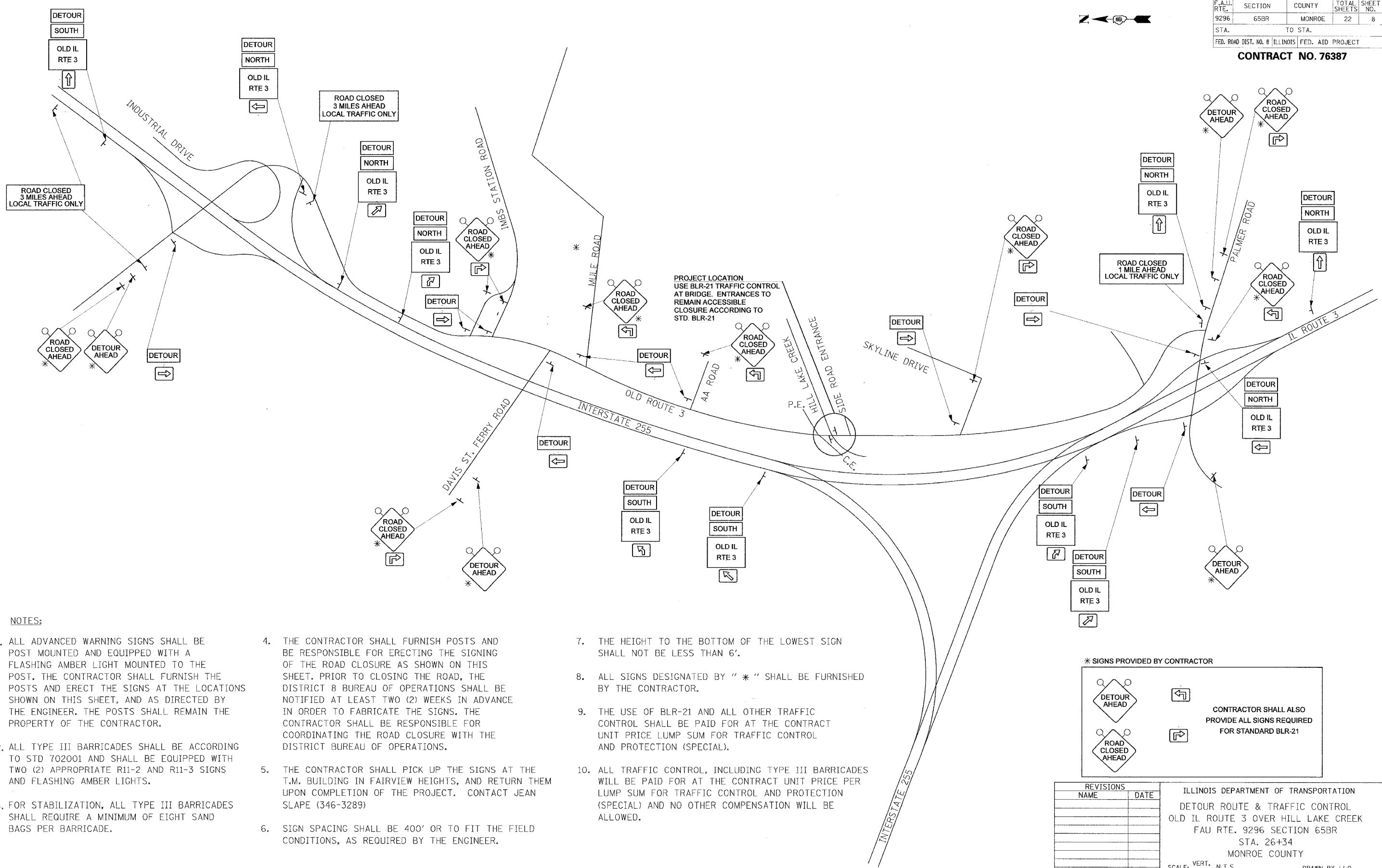

NOTES:

1. ALL ADVANCED WARNING SIGNS SHALL BE POST MOUNTED AND EQUIPPED WITH A FLASHING AMBER LIGHT MOUNTED TO THE POST. THE CONTRACTOR SHALL FURNISH THE POSTS AND ERECT THE SIGNS AT THE LOCATIONS SHOWN ON THIS SHEET, AND AS DIRECTED BY THE ENGINEER. THE POSTS SHALL REMAIN THE PROPERTY OF THE CONTRACTOR.
2. ALL TYPE III BARRICADES SHALL BE ACCORDING TO STD 702001 AND SHALL BE EQUIPPED WITH TWO (2) APPROPRIATE R11-2 AND R11-3 SIGNS AND FLASHING AMBER LIGHTS.
3. FOR STABILIZATION, ALL TYPE III BARRICADES SHALL REQUIRE A MINIMUM OF EIGHT SAND BAGS PER BARRICADE.
4. THE CONTRACTOR SHALL FURNISH POSTS AND BE RESPONSIBLE FOR ERECTING THE SIGNING OF THE ROAD CLOSURE AS SHOWN ON THIS SHEET. PRIOR TO CLOSING THE ROAD, THE DISTRICT 8 BUREAU OF OPERATIONS SHALL BE NOTIFIED AT LEAST TWO (2) WEEKS IN ADVANCE IN ORDER TO FABRICATE THE SIGNS. THE CONTRACTOR SHALL BE RESPONSIBLE FOR COORDINATING THE ROAD CLOSURE WITH THE DISTRICT BUREAU OF OPERATIONS.
5. THE CONTRACTOR SHALL PICK UP THE SIGNS AT THE T.M. BUILDING IN FAIRVIEW HEIGHTS, AND RETURN THEM UPON COMPLETION OF THE PROJECT. CONTACT JEAN SLAPE (346-3289)
6. SIGN SPACING SHALL BE 400' OR TO FIT THE FIELD CONDITIONS, AS REQUIRED BY THE ENGINEER.
7. THE HEIGHT TO THE BOTTOM OF THE LOWEST SIGN SHALL NOT BE LESS THAN 6'.
8. ALL SIGNS DESIGNATED BY " \* " SHALL BE FURNISHED BY THE CONTRACTOR.
9. THE USE OF BLR-21 AND ALL OTHER TRAFFIC CONTROL SHALL BE PAID FOR AT THE CONTRACT UNIT PRICE LUMP SUM FOR TRAFFIC CONTROL AND PROTECTION (SPECIAL).
10. ALL TRAFFIC CONTROL, INCLUDING TYPE III BARRICADES WILL BE PAID FOR AT THE CONTRACT UNIT PRICE PER LUMP SUM FOR TRAFFIC CONTROL AND PROTECTION (SPECIAL) AND NO OTHER COMPENSATION WILL BE ALLOWED.

\* SIGNS PROVIDED BY CONTRACTOR

		CONTRACTOR SHALL ALSO PROVIDE ALL SIGNS REQUIRED FOR STANDARD BLR-21

REVISIONS	
NAME	DATE

ILLINOIS DEPARTMENT OF TRANSPORTATION  
 DETOUR ROUTE & TRAFFIC CONTROL  
 OLD IL ROUTE 3 OVER HILL LAKE CREEK  
 FAU RTE. 9296 SECTION 65BR  
 STA. 26+34  
 MONROE COUNTY

SCALE: VERT. N.T.S.  
 HORIZ. N.T.S.  
 DATE: JANUARY 2007

DRAWN BY LLQ  
 CHECKED BY LEL