

F.A.U. RTE.	SECTION	COUNTY	TOTAL SHEETS	SHEET NO.
9269	65BR	MONROE	22	19
STA. 25+76.16		TO STA. 26+00.00		
FED. ROAD DIST. NO. 8		ILLINOIS FED. AID PROJECT		

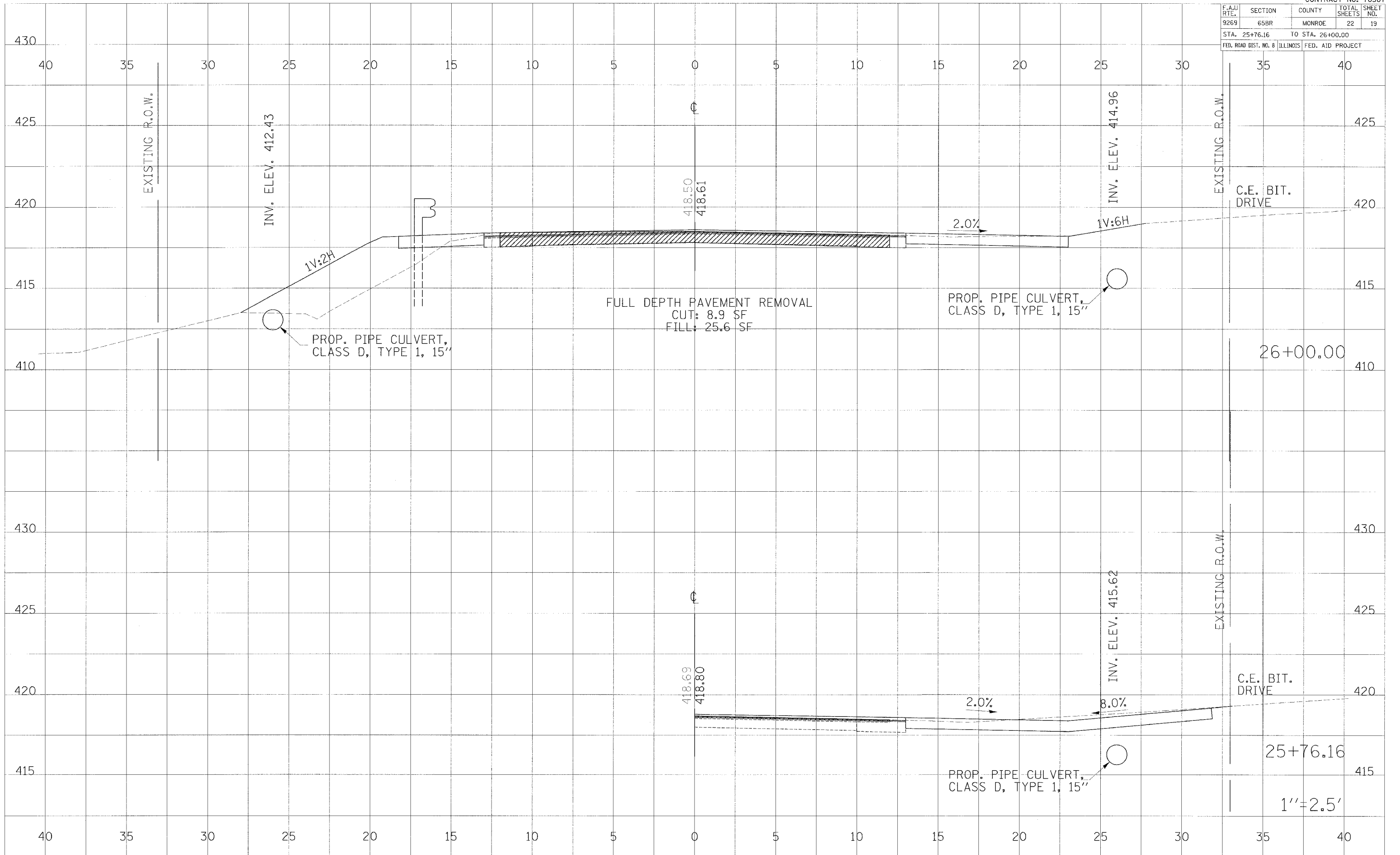

FIN. DATE _____ BY _____ DATE _____
 SURVEYED _____
 5. PLOT _____
 NOTE BOOK _____
 AREAS CHECKED _____
 NO. _____

ORIGINAL SURVEY _____ BY _____ DATE _____
 5. PLOT _____
 NOTE BOOK _____
 AREAS CHECKED _____
 NO. _____

PLOT DATE = #DATE#
 FILE NAME = #FILE#
 PLOT SCALE = #SCALE#
 USER NAME = #USER#

26+00.00

25+76.16

1"=2.5'

FULL DEPTH PAVEMENT REMOVAL
 CUT: 8.9 SF
 FILL: 25.6 SF

PROP. PIPE CULVERT,
 CLASS D, TYPE 1, 15"

PROP. PIPE CULVERT,
 CLASS D, TYPE 1, 15"

PROP. PIPE CULVERT,
 CLASS D, TYPE 1, 15"

INV. ELEV. 412.43

418.50
418.61

INV. ELEV. 414.96

INV. ELEV. 415.62

EXISTING R.O.W.

EXISTING R.O.W.

EXISTING R.O.W.

C.E. BIT. DRIVE

C.E. BIT. DRIVE

2.0%

1V:6H

2.0%

8.0%

1V:2H