

F.A.P. RTE.	SECTION	COUNTY	TOTAL SHEETS NO.	SHEET NO.
310	60-15HB	MADISON	185	32
STA. 9+950 TO STA. 10+125				
FED. ROAD DIST. NO.		ILLINOIS FED. AID PROJECT		
CONTRACT NO. 76626				

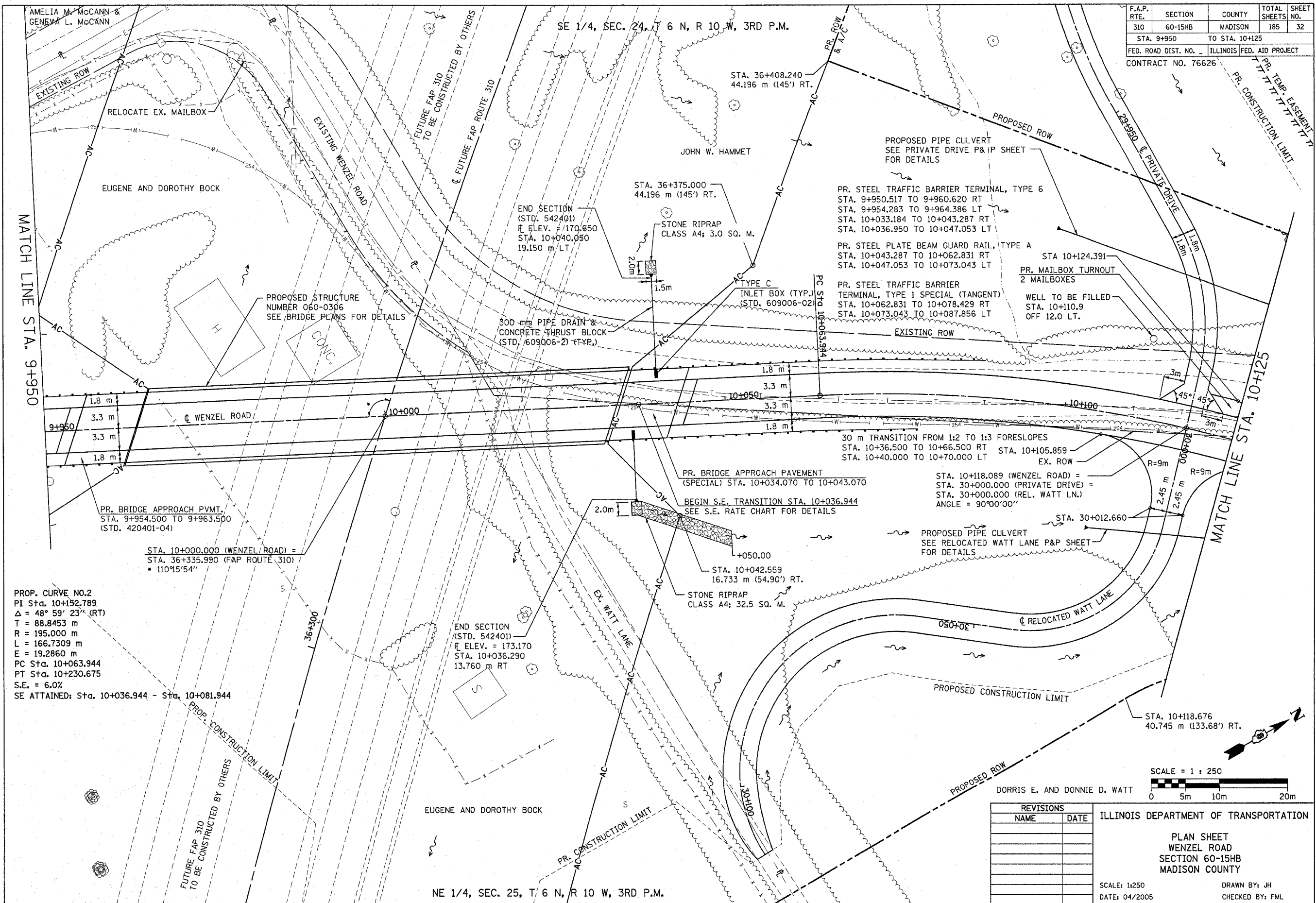

PROP. CURVE NO.2
 PI Sta. 10+152.789
 $\Delta = 48^\circ 59' 23''$ (RT)
 $T = 88.8453$ m
 $R = 195.000$ m
 $L = 166.7309$ m
 $E = 19.2860$ m
 PC Sta. 10+063.944
 PT Sta. 10+230.675
 S.E. = 6.0%
 SE ATTAINED: Sta. 10+036.944 - Sta. 10+081.944

REVISIONS	
NAME	DATE

ILLINOIS DEPARTMENT OF TRANSPORTATION
 PLAN SHEET
 WENZEL ROAD
 SECTION 60-15HB
 MADISON COUNTY
 SCALE: 1:250
 DATE: 04/2005
 DRAWN BY: JH
 CHECKED BY: FML