

F.A.R. NO.	SECTION	COUNTY	TOTAL SHEETS	SHEET NO.
789	IRS-1	MADISON	26	18
STA. 114+00		TO STA. 124+00		

EXISTING CONDITIONS:

PLAN	DATE	BY
SWR		
PLT		
CHK		
APP		

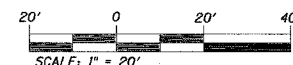
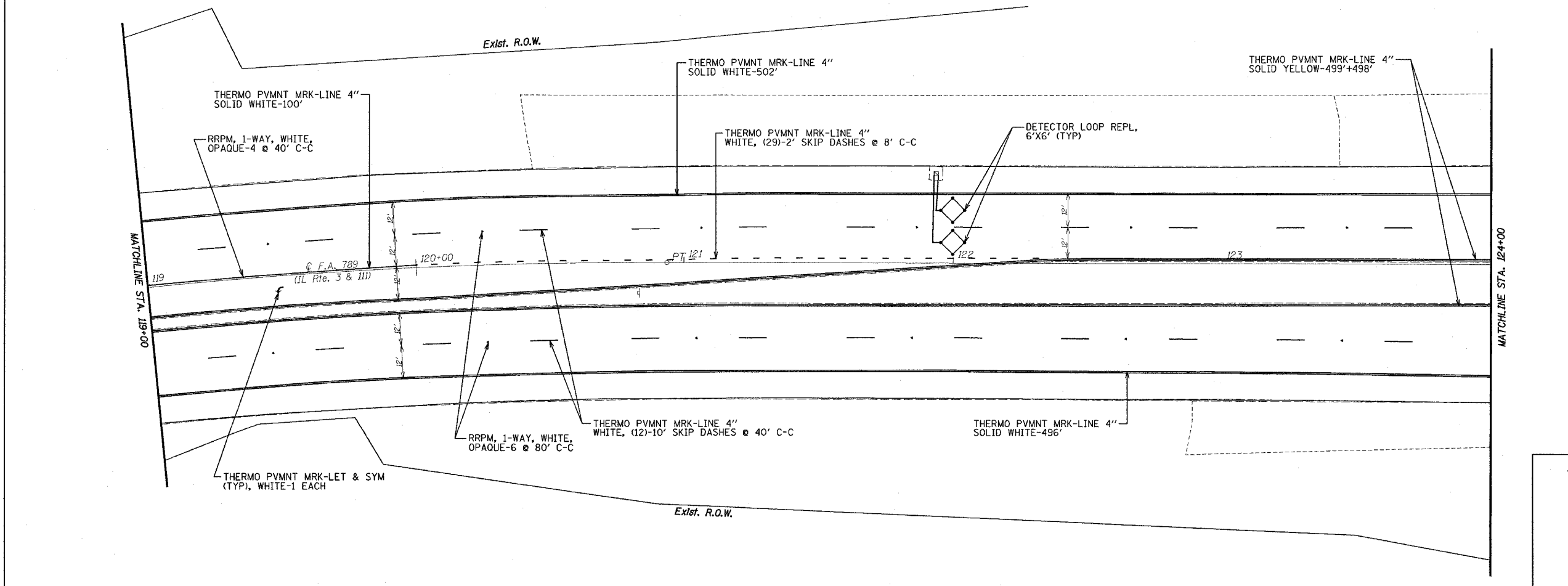
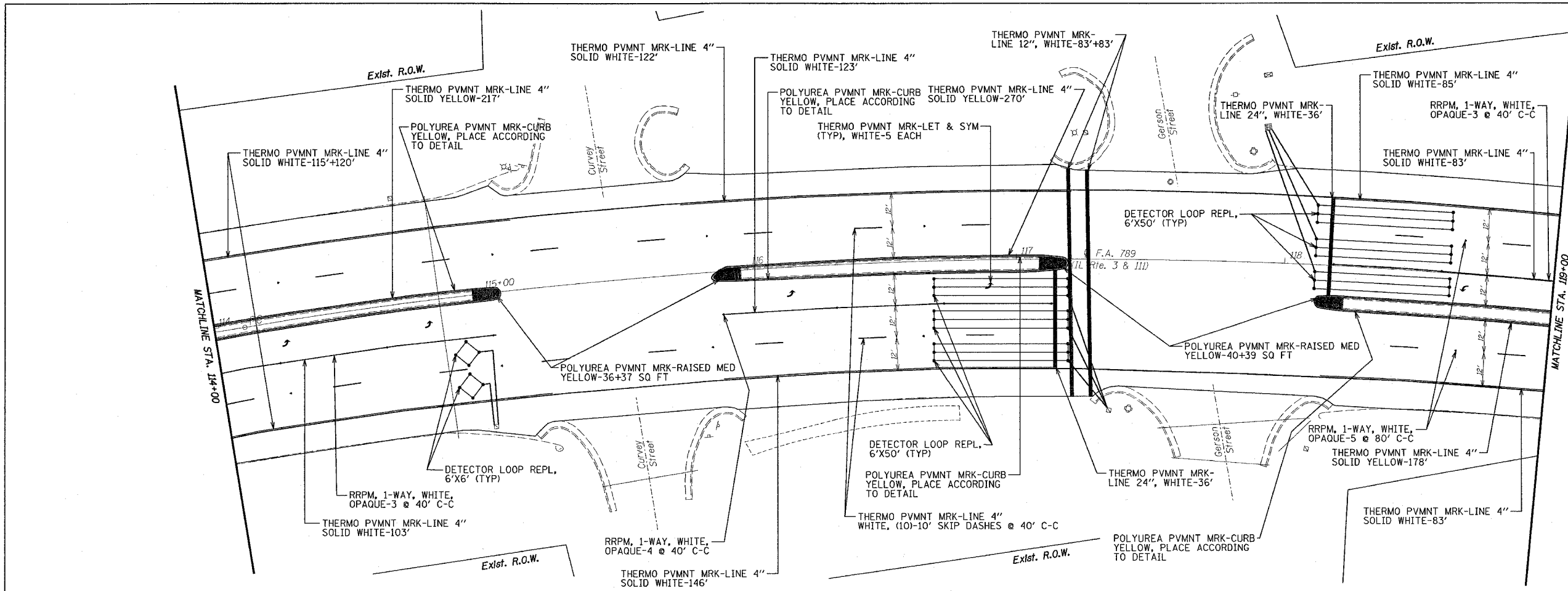

ILLINOIS DEPARTMENT OF TRANSPORTATION

**PAVEMENT MARKING  
LOCATION #2**

F.A. 789 (IL RTE. 3 & 111)  
SECTION IRS-1  
MADISON COUNTY

PLOT DATE: 4/5/2007

4/5/2007  
c:\pavement\789\18.dwg  
789