

THOMAS & BETTY VANWIKLE  
NE 1/4, SEC 31, T. 6 S., R. 7 E., 3RD P.M.

THOMAS & BETTY VANWIKLE  
SE 1/4, SEC 31, T. 6 S., R. 7 E., 3RD P.M.

FAP RTE	SECTION	COUNTY	TOTAL SHEETS	SHEET NO.
776	(116BR-1)B-1	HAMILTON	140	8
STA. 508+50		TO STA. 523+50		
FED. ROAD DIST. NO.		ILLINOIS CONTRACT NO. 94998		

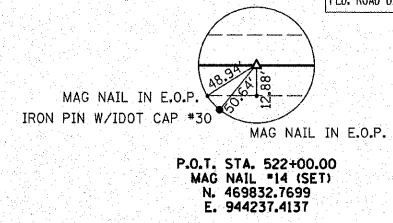
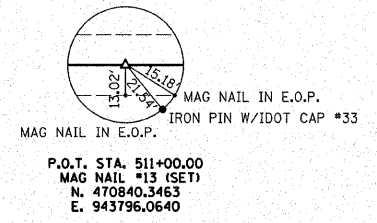
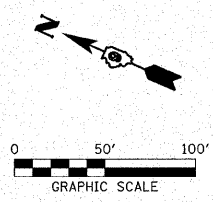

PLAN	REVISIONS	DATE

PROFILE	REVISIONS	DATE

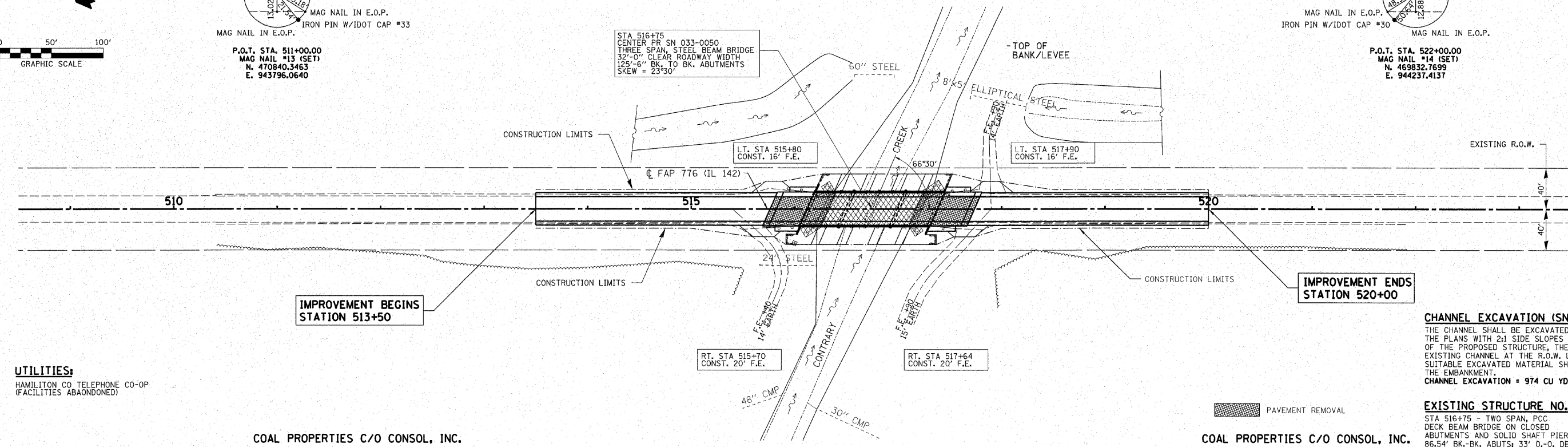

**UTILITIES:**  
HAMILTON CO TELEPHONE CO-OP  
(FACILITIES ABAANDONED)

**CHANNEL EXCAVATION (SN 0050)**  
THE CHANNEL SHALL BE EXCAVATED AS SHOWN IN THE PLANS WITH 2:1 SIDE SLOPES WITHIN THE LIMITS OF THE PROPOSED STRUCTURE, THEN TAPER TO THE EXISTING CHANNEL AT THE R.O.W. LINES. ONLY SUITABLE EXCAVATED MATERIAL SHALL BE USED IN THE EMBANKMENT.  
CHANNEL EXCAVATION = 974 CU YD

**EXISTING STRUCTURE NO. 033-0020**  
STA 516+75 - TWO SPAN, PCC DECK BEAM BRIDGE ON CLOSED ABUTMENTS AND SOLID SHAFT PIERS. 86.5' BK.-BK. ABUTS; 33' 0.-0. DECK  
REMOVAL OF EXISTING STRUCTURES NO. 1 = 1 EACH

COAL PROPERTIES C/O CONSOL. INC.  
NE 1/4, SEC 31, T. 6 S., R. 7 E., 3RD P.M.

COAL PROPERTIES C/O CONSOL. INC.  
SE 1/4, SEC 31, T. 6 S., R. 7 E., 3RD P.M.

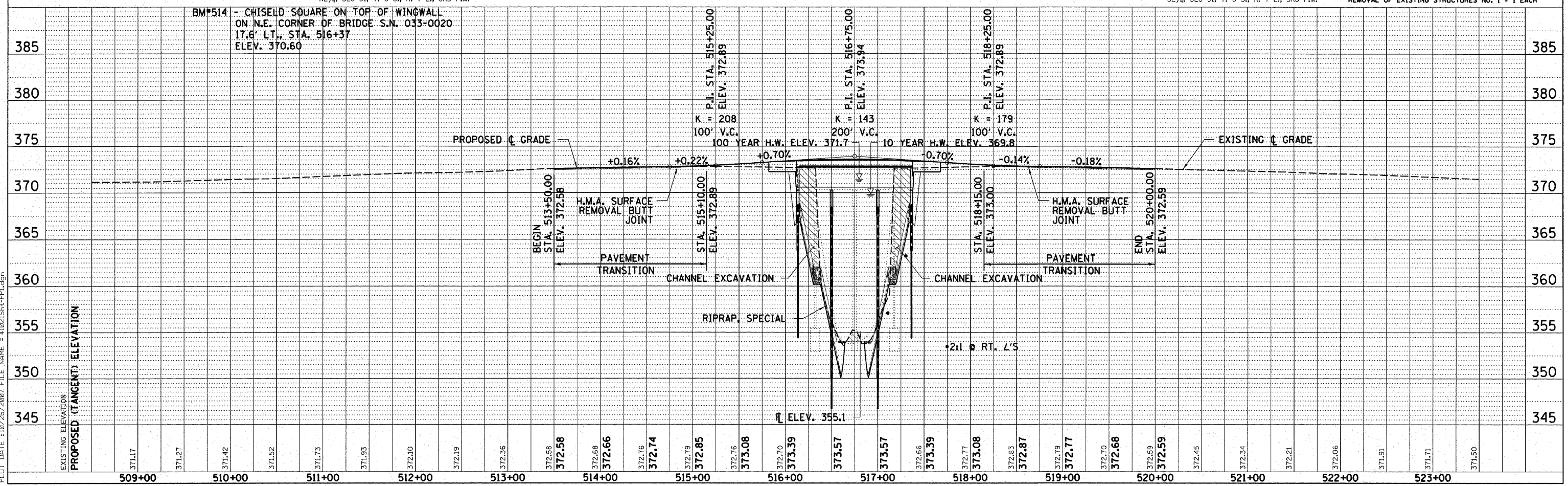

PLOT DATE: 10/26/2007 FILE NAME: 41023.Sht+PFI.dgn