

F.A.P. RTE.	SECTION	COUNTY	TOTAL SHEETS	SHEET NO.
776	(116BR-1)B-1	HAMILTON	140	15
STA.		TO STA.		
FED. ROAD DIST. NO.		ILLINOIS	FED. AID PROJECT	

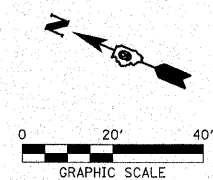
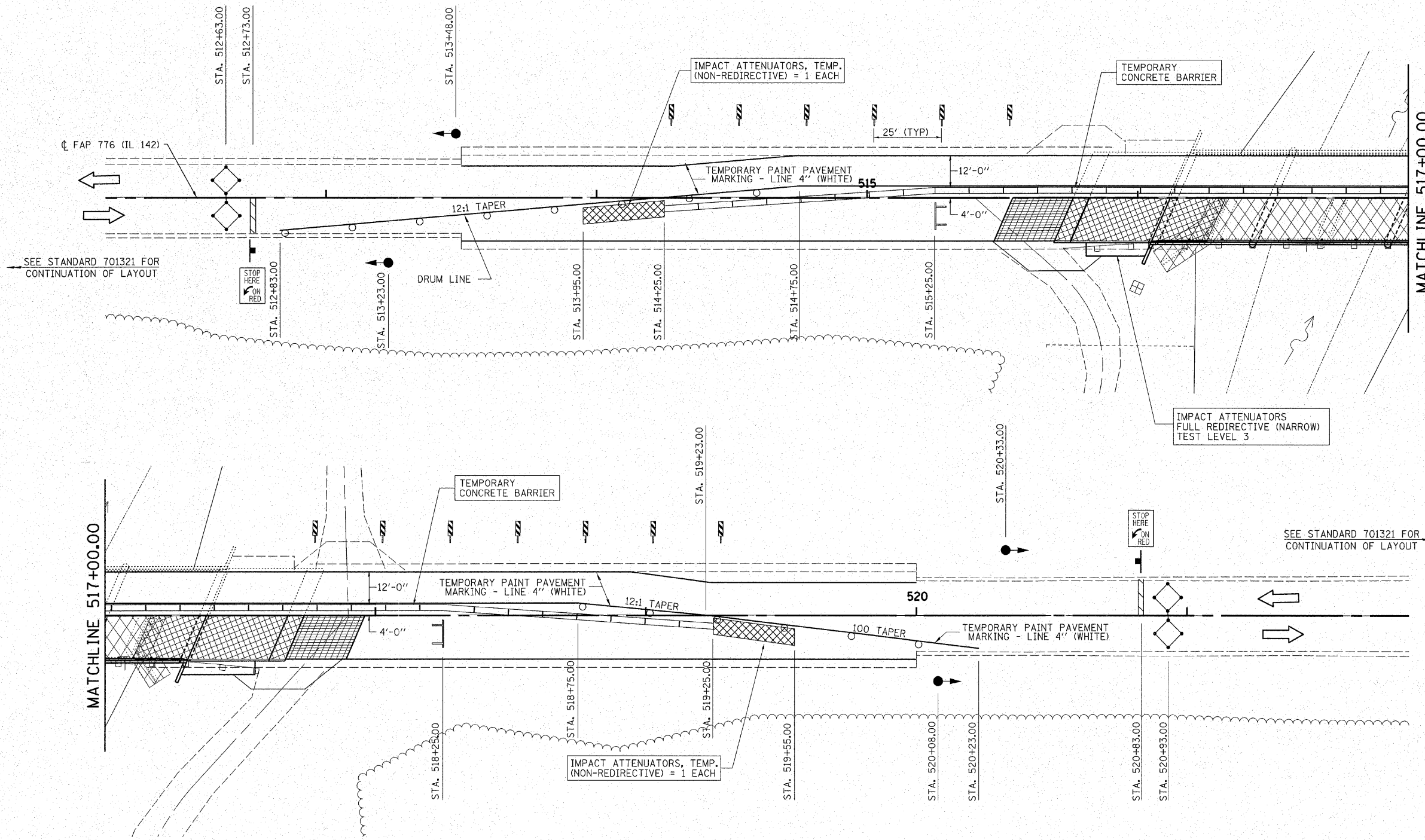

MATCHLINE 517+00.00

MATCHLINE 517+00.00

SEE STANDARD 701321 FOR CONTINUATION OF LAYOUT

SEE STANDARD 701321 FOR CONTINUATION OF LAYOUT

- LEGEND**
- HOT MIX ASPHALT BASE COURSE 1 1/2" (WIDENING)
  - BRIDGE REMOVAL
  - PAVEMENT REMOVAL
  - TEMPORARY RAMP

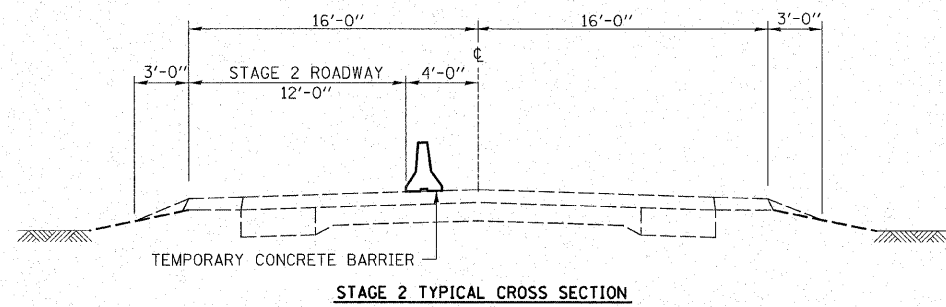

PLOT DATE = 10/26/2007  
FILE NAME = 41821Shr-stage2-B1.dgn  
PLOT SCALE =  
USER NAME =

**HAMPTON, LENZINI & RENWICK, INC.**  
CIVIL & STRUCTURAL ENGINEERS

**HLR**

3085 STEVENSON DRIVE, SUITE 201  
SPRINGFIELD, ILLINOIS 62703  
(217) 548-3400

ELGIN • SPRINGFIELD

PROJECT NUMBER: 12-41-0021-i    DATE: 10/23/07  
DESIGNED: L.F.S.    CHECKED: S.W.M.    DRAWN: W.J.S.

**MAINTENANCE OF TRAFFIC, STAGE 2**  
SN 033-0050  
F.A.P. ROUTE 776 (IL 142)  
SECTION (116BR-1, BR-2, BR-3)B-1  
HAMILTON COUNTY