

STATE OF ILLINOIS  
DEPARTMENT OF TRANSPORTATION

ROUTE NO. F.A.P. 776	SECTION (116BR -2)B-1	COUNTY HAMILTON	TOTAL SHEETS 140	SHEET NO. 51	SHEET NO. 7 21 SHEETS
FED. ROAD DIST. NO. 7		ILLINOIS	FED. AID PROJECT-		

Contract #78006

EAST CURB LINE

Location	Station	Offset	Theoretical Grade Elevations
End of N. Approach Pvmf.	538+16.20	-16.000	370.965
A	538+26.20	-16.000	370.991
B	538+36.20	-16.000	371.019
Bk. N. Abutment	538+46.20	-16.000	371.048

EAST EDGE OF PAVEMENT

Location	Station	Offset	Theoretical Grade Elevations
End of N. Approach Pvmf.	538+16.20	-12.000	371.045
A	538+26.20	-12.000	371.071
B	538+36.20	-12.000	371.099
Bk. N. Abutment	538+46.20	-12.000	371.128

STAGE CONSTRUCTION LINE

Location	Station	Offset	Theoretical Grade Elevations
End of N. Approach Pvmf.	538+16.20	-2.000	371.195
A	538+26.20	-2.000	371.221
B	538+36.20	-2.000	371.249
Bk. N. Abutment	538+46.20	-2.000	371.278

☉ STRUCTURE & PG

Location	Station	Offset	Theoretical Grade Elevations
End of N. Approach Pvmf.	538+16.20	0	371.225
A	538+26.20	0	371.251
B	538+36.20	0	371.279
Bk. N. Abutment	538+46.20	0	371.308

WEST EDGE OF PAVEMENT

Location	Station	Offset	Theoretical Grade Elevations
End of N. Approach Pvmf.	538+16.20	12.000	371.045
A	538+26.20	12.000	371.071
B	538+36.20	12.000	371.099
Bk. N. Abutment	538+46.20	12.000	371.128

WEST CURB LINE

Location	Station	Offset	Theoretical Grade Elevations
End of N. Approach Pvmf.	538+16.20	16.000	370.965
A	538+26.20	16.000	370.991
B	538+36.20	16.000	371.019
Bk. N. Abutment	538+46.20	16.000	371.048

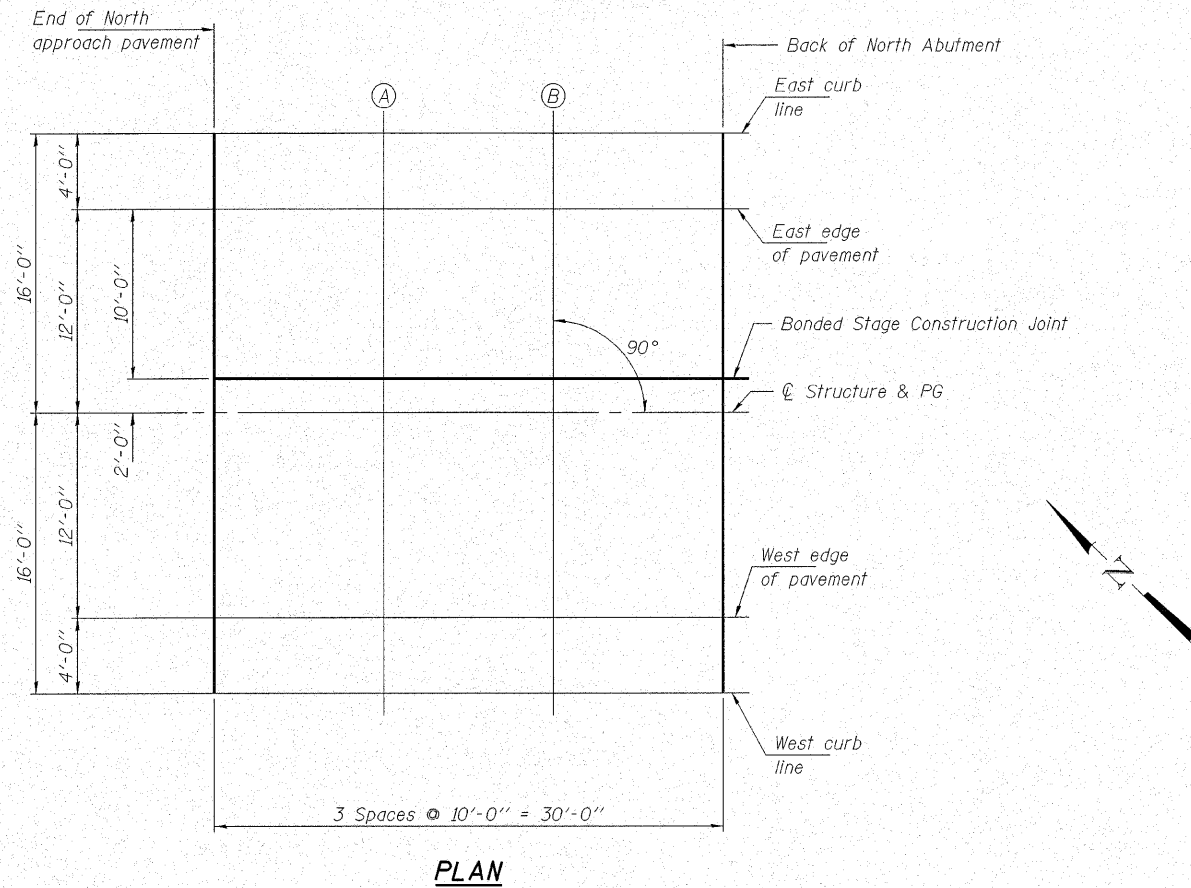

PLAN

PLOT DATE: 10/26/2007 FILE NAME: 0330051-78006-41021brdgn0051.dgn

<p><b>HAMPTON, LENZINI &amp; RENWICK, INC.</b> CIVIL &amp; STRUCTURAL ENGINEERS LAND SURVEYORS</p> <p>3085 STEVENSON DRIVE, SUITE 201 SPRINGFIELD, ILLINOIS 62703 (217) 546-3400</p> <p>ELGIN • SPRINGFIELD</p>	<p><b>NORTH APPROACH SLAB ELEVATIONS</b></p> <p><b>IL RTE. 142 OVER CONTRARY CREEK (NORTH OVERFLOW)</b></p> <p><b>F.A.P. ROUTE 776 - SECTION (116BR-2)B-1</b></p> <p><b>HAMILTON COUNTY</b></p> <p><b>STRUCTURE NO. 033-0051 / STATION 539+14.20</b></p>	
	<p>PROJECT NUMBER: 12-41-0021-1</p> <p>DESIGNED: S.M.S.</p>	<p>DATE: 09/25/07</p> <p>CHECKED: S.W.M.</p>