

F.A.P.	SECTION	COUNTY	TOTAL SHEETS	SHEET NO.
776	(116BR-3)B-1	HAMILTON	140	128
STA. 517+90.00		TO STA. 519+00.00		
FED. ROAD DIST. NO.		ILLINOIS FED. AID PROJECT		
65	70	75	80	

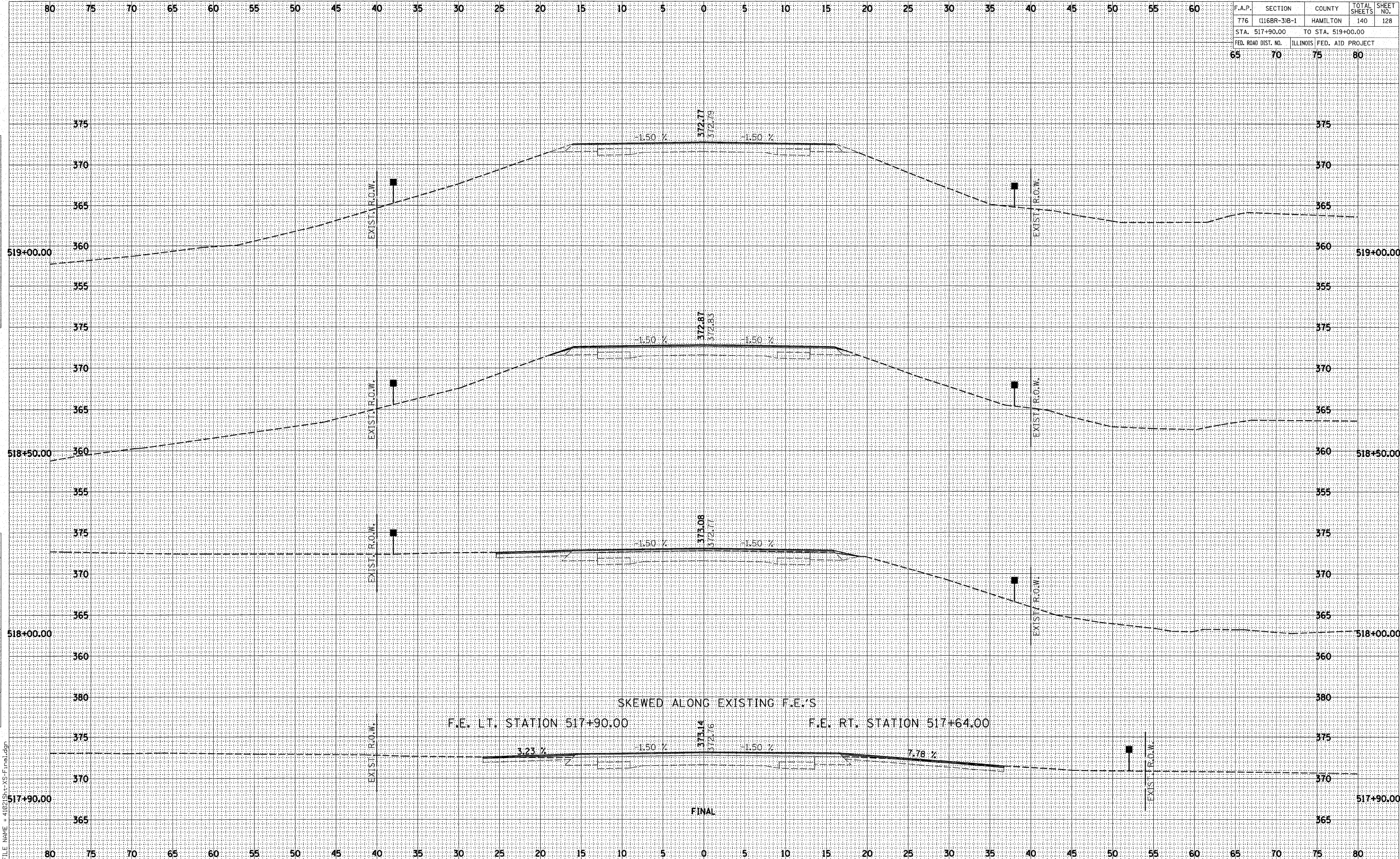

DATE	BY
ORIGINAL SURVEY	SURVEYED
NOTE BOOK	PLOTTED
NO.	AREAS CHECKED

DATE	BY
ORIGINAL SURVEY	SURVEYED
NOTE BOOK	PLOTTED
NO.	AREAS CHECKED

PLOT DATE : 10/26/2007  
 FILE NAME = 41021st-XS-F.ino.dgn

SKewed ALONG EXISTING F.E.'S  
 F.E. LT. STATION 517+90.00  
 F.E. RT. STATION 517+64.00

FINAL