

F.A. RTE.	SECTION	COUNTY	TOTAL SHEETS	SHEET NO.
1362	06-00047-00-LS	COOK	59	10
STA. 22+50		TO STA. 35+00		
FED. ROAD DIST. NO.		ILLINOIS FED. AID PROJECT		

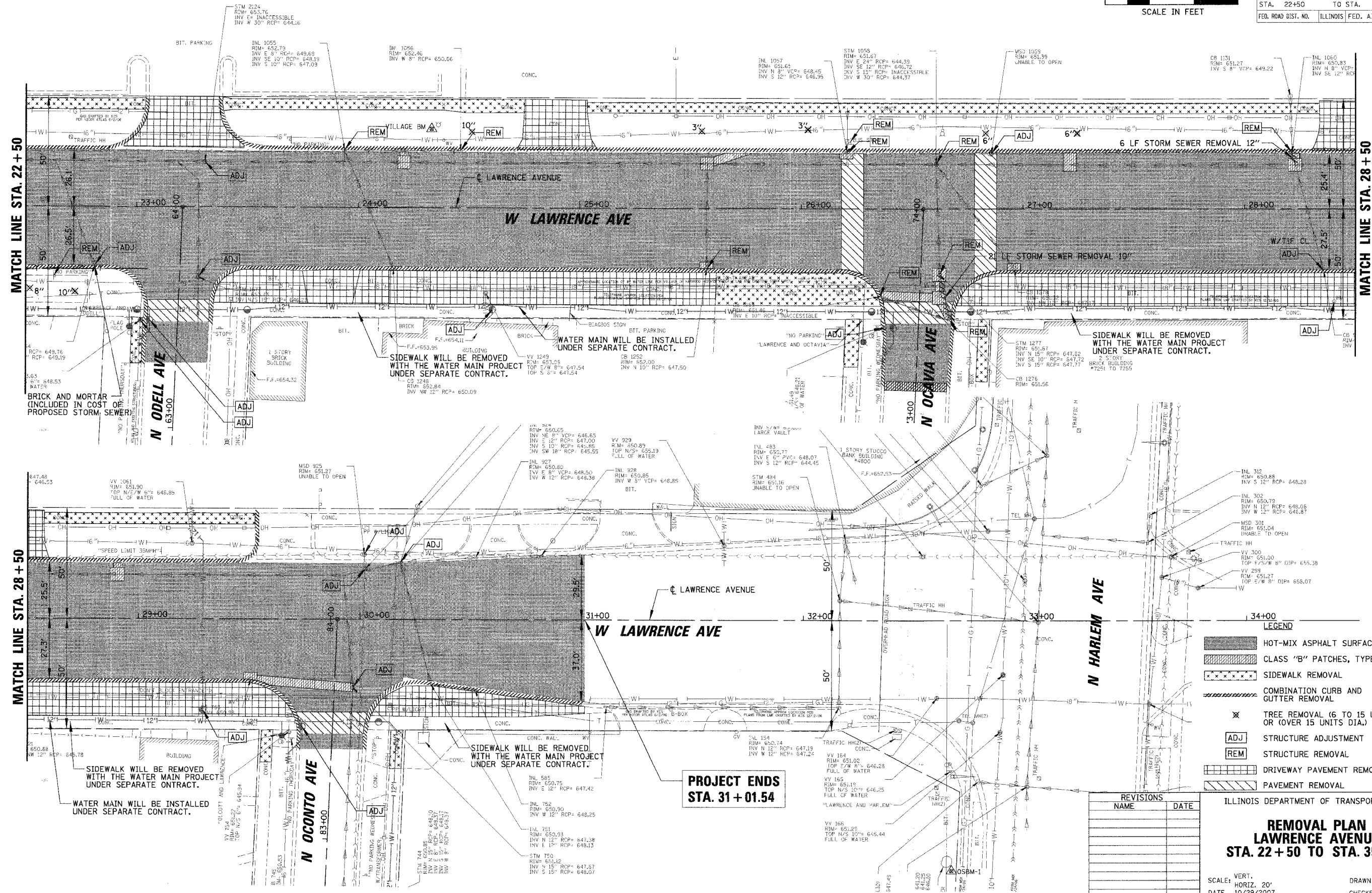
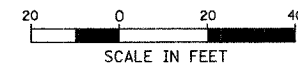

MATCH LINE STA. 22 + 50

MATCH LINE STA. 28 + 50

MATCH LINE STA. 28 + 50

**PROJECT ENDS
STA. 31 + 01.54**

LEGEND

- HOT-MIX ASPHALT SURFACE REMOVAL 2"
- CLASS "B" PATCHES, TYPE I-IV, 9"
- SIDEWALK REMOVAL
- COMBINATION CURB AND GUTTER REMOVAL
- TREE REMOVAL (6 TO 15 UNITS DIA.) OR (OVER 15 UNITS DIA.)
- STRUCTURE ADJUSTMENT
- STRUCTURE REMOVAL
- DRIVEWAY PAVEMENT REMOVAL
- PAVEMENT REMOVAL

REVISIONS

NO.	NAME	DATE

ILLINOIS DEPARTMENT OF TRANSPORTATION
**REMOVAL PLAN
LAWRENCE AVENUE
STA. 22 + 50 TO STA. 35 + 00**

SCALE: VERT. 1"=20'
HORIZ. 1"=40'
DATE 10/29/2007
DRAWN BY PMM
CHECKED BY LMF

PLOT DATE = 10/29/2007
FILE NAME = N:\HW\000\HELD\015\0627\9\CVL\1\0627\9\REM2.PLN
PLOT NAME = P:\PACNELLI
USER NAME = P:\PACNELLI