

CONTRACT NO. 83905				
F.A. RTE.	SECTION	COUNTY	TOTAL SHEETS	SHEET NO.
06-00047-00-LS	COOK	59	12	
STA. 16+50		TO STA. 22+50		
FED. ROAD DIST. NO. ILLINOIS FED. AID PROJECT				

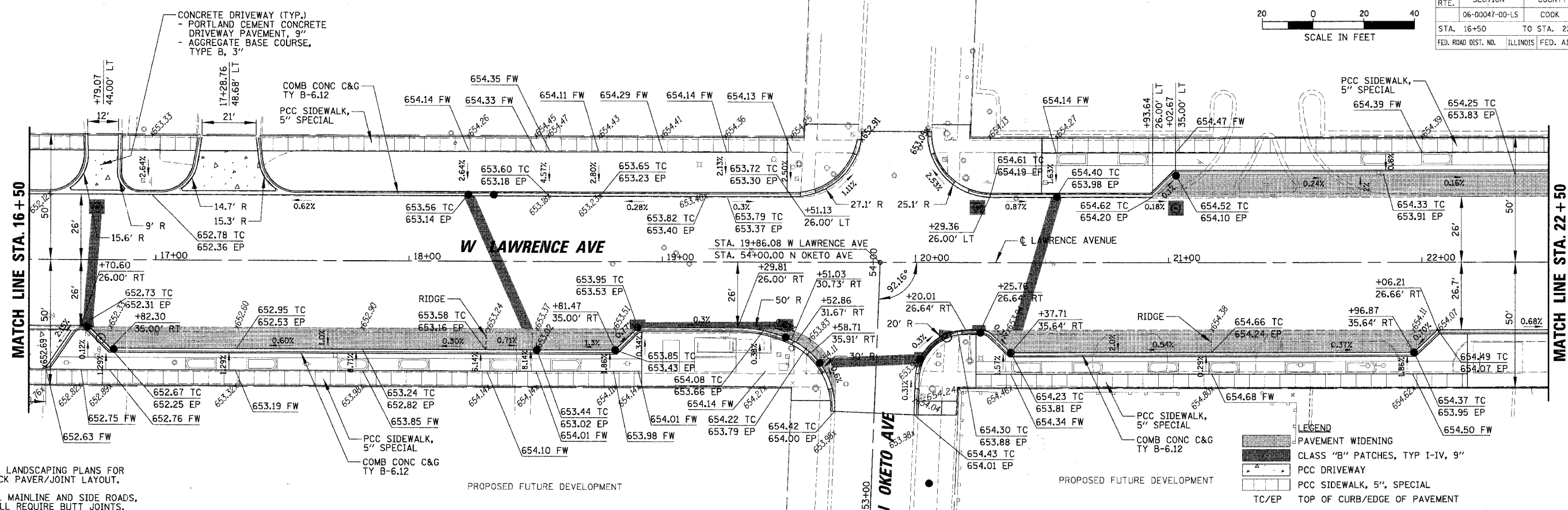
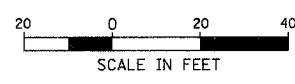

NOTE:
 1. SEE LANDSCAPING PLANS FOR BRICK PAVER/JOINT LAYOUT.
 2. ALL MAINLINE AND SIDE ROADS, SHALL REQUIRE BUTT JOINTS.

LEGEND

	PAVEMENT WIDENING
	CLASS "B" PATCHES, TYP I-IV, 9"
	PCC DRIVEWAY
	PCC SIDEWALK, 5", SPECIAL
	TC/EP TOP OF CURB/EDGE OF PAVEMENT
	FW/BW FRONT OF WALK/BACK OF WALK

DATE	BY
DATE	BY
DATE	BY

DATE	BY
DATE	BY
DATE	BY

PLT DATE = 11/29/2007
 FILE NAME = W:\PROJECTS\83905\1627\1627.PPP
 PLT SCALE = 20
 USER NAME = PMGNELLI

