

LEGEND OF SYMBOLS	
	PROPOSED DECORATIVE LIGHT POLE, ALUMINUM, 12' MOUNTING HEIGHT WITH DECORATIVE ACORN STYLE LUMINAIRE, SODIUM VAPOR, TENON MOUNT, 70 WATT
	EXISTING 35' MOUNTING HEIGHT POLE WITH 8' MAST ARM AND 310 WATT HIGH PRESSURE SODIUM LAMP (GE451002.IES)
	EXISTING 35' MOUNTING HEIGHT COMBINATION TRAFFIC/LIGHT POLE WITH 12' MAST ARM AND 400 WATT HIGH PRESSURE SODIUM LAMP (GE451002.IES)
	PROPOSED CONTROL CENTER
	PROPOSED UNIT DUCT WITH 3-1/8" No. 4 & 1-1/8" No. 6 GROUND, 600V (XLP-TYPE USE), 1 1/2" DIAMETER OR AS NOTED, BORED & PULLED OR AS NOTED
	PROPOSED RIGID GALVANIZED STEEL CONDUIT IN TRENCH OR PUSHED AS NOTED
	CONTROLLER IDENTIFICATION (TYP.)
	CIRCUIT NUMBER (TYP.)
	POLE NUMBER (TYP.)
	SET BACK FROM BACK OF CURB (TYP.)
	STATION NUMBER (TYP.)

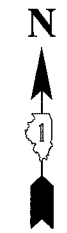
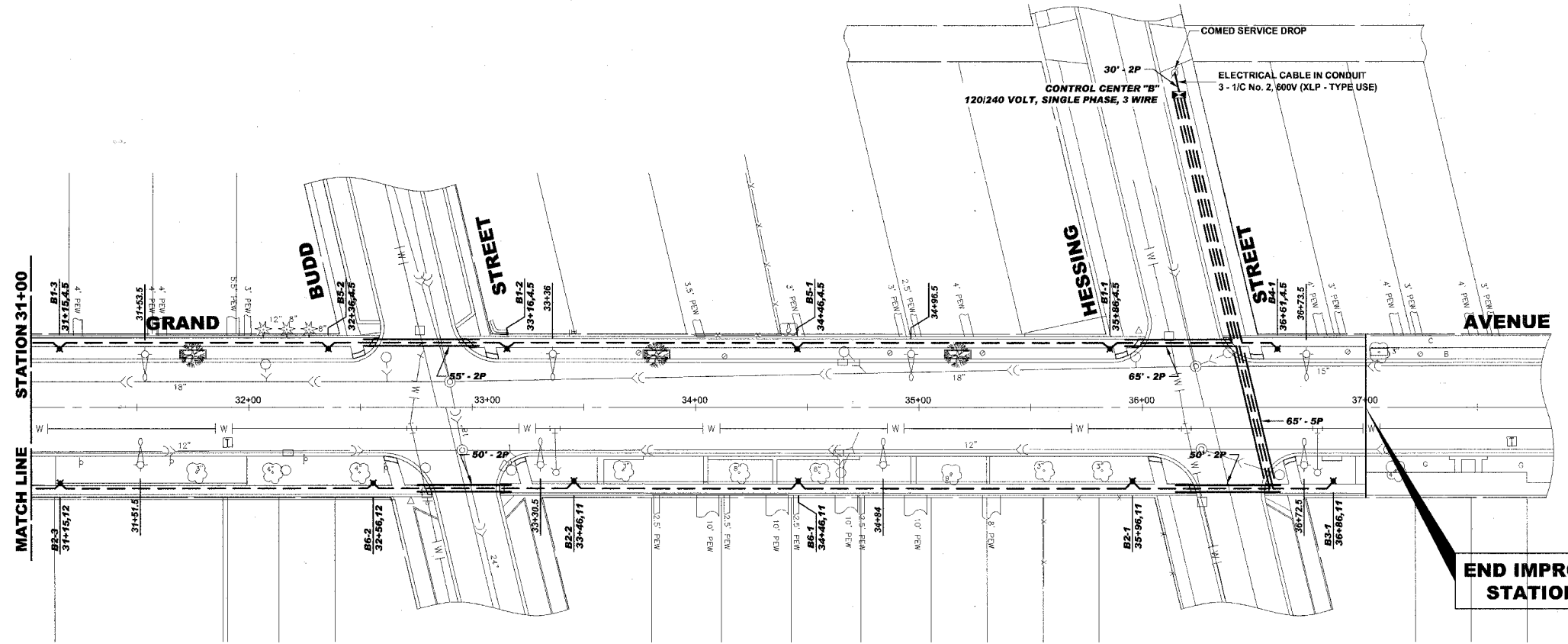

**END IMPROVEMENT  
STATION 37+00**

revised -12/21/07

Drawing file: W:\Projects\75006033 - Grand Ave Streetscape\GRAND\_AVE-Lighting.dwg Dec 13, 2007 - 11:44am

	◆ Civil Engineers	9933 Roosevelt Road
	◆ Municipal Consultants	Westchester, Illinois 60154-2780
	◆ Established 1911	Phone: 708/865-0300
		Fax: 708/865-1212

**GRAND AVENUE STREETScape PROJECT  
VILLAGE OF RIVER GROVE, ILLINOIS**

**GRAND AVENUE LIGHTING PLAN**

SCALE:	1"=30'	SHEET	20
DRAWN BY:	LEV/ECW/MK		
BOOK NO.:	1441,1443,1516	OF	35
DATE:	10/15/07		
REVISION:	Addendum #1 - 12/14/07	E.H.E. NO.:	760-06-03320