

EXISTING TOPOGRAPHY

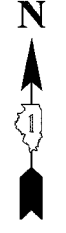

PROPOSED IMPROVEMENT

NOTE:
USE PORTLAND CEMENT CONCRETE BASE COURSE, 3", FOR DECORATIVE BRICK SIDEWALK, WHERE DECORATIVE BRICK SIDEWALK BUTTS AGAINST CURB

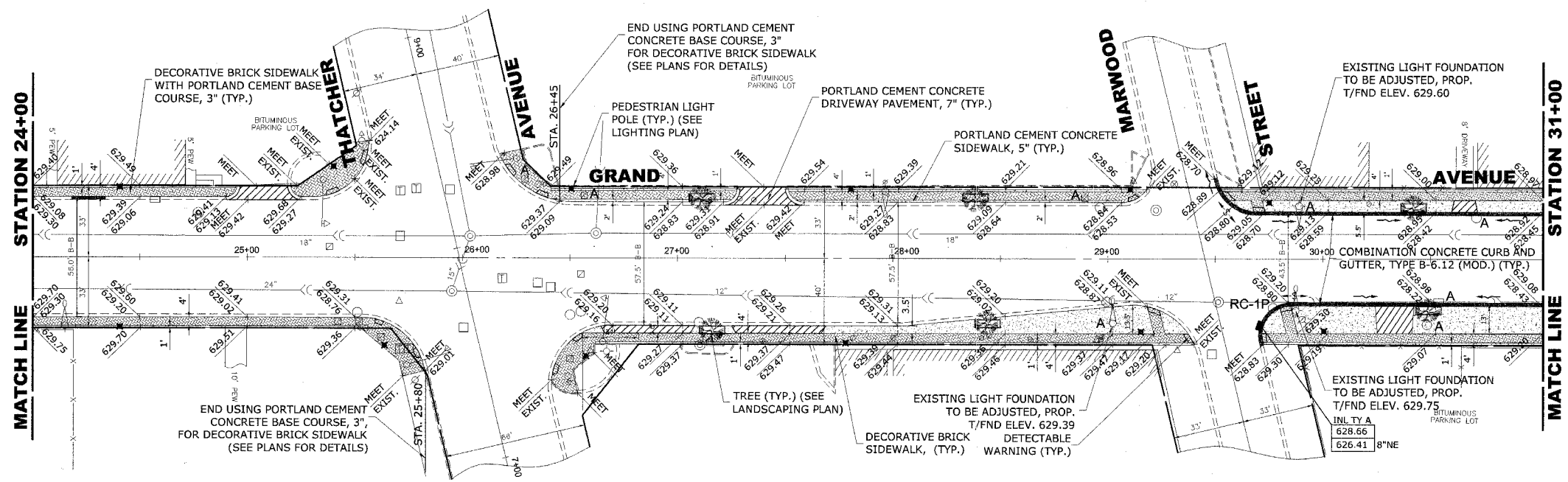
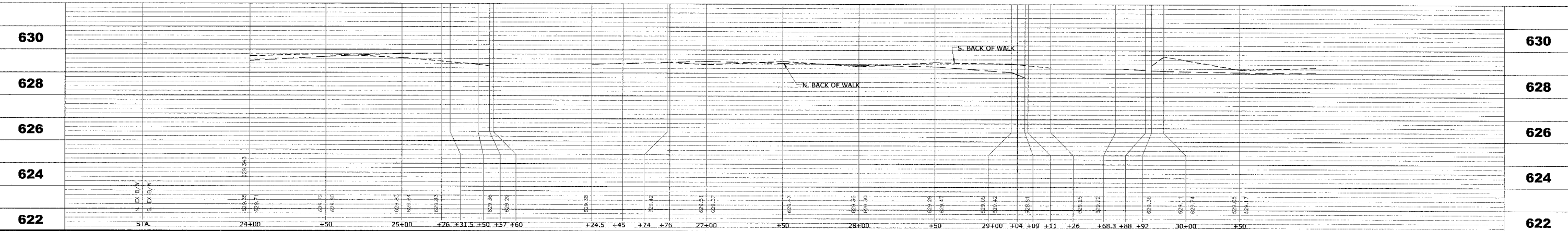

HANCOCK ENGINEERING

- Civil Engineers
- Municipal Consultants
- Established 1911

9933 Roosevelt Road
Westchester, Illinois 60154-2780
Phone: 708/865-0300
Fax: 708/865-1212

**GRAND AVENUE STREETScape PROJECT
VILLAGE OF RIVER GROVE, ILLINOIS**

**GRAND AVENUE
STREETScape PLAN AND PROFILE**

SCALE: 1"=30'H. & 1"=2'V.

DRAWN BY: LEV/ECW/MK

BOOK NO.: 1441,1443,1516

DATE: 10-15-07

E.H.E. NO.: 760-06-03320

REVISION:

SHEET **11** OF **35**

Drawing file: W:\Projects\15006033 - Grand Ave Streetscape\GRAND AVE.dwg Oct 18, 2007 - 2:41 pm