

|                       |                |          |                  |           |
|-----------------------|----------------|----------|------------------|-----------|
| F. A. U. NO.          | SECTION        | COUNTY   | TOTAL SHEETS     | SHEET NO. |
| 2593                  | 02-00092-00-WR | DU PAGE  | 49               | 9         |
| FED. ROAD DIST. NO. 1 |                | ILLINOIS | FED. AID PROJECT |           |
| CONTRACT NO. 83936    |                |          |                  |           |

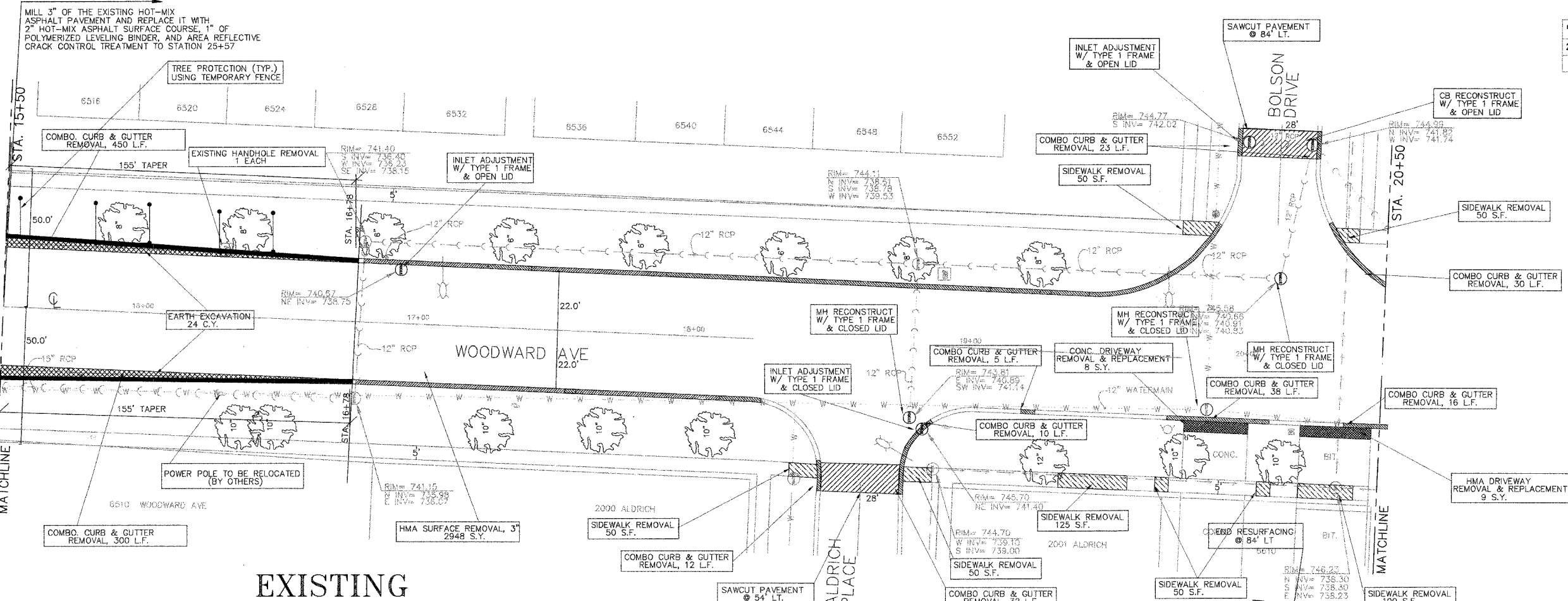

**EXISTING**

PLAN  
SCALE: 1"=20'

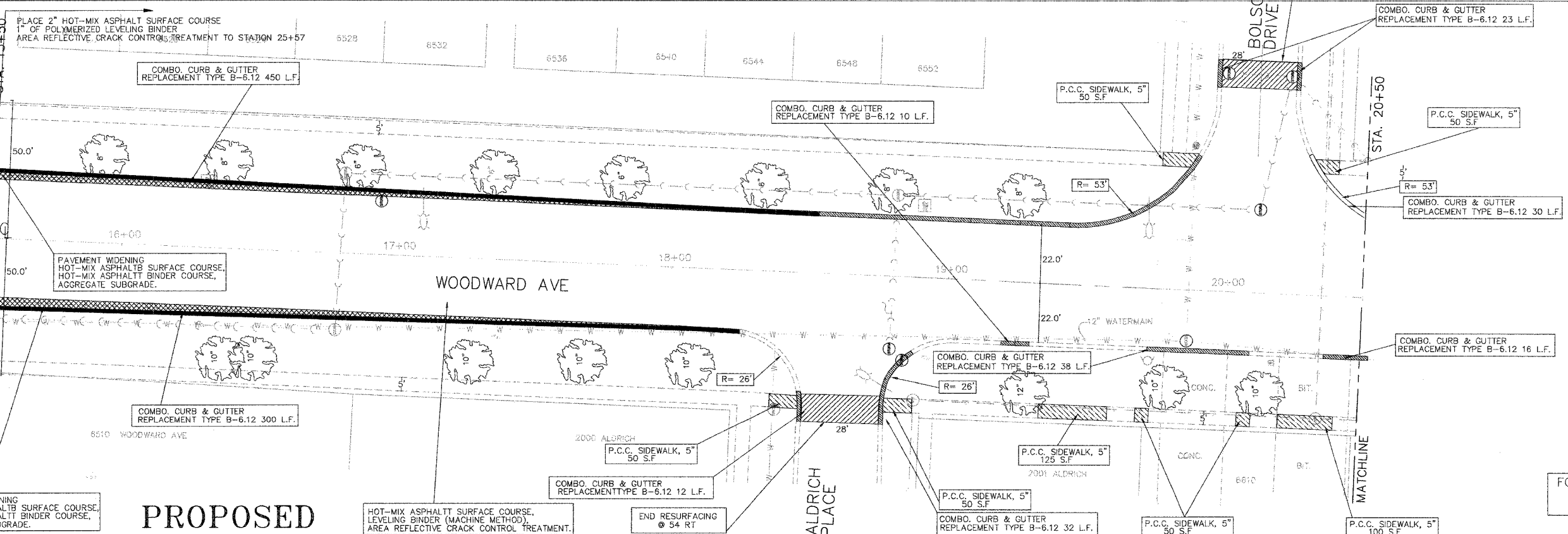
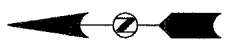

**PROPOSED**

FOR WOODWARD AVE. PROFILE  
STA. 15+50 TO STA. 20+50  
SEE SHEET 12

VILLAGE OF DOWNERS GROVE  
PUBLIC WORKS ENGINEERING DIVISION  
5101 WALNUT AVENUE 60515 (630)434-5460

**WOODWARD AVE. IMPROVEMENTS**  
DOWNERS GROVE, ILLINOIS

| REVISIONS |      | WOODWARD AVE. EXISTING & PROPOSED<br>STA. 15+50 TO STA. 20+50 |                  |
|-----------|------|---------------------------------------------------------------|------------------|
| NAME      | DATE | DATE                                                          | CHECKED BY       |
|           |      | 2/02/07                                                       | S.A.V.           |
|           |      | SCALE: N.T.S.                                                 | DRAWN BY: R.W.B. |
|           |      | FILE NAME: C:\CADFILES\WOODWARD\WOODWARD-4A                   |                  |