

F.A. RTE.	SECTION	COUNTY	TOTAL SHEETS	SHEET NO.
	02-00093-00-	DUPAGE	14	1

CONTRACT NO. 83972

INDEX OF SHEETS

SHEET NO.	DESCRIPTION
1	COVER SHEET
2	GENERAL NOTES
3	TYPICAL SECTIONS
4	TYPICAL PAVEMENT MARKINGS
5	TRAFFIC CONTROL DETAILS
6	DUNHAM RD: PALMER ST - 63rd ST
7	PRENTISS DR: PUFFER RD - SPRINGSIDE AVE
8	DOWNTOWN DOWNERS GROVE BIKE LANES
9	SIGNAGE DETAILS
10	DUNHAM RD: FOSTER - 59th ST AND PRENTISS / BOLSON: WOODWARD ST - DUNHAM RD
11	VARIOUS STREETS SOUTH & WEST OF DOWNTOWN
12	DOWNTOWN DOWNERS GROVE
13	SARATOGA AVE: PRAIRIE AVE - BROOKSIDE LN
14	SARATOGA AVE: BROOKSIDE LN - 31st ST

STATE OF ILLINOIS
DEPARTMENT OF TRANSPORTATION
DIVISION OF HIGHWAYS
PLANS FOR PROPOSED
FEDERAL AID PROJECT

VARIOUS LOCATIONS BIKEWAY
PAVEMENT MARKING & SIGNAGE
SECTION 02-00093-00-BT
PROJECT CMM-8003(327)
DUPAGE COUNTY
JOB #C-91-027-04

PROJECT LOCATED ENTIRELY WITHIN THE VILLAGE OF DOWNERS GROVE

INDEX OF STANDARDS

STANDARD #	HIGHWAY STANDARDS
000001-05	STANDARD SYMBOLS, ABBREVIATIONS, & PATTERNS
701301-02	LANE CLOSURE, 2L, 2W, SHORT TIME OPERATION
701311-02	LANE CLOSURE, 2L, 2W, MOVING OPERATION - DAY ONLY
701901	TRAFFIC CONTROL DEVICES (3 SHEETS)
720006-01	SIGN PANEL ERECTION DETAILS
720011	METAL POSTS FOR SIGNS, MARKERS, & DELINEATORS
729001	APPLICATION OF TYPES A & B METAL POSTS
780001-01	TYPICAL PAVEMENT MARKINGS

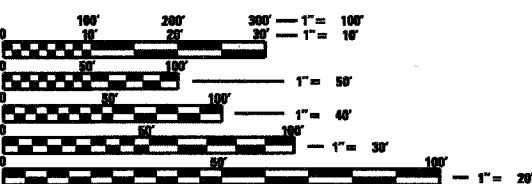

FULL SIZE PLANS HAVE BEEN PREPARED USING STANDARD ENGINEERING SCALES. REDUCED SIZED PLANS WILL NOT CONFORM TO STANDARD SCALES. IN MAKING MEASUREMENTS ON REDUCED PLANS, THE ABOVE SCALES MAY BE USED.

J.U.L.I.E.
JOINT UTILITY LOCATION INFORMATION FOR EXCAVATION
1-800-892-0123

CONTRACT NO. 83972

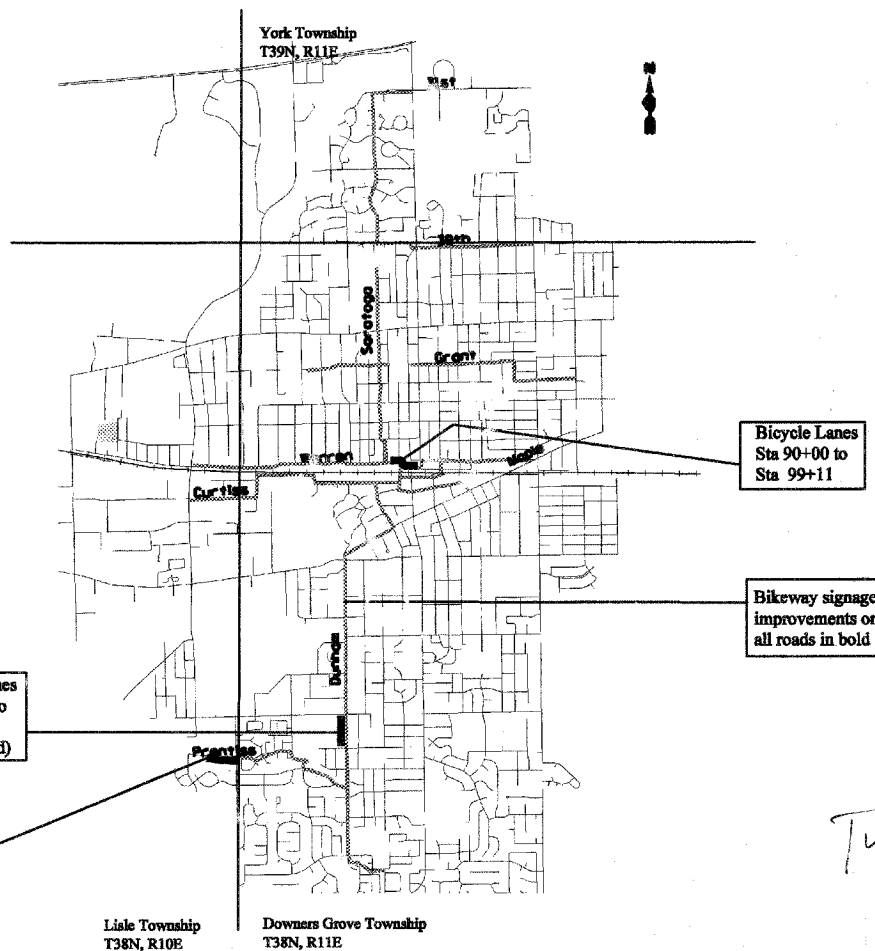

Timothy Barry
 Signed October 25, 2007
 License Expiration: November 30, 2007

Project Length of Bikeway Improvements:
Approximately 14.3 miles

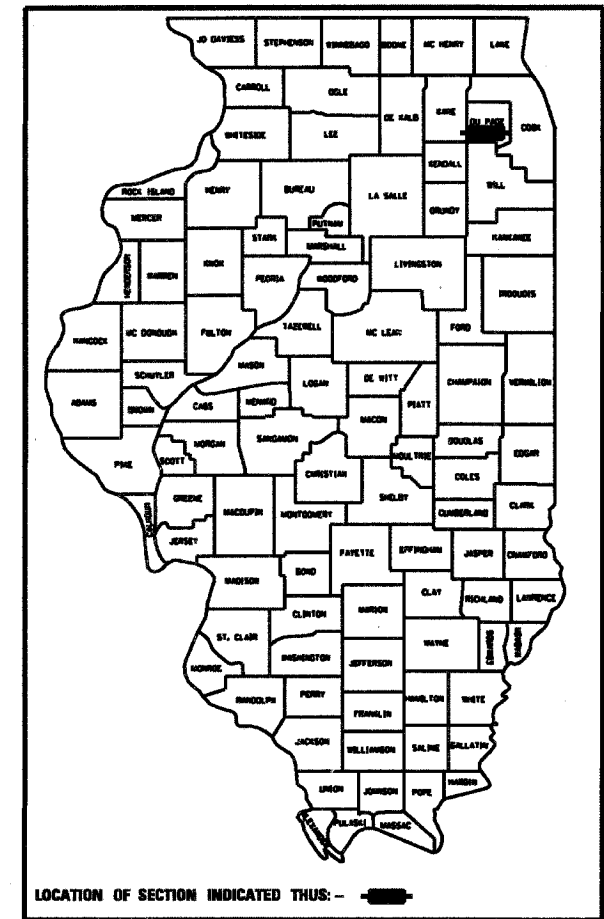

STATE OF ILLINOIS DEPARTMENT OF TRANSPORTATION DIVISION OF HIGHWAYS	
APPROVED	 10/26/2007 Village of Downers Grove
PASSED	NOVEMBER 6, 2007 District 1 Engineer of Local Roads & Streets
RELEASING FOR BID BASED ON LIMITED REVIEW	Nov. 7, 2007 Deputy Director of Highways, Region 1 Engineer

**PRINTED BY THE AUTHORITY
OF THE STATE OF ILLINOIS**

F.A. RTE.	SECTION	COUNTY	TOTAL SHEETS	SHEET NO.
	02-00093-00-B1	DUPAGE	14	2
FED. ROAD DIST. NO. ILLINOIS FED. AID PROJECT				
CONTRACT NO. 83972				

GENERAL NOTES

1. ALL CONSTRUCTION SHALL BE IN ACCORDANCE WITH THE "STANDARD SPECIFICATIONS FOR ROAD & BRIDGE CONSTRUCTION", ADOPTED JANUARY 1, 2007; THE "SUPPLEMENTAL SPECIFICATIONS & RECURRING SPECIAL PROVISIONS", ADOPTED JANUARY 1, 2007; THE LATEST EDITION OF THE "ILLINOIS MANUAL ON UNIFORM TRAFFIC CONTROL DEVICES FOR STREETS AND HIGHWAYS (MUTCD)", THE "STANDARD SPECIFICATIONS FOR TRAFFIC CONTROL ITEMS" AND THE "SPECIAL PROVISIONS" INCLUDED IN THE CONTRACT DOCUMENT.
2. ALL REFERENCES TO STANDARDS IN THE PLAN OR SPECIAL PROVISIONS SHALL BE INTERPRETED TO BE THE LATEST STANDARDS OF THE DEPARTMENT.
3. DIMENSIONS: IT SHALL BE THE CONTRACTOR'S RESPONSIBILITY TO VERIFY ALL DIMENSIONS AND CONDITIONS IN THE FIELD PRIOR TO ORDERING MATERIALS AND BEGINNING CONSTRUCTION.
4. BEFORE STARTING ANY EXCAVATION, THE CONTRACTOR SHALL CALL "JULIE" AT 1-800-892-0123 48 HOURS IN ADVANCE.

SUMMARY OF QUANTITIES

Item Number	Items	Unit	Total Quantity	Roadside Improvements SFTY-1B	Pavement Markings SFTY-1D	Traffic Signs Y002-1C
X0322748	Bicycle Lane Marking (Standard)	Each	37	37		
X0322927	Bike Lane Symbol (City of Chicago)	Each	21	21		
78000200	THERMOPLASTIC PVMT MARKING - LINE 4"	Foot	5,150		5150	
78000400	THERMOPLASTIC PVMT MARKING - LINE 6"	Foot	4,350		4350	
72000100	Sign Panel - Type 1	Sq Ft	500			500
72900100	Metal Post Type A	Foot	850			850
67100100	Mobilization	L Sum	1			

* Indicates Speciality Item

REVISIONS	
NAME	DATE
DAT	6/4/07
DAT	7/14/07
DAT	8/21/07

ILLINOIS DEPARTMENT OF TRANSPORTATION
VILLAGE OF DOWNERS GROVE
BIKE PLAN

GENERAL NOTES

SCALE: 1"=50'
DATE 8-21-07
DRAWN BY DAT
CHECKED BY CLW

F.A. RTE.	SECTION	COUNTY	TOTAL SHEETS	SHEET NO.
NA	02-00093-00-BT	DUPAGE	111	3
TO				
FED. ROAD DIST. NO.	ILLINOIS	FED. AID PROJECT		
CONTRACT NO. 83972				

Dunham Road
38' Pavment Width
(with one parking lane)



PARKING LANE	BIKE LANE	SOUTHBOUND LANE	NORTHBOUND LANE	BIKE LANE
8'	5'	10'	10'	5'

STA. 36+75 TO
STA. 49+33

Prentiss Drive
38' Pavment Width

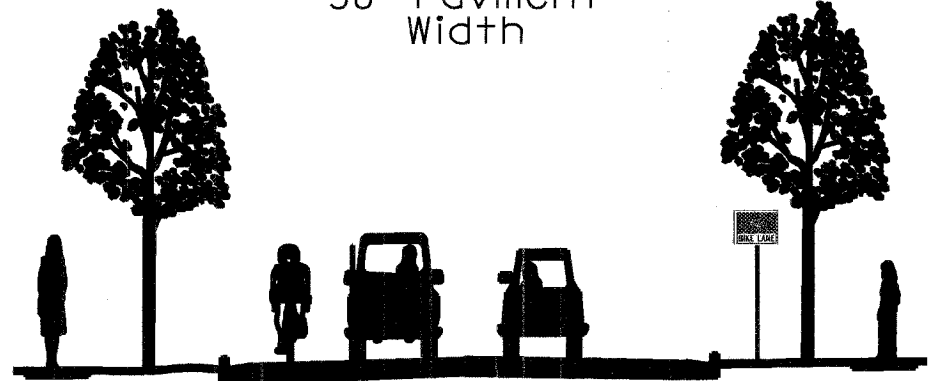

BIKE LANE	SOUTHBOUND LANE	NORTHBOUND LANE	BIKE LANE
5'	14'	14'	5'

STA. 50+00 TO
STA. 63+00

Bikeway Signage
Installation
Detail

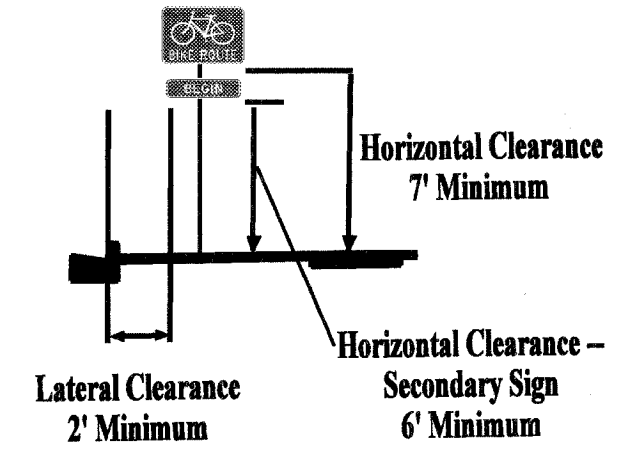

Applicable to
Bike Route &
Bike Lane
Signage

Warren Road
46' Pavment Width



PARKING LANE	BIKE LANE	SOUTHBOUND LANE	NORTHBOUND LANE	BIKE LANE	PARKING LANE
8'	5'	10'	10'	5'	8'

STA. 90+00 TO
STA. 94+75

Warren Road
47' Pavment Width



PARKING LANE	BIKE LANE	SOUTHBOUND LANE	NORTHBOUND LANE	BIKE LANE	PARKING LANE
8'	5'	10.5'	10.5'	5'	8'

STA. 96+00 TO
STA. 99+11

REVISIONS	
NAME	DATE
SM	12/23/06
DAT	1/29/07
BMT	4/15/07
DAT	8/22/07

ILLINOIS DEPARTMENT OF TRANSPORTATION
VILLAGE OF DOWNERS GROVE
BIKE PLAN
TYPICAL SECTIONS
SCALE: 1"=50'
DATE 8/22/07
DRAWN BY SEM
CHECKED BY CLW

P.A. RTE.	SECTION	COUNTY	TOTAL SHEETS	SHEET NO.
D2-00093-00-BT	DUPAGE			4
TYPICAL BIKEWAY PAVEMENT MARKINGS				
ILLINOIS FED. AID PROJECT				
CONTRACT NO. 83972				

Bike Arrow Lane Marking
Area = 4.56 sq ft

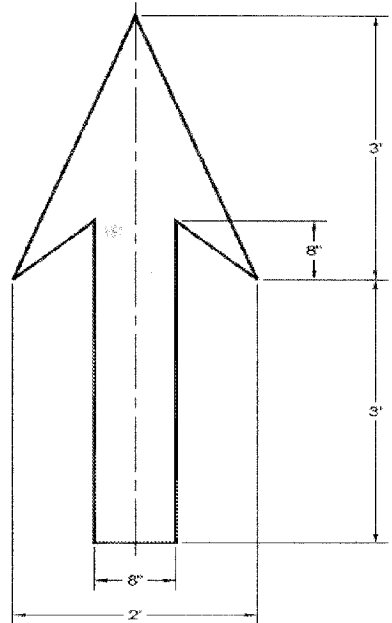

Bike Lane Symbol and Arrow Spacing

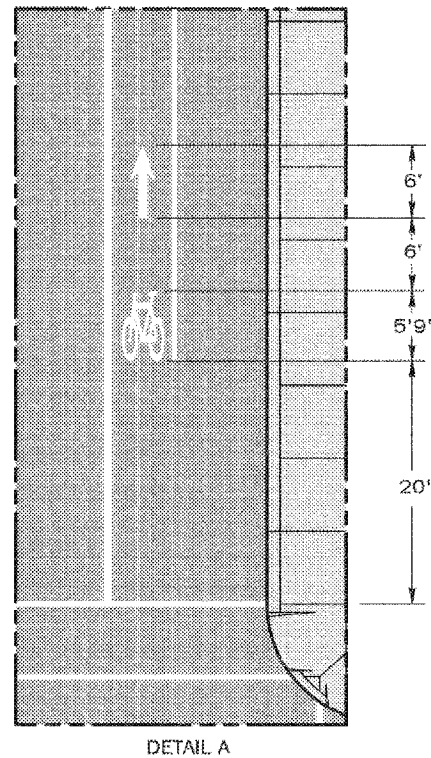
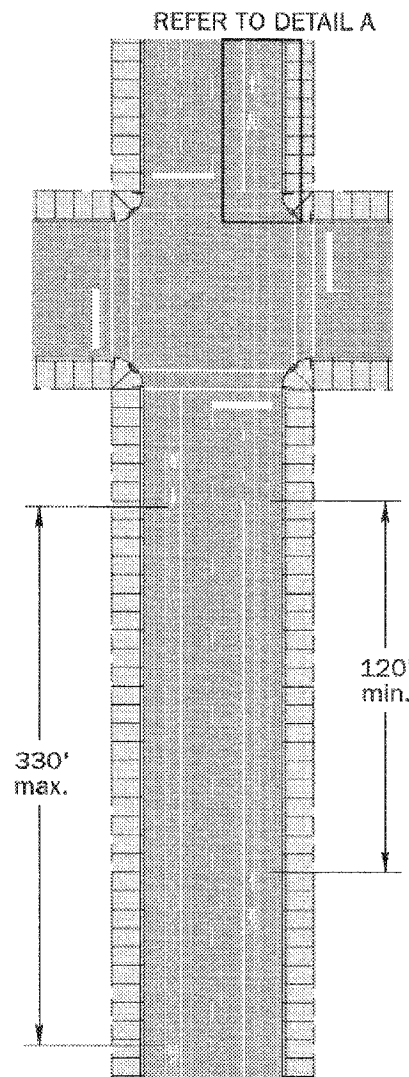

Shared Lane Chevron Spacing

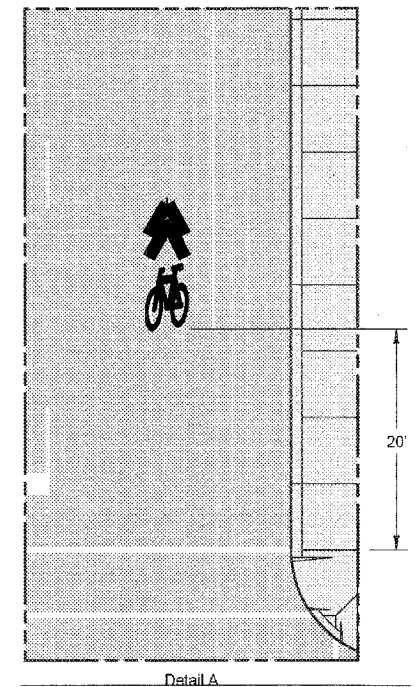
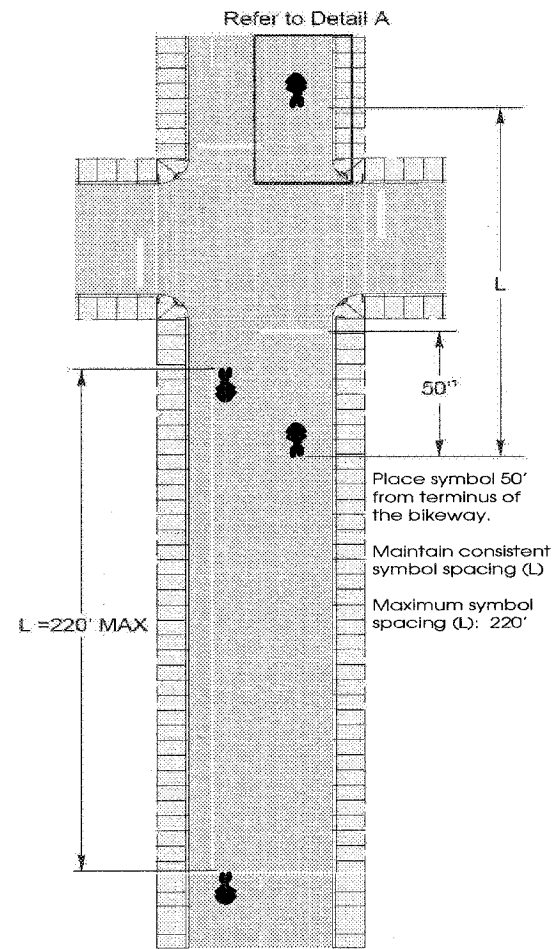

Bicycle Lane Marking
Area = 8.36 sq ft

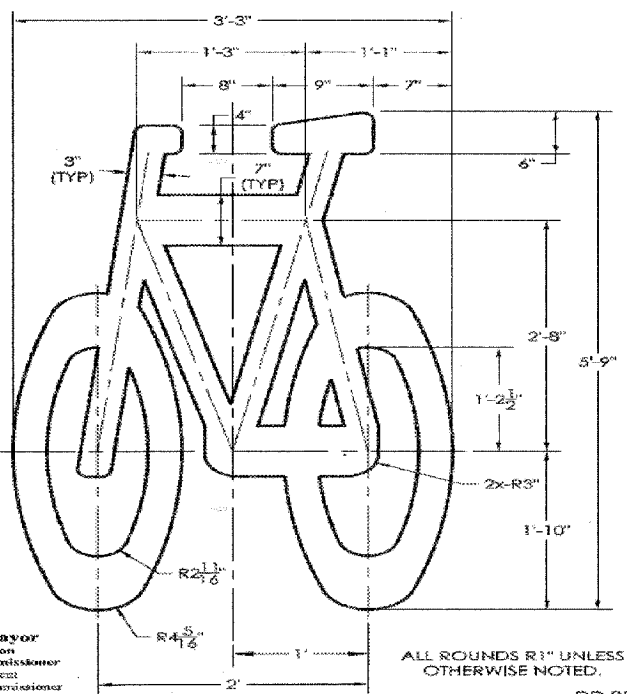

Chevron Lane Sharing Symbol
Area = 6.68 sq ft

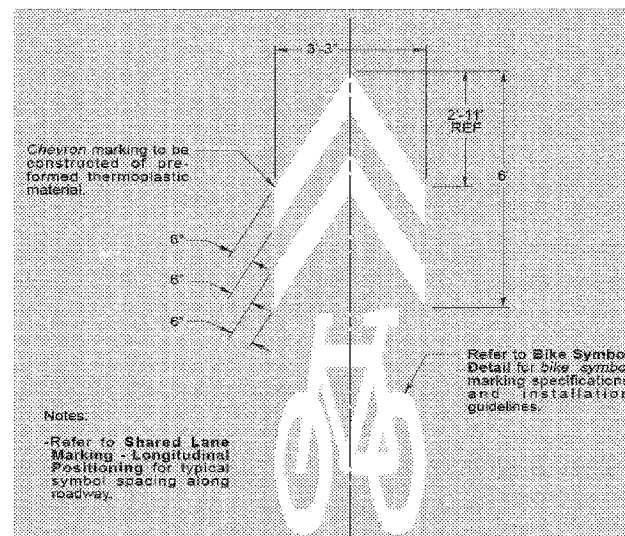

REVISIONS	
NAME	DATE
SM	12/21/06
DAT	1/29/07
DAT	4/13/07
DAT	9/13/07

ILLINOIS DEPARTMENT OF TRANSPORTATION
VILLAGE OF DOWNERS GROVE
PHASE I BIKE PLAN
PAVEMENT MARKING DETAILS
SCALE: 1"=10'
DATE: 9-13-07
DRAWN BY SEM
CHECKED BY CLW

TRAFFIC CONTROL AND PROTECTION FOR SIDE ROADS, INTERSECTIONS, AND DRIVEWAYS

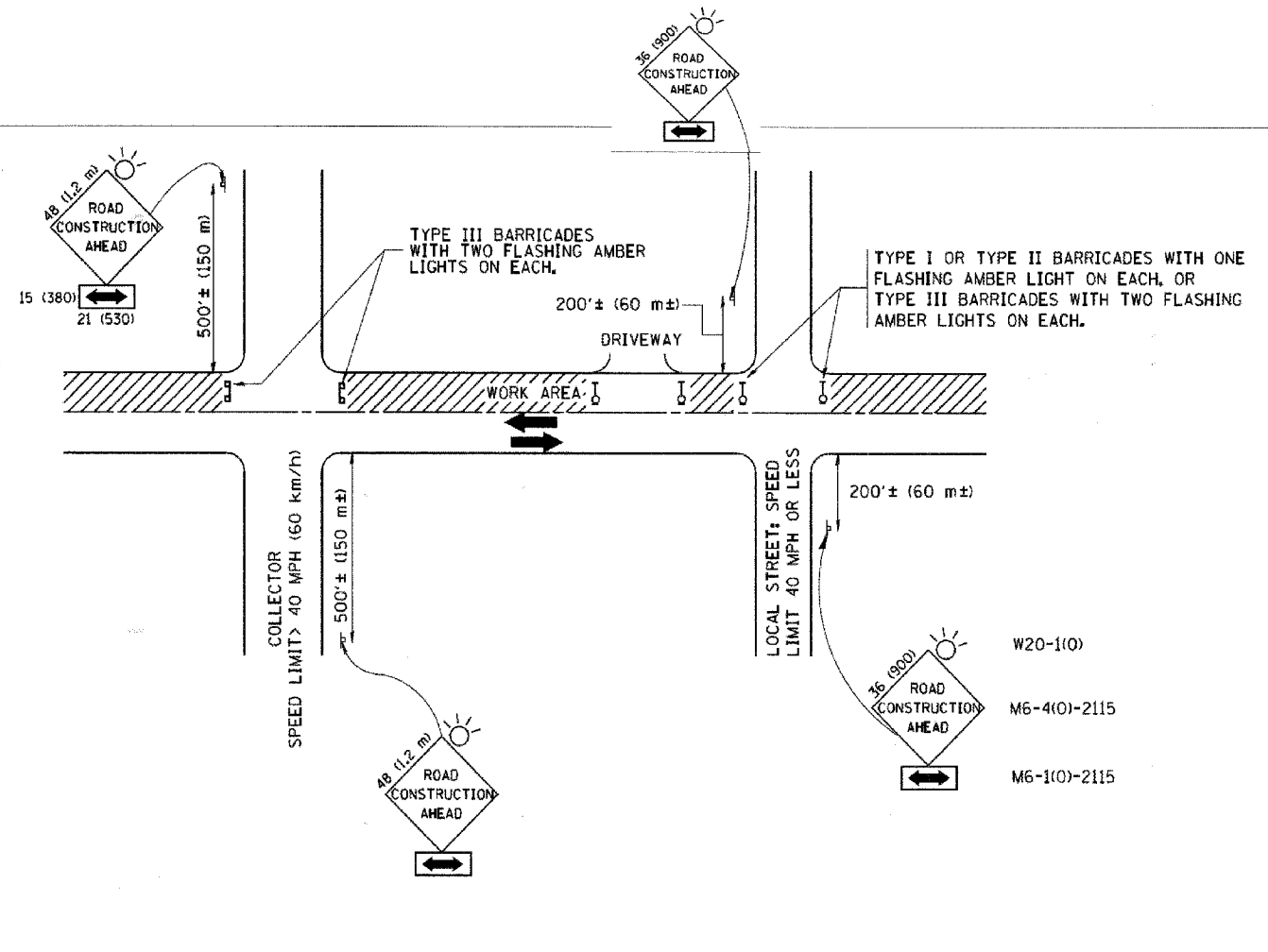

NOTES:

- A. FOR NO LANE RESTRICTION ON THE SIDE ROAD OR DRIVEWAYS
 1. SIDE ROAD WITH A SPEED LIMIT OF 40 MPH (60 km/h) OR LESS AS SHOWN ON THE DRAWING AND AS DIRECTED BY THE ENGINEER:
 - a) ONE ROAD CONSTRUCTION AHEAD SIGN 36 x 36 (900x900) WITH A FLASH AND FLAG MOUNTED ON IT APPROXIMATELY 200' (60 m) IN ADVANCE OF THE MAIN ROUTE.
 - b) THE CLOSED PORTION OF THE MAIN ROUTE SHALL BE PROTECTED BY BLOCKING WITH TYPE I, TYPE II OR TYPE III BARRICADES, 1/3 OF THE CROSS SECTION OF THE CLOSED PORTION.
 2. SIDE ROAD WITH A SPEED LIMIT GREATER THAN 40 MPH (60 km/h) AS SHOWN ON THE DRAWING AND AS DIRECTED BY THE ENGINEER:
 - a) ONE ROAD CONSTRUCTION AHEAD SIGN 48 x 48 (1,2 m x 1,2 m) WITH A FLASHER MOUNTED ON IT APPROXIMATELY 500' (150 m) IN ADVANCE OF THE MAIN ROUTE.
 - b) THE CLOSED PORTION OF THE MAIN ROUTE SHALL BE PROTECTED BY BLOCKING WITH TYPE III BARRICADES, 1/2 OF THE CROSS SECTION OF THE CLOSED PORTION.
3. WHEN THE SIDE ROAD LIES BETWEEN THE BEGINNING OF THE MAINLINE SIGNING AND THE WORK ZONE, A SINGLE HEADED ARROW (M6-1) SHALL BE USED IN LIEU OF THE DOUBLE HEADED ARROW (M6-4).
- B. FOR A LANE CLOSURE ON A SIDE ROAD OR DRIVEWAY:

USE APPLICABLE PORTIONS OF THE TYPICAL APPLICATION OF TRAFFIC CONTROL DEVICES (STD. 701501, STD. 701606 OR THE APPROPRIATE STANDARD). THE SPACING OF SIGNS AND BARRICADES SHALL BE ADJUSTED FOR FIELD CONDITIONS AS DIRECTED BY THE ENGINEER. THE DIRECTIONAL ARROW SHALL BE COVERED OR REMOVED WHEN NO LONGER CONSISTENT WITH THE SIDE ROAD LANE CLOSURE.
- C. ADVANCE WARNING SIGNS ARE TO BE OMITTED ON DRIVEWAY UNLESS OTHERWISE NOTED.
- D. THE TRAFFIC CONTROL AND PROTECTION FOR SIDE ROADS, INTERSECTIONS, AND DRIVEWAYS SHALL BE INCIDENTAL TO THE COST OF SPECIFIED TRAFFIC CONTROL STANDARDS OR ITEMS.

All dimensions are in millimeters (inches) unless otherwise shown.

PAVEMENT MARKINGS LETTERS AND SYMBOLS FOR TRAFFIC STAGING

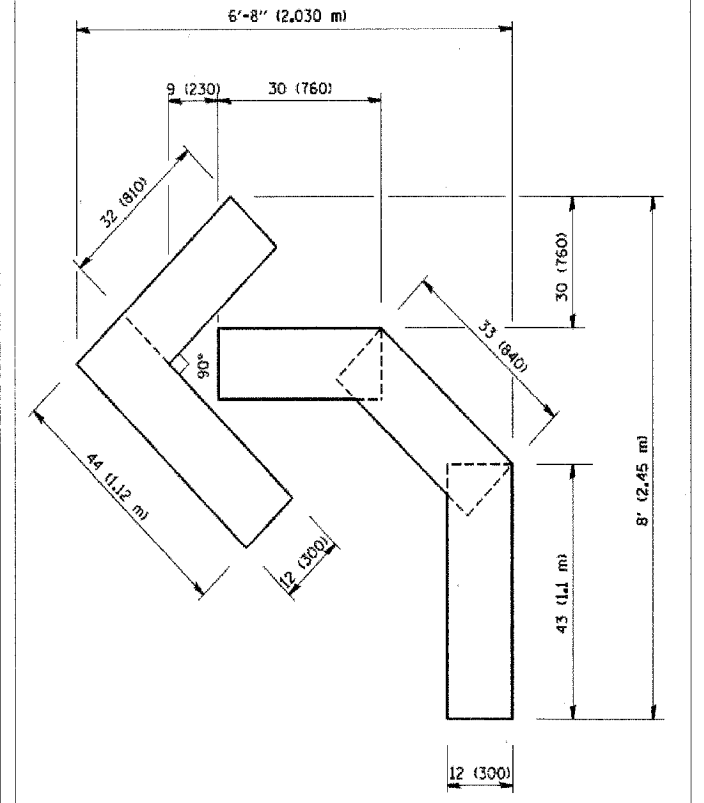
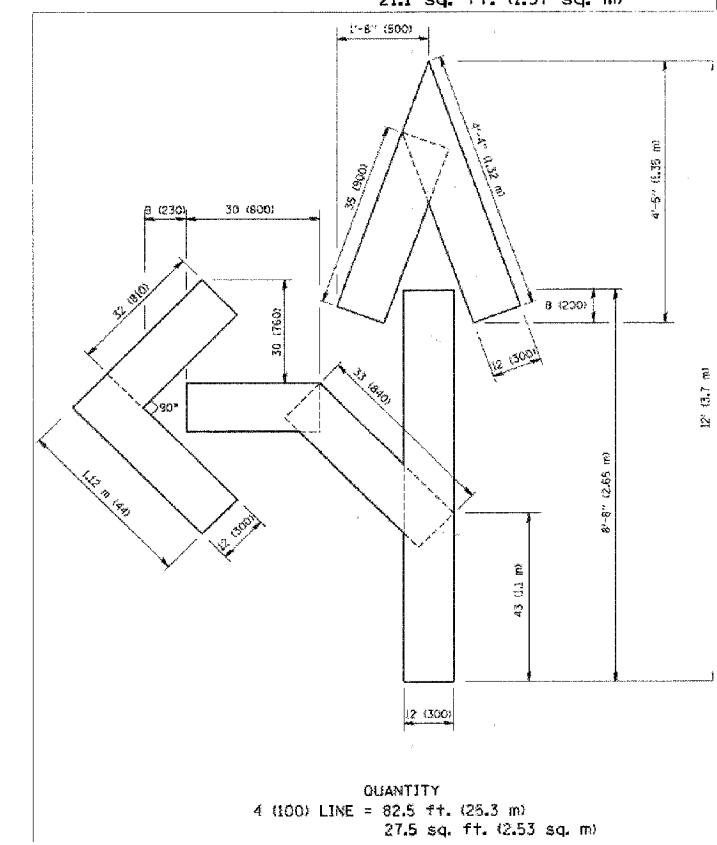
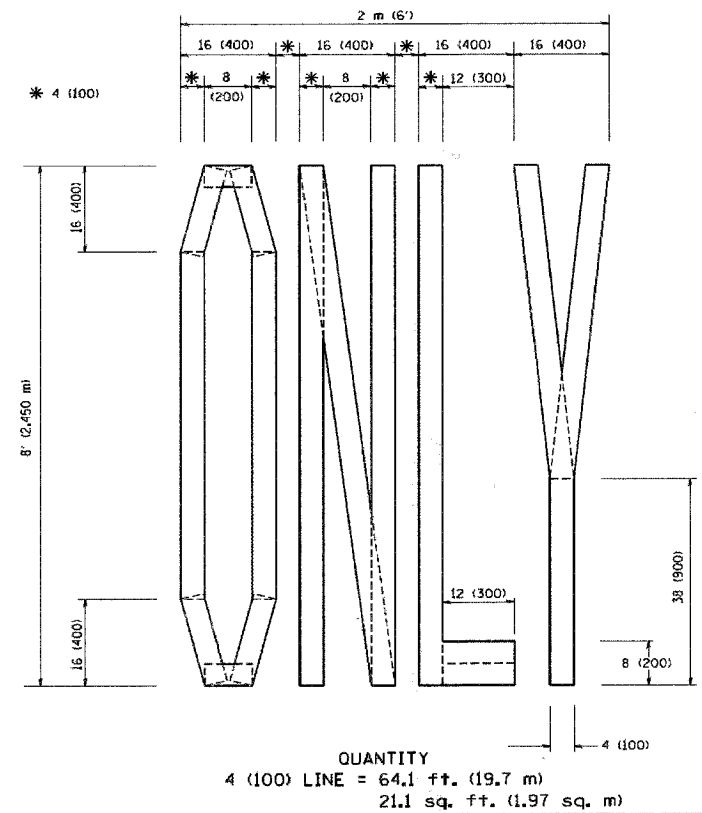

All dimensions are in inches (millimeters) unless otherwise shown.

SECTION	COUNTY	TOTAL SHEETS	SHEET NO.
D2-00093-00-B7	DUPAGE	5	5
TRAFFIC CONTROL DETAILS			
CONTRACT NO. 83972			

REVISIONS	
DATE	DESCRIPTION
10/23/07	

ILLINOIS DEPARTMENT OF TRANSPORTATION
 VILLAGE OF DOWNERS GROVE
 BIKE PLAN
 TRAFFIC CONTROL DETAILS
 SCALE: NONE
 DATE 10-23-07
 DRAWN BY DAT

F.A. RTE.	SECTION	COUNTY	TOTAL SHEETS	SHEET NO.
NA	D2-00093-00-BT	DUPAGE	14	6
DUNHAM: PALMER TO 63rd ST				
FED. ROAD DIST. NO.	ILLINOIS	FED. AID PROJECT		
CONTRACT NO. 83972				

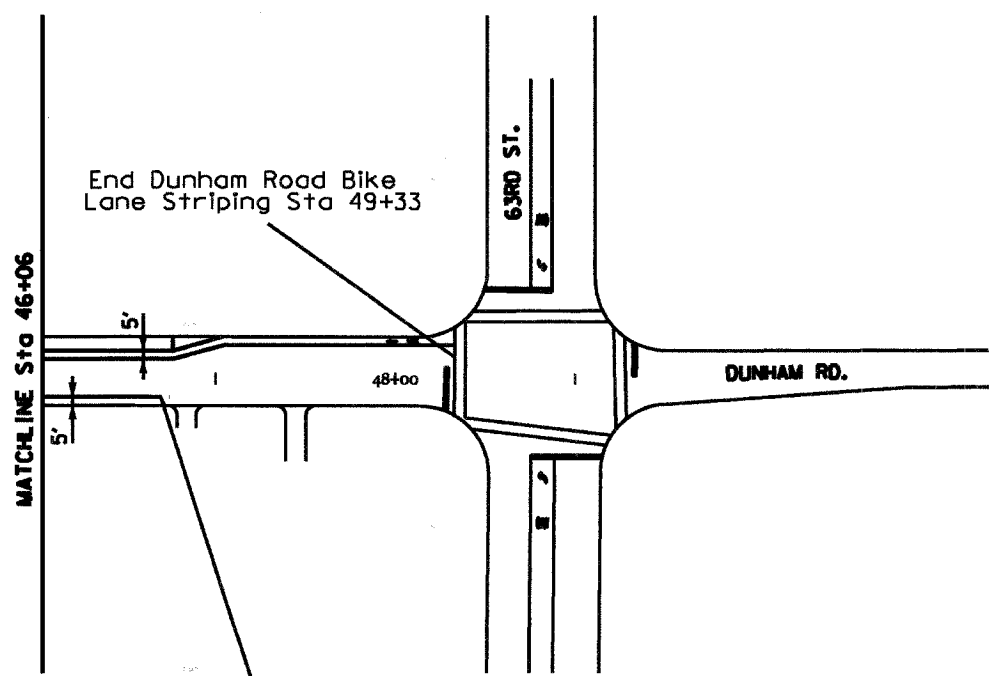
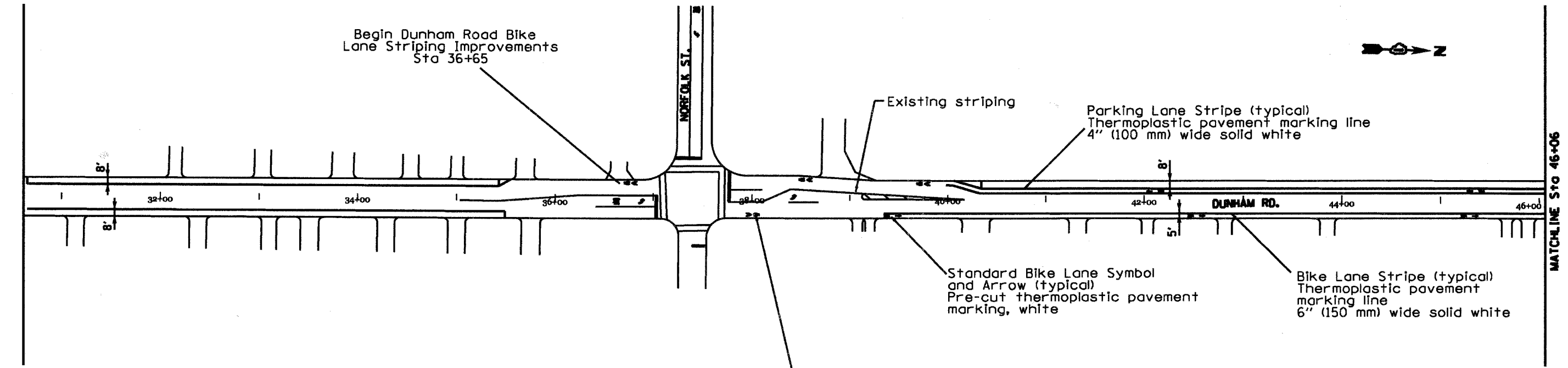

REVISIONS	
NAME	DATE
SM	12/23/06
DAT	1/23/07
SM	4/25/07
DAT	8/22/07

ILLINOIS DEPARTMENT OF TRANSPORTATION
 VILLAGE OF DOWNERS GROVE
 BIKE PLAN
 DUNHAM ROAD BIKEWAY

SCALE: 1"=50'
 DATE 8/22/07

DRAWN BY SEM
 CHECKED BY CLW

F.A. RTE.	SECTION	COUNTY	TOTAL SHEETS	SHEET NO.
NA	D2-00093-00-BT	DUPAGE	14	7
PRENTISS: PUFFER TO SPRINGSIDE				
FED. ROAD DIST. NO.	ILLINOIS FED. AID PROJECT			

CONTRACT NO. 88972

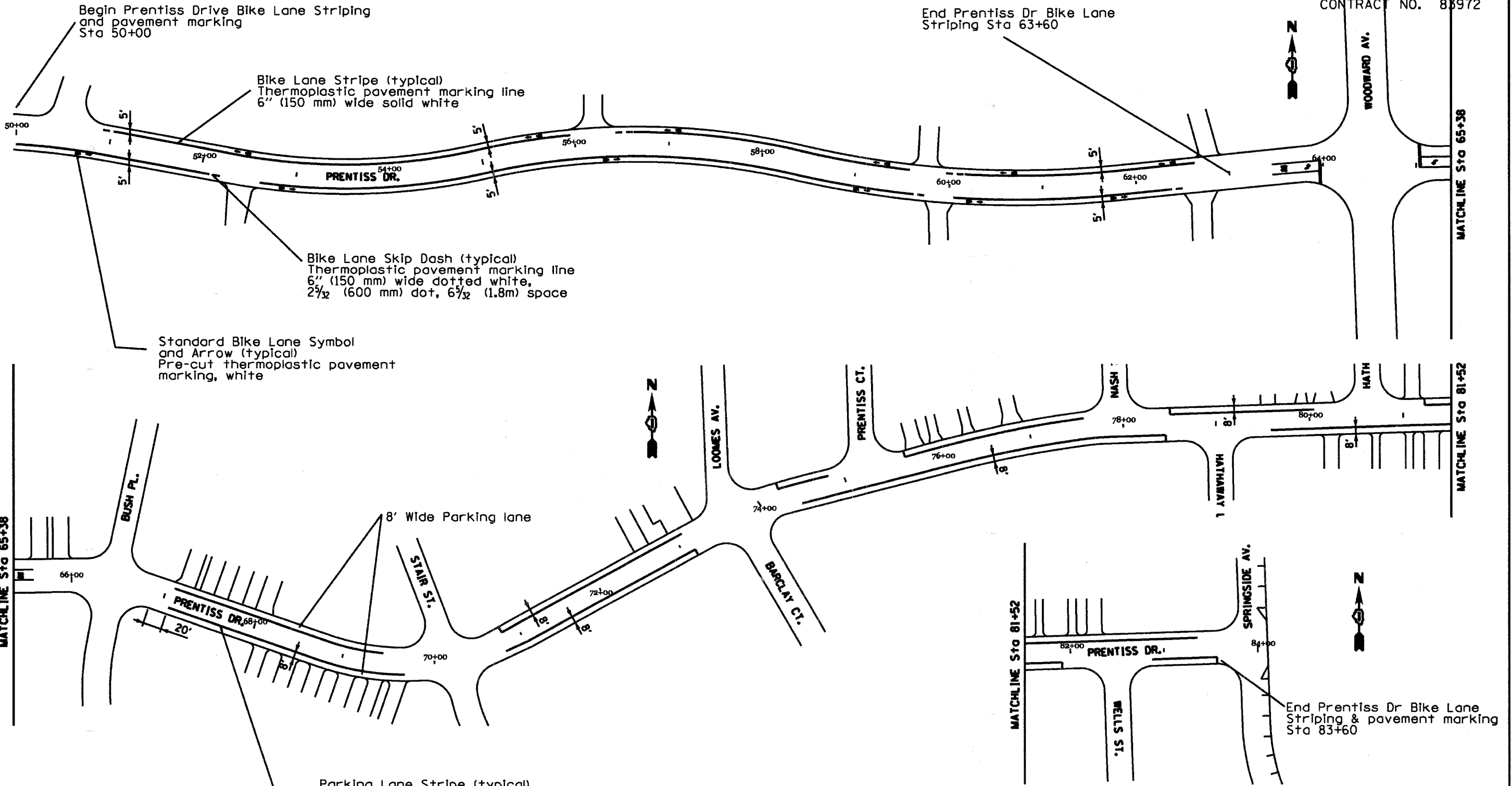

REVISIONS	
NAME	DATE
SM	12/23/06
DAT	1/29/07
SM	4/25/07
DAT	8/22/07

ILLINOIS DEPARTMENT OF TRANSPORTATION
 VILLAGE OF DOWNERS GROVE
 BIKE PLAN
 PRENTISS DRIVE BIKEWAY
 SCALE: 1"=50'
 DATE 8/22/07
 DRAWN BY SEM
 CHECKED BY CLW

F.A. RTE.	SECTION	COUNTY	TOTAL SHEETS	SHEET NO.
NA	02-00093-00-BT	DUPAGE	14	8
DOWNTOWN DOWNERS GROVE				
FED. ROAD DIST. NO.	ILLINOIS	FED. AID PROJECT		

CONTRACT NO. 83972

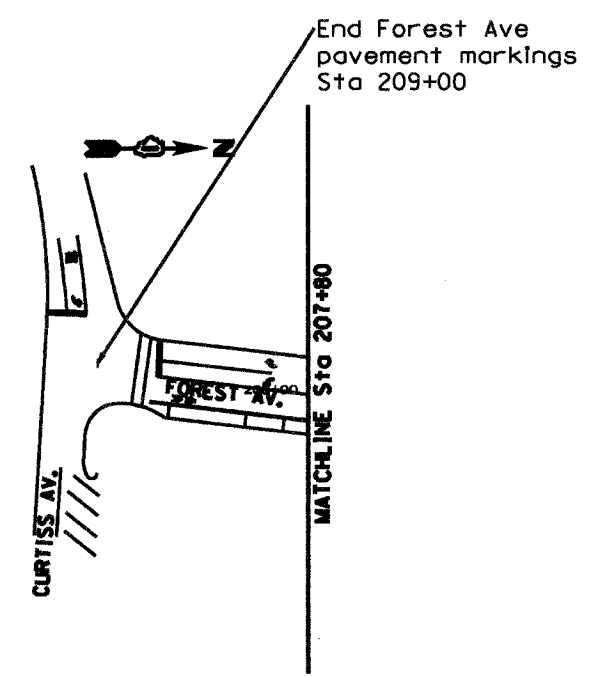
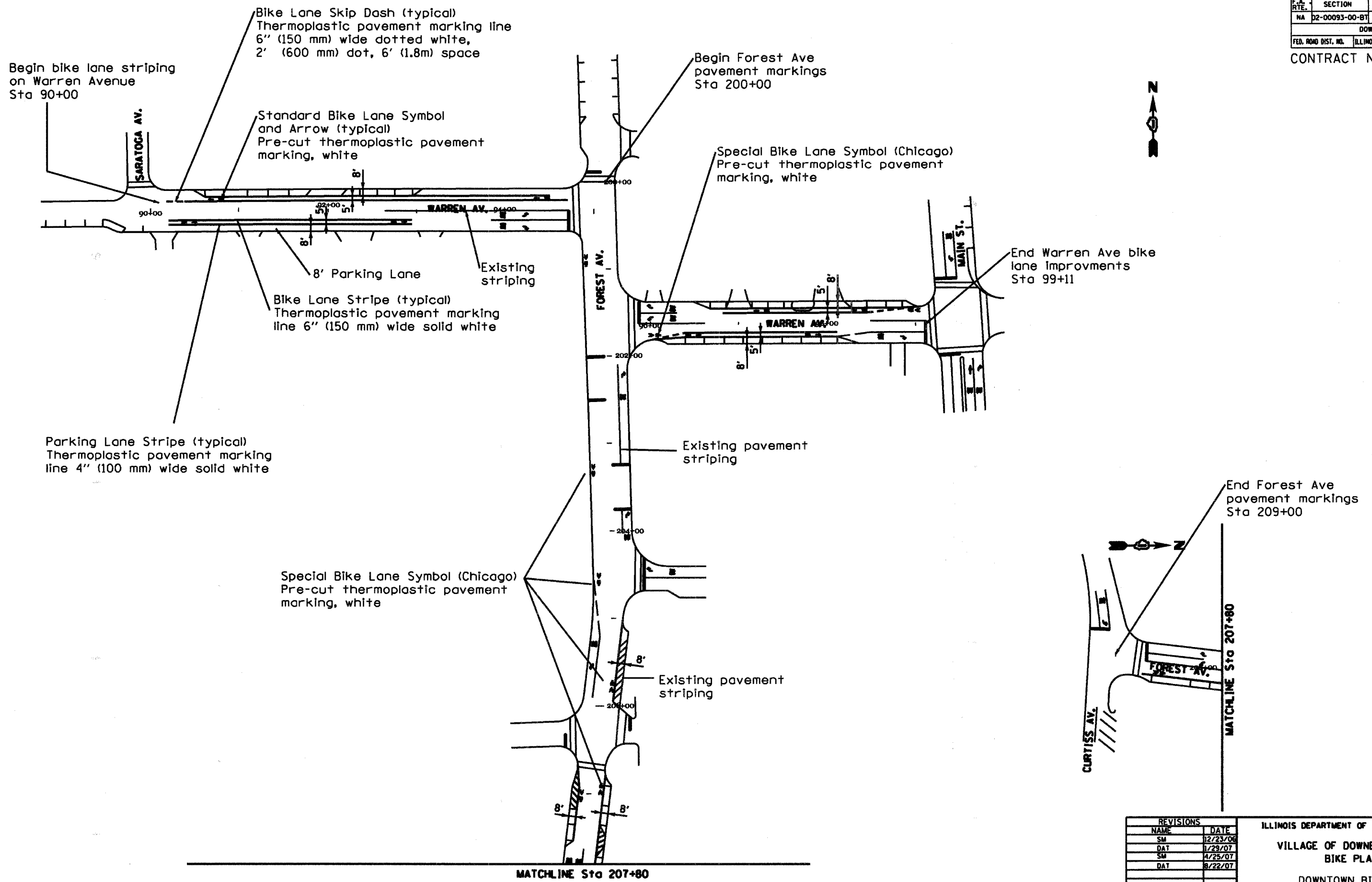

REVISIONS	
NAME	DATE
SM	12/23/06
DAT	1/29/07
SM	4/25/07
DAT	8/22/07

ILLINOIS DEPARTMENT OF TRANSPORTATION
 VILLAGE OF DOWNERS GROVE
 BIKE PLAN
 DOWNTOWN BIKEWAY
 SCALE: 1"=50'
 DATE 8/22/07
 DRAWN BY SEM
 CHECKED BY CLW

MATCHLINE Sta 207+80

PLAN SCALE: 1"=50'
 DATE: 8/22/07

SIGNAGE DESIGN

F.A. RTE	SECTION	COUNTY	TOTAL SHEETS	SHEET NO.
N/A	02-0093-00-BT	DUPAGE	14	9
FED. ROAD DIST NO.		ILLINOIS	FED. AID PROJECT	
Contract Number 83972				



SIGN R3-17
Size 24" x 30"
Color: Black on White Reflective



SIGN R3-17A
Size 12" x 30"
Color: Black on White Reflective



SIGN R3-17B
Size 12" x 30"
Color: Black on White Reflective

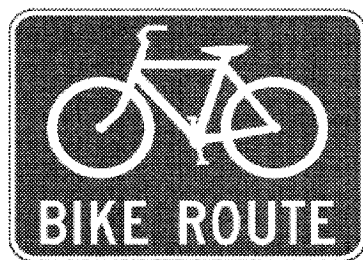

SIGN D11-1
Size 24" x 18"
Color: White on Green Reflective

Type: 2" Highway Gothic
Symbol: 18.25" x 10 1/2"

Place at approximately 1/4 mile intervals and major intersections to confirm route (per AASHTO).



SIGN M7-11
Size 12" x 4"
Color: White on Green Reflective



SIGN M7-12
Size 12" x 4"
Color: White on Green Reflective

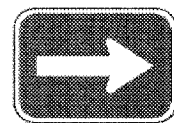

SIGN M7-1
Size 12" x 9"
Color: White on Green Reflective

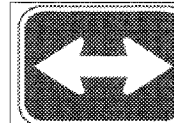

SIGN M7-5
Size 12" x 9"
Color: White on Green Reflective

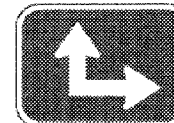

SIGN M7-6
Size 12" x 9"
Color: White on Green Reflective

ESTIMATED SIGNAGE QUANTITIES

#	MUTCD Code #	Size (inches)	Sign-Specific Text	Description	Quantity
1	D11-1	24 x 18		Bike Route	107
2	R3-17a	30 x 12		Ahead	4
3	R3-17	30 x 24		Bike Lane	18
4	R3-17b	30 x 12		Ends	8
5	M7-6	12 x 9		Directional arrows	5
5*	M7-6	12 x 9		Directional arrows	4
6	M7-5	12 x 9		Directional arrows	8
7	M7-1	12 x 9		Directional arrows	17
8	M7-1	12 x 9		Directional arrows	14
9	M4-11	12 x 4		Begin	12
10	M4-12	12 x 4		End	9
11	D1-1b(L)	24 x 6	Downtown 3	Destination	1
12	D1-1b	24 x 6	To Downtown	Destination	10
13	D1-1b	24 x 6	To Belmont Ave	Destination	2
14	D1-1b	24 x 6	To Lyman Woods	Destination	3
15	D1-1b	24 x 6	To Maple Grove Forest	Destination	1
16	D1-1b	24 x 6	To Doerhoeffer Park	Destination	2



SIGN D1-1b
Size 24" x 6"
Color: White on Green Reflective

Revisions		Illinois Department of Transportation Village of Downers Grove Bike Plan Signage
Name	Date	
DAT	1/29/07	
DAT	4/25/07	
DAT	8/31/07	
		Drawn by: DAT
		Date: 4/25/07

MATCHLINE SHEET 11

F.A. RTE	SECTION	COUNTY	TOTAL SHEETS	SHEET NO.
N/A	02-0093-00-BT	DUPAGE	14	10
DURHAM, PRENTISS AND BOLSON				
FED. ROAD DIST NO.	ILLINOIS	FED. AID PROJECT		

Contract Number 83972

SIGN LEGEND

#	MUTCD Code #	Size (inches)	Sign-Specific Text	Arrow Direction	Description
1	D11-1	24 x 18		N/A	Bike Route
2	R3-17a	30 x 12		N/A	Ahead
3	R3-17	30 x 24		N/A	Bike Lane
4	R3-17b	30 x 12		N/A	Ends
5	M7-6	12 x 9		Str / Right	Directional arrows
5*	M7-6	12 x 9		Str / Left	Directional arrows
6	M7-5	12 x 9		Right/Left	Directional arrows
7	M7-1	12 x 9		Right	Directional arrows
8	M7-1	12 x 9		Left	Directional arrows
9	M4-11	12 x 4			Begin
10	M4-12	12 x 4			End
11	D1-1b(L)	24 x 6	Downtown 3	Left	Destination
12	D1-1b	24 x 6	To Downtown		Destination

Note: Sign locations are approximate. It is recommended to co-locate signage on existing poles where feasible.

See Sheet 6 for additional signage design detail.

Bikeway Type

- Bike Route
- Bike Lanes

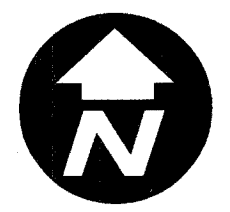

Revisions

Name	Date
DAT	1/29/07
DAT	4/25/07
DAT	8/22/07

Illinois Department of Transportation

Village of Downers Grove
Bike Plan Signage

Drawn by: DAT
Date: 4/25/07

0 495 990 Feet

Connect to future bike lanes on Lemont Road

Connection to future off-street path

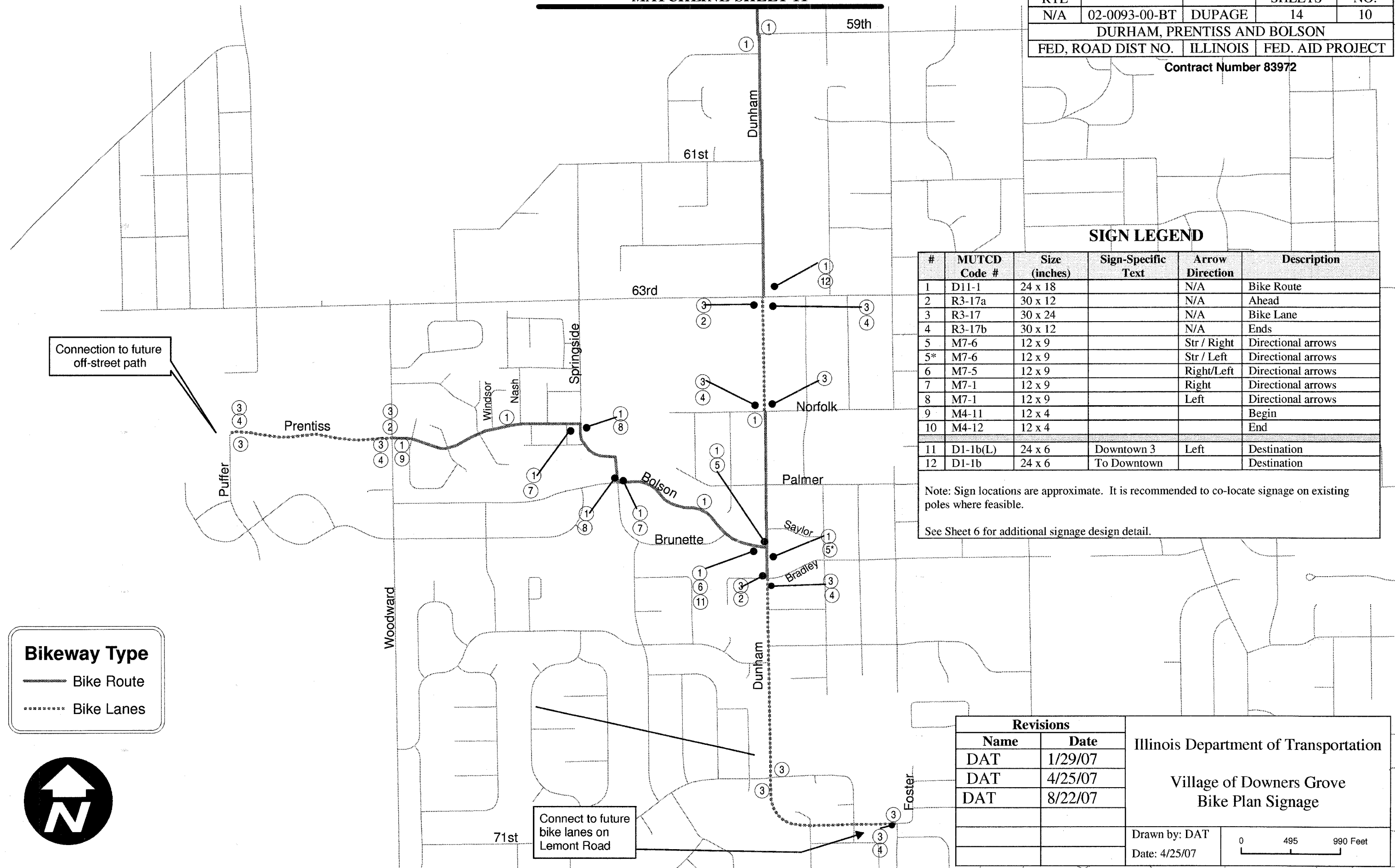

MATCHLINE SHEET 13

F.A. RTE	SECTION	COUNTY	TOTAL SHEETS	SHEET NO.
N/A	02-0093-00-BT	DUPAGE	14	11
SOUTH & WEST OF DOWNTOWN				
FED. ROAD DIST NO.	ILLINOIS	FED. AID PROJECT		

Contract Number 83972

For downtown area signage, see Sheet 12

Connect to future bike route on Warren

Connect to future bike route on Naperville Road

Connect to future bike route on Curtiss

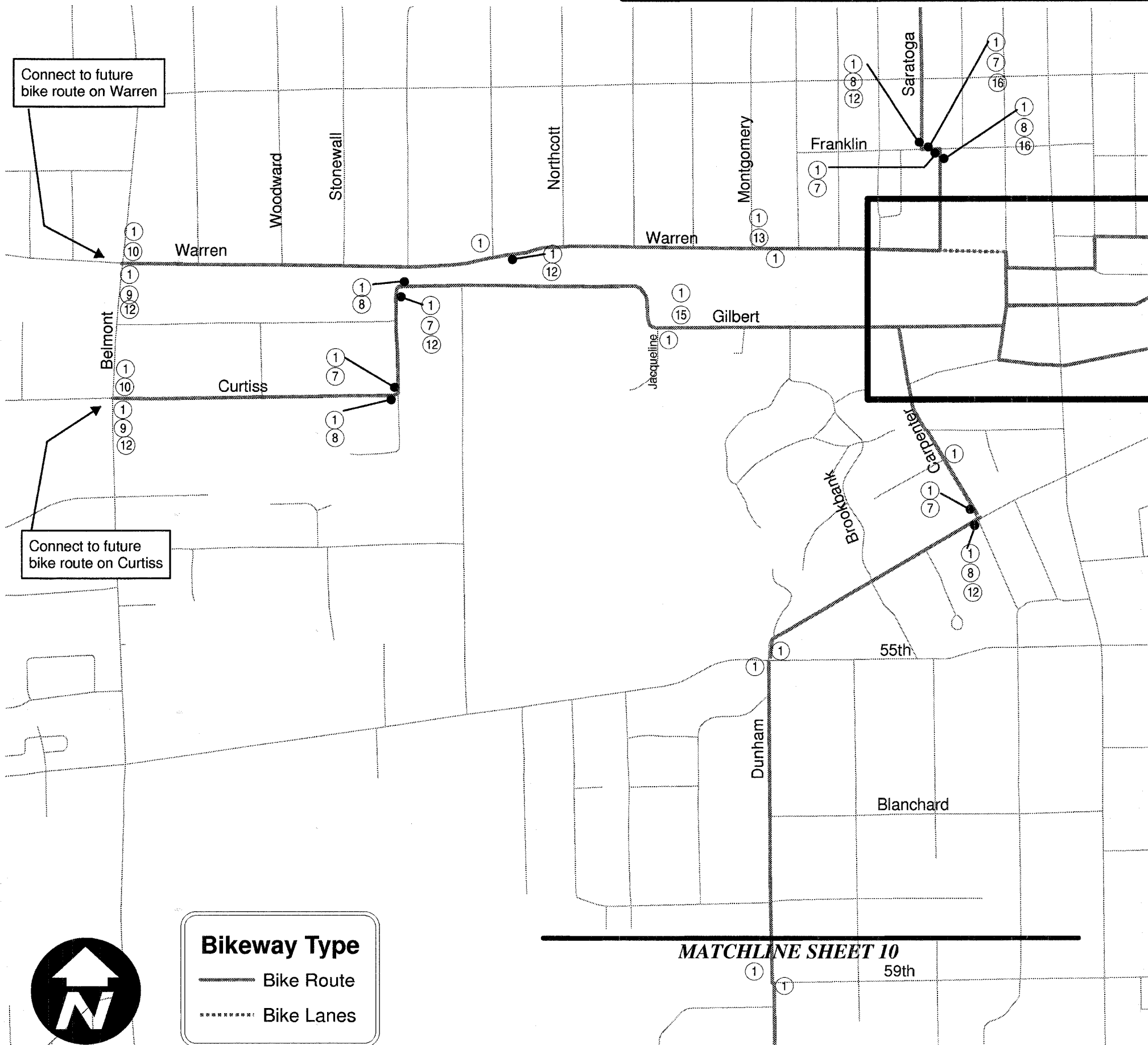

SIGN LEGEND

#	MUTCD Code #	Size (inches)	Sign-Specific Text	Arrow Direction	Description
1	D11-1	24 x 18		N/A	Bike Route
2	R3-17a	30 x 12		N/A	Ahead
3	R3-17	30 x 24		N/A	Bike Lane
4	R3-17b	30 x 12		N/A	Ends
5	M7-6	12 x 9		Str / Right	Directional arrows
5*	M7-6	12 x 9		Str / Left	Directional arrows
6	M7-5	12 x 9		Right/Left	Directional arrows
7	M7-1	12 x 9		Right	Directional arrows
8	M7-1	12 x 9		Left	Directional arrows
9	M4-11	12 x 4			Begin
10	M4-12	12 x 4			End
12	D1-1b	24 x 6	To Downtown		Destination
13	D1-1b	24 x 6	To Belmont Ave		Destination
15	D1-1b	24 x 6	To Maple Grove Forest		Destination
16	D1-1b	24 x 6	To Doerhoeffer Park		Destination

Note: Sign locations are approximate. It is recommended to co-locate signage on existing poles where feasible.

See Sheet 6 for additional signage design detail.

Revisions

Name	Date
DAT	1/29/07
DAT	4/25/07
DAT	8/22/07

Illinois Department of Transportation

Village of Downers Grove
Bike Plan Signage

Drawn by: DAT
Date: 8/22/07



Bikeway Type

- Bike Route
- Bike Lanes

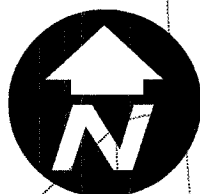

MATCHLINE SHEET 10

59th

F.A. RTE	SECTION	COUNTY	TOTAL SHEETS	SHEET NO.
N/A	02-0093-00-BT	DUPAGE	14	12
DOWNTOWN DOWNERS GROVE				
FED. ROAD DIST NO.	ILLINOIS	FED. AID PROJECT		

Contract Number 83972

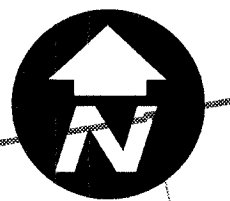
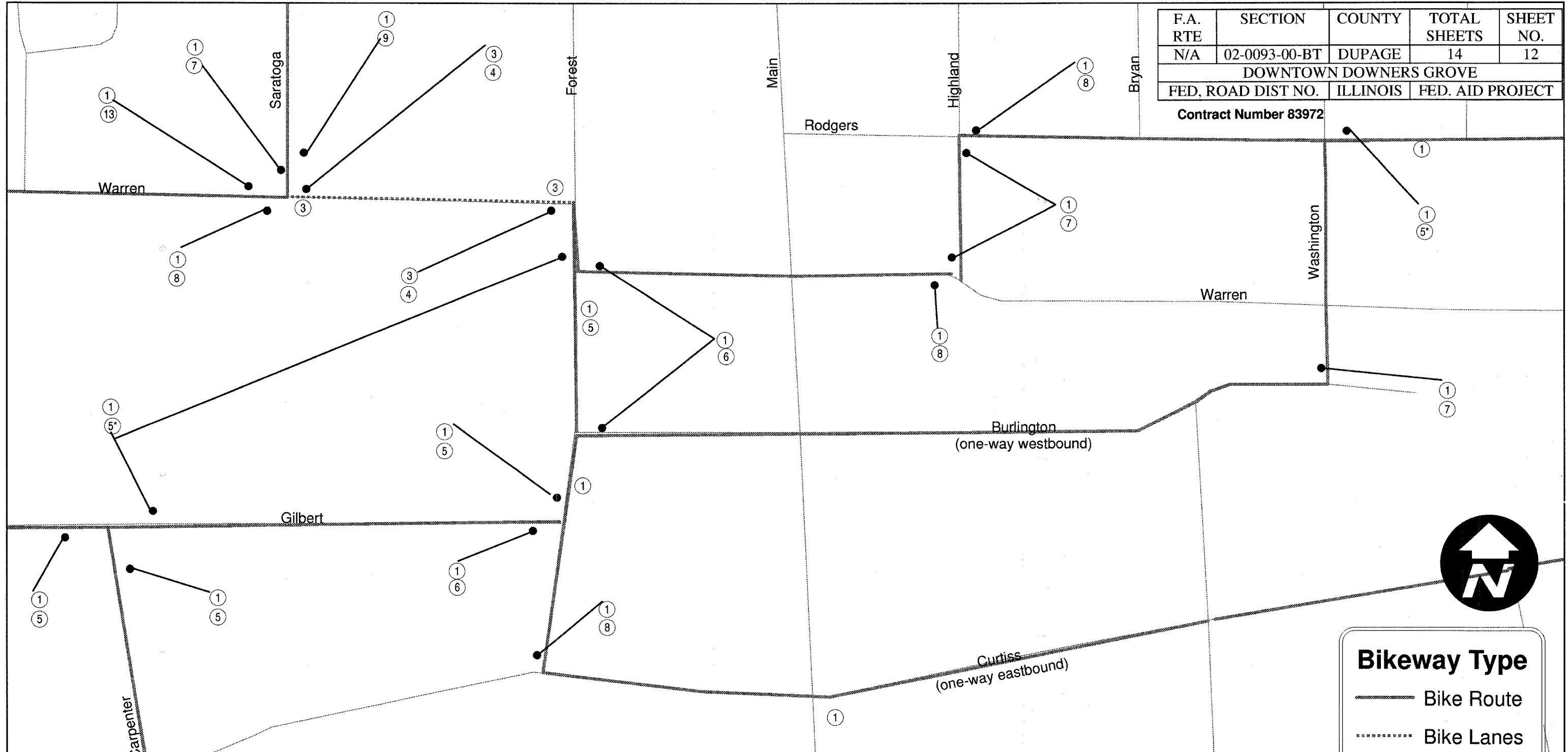

Bikeway Type

———— Bike Route

..... Bike Lanes

SIGN LEGEND

#	MUTCD Code #	Size (inches)	Sign-Specific Text	Arrow Direction	Description	#	MUTCD Code #	Size (inches)	Sign-Specific Text	Arrow Direction	Description
1	D11-1	24 x 18		N/A	Bike Route	6	M7-5	12 x 9		Right/Left	Directional arrows
2	R3-17a	30 x 12		N/A	Ahead	7	M7-1	12 x 9		Right	Directional arrows
3	R3-17	30 x 24		N/A	Bike Lane	8	M7-1	12 x 9		Left	Directional arrows
4	R3-17b	30 x 12		N/A	Ends	9	M4-11	12 x 4			Begin
5	M7-6	12 x 9		Str / Right	Directional arrows	10	M4-12	12 x 4			End
5*	M7-6	12 x 9		Str / Left	Directional arrows	13	D1-1b	24x6	To Belmont Ave		

Revisions		Illinois Department of Transportation Village of Downers Grove Bike Plan Signage
Name	Date	
DAT	1/29/07	
DAT	4/25/07	
DAT	8/22/07	
Drawn by: DAT		0 110 220 Feet
Date: 8/22/07		

Notes: Sign locations are approximate. It is recommended to locate signage on existing poles where feasible. See Sheet 9 for additional signage design detail.

MATCHLINE SHEET 14

F.A. RTE	SECTION	COUNTY	TOTAL SHEETS	SHEET NO.
N/A	02-0093-00-BT	DUPAGE	14	13
SARATOGA: PRAIRIE TO BROOKSIDE				
FED. ROAD DIST NO.	ILLINOIS	FED. AID PROJECT		

Contract Number 83972

Bikeway Type

—— Bike Route

..... Bike Lanes

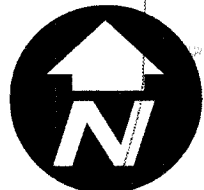

Future trail connection through Doerhoeffer Park

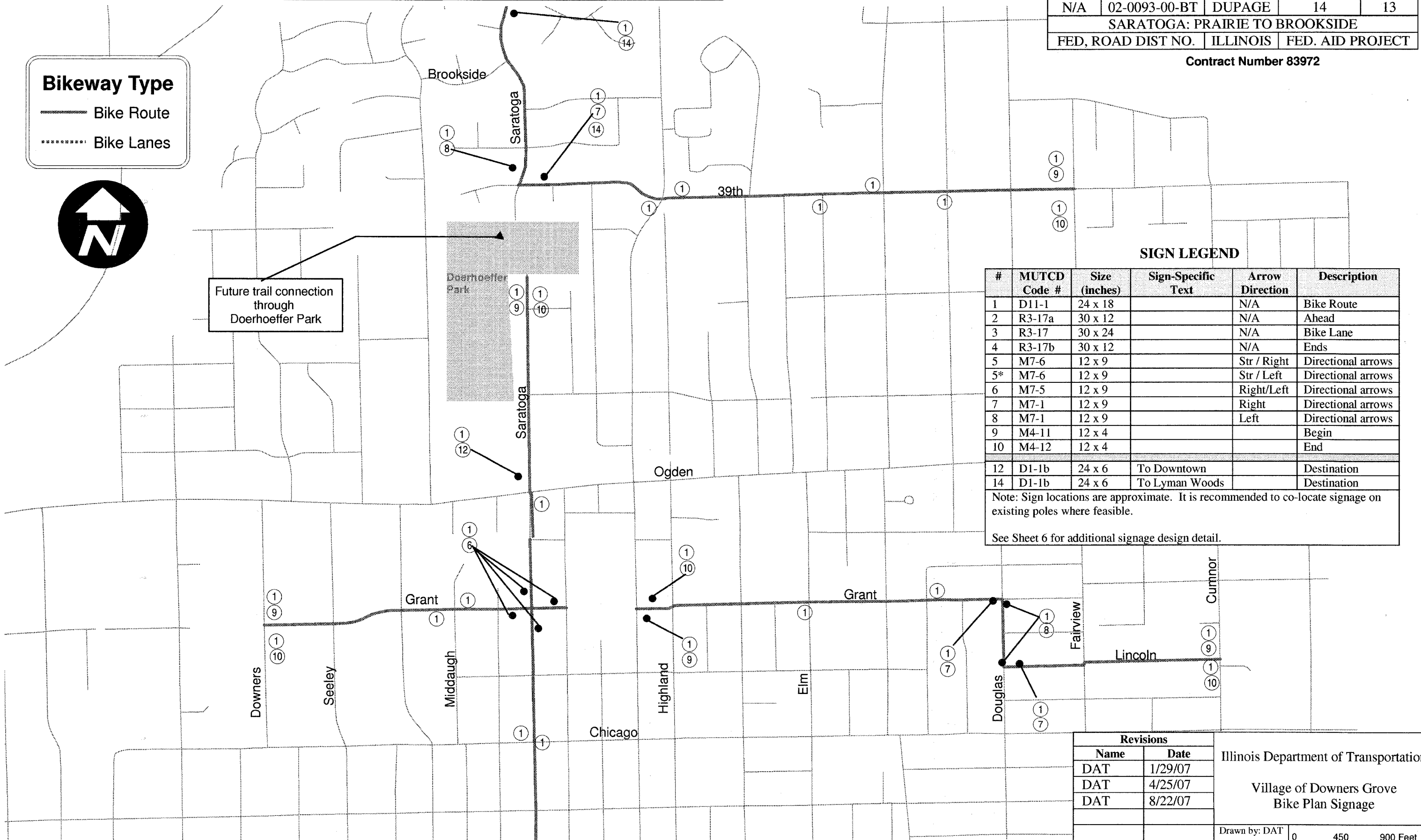

SIGN LEGEND

#	MUTCD Code #	Size (inches)	Sign-Specific Text	Arrow Direction	Description
1	D11-1	24 x 18		N/A	Bike Route
2	R3-17a	30 x 12		N/A	Ahead
3	R3-17	30 x 24		N/A	Bike Lane
4	R3-17b	30 x 12		N/A	Ends
5	M7-6	12 x 9		Str / Right	Directional arrows
5*	M7-6	12 x 9		Str / Left	Directional arrows
6	M7-5	12 x 9		Right/Left	Directional arrows
7	M7-1	12 x 9		Right	Directional arrows
8	M7-1	12 x 9		Left	Directional arrows
9	M4-11	12 x 4			Begin
10	M4-12	12 x 4			End
12	D1-1b	24 x 6	To Downtown		Destination
14	D1-1b	24 x 6	To Lyman Woods		Destination

Note: Sign locations are approximate. It is recommended to co-locate signage on existing poles where feasible.

See Sheet 6 for additional signage design detail.

Revisions		Illinois Department of Transportation Village of Downers Grove Bike Plan Signage
Name	Date	
DAT	1/29/07	
DAT	4/25/07	
DAT	8/22/07	
Drawn by: DAT Date: 8/22/07		0 450 900 Feet

MATCHLINE SHEET 11

F.A. RTE	SECTION	COUNTY	TOTAL SHEETS	SHEET NO.
N/A	02-0093-00-BT	DUPAGE	14	14
SARATOGA: BROOKSIDE - 31st				
FED, ROAD DIST NO.	ILLINOIS	FED. AID PROJECT		

Contract Number 83972

Bikeway Type

———— Bike Route

..... Bike Lanes



SIGN LEGEND

#	MUTCD Code #	Size (inches)	Sign-Specific Text	Arrow Direction	Description
1	D11-1	24 x 18		N/A	Bike Route
2	R3-17a	30 x 12		N/A	Ahead
3	R3-17	30 x 24		N/A	Bike Lane
4	R3-17b	30 x 12		N/A	Ends
5	M7-6	12 x 9		Str / Right	Directional arrows
5*	M7-6	12 x 9		Str / Left	Directional arrows
6	M7-5	12 x 9		Right/Left	Directional arrows
7	M7-1	12 x 9		Right	Directional arrows
8	M7-1	12 x 9		Left	Directional arrows
9	M4-11	12 x 4			Begin
10	M4-12	12 x 4			End
12	D1-1b	24 x 6	To Downtown		Destination
14	D1-1b	24 x 6	To Lyman Woods		Destination

Note: Sign locations are approximate. It is recommended to co-locate signage on existing poles where feasible.

See Sheet 6 for additional signage design detail.

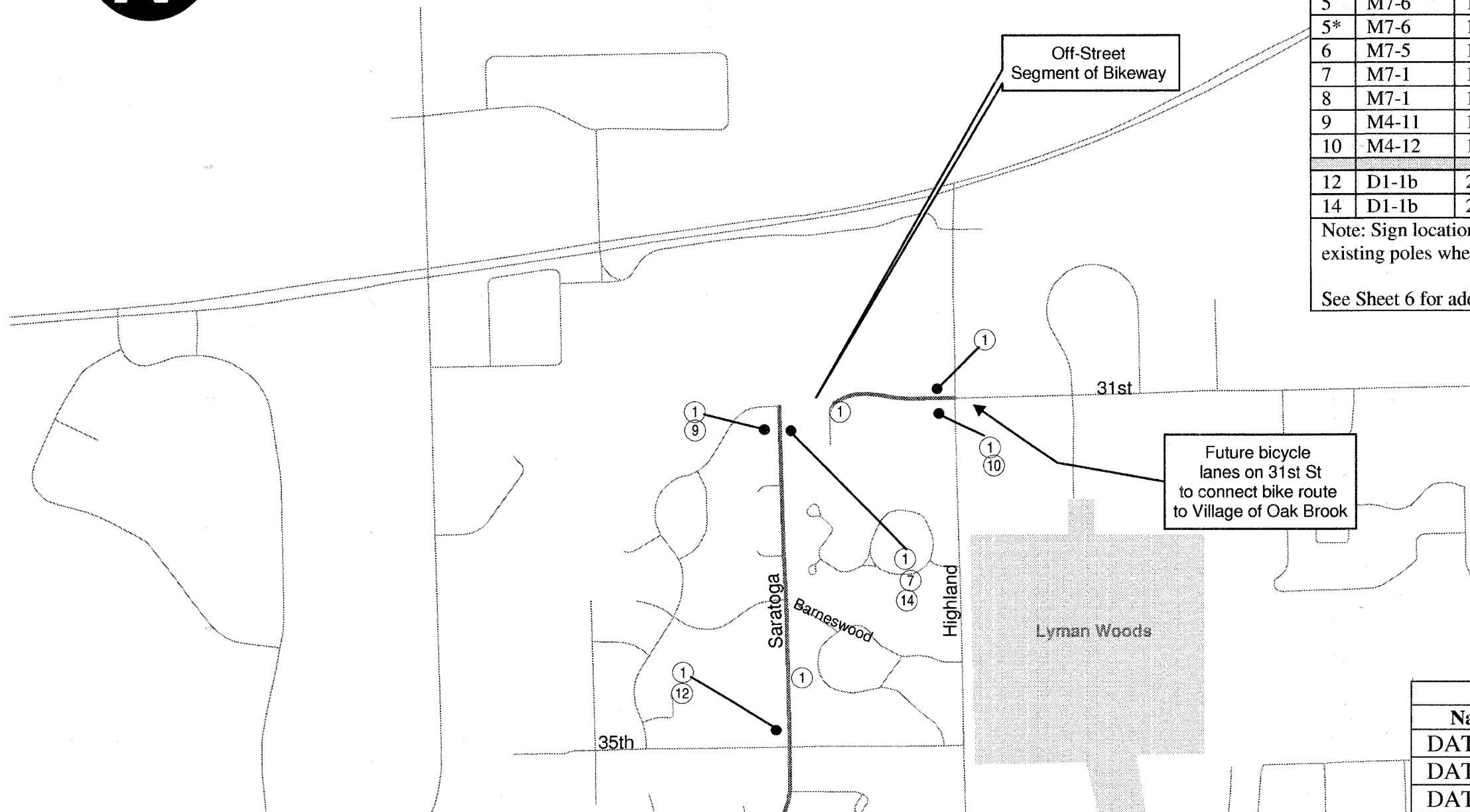

Off-Street Segment of Bikeway

Future bicycle lanes on 31st St to connect bike route to Village of Oak Brook

MATCHLINE SHEET 13

Revisions		Illinois Department of Transportation Village of Downers Grove Bike Plan Signage
Name	Date	
DAT	1/29/07	
DAT	4/25/07	
DAT	8/22/07	
Drawn by: DAT		0 500 1,000 Feet
Date: 8/22/07		