

F.A.U. RTE.	SECTION	COUNTY	TOTAL SHEETS	SHEET NO.
3573	07-00058-00-RS	DUPAGE	21	5
STA. 10+00	TO STA. 22+00			
FED. ROAD DIST. NO.	ILLINOIS	FED. AID PROJECT		
	ZURICH LN	CONTRACT NO. 83976		

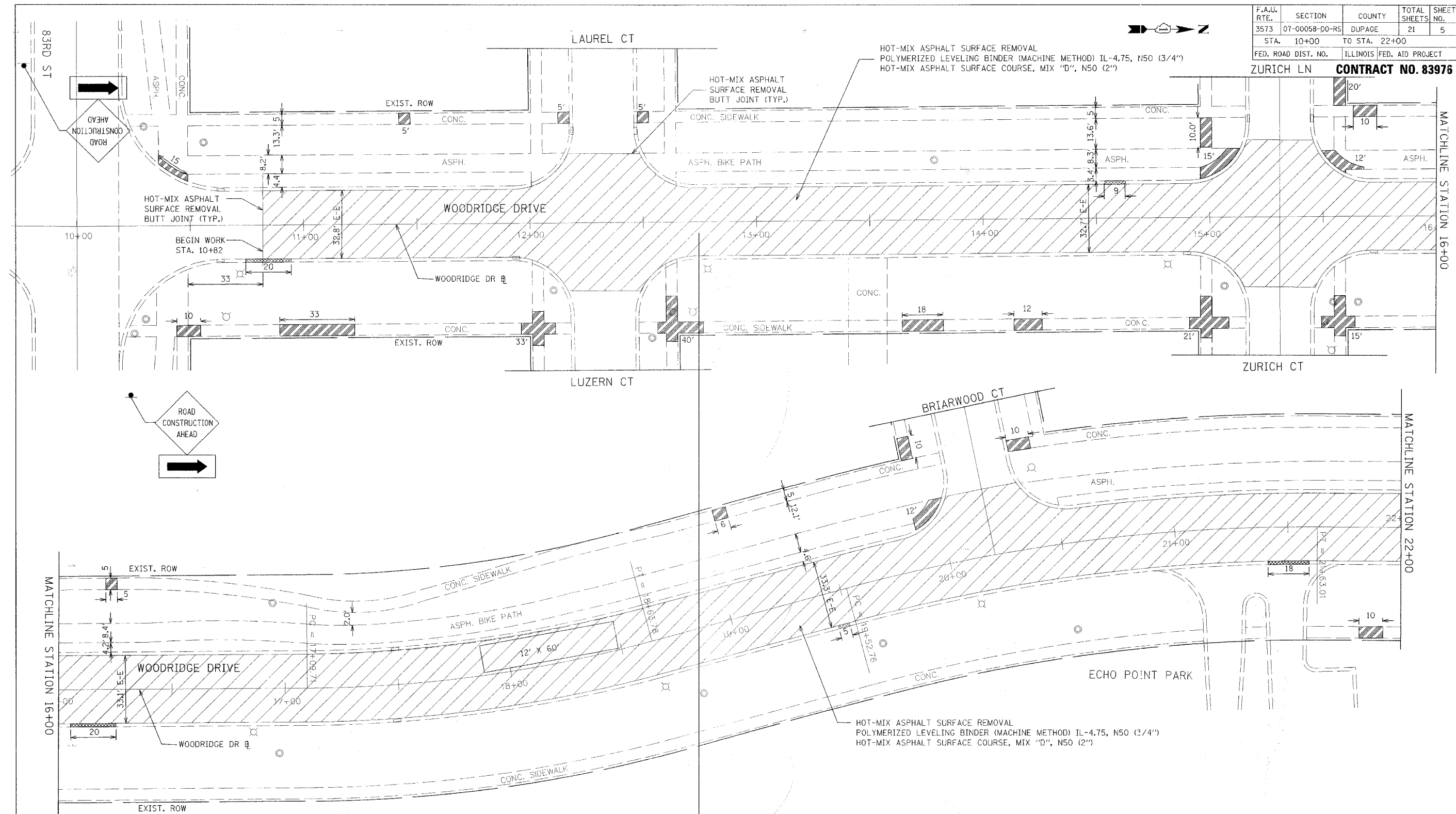

HOT-MIX ASPHALT SURFACE REMOVAL
 POLYMERIZED LEVELING BINDER (MACHINE METHOD) IL-4.75, N50 (3/4")
 HOT-MIX ASPHALT SURFACE COURSE, MIX "D", N50 (2")

HOT-MIX ASPHALT SURFACE REMOVAL
 POLYMERIZED LEVELING BINDER (MACHINE METHOD) IL-4.75, N50 (3/4")
 HOT-MIX ASPHALT SURFACE COURSE, MIX "D", N50 (2")

NOTES:
 ALL TRAFFIC CONTROL SIGNAGE AS REQUIRED ON THE PLANS AND ON THE STANDARD DETAIL DRAWINGS WILL BE PAID FOR AS PART OF THE TRAFFIC CONTROL AND PROTECTION STANDARDS. ALL TRAFFIC CONTROL SIGNS SHOWN ON THE PLANS SHALL BE PLACED AND ACCEPTED PRIOR TO THE COMMENCEMENT OF ANY CONSTRUCTION ACTIVITIES. ALL TRAFFIC CONTROL SIGNS SHALL BE MAINTAINED UNTIL ALL CONSTRUCTION ACTIVITY IS COMPLETE.

SIDESTREET SIGNING DETAIL

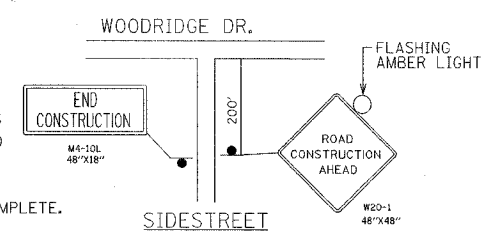

- NOTES:
1. THE ACTUAL LOCATION AND QUALITY OF CURB AND GUTTER REMOVAL AND REPLACEMENT, SIDEWALK REMOVAL AND REPLACEMENT, DRIVEWAY REMOVAL AND REPLACEMENT, AND PAVEMENT PATCHING WILL BE DETERMINED IN THE FIELD, DURING CONSTRUCTION, BY THE RESIDENT ENGINEER.
 2. RESTORATION OF THE WORK AREA SHALL BE INCIDENTAL TO THE CONTRACT WITHOUT ANY EXTRA COMPENSATION ALLOWED TO THE CONTRACTOR.
 3. FRAMES AND GRATES TO BE ADJUSTED SHALL BE ADJUSTED AS NEEDED IN THE FIELD AS DETERMINED BY THE RESIDENT ENGINEER.
 4. ALL CRACK FILL MATERIAL TO BE REMOVED ENTIRELY ALONG CURB LINE.

LEGEND

	HOT-MIX ASPHALT SURFACE REMOVAL AND REPLACEMENT
	SIDEWALK REMOVAL AND REPLACEMENT
	DRIVEWAY REMOVAL 4' FROM BACK OF CURB (TYP.)
	COMBINATION CONCRETE CURB AND GUTTER REMOVAL AND REPLACEMENT

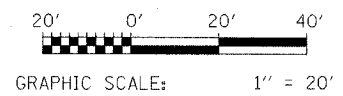

REVISIONS	
NAME	DATE

ILLINOIS DEPARTMENT OF TRANSPORTATION
 WOODRIDGE DRIVE
 RESURFACING PLAN
 STA 10+00 - 22+00
 DRAWN BY: LLM
 DATE: OCTOBER 12, 2007
 CHECKED BY: JRP