

F.A. RTE.	SECTION	COUNTY	TOTAL SHEETS	SHEET NO.
3573	07-00058-00-RS	DUPAGE	21	1

CONTRACT NO. 83976

INDEX OF SHEETS

SHEET NO.	DESCRIPTION
1	TITLE
2	GENERAL NOTES, STANDARDS
3	SUMMARY OF QUANTITIES
4	TYPICAL SECTIONS
5-9	RESURFACING PLAN
10-14	PAVEMENT MARKING PLAN
15	DETAILS FOR FRAMES AND LIDS ADJUSTMENT WITH MILLING
16	PAVEMENT PATCHING FOR HMA SURFACED PAVEMENT
17	CURB OR CURB AND GUTTER REMOVAL AND REPLACEMENT
18	TRAFFIC CONTROL AND PROTECTION FOR SIDE ROADS, INTERSECTIONS, AND DRIVEWAYS
19	DISTRICT ONE TYPICAL PAVEMENT MARKINGS
20	PAVEMENT MARKING LETTERS AND SYMBOLS FOR TRAFFIC STAGING
21	BUTT JOINT AND HMA TAPER DETAILS

STATE OF ILLINOIS
DEPARTMENT OF TRANSPORTATION
DIVISION OF HIGHWAYS

PLANS FOR PROPOSED FEDERAL AID HIGHWAY RESURFACING

**FAU 3573 ROUTE (WOODRIDGE DRIVE)
RESURFACING 75TH STREET TO 83RD STREET
SECTION 07-0C058-00-RS
PROJECT M-8003 (874)
VILLAGE OF WOODRIDGE
DUPAGE COUNTY
JOB NO: C-91-036-08**

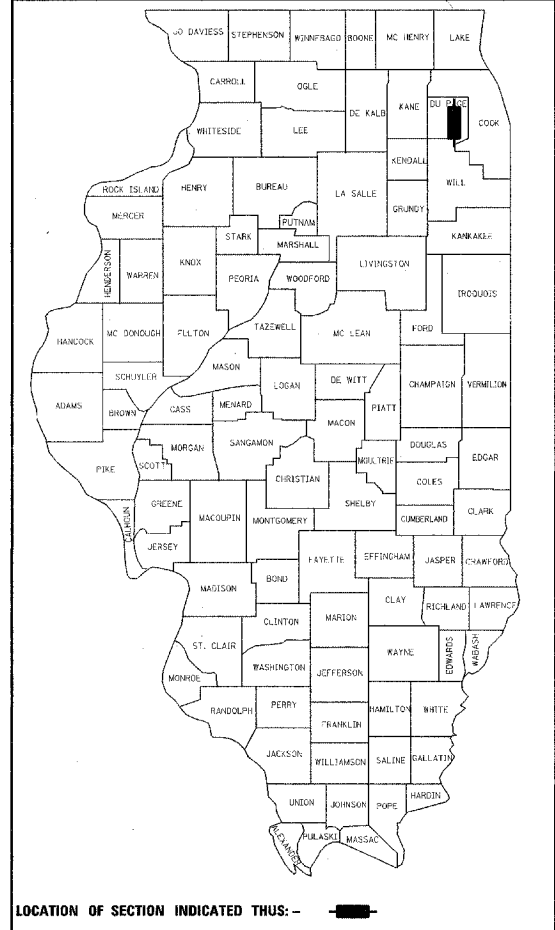

DESIGN DESIGNATION
5300 (08) COLLECTOR 1.3 (HMA 20)

TRAFFIC DATA
ADT (2006) = 5300
POSTED SPEED = 25 MPH

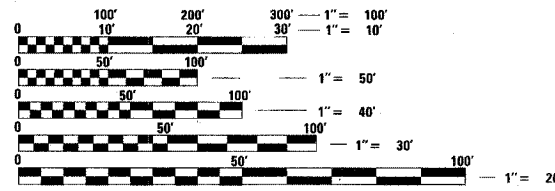

FULL SIZE PLANS HAVE BEEN PREPARED USING STANDARD ENGINEERING SCALES. REDUCED SIZED PLANS WILL NOT CONFORM TO STANDARD SCALES. IN MAKING MEASUREMENTS ON REDUCED PLANS, THE ABOVE SCALES MAY BE USED.

J.U.L.I.E.
JOINT UTILITY LOCATION INFORMATION FOR EXCAVATION
1-800-892-0123

CONTRACT NO. 83976

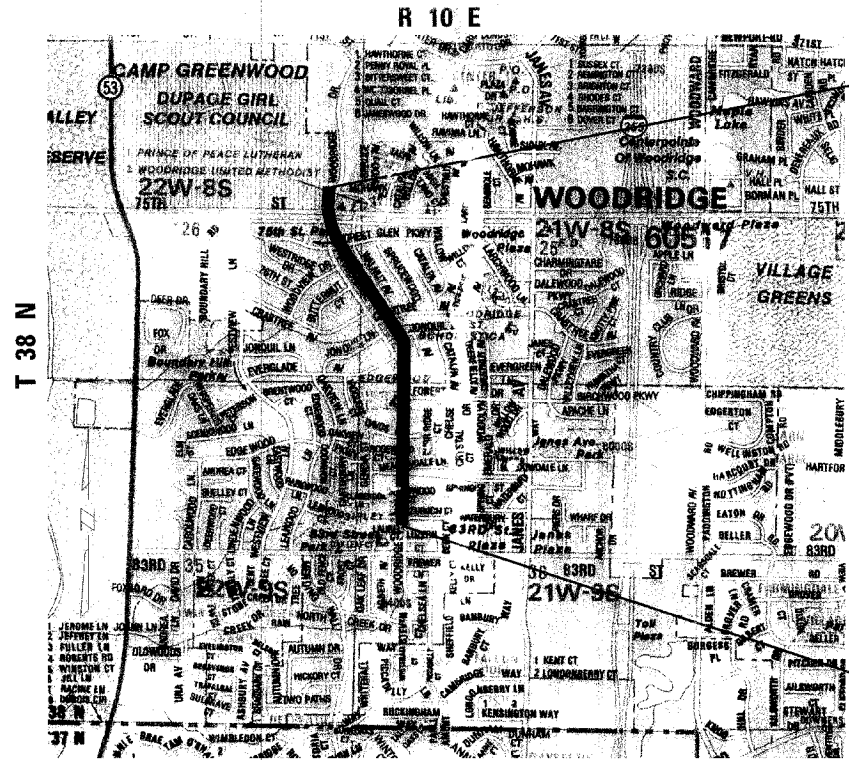

LOCATION MAP
NOT TO SCALE

GROSS LENGTH AND NET LENGTH = 5433.00 FEET

**PROJECT LIMIT
STATION 65 + 15**

**PROJECT LIMIT
STATION 10 + 82**



David D. Landwehr
10/19/07
E.S. 11/20/09

**STATE OF ILLINOIS
DEPARTMENT OF TRANSPORTATION
DIVISION OF HIGHWAYS**

Approved October 9, 2007
Zill A. Khan
VILLAGE OF WOODRIDGE, VILLAGE ENGINEER

Passed November 6, 2007
Christopher Holt
DISTRICT ENGINEER OF LOCAL ROADS AND STREETS

Released for Bid
Based on Limited
Review Nov. 7, 2007
Pierre O'Keefe, Esq.
DEPUTY DIRECTOR OF HIGHWAYS, REGION 1 ENGINEER

**PRINTED BY THE AUTHORITY
OF THE STATE OF ILLINOIS**

PLANS PREPARED BY:
URS 100 S. WACKER DR., SUITE 500 TEL (312)-939-1000
CHICAGO IL, 60606 FAX (312)-939-4119

ASSOCIATE FIELD ENGINEER, JESSICA FELICIANO, 847-705-4487

F.A.U. RTE.	SECTION	COUNTY	TOTAL SHEETS	SHEET NO.
3573	07-00058-00-RS	DUPAGE	21	2
STA.		TO STA.		
FED. ROAD DIST. NO.		ILLINOIS	FED. AID PROJECT	

CONTRACT NO. 83976

GENERAL NOTES

SPECIFICATIONS, STANDARDS AND SPECIAL PROVISIONS:

ALL CONSTRUCTION SHALL BE PERFORMED IN ACCORDANCE WITH THE ILLINOIS DEPARTMENT OF TRANSPORTATION "STANDARD SPECIFICATIONS FOR ROAD AND BRIDGE CONSTRUCTION", ADOPTED JANUARY 1, 2008. (HEREINAFTER REFERRED TO AS THE STANDARD SPECIFICATIONS); THE "SUPPLEMENTAL SPECIFICATIONS AND RECURRING SPECIAL PROVISIONS", ADOPTED JAN. 1, 2007; THE LATEST EDITION OF THE "ILLINOIS MANUAL ON UNIFORM TRAFFIC CONTROL DEVICES FOR STREETS"; THE "DETAILS" ON THE PLANS AND THE "SPECIAL PROVISIONS" INCLUDED IN THE CONTRACT DOCUMENTS. ANY REFERENCE TO STANDARDS THROUGHOUT THE PLANS OR SPECIAL PROVISIONS SHALL BE INTERPRETED AS THE LATEST STANDARD OF THE ILLINOIS DEPARTMENT OF TRANSPORTATION.

PROJECT COORDINATION

THE CONTRACTOR SHALL NOTIFY THE VILLAGE ENGINEER AT LEAST 72 HOURS IN ADVANCE OF BEGINNING WORK AND SHALL COORDINATE ALL CONSTRUCTION OPERATIONS WITH THE ENGINEER. ATTENTION IS CALLED TO SECTION 701 OF THE STANDARD SPECIFICATIONS AND THE SPECIAL PROVISIONS FOR TRAFFIC CONTROL AND PROTECTION. THE STORAGE OF EQUIPMENT AND/OR MATERIALS WITHIN THE RIGHT-OF-WAY SHALL REQUIRE PRIOR APPROVAL OF THE ENGINEER.

SAFETY

ALL CONSTRUCTION PERSONNEL WILL BE REQUIRED TO WEAR FLUORESCENT ORANGE SAFETY VESTS AT ALL TIMES WHILE ON THE CONSTRUCTION SITE.

EXISTING UTILITIES:

EXISTING UTILITIES ARE SHOWN ON THE PLANS ACCORDING TO INFORMATION OBTAINED FROM THE VILLAGE OF WOODRIDGE AND FIELD SURVEYS. THE ACCURACY AND COMPLETENESS OF SAID INFORMATION IS NOT GUARANTEED. IT SHALL BE THE CONTRACTOR'S RESPONSIBILITY TO VERIFY THE EXISTENCE, NATURE AND EXACT LOCATIONS OF ALL UTILITY LINES AND APPURTENANCES WITHIN THE LIMITS OF THE IMPROVEMENTS. THE CONTRACTOR SHALL GIVE PRIOR NOTIFICATION TO THE UTILITY COMPANIES AND THE VILLAGE OF WOODRIDGE OF HIS INTENTION TO BEGIN WORK.

CERTAIN EXISTING UTILITY FACILITIES WHICH INTERFERE WITH THE PROPOSED CONSTRUCTION WILL HAVE TO BE REMOVED AND RELOCATED BY THE UTILITY COMPANIES OR THE VILLAGE OF WOODRIDGE. THE CONTRACTOR SHALL COORDINATE AND SCHEDULE PROPOSED WORK WITH ALL AFFECTED UTILITY COMPANIES AND THE VILLAGE OF WOODRIDGE SO AS TO INSURE THE TIMELY COMPLETION AND MAINTENANCE OF SAID UTILITY FACILITIES.

THE CONTRACTOR SHALL BE HELD RESPONSIBLE FOR INTERFERENCE WITH OR DAMAGE TO ANY EXISTING UTILITY FACILITY AND APPURTENANCES SUCH AS WATER MAINS, SEWERS, GAS MAINS, ELECTRIC AND SIGNAL CABLES, CONDUITS, ETC., RESULTING FROM THE OPERATIONS OF THE CONTRACTORS EQUIPMENT OR EMPLOYEES AND SHALL REPAIR OR REPLACE SAME AT THE CONTRACTORS EXPENSE AND WITH THE LEAST POSSIBLE DELAY. NO EXTRA COMPENSATION WILL BE ALLOWED TO THE CONTRACTOR FOR ANY EXPENSES INCURRED BECAUSE OF DELAYS, INCONVENIENCES OR INTERRUPTIONS TO HIS WORK RESULTING FROM COMPLIANCE WITH THE ABOVE REQUIREMENTS.

THE CONTRACTOR SHALL BE RESPONSIBLE FOR CALLING J.U.L.I.E. AT TOLL FREE NUMBER 800-892-0123 AND THE VILLAGE OF WOODRIDGE PUBLIC WORKS DEPARTMENT AT 630-719-4753 REQUESTING UTILITY LOCATION STAKING PRIOR TO EXCAVATING.

TRAFFIC CONTROL AND MAINTENANCE:

THE CONTRACTOR SHALL SCHEDULE HIS WORK SO THAT ONLY ONE TEMPORARY LANE CLOSURE IN EACH DIRECTION IS IMPLEMENTED AT A TIME. A LANE CLOSURE WILL ONLY BE PERMITTED DURING CONSTRUCTION OPERATIONS AND IN ACCORDANCE WITH THE APPLICABLE IDOT STANDARD. THE CONTRACTOR SHALL FURNISH, ERECT, AND MAINTAIN ALL SIGNS, BARRICADES AND OTHER TRAFFIC CONTROL DEVICES INCLUDING FLAGGERS REQUIRED TO MAINTAIN TRAFFIC FLOW. THE CONTRACTOR SHALL SCHEDULE HIS WORK SO THAT NO HOLES IN THE PAVEMENT REMAIN OPEN OVER NIGHT.

ACCESS TO ADJUTING PROPERTY SHALL BE PROVIDED AT ALL TIMES DURING CONSTRUCTION OF THIS PROJECT. TIME REQUIRED FOR CONSTRUCTION AT DRIVEWAYS SHALL BE LIMITED TO THE MINIMUM TIME REQUIRED FOR SAID CONSTRUCTION AND, IF REQUIRED, TEMPORARY AGGREGATE SURFACE FOR DRIVEWAY ACCESS SHALL BE PROVIDED.

STATE STANDARDS

STANDARD NO.	DESCRIPTION
000001-05	STANDARD SYMBOLS, ABBREVIATIONS AND PATTERNS
424001-05	CURB RAMPS FOR SIDEWALK
442201-03	CLASS C AND D PATCHES
606001-03	CONCRETE CURB TYPE B AND COMBINATION CONCRETE CURB AND GUTTER
701501-04	URBAN LANE CLOSURE, 2L, 2W UNDIVIDED
701701-05	URBAN LANE CLOSURE MULTILANE INTERSECTION
701801-03	LANE CLOSURE MULTILANE 1W OR 2W CROSSWALK OR SIDEWALK CLOSURE
701901-06	TRAFFIC CONTROL DEVICES
780001-01	TYPICAL PAVEMENT MARKINGS
886001	DETECTOR LOOP INSTALLATIONS
886006	TYPICAL LAYOUTS FOR DETECTION LOOPS

DISPOSAL OF EXCESS MATERIAL:

ALL EXCESS MATERIAL AND ANY OTHER DEBRIS SHALL BE DISPOSED OF BY THE CONTRACTOR AT AN OFF-SITE DISPOSAL AREA.

PROTECTION OF PUBLIC/PRIVATE PROPERTY:

THE CONTRACTOR SHALL PROTECT ALL EXISTING TREES, SHRUBS, FENCES, DRAIN LINES, POWER LINES, AND OTHER PUBLIC/PRIVATE PROPERTY. ANY ITEM THAT IS DAMAGED SHALL BE REPLACED OR REPAIRED BY THE CONTRACTOR AS DIRECTED BY THE ENGINEER AT NO ADDITIONAL COST TO THE CONTRACT.

SAW CUTTING FOR REMOVAL:

THE CONTRACTOR SHALL BE REQUIRED TO MAKE A FULL DEPTH SAW CUT AT THE EDGE OF PAVEMENT ADJACENT TO THE REMOVAL OF ALL CONCRETE CURB OR COMBINATION CONCRETE CURB AND GUTTER. THE CONTRACTOR SHALL MAKE ALL FULL DEPTH SAW CUTS REQUIRED FOR THE REMOVAL OF CONCRETE CURB AND GUTTERS, SIDEWALKS AND DRIVEWAYS AS SPECIFIED, OR AS DIRECTED BY THE ENGINEER. THE COST SHALL BE CONSIDERED INCLUDED IN THE COST FOR REMOVAL OF THE SPECIFIED ITEM IN THE CONTRACT.

EXISTING STREET CLEANLINESS:

THE CONTRACTOR SHALL KEEP EXISTING ADJACENT STREETS CLEAN OF DIRT, MUD, AND OTHER DEBRIS AND, WHEN NECESSARY, CLEAN SAID PAVEMENTS ON A DAILY BASIS OR WHEN DIRECTED BY THE ENGINEER.

BASE COURSE CLEANING:

PRIOR TO APPLYING THE HOT-MIX ASPHALT PRIME COAT, THE BASE SURFACE INCLUDING GUTTERS SHALL BE CLEANED OF LOOSE GRINDINGS, LEAVES, OF ALL DUST, DIRT, WEEDS AND OTHER FOREIGN MATERIALS. ALL CRACK FILL MATERIAL SHALL BE REMOVED IN ITS ENTIRETY ALONG THE CURB LINE. COST TO BE CONSIDERED INCLUDED IN THE COST OF THE HOT-MIX ASPHALT SURFACE WORK.

BASE PATCHING AND REPAIR

PRIOR TO THE PLACEMENT OF PATCHES FOR BASE REPAIR, THE SUBGRADE SHALL BE INSPECTED BY THE ENGINEER. IF ADDITIONAL SUBBASE REPAIR IS NECESSARY, THE AREA SHALL BE UNDERCUT AND BACKFILLED WITH P.C.E. MATERIAL AS APPROVED BY THE ENGINEER. THE UNDERCUTTING, REMOVAL, HAULING AND DISPOSAL OF THE UNSUITABLE MATERIAL WILL NOT BE MEASURED AND PAID SEPARATELY, BUT SHALL BE CONSIDERED INCLUDED IN THE ITEM OF POROUS GRANULAR EMBANKMENT, SUBGRADE AS REQUIRED BY THE ENGINEER.

CLEAN-UP AND DISPOSAL:

THE CONTRACTOR SHALL MAINTAIN THE SITE IN A CLEAN AND ORDERLY MANNER. DEBRIS AND ANY SURPLUS MATERIAL SHALL BE REMOVED AND RESTORATION SHALL PROCEED AS THE WORK PROCEEDS. IF THE OWNER OR THE ENGINEER SO DIRECTS, THE CONTRACTOR SHALL STOP ALL OTHER WORK AND CONCENTRATE ON CLEAN-UP AND RESTORATION. DEBRIS AND SURPLUS MATERIAL SHALL BE DISPOSED OF BY THE CONTRACTOR OFF-SITE.

CONSTRUCTION LIMITS:

THE CONTRACTOR SHALL CONFINE OPERATIONS WITHIN THE DEDICATED ROADWAY RIGHTS-OF-WAY. ANY DAMAGE OUTSIDE OF SAID RIGHTS-OF-WAY SHALL BE REPAIRED AT THE CONTRACTOR'S EXPENSE.

LANDSCAPING RESTORATION:

ALL LANDSCAPING DAMAGED DURING CONSTRUCTION SHALL BE RESTORED WITH A MINIMUM OF 4" OF PULVERIZED TOP SOIL AND SEEDING CLASS, 2A THIS WORK WILL NOT BE PAID FOR SEPARATELY, BUT SHALL BE CONSIDERED INCLUDED IN COMBINATION WITH CONCRETE CURB AND GUTTER REMOVAL AND REPLACEMENT, OR SIDEWALK REPLACEMENT.

CURB AND GUTTER REPLACEMENT:

THE MINIMUM THICKNESS OF THE PROPOSED GUTTER FLAG SHALL BE 10" UNLESS OTHERWISE STATED IN THE PLANS OR DIRECTED BY THE ENGINEER.

DISTURBED PAVEMENT AND GROUND AREAS SHALL BE RESTORED IMMEDIATELY FOLLOWING REPLACEMENT OPERATIONS. IN ALL CASES WITHIN THREE (3) WORKING DAYS FROM THE DATE THE CURB AND GUTTER WAS CAST. THE ENGINEER SHALL STOP THE CONTRACTOR FROM FURTHER REMOVAL OPERATIONS AT ANY TIME HE DETERMINES THE RESTORATION IS NOT BEING DONE IN A TIMELY MANNER. FAILURE TO COMPLY WITH THESE REQUIREMENTS SHALL RESULT IN THE ENFORCEMENT OF LIQUIDATED DAMAGES IN THE AMOUNT SPECIFIED IN ARTICLE 108.09 OF THE STANDARD SPECIFICATIONS.

REVISIONS		ILLINOIS DEPARTMENT OF TRANSPORTATION WOODRIDGE DRIVE GENERAL NOTES & STANDARDS
NAME	DATE	
		DRAWN BY: LLM CHECKED BY: JRP DATE: OCTOBER 12, 2007

F.A.U. RTE.	SECTION	COUNTY	TOTAL SHEETS	SHEET NO.
3573	07-00058-00-RS	DUPAGE	21	4
STA.		TO STA.		
FED. ROAD DIST. NO.		ILLINOIS	FED. AID PROJECT	

CONTRACT NO. 83976

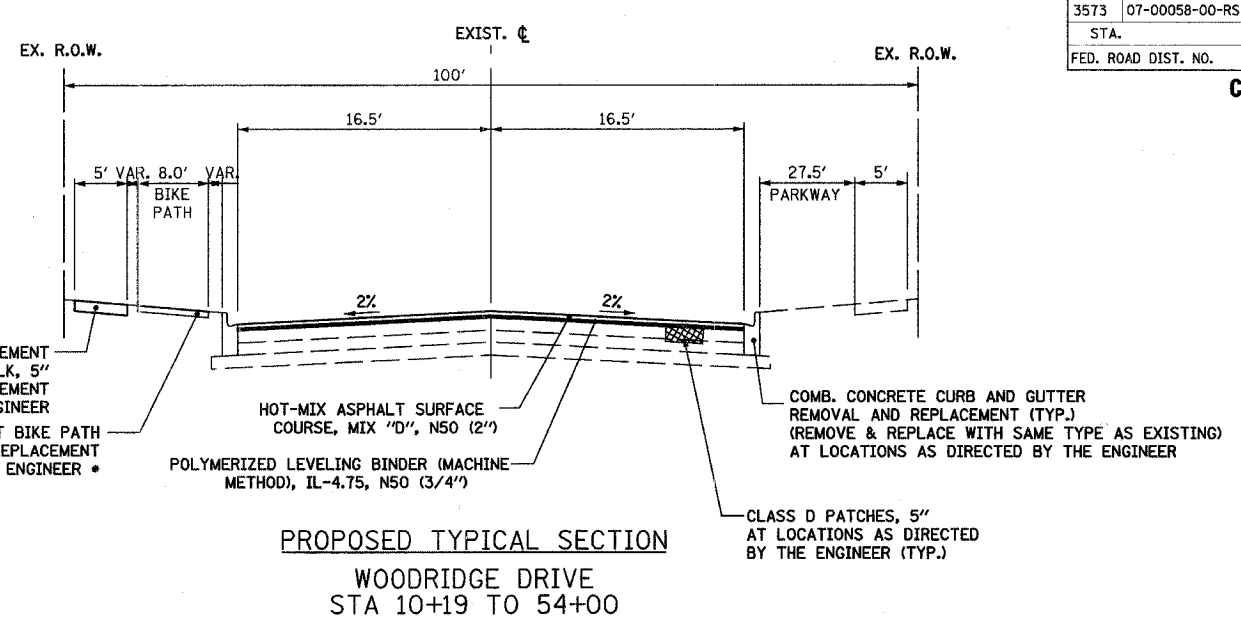
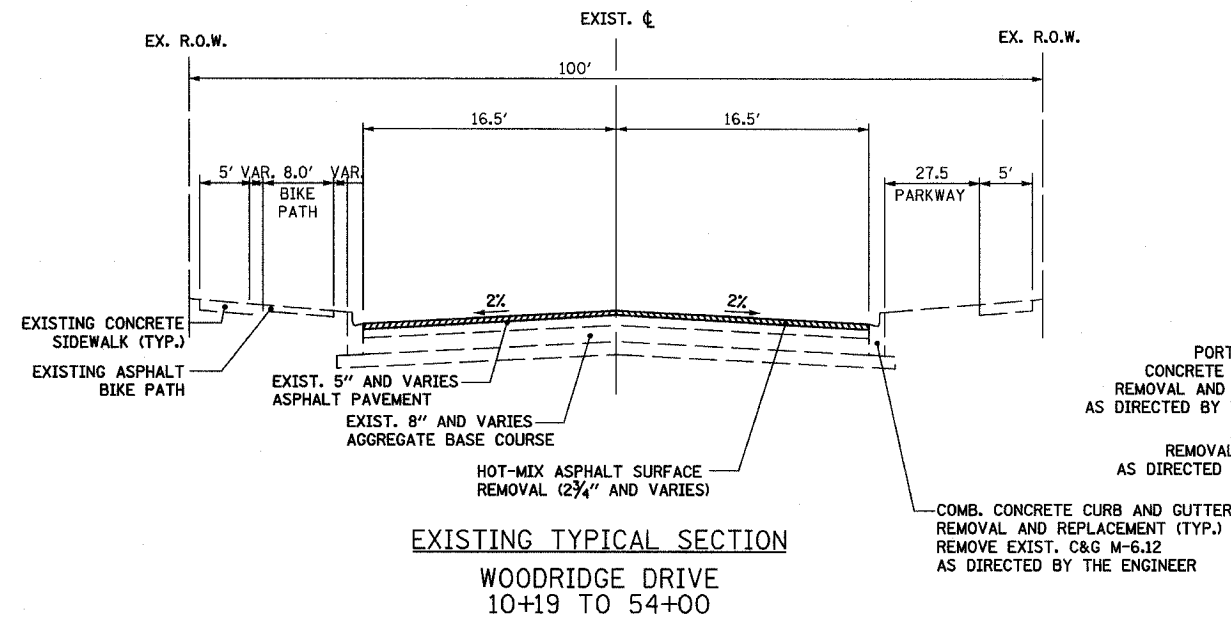

• REMOVAL PAID FOR AS SIDEWALK REMOVAL
 REPLACEMENT PID FOR AS HMA SURFACE COURSE, MIX "D", N50 (2") (STONE BASE REPLACEMENT SHALL BE INCLUDED IN THE HMA SURFACE COURSE PAY ITEM)

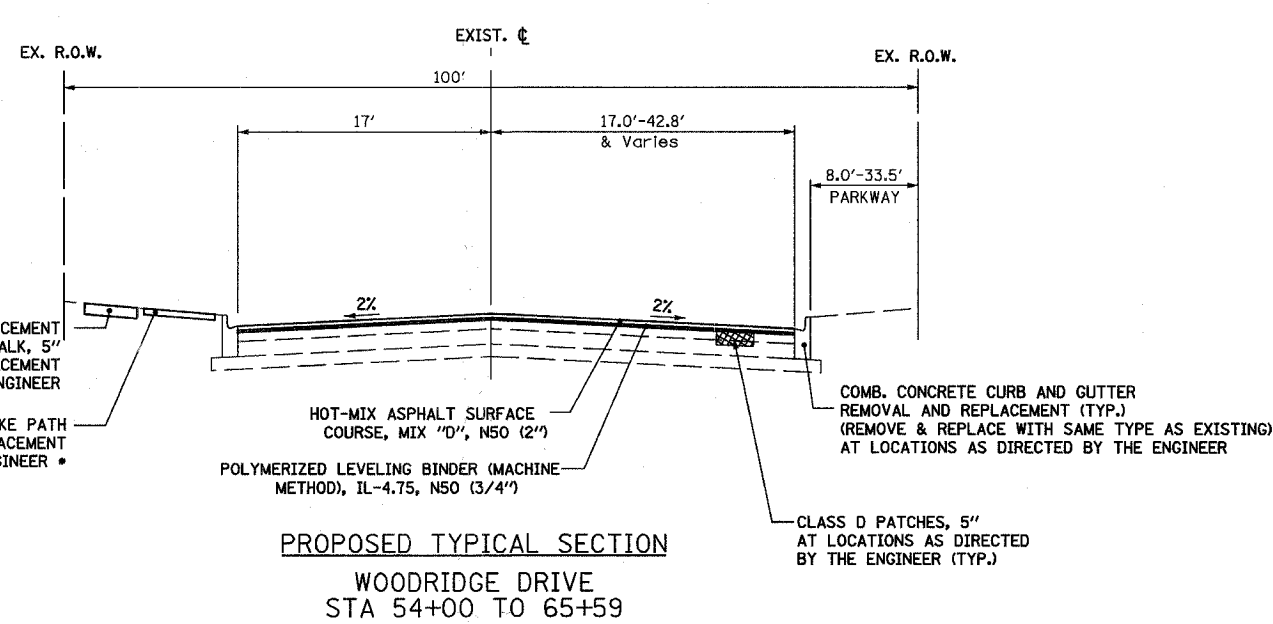
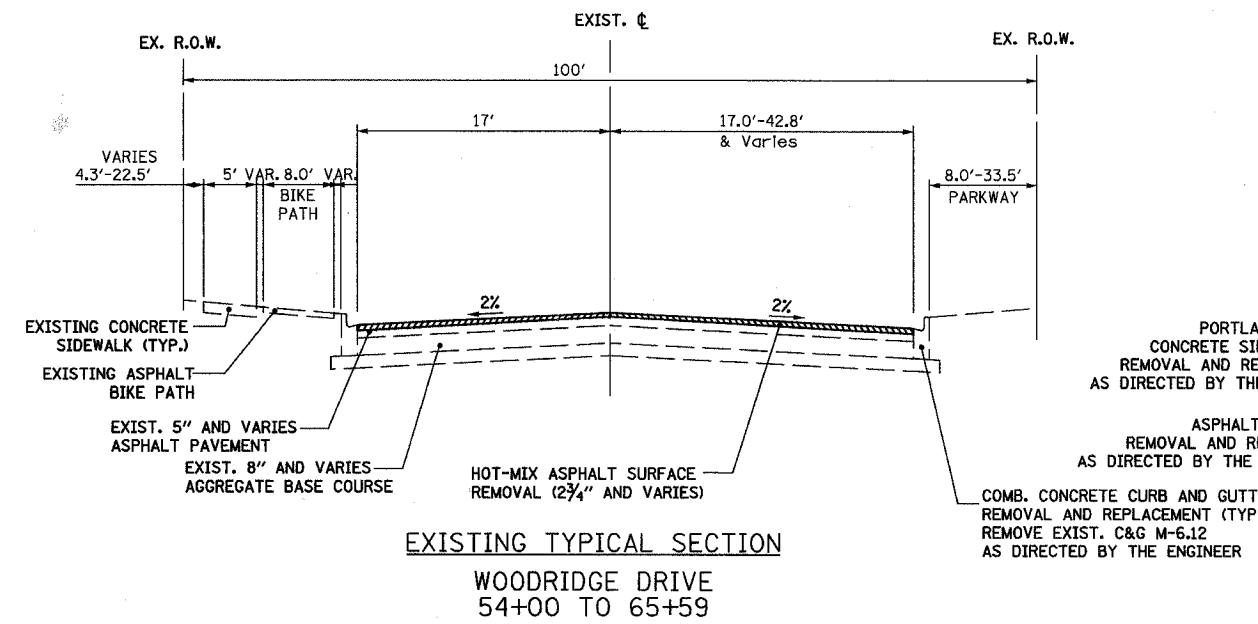

RESURFACING

MAINLINE PAVEMENT
 --WOODRIDGE DRIVE--
 83RD STREET TO 75TH STREET
 HOT-MIX ASPHALT MIXTURE REQUIREMENTS

ITEM	AC TYPE	VOIDS
ROADWAY HOT-MIX ASPHALT SURFACE COURSE, MIX "D", N50 (IL9.5MM) 2"	PG 64-22	4% @ 50 Gyr.
POLYMERIZED LEVELING BINDER (MACHINE METHOD), IL-4.75, N50 3/4"	SBS/SBR PG 76-28/-22	4% @ 50 Gyr.
PATCHING CLASS D PATCHES, (HMA BINDER IL-19MM) 5"	PG 64-22 *	4% @ 70 Gyr.
HMA REPLACEMENT OVER PATCHES (HMA BINDER IL-19MM)	PG 64-22 *	4% @ 70 Gyr.

THE UNIT WEIGHT USED TO CALCULATE ALL HOT-MIX ASPHALT SURFACE MIXTURES IS 112 LBS/ SQ YD/IN

• WHEN RAP EXCEEDS 20%, THE NEW ASPHALT BINDER IN THE MIX SHALL BE PG 58-22

REVISIONS	
NAME	DATE

ILLINOIS DEPARTMENT OF TRANSPORTATION
 WOODRIDGE DRIVE
 TYPICAL SECTIONS

DRAWN BY: LLM
 CHECKED BY: JRP
 DATE: OCTOBER 12, 2007

F.A.U. RTE.	SECTION	COUNTY	TOTAL SHEETS	SHEET NO.
3573	07-00058-00-RS	DUPAGE	21	5
STA. 10+00	TO STA. 22+00			
FED. ROAD DIST. NO.	ILLINOIS	FED. AID PROJECT		
	ZURICH LN	CONTRACT NO. 83976		

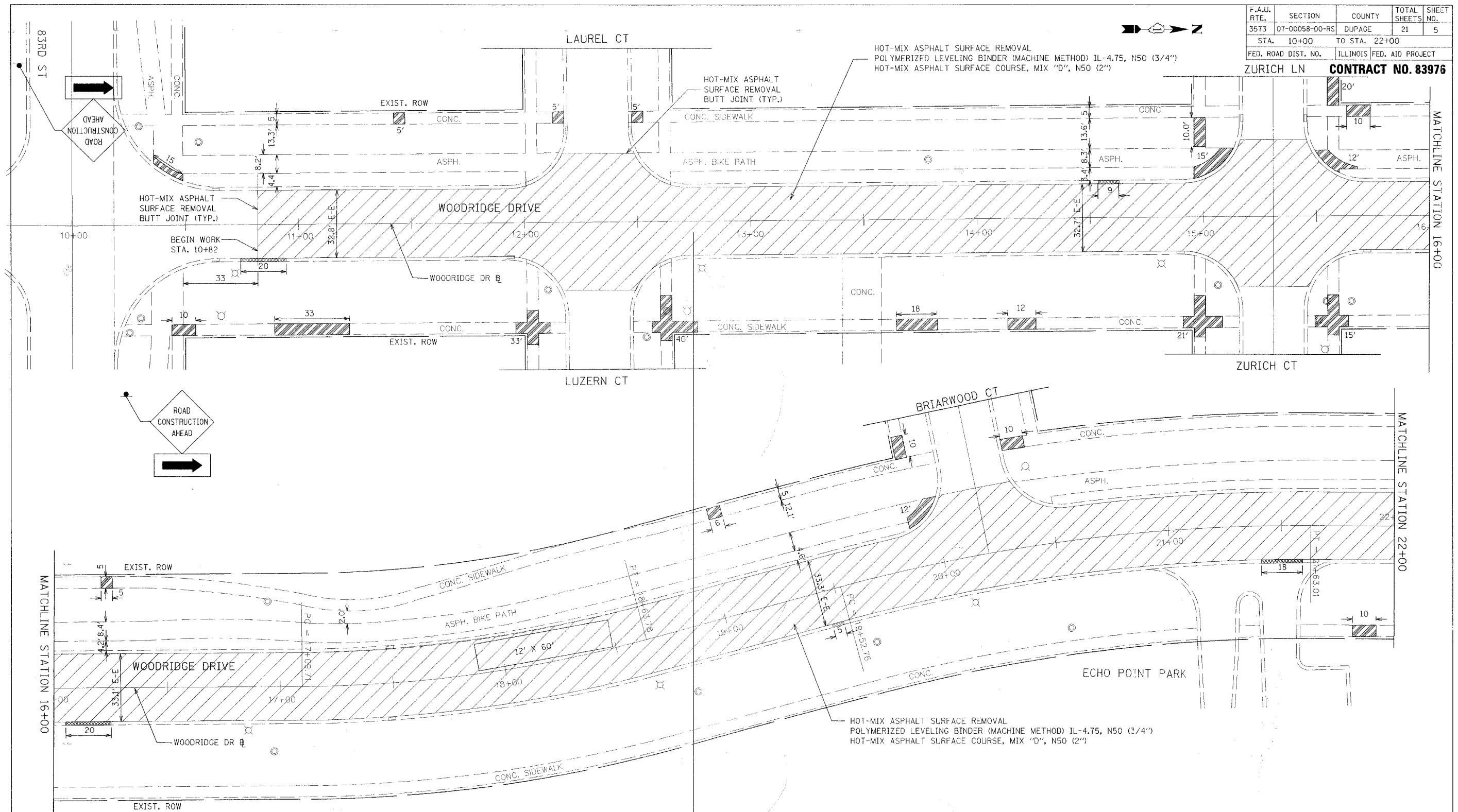

NOTES:
 ALL TRAFFIC CONTROL SIGNAGE AS REQUIRED ON THE PLANS AND ON THE STANDARD DETAIL DRAWINGS WILL BE PAID FOR AS PART OF THE TRAFFIC CONTROL AND PROTECTION STANDARDS. ALL TRAFFIC CONTROL SIGNS SHOWN ON THE PLANS SHALL BE PLACED AND ACCEPTED PRIOR TO THE COMMENCEMENT OF ANY CONSTRUCTION ACTIVITIES. ALL TRAFFIC CONTROL SIGNS SHALL BE MAINTAINED UNTIL ALL CONSTRUCTION ACTIVITY IS COMPLETE.

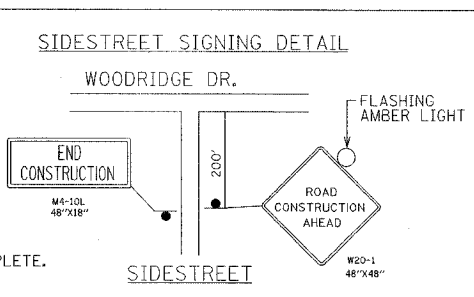

- NOTES:
1. THE ACTUAL LOCATION AND QUALITY OF CURB AND GUTTER REMOVAL AND REPLACEMENT, SIDEWALK REMOVAL AND REPLACEMENT, DRIVEWAY REMOVAL AND REPLACEMENT, AND PAVEMENT PATCHING WILL BE DETERMINED IN THE FIELD, DURING CONSTRUCTION, BY THE RESIDENT ENGINEER.
 2. RESTORATION OF THE WORK AREA SHALL BE INCIDENTAL TO THE CONTRACT WITHOUT ANY EXTRA COMPENSATION ALLOWED TO THE CONTRACTOR.
 3. FRAMES AND GRATES TO BE ADJUSTED SHALL BE ADJUSTED AS NEEDED IN THE FIELD AS DETERMINED BY THE RESIDENT ENGINEER.
 4. ALL CRACK FILL MATERIAL TO BE REMOVED ENTIRELY ALONG CURB LINE.

LEGEND

	HOT-MIX ASPHALT SURFACE REMOVAL AND REPLACEMENT
	SIDEWALK REMOVAL AND REPLACEMENT
	DRIVEWAY REMOVAL 4' FROM BACK OF CURB (TYP.)
	COMBINATION CONCRETE CURB AND GUTTER REMOVAL AND REPLACEMENT

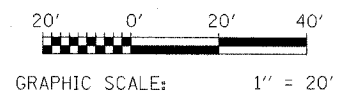

REVISIONS	
NAME	DATE

ILLINOIS DEPARTMENT OF TRANSPORTATION
 WOODRIDGE DRIVE
 RESURFACING PLAN
 STA 10+00 - 22+00
 DRAWN BY: LLM
 DATE: OCTOBER 12, 2007
 CHECKED BY: JRP

F.A.U. RTE.	SECTION	COUNTY	TOTAL SHEETS	SHEET NO.
3573	07-00058-00-RS	DUPAGE	21	6
STA. 22+00		TO STA. 34+00		
FED. ROAD DIST. NO.	ILLINOIS	FED. AID PROJECT		

CONTRACT NO. 83976

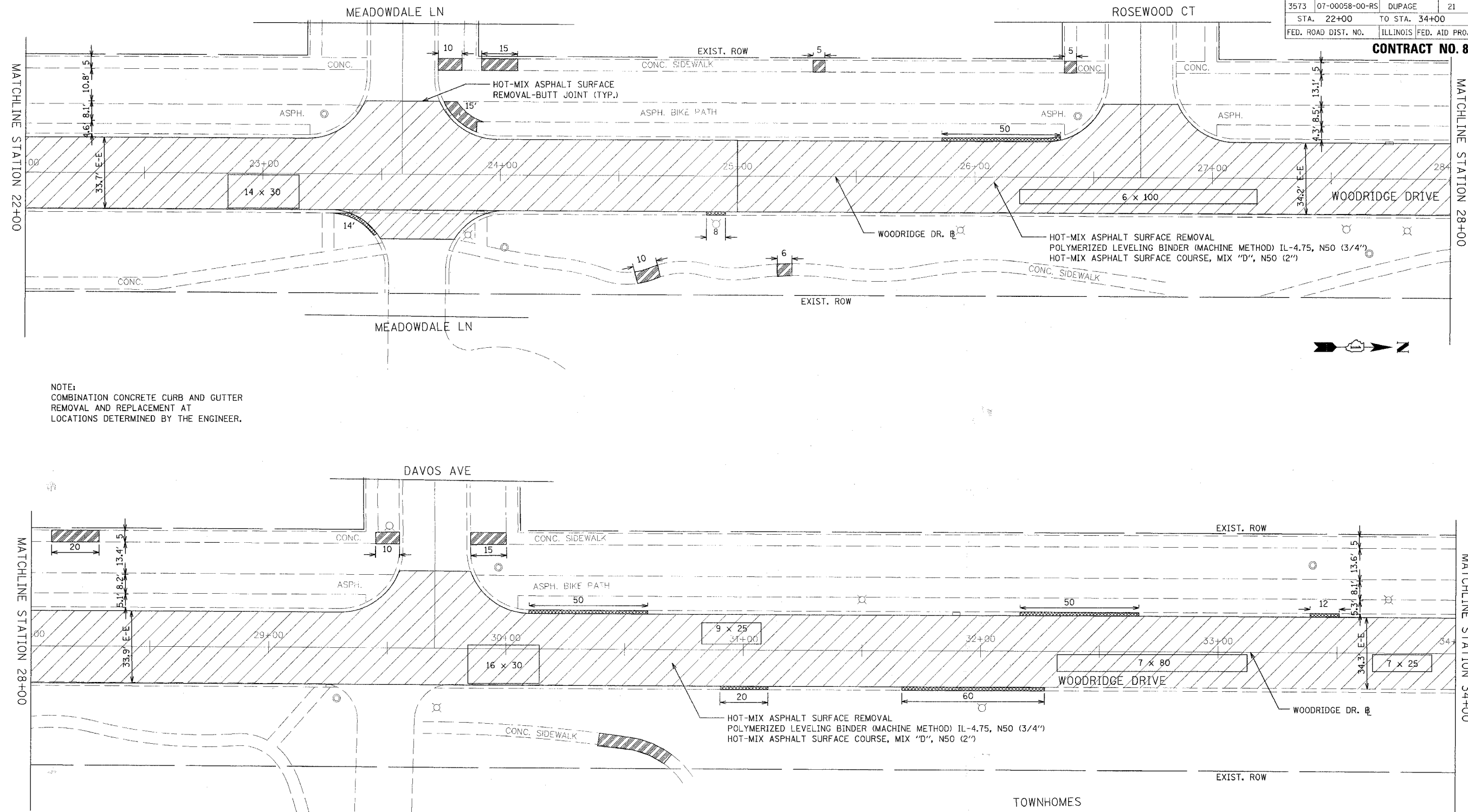

NOTE:
COMBINATION CONCRETE CURB AND GUTTER
REMOVAL AND REPLACEMENT AT
LOCATIONS DETERMINED BY THE ENGINEER.

- LEGEND**
- HOT-MIX ASPHALT SURFACE REMOVAL AND REPLACEMENT
 - SIDEWALK REMOVAL AND REPLACEMENT
 - DRIVEWAY REMOVAL 4' FROM BACK OF CURB (TYP.)
 - COMBINATION CONCRETE CURB AND GUTTER REMOVAL AND REPLACEMENT

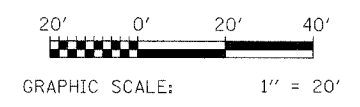

REVISIONS	
NAME	DATE

ILLINOIS DEPARTMENT OF TRANSPORTATION
WOODRIDGE DRIVE
RESURFACING PLAN
STA 22+00 - 34+00
DRAWN BY: LLM
DATE: OCTOBER 12, 2007
CHECKED BY: JRP

F.A.U. RTE.	SECTION	COUNTY	TOTAL SHEETS	SHEET NO.
3573	07-00058-00-RS	DUPAGE	21	8
STA. 46+00		TO STA. 57+00		
FED. ROAD DIST. NO.		ILLINOIS FED. AID PROJECT		

CONTRACT NO. 83976

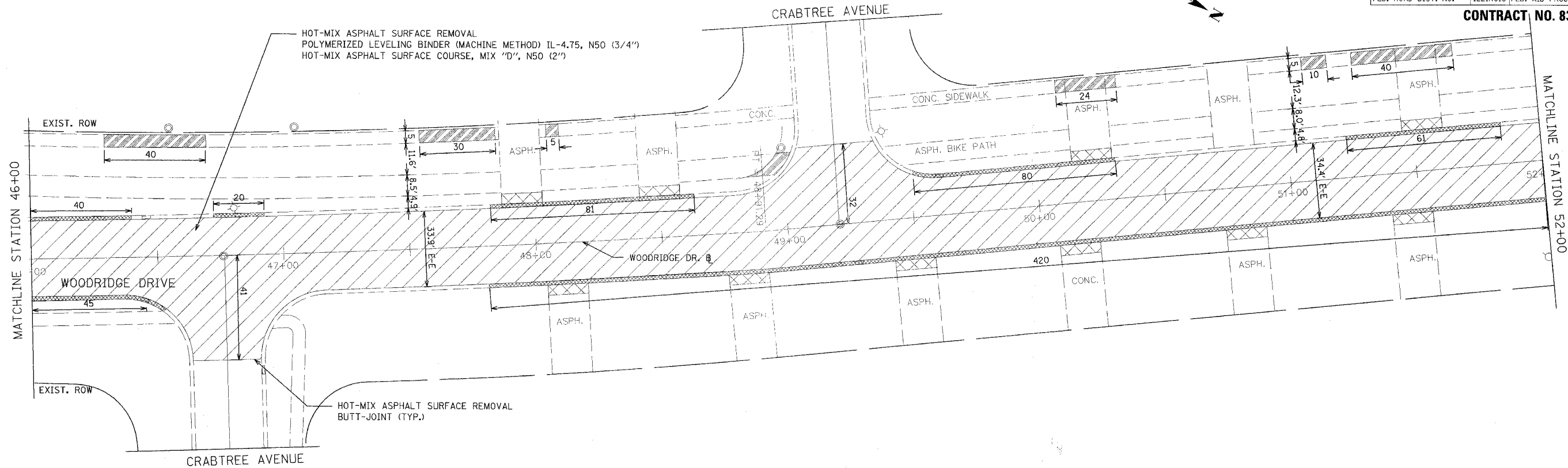

NOTE:
COMBINATION CONCRETE CURB AND GUTTER
REMOVAL AND REPLACEMENT AT LOCATIONS
DETERMINED BY THE ENGINEER.

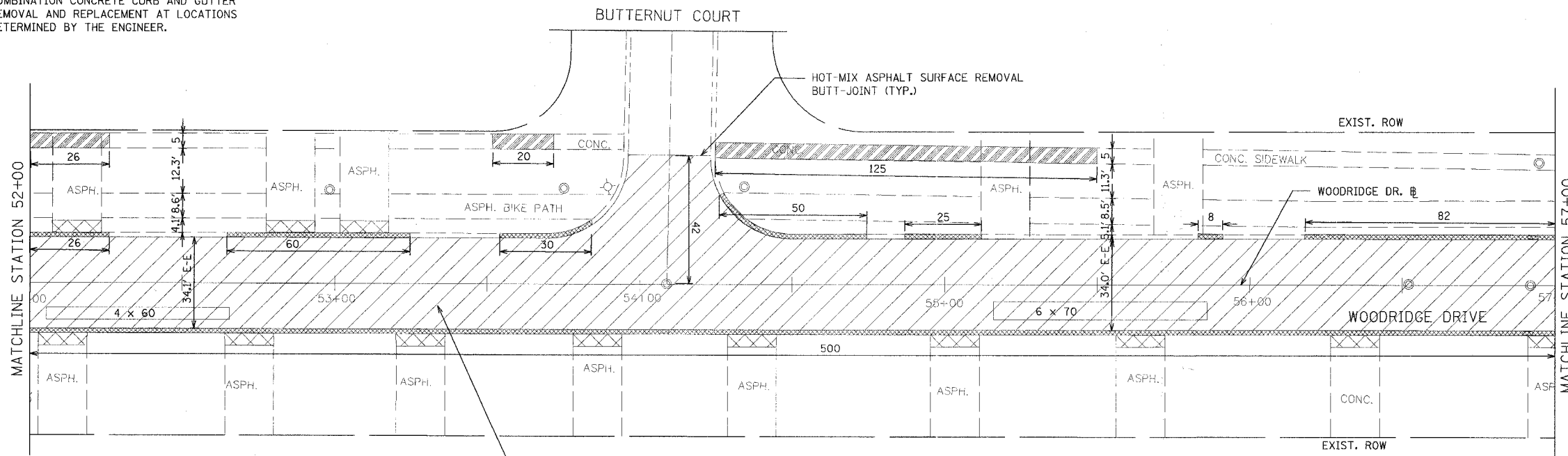

- LEGEND**
- HOT-MIX ASPHALT SURFACE REMOVAL AND REPLACEMENT
 - SIDEWALK REMOVAL AND REPLACEMENT
 - DRIVEWAY REMOVAL 4' FROM BACK OF CURB (TYP.)
 - COMBINATION CONCRETE CURB AND GUTTER REMOVAL AND REPLACEMENT

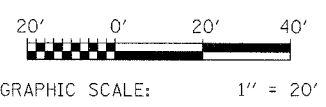

HOT-MIX ASPHALT SURFACE REMOVAL
POLYMERIZED LEVELING BINDER (MACHINE METHOD) IL-4.75, N50 (3/4")
HOT-MIX ASPHALT SURFACE COURSE, MIX "D", N50 (2")

REVISIONS	
NAME	DATE

ILLINOIS DEPARTMENT OF TRANSPORTATION
WOODRIDGE DRIVE
RESURFACING PLAN
STA 46+00 - 57+00
DRAWN BY: LLM
DATE: OCTOBER 12, 2007
CHECKED BY: JRP

F.A.U. RTE.	SECTION	COUNTY	TOTAL SHEETS	SHEET NO.
3573	07-00058-00-RS	DUPAGE	21	9
STA. 57+00	TO STA. 64+50			
FED. ROAD DIST. NO.	ILLINOIS FED. AID PROJECT			

CONTRACT NO. 83976

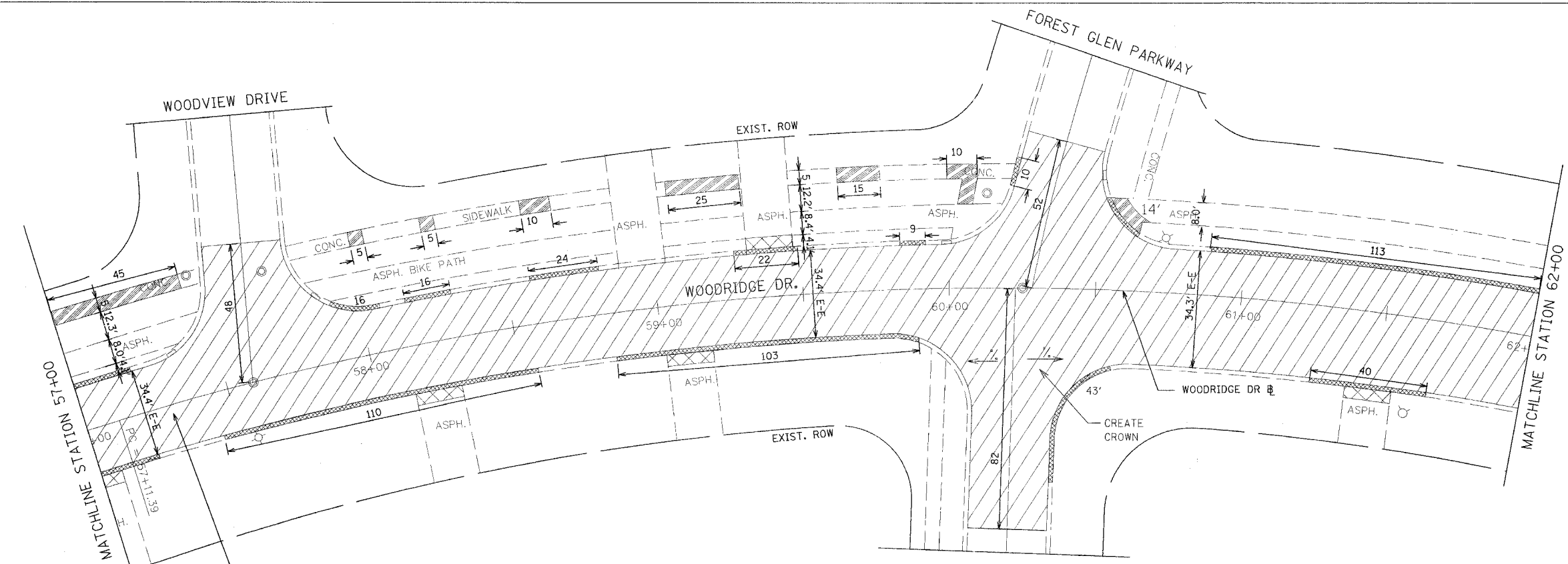

HOT-MIX ASPHALT SURFACE REMOVAL
 POLYMERIZED LEVELING BINDER (MACHINE METHOD) IL-4.75, N50 (3/4")
 HOT-MIX ASPHALT SURFACE COURSE, MIX "D", N50 (2")

DUPAGE COUNTY SPECIFICATIONS/REQUIREMENTS FOR DETECTOR LOOP, REPLACEMENT WORK AT WOODRIDGE DR. AND 75TH STREET.

1. EQUIPMENT AND MATERIALS MAY NOT BE STORED WITHIN THE COUNTY'S RIGHT OF WAY.
2. CONTACT DUPAGE COUNTY (630-407-6700) A MINIMUM OF 48 HOURS PRIOR TO THE START OF WORK WITHIN THE COUNTY'S RIGHT OF WAY.
3. ALL SIGNAL EQUIPMENT CONSTRUCTION/RESTORATION (INCLUDING DETECTION LOOPS REPLACEMENT LAYOUT) SHALL BE COORDINATED WITH THE COUNTY'S SIGNAL COORDINATOR, MR. THOMAS HARDY, CONTACT THE DIVISION OF TRANSPORTATION AT 630-407-6900 A MINIMUM OF 48 HOURS PRIOR TO THE START OF CONSTRUCTION TO COORDINATE INSPECTIONS

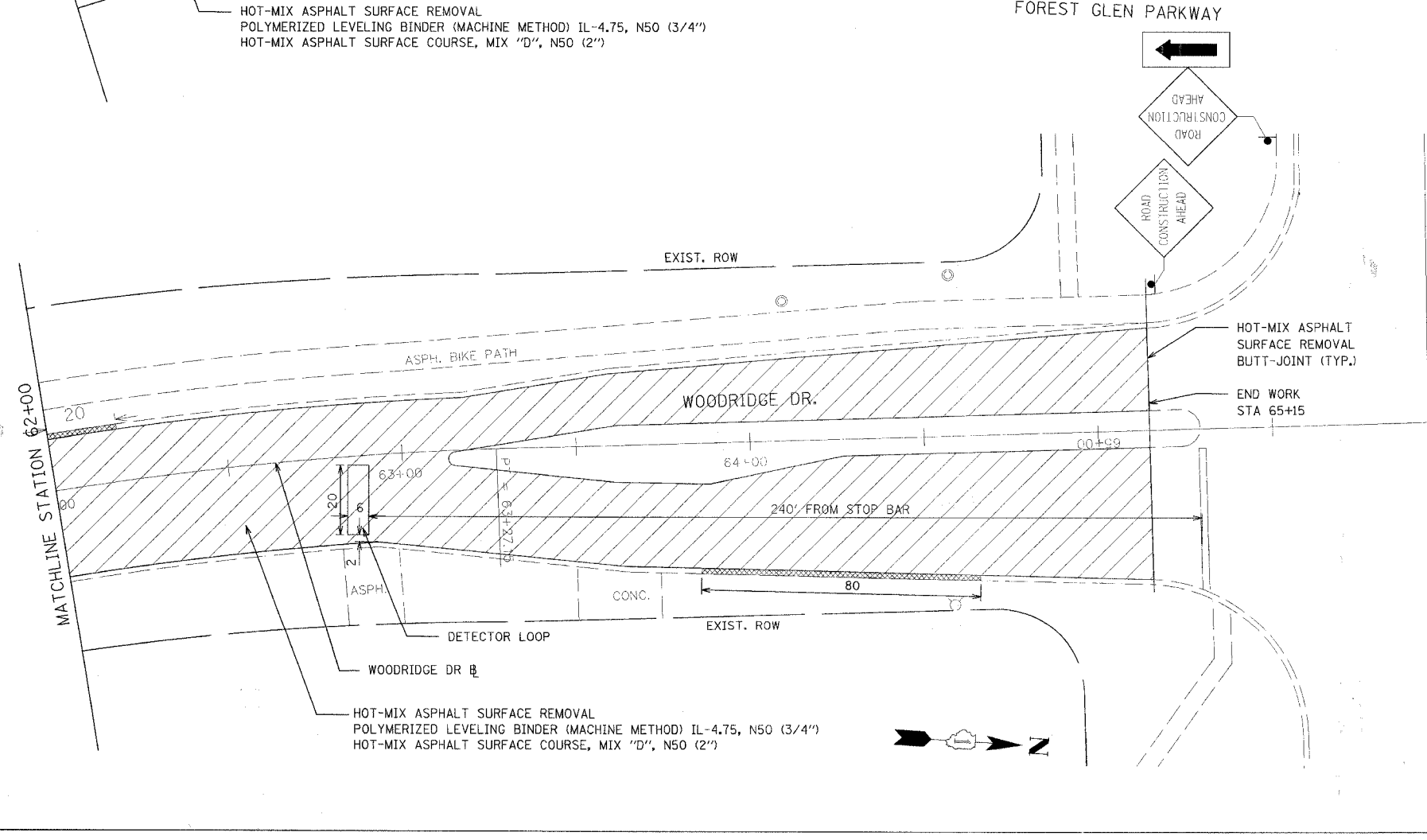

HOT-MIX ASPHALT SURFACE REMOVAL
 POLYMERIZED LEVELING BINDER (MACHINE METHOD) IL-4.75, N50 (3/4")
 HOT-MIX ASPHALT SURFACE COURSE, MIX "D", N50 (2")

- LEGEND**
- HOT-MIX ASPHALT SURFACE REMOVAL AND REPLACEMENT
 - SIDEWALK REMOVAL AND REPLACEMENT
 - DRIVEWAY REMOVAL 4' FROM BACK OF CURB (TYP.)
 - COMBINATION CONCRETE CURB AND GUTTER REMOVAL AND REPLACEMENT

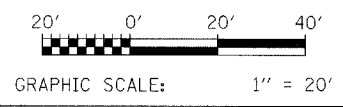

REVISIONS	
NAME	DATE

ILLINOIS DEPARTMENT OF TRANSPORTATION
WOODRIDGE DRIVE
 RESURFACE PLAN
 STA 57+00 - 64+50
 DRAWN BY: LLM
 DATE: OCTOBER 12, 2007
 CHECKED BY: JRP

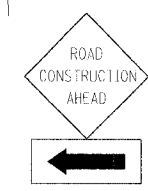

F.A.U. RTE.	SECTION	COUNTY	TOTAL SHEETS	SHEET NO.
3573	07-00058-00-RS	DUPAGE	21	10
STA. 10+00	TO STA. 22+00			
FED. ROAD DIST. NO.	ILLINOIS	FED. AID PROJECT		

CONTRACT NO. 83976

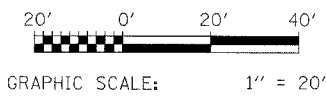
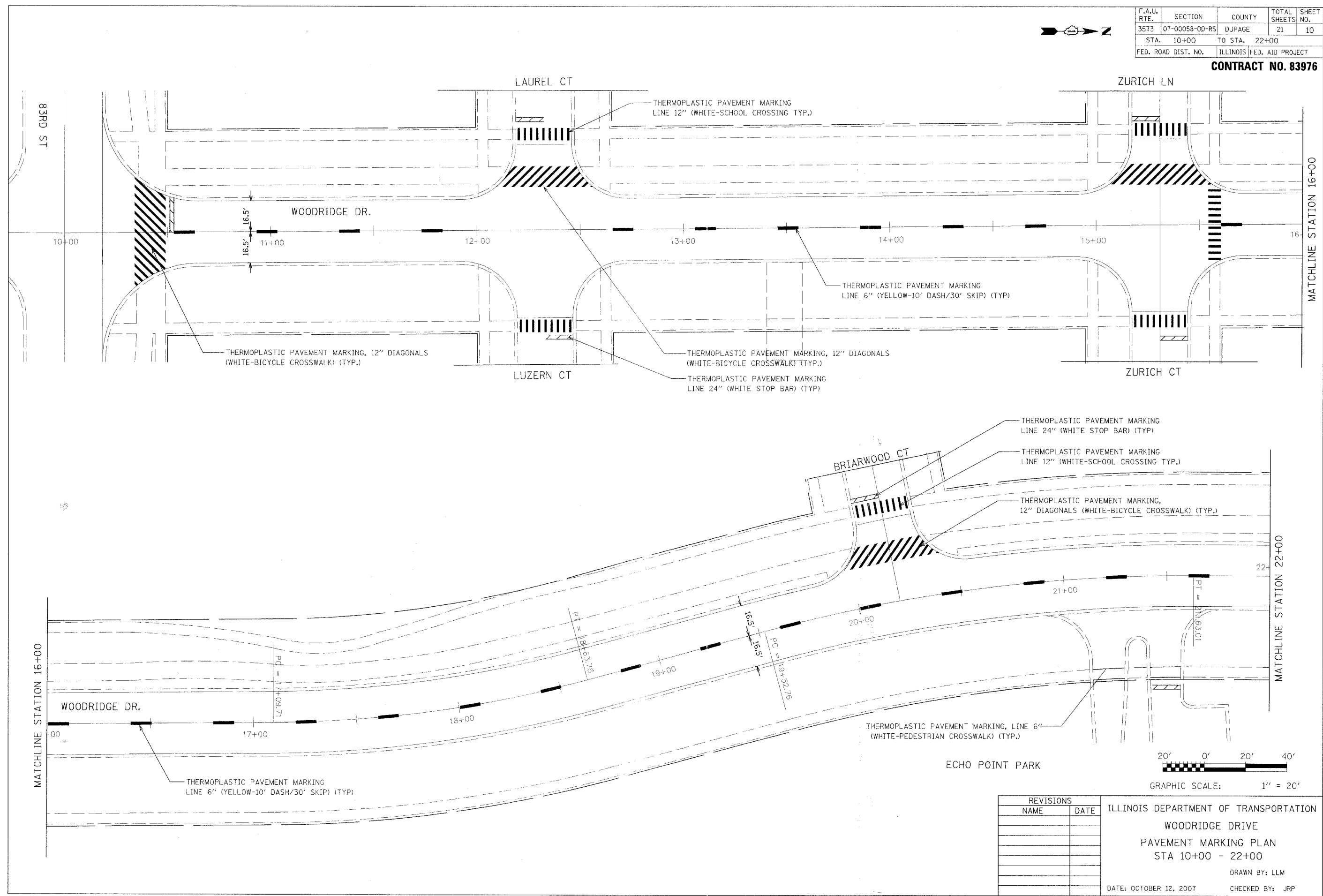

REVISIONS	
NAME	DATE

ILLINOIS DEPARTMENT OF TRANSPORTATION
 WOODRIDGE DRIVE
 PAVEMENT MARKING PLAN
 STA 10+00 - 22+00
 DRAWN BY: LLM
 DATE: OCTOBER 12, 2007
 CHECKED BY: JRP

F.A.U. RTE.	SECTION	COUNTY	TOTAL SHEETS	SHEET NO.
3573	07-00058-00-RS	DUPAGE	21	11
STA. 22+00	TO STA. 34+00			
FED. ROAD DIST. NO.	ILLINOIS	FED. AID PROJECT		

CONTRACT NO. 83976

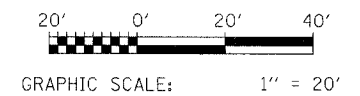
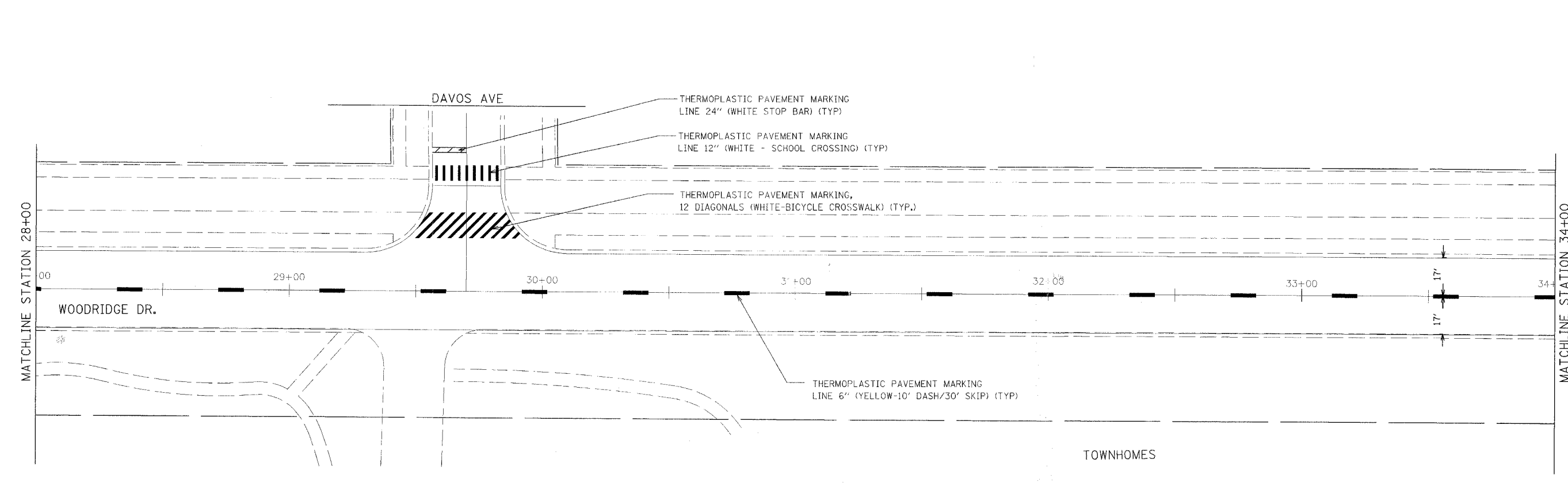
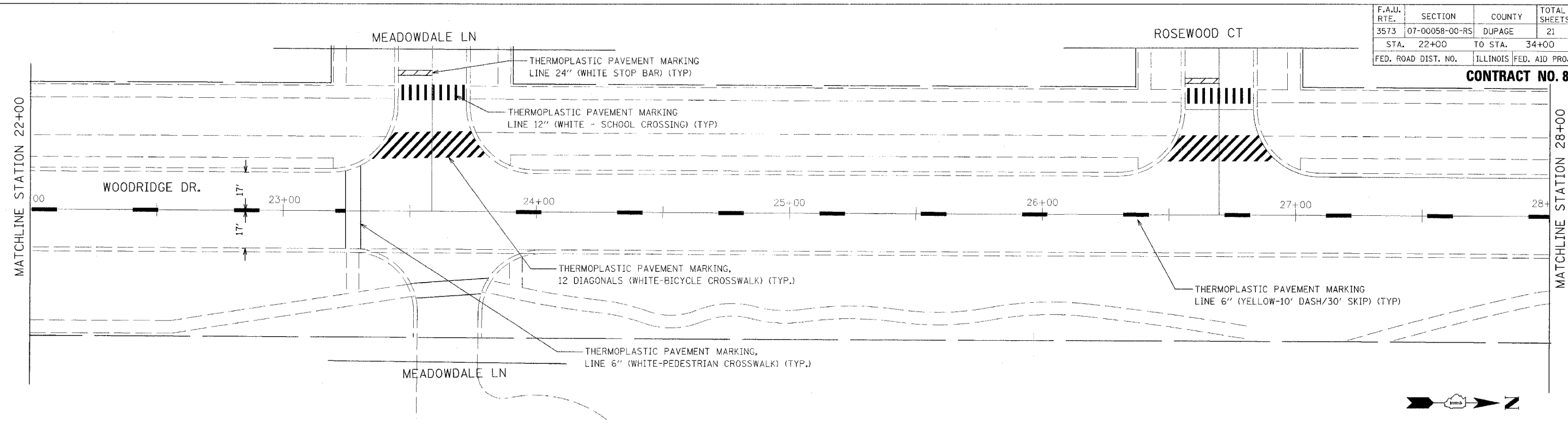

REVISIONS	
NAME	DATE

ILLINOIS DEPARTMENT OF TRANSPORTATION
WOODRIDGE DRIVE
PAVEMENT MARKING PLAN
STA 22+00 - 34+00
DRAWN BY: LLM
DATE: OCTOBER 12, 2007
CHECKED BY: JRP

F.A.U. RTE.	SECTION	COUNTY	TOTAL SHEETS	SHEET NO.
3573	07-00058-00-RS	DUPAGE	21	12
STA. 34+00		TO STA. 46+00		
FED. ROAD DIST. NO.		ILLINOIS FED. AID PROJECT		

CONTRACT NO. 83976

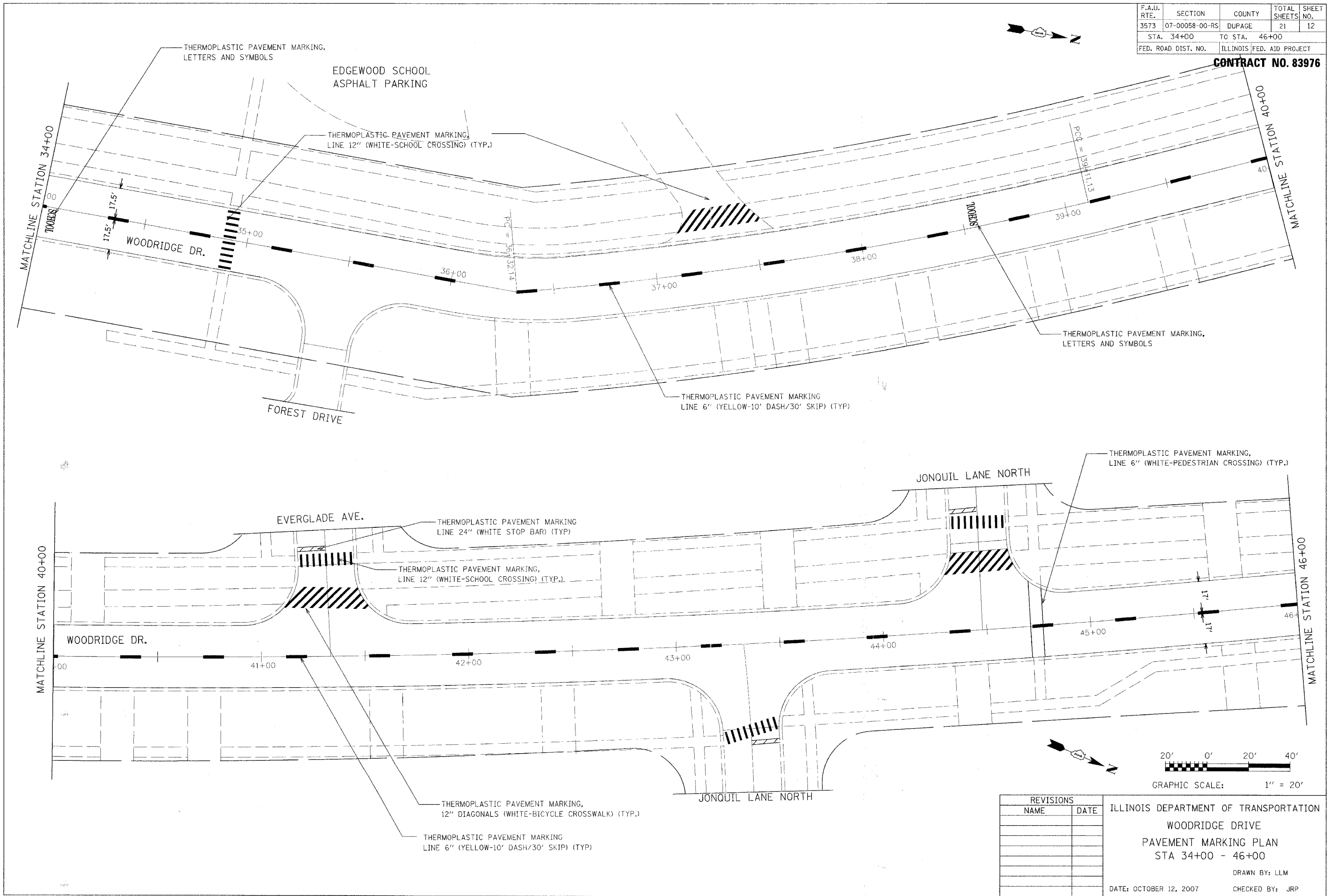

REVISIONS	
NAME	DATE

ILLINOIS DEPARTMENT OF TRANSPORTATION
 WOODRIDGE DRIVE
 PAVEMENT MARKING PLAN
 STA 34+00 - 46+00
 DRAWN BY: LLM
 DATE: OCTOBER 12, 2007
 CHECKED BY: JRP

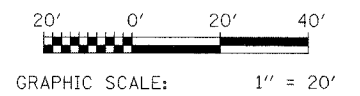

F.A.U. RTE.	SECTION	COUNTY	TOTAL SHEETS	SHEET NO.
3573	07-00058-00-RS	DUPAGE	21	13
STA. 46+00		TO STA. 57+00		
FED. ROAD DIST. NO.		ILLINOIS	FED. AID PROJECT	

CONTRACT NO. 83976

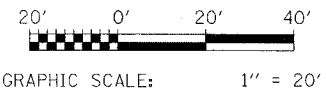
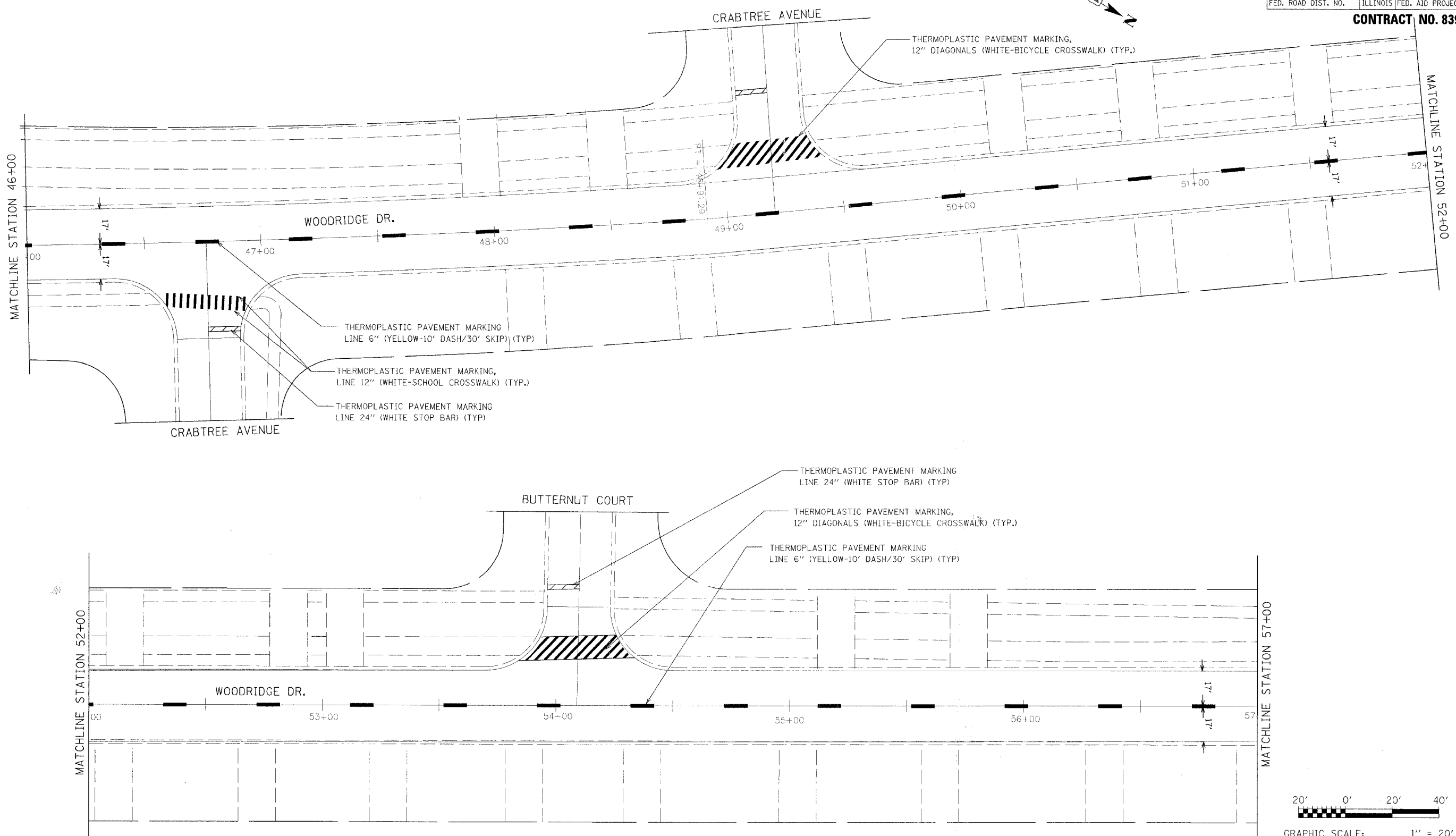

REVISIONS	
NAME	DATE

ILLINOIS DEPARTMENT OF TRANSPORTATION
 WOODRIDGE DRIVE
 PAVEMENT MARKING PLAN
 STA 46+00 - 57+00
 DRAWN BY: LLM
 DATE: OCTOBER 12, 2007
 CHECKED BY: JRP

F.A.U. RTE.	SECTION	COUNTY	TOTAL SHEETS	SHEET NO.
3573	07-00058-00-RS	DUPAGE	21	14
STA. 57+00		TO STA. 64+50		
FED. ROAD DIST. NO.		ILLINOIS FED. AID PROJECT		

CONTRACT NO. 83976

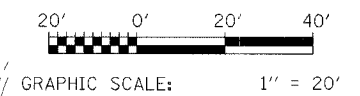
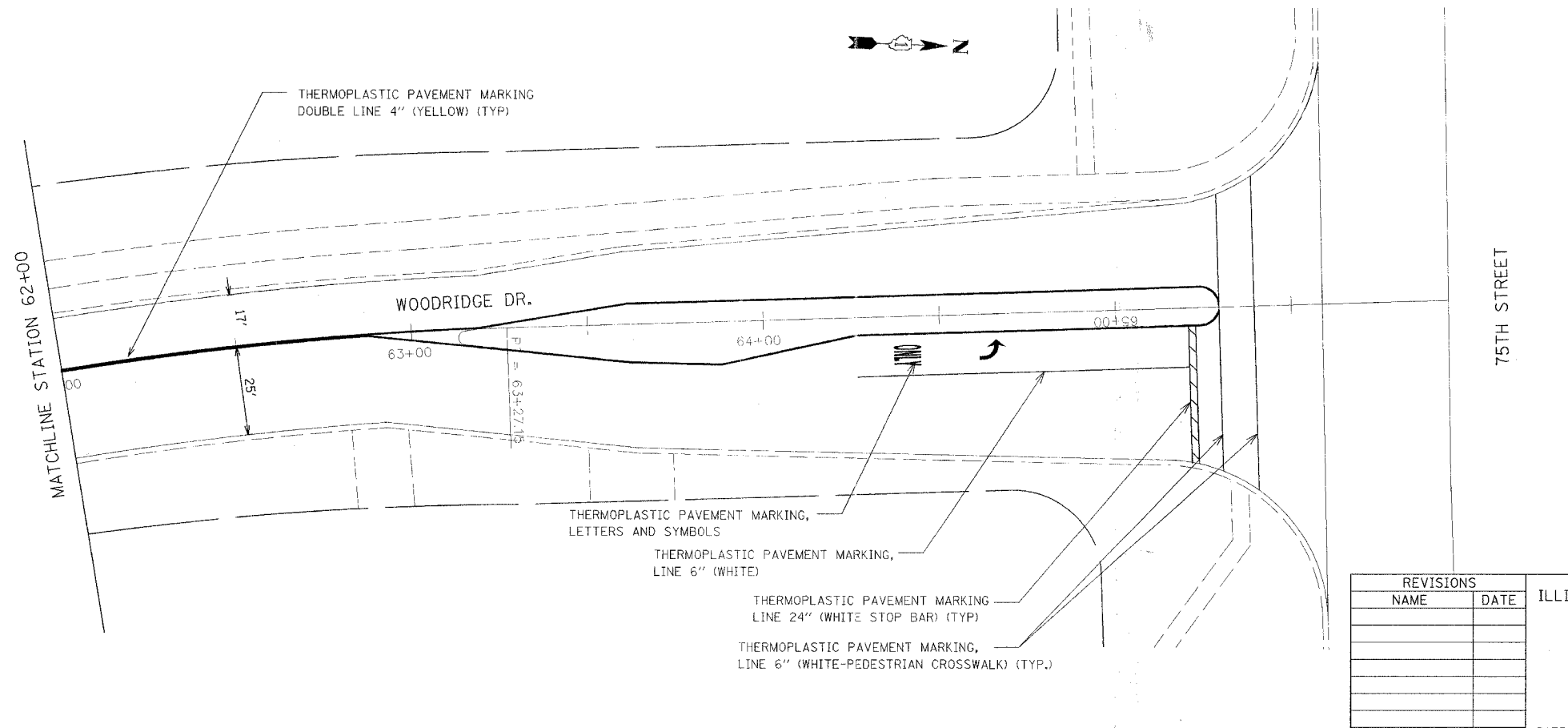
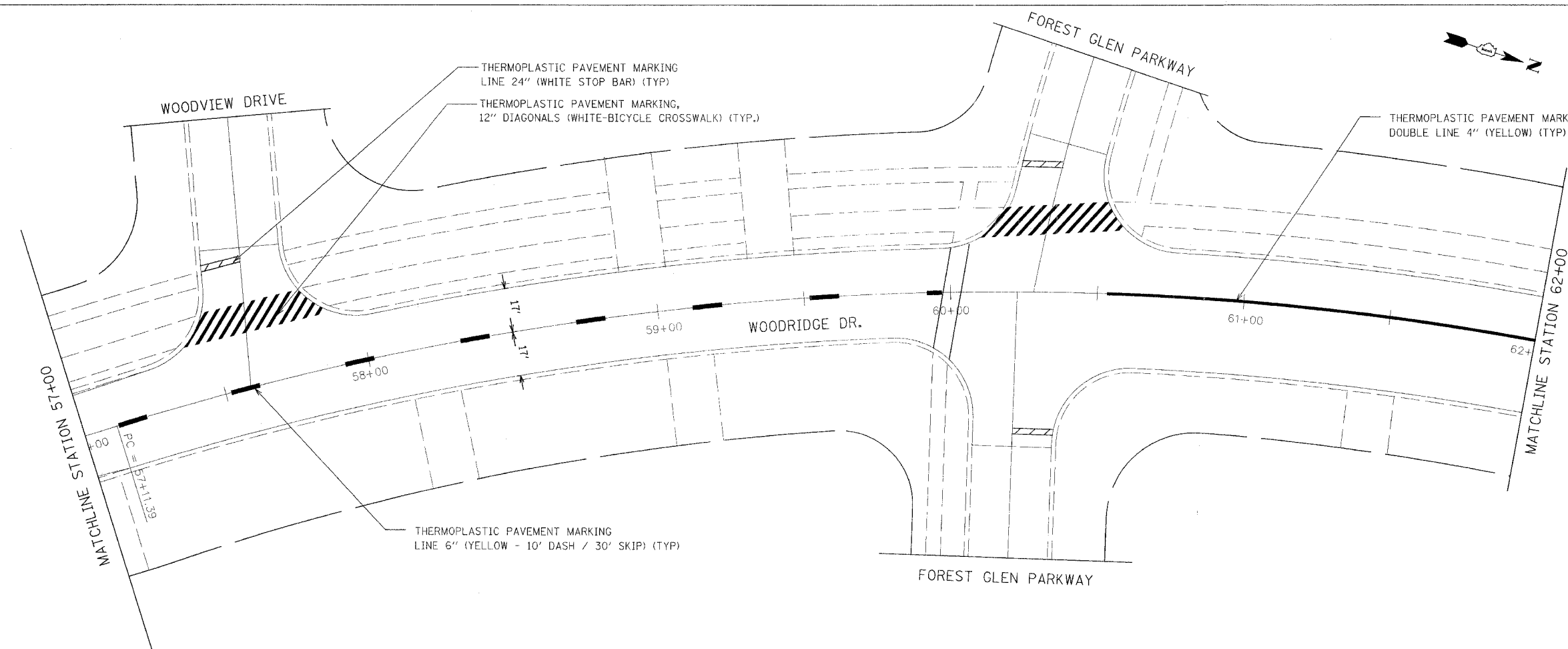

REVISIONS	
NAME	DATE

ILLINOIS DEPARTMENT OF TRANSPORTATION
 WOODRIDGE DRIVE
 PAVEMENT MARKING PLAN
 STA 57+00 - 64+50
 DRAWN BY: LLM
 DATE: OCTOBER 12, 2007
 CHECKED BY: JRP

THERMOPLASTIC PAVEMENT MARKING
 LINE 24" (WHITE STOP BAR) (TYP.)
 THERMOPLASTIC PAVEMENT MARKING,
 12" DIAGONALS (WHITE-BICYCLE CROSSWALK) (TYP.)

THERMOPLASTIC PAVEMENT MARKING
 DOUBLE LINE 4" (YELLOW) (TYP.)

THERMOPLASTIC PAVEMENT MARKING
 LINE 6" (YELLOW - 10' DASH / 30' SKIP) (TYP.)

THERMOPLASTIC PAVEMENT MARKING
 DOUBLE LINE 4" (YELLOW) (TYP.)

THERMOPLASTIC PAVEMENT MARKING,
 LETTERS AND SYMBOLS

THERMOPLASTIC PAVEMENT MARKING,
 LINE 6" (WHITE)

THERMOPLASTIC PAVEMENT MARKING
 LINE 24" (WHITE STOP BAR) (TYP.)

THERMOPLASTIC PAVEMENT MARKING,
 LINE 6" (WHITE-PEDESTRIAN CROSSWALK) (TYP.)

F.A. RTE.	SECTION	COUNTY	TOTAL SHEETS	SHEET NO.
			21	15
STA.		TO STA.		
FED. ROAD DIST. NO. 1		ILLINOIS FED. AID PROJECT		

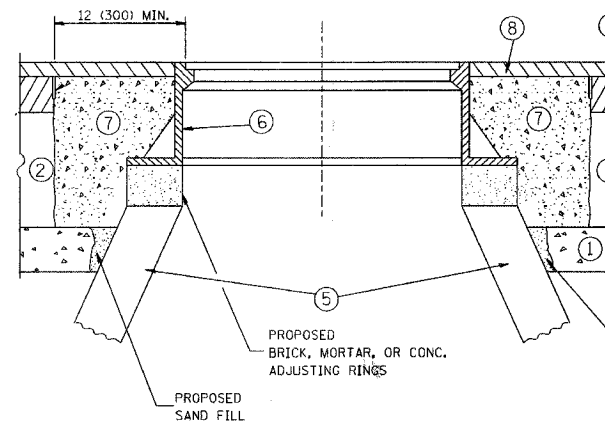
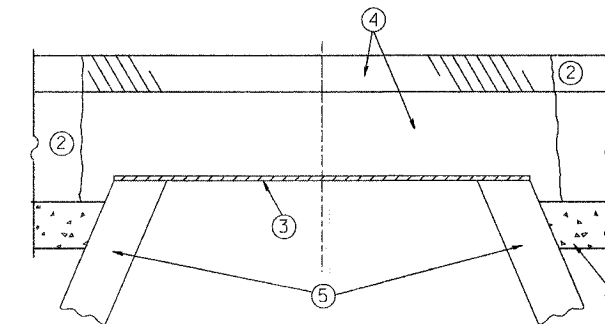

- CONSTRUCTION PROCEDURES**
- STAGE 1 (BEFORE PAVEMENT MILLING)**
- A) REMOVE A MINIMUM OF 12 (300) OF THE PAVEMENT FROM AROUND THE STRUCTURE.
 - B) REMOVE THE EXISTING FRAME AND LID FROM THE STRUCTURE.
 - C) COVER THE STRUCTURE OPENING WITH A 36 (900) DIAMETER METAL PLATE.
 - D) BACKFILL WITH CRUSHED STONE AND A MINIMUM 1/2 (40) THICK HMA SURFACE MIX APPROVED BY THE ENGINEER.
- STAGE 2 (AFTER PAVEMENT MILLING)**
- A) REMOVE THE HMA SURFACE MIX AND CRUSHED STONE.
 - B) INSTALL THE FRAME AND LID; ADJUST THE FRAME TO ITS FINAL SURFACE ELEVATION.
 - C) THE SURROUNDING SPACE SHALL BE FILLED WITH CLASS SI CONCRETE, OR HMA SURFACE COURSE OR HMA BINDER COURSE TO THE ELEVATION OF THE SURFACE OF THE EXISTING BASE COURSE OR THE BINDER COURSE.

THE PROCEDURE EXPLAINED ABOVE SHALL CONFORM TO THE APPLICABLE PORTIONS OF SECTIONS 353, 406, 602, AND 603 OF THE STANDARD SPECIFICATIONS.

NOTES:

EXISTING BROKEN FRAMES AND LIDS SHALL BE REMOVED AND DISPOSED OF BY THE CONTRACTOR AND SHALL BE REPLACED AS DIRECTED BY THE ENGINEER. REPLACEMENT FRAMES AND LIDS WILL BE PAID FOR IN ACCORDANCE WITH ARTICLE 109.04 OF THE STANDARD SPECIFICATIONS UNLESS A SEPARATE PAY ITEM HAS BEEN PROVIDED.

IF THE EXISTING LIDS ARE OPEN, THE FRAME WILL BE ADJUSTED TO THE ELEVATION OF THE MILLED PAVEMENT SURFACE PRIOR TO THE MILLING OPERATION. THE FRAME WILL NOT BE REMOVED AND COVERED BY THE METAL PLATE.

CITY OF CHICAGO CASTINGS ARE THE PROPERTY OF THE CITY AND THE CONTRACTOR SHALL NOTIFY THE CITY FOR REMOVAL AND DISPOSITION OF THE CASTINGS.

THE METAL PLATE USED TO COVER THE STRUCTURE SHALL REMAIN THE PROPERTY OF THE CONTRACTOR.

WHEN STRUCTURES ARE TO BE ADJUSTED OR RECONSTRUCTED, THE LOWERING AND RAISING OF THE FRAMES AND LIDS WILL NOT BE PAID FOR SEPARATELY BUT WILL BE INCLUDED IN THE COST OF THE CORRESPONDING PAY ITEM.

LEGEND

① SUB-BASE GRANULAR MATERIAL	⑥ FRAME AND LID (SEE NOTES)
② EXISTING PAVEMENT	⑦ CLASS SI CONCRETE, HMA SURFACE COURSE OR HMA BINDER COURSE
③ 36 (900) DIAMETER METAL PLATE	⑧ PROPOSED HMA SURFACE COURSE
④ PROPOSED CRUSHED STONE AND HMA SURFACE MIX	⑨ PROPOSED HMA BINDER COURSE
⑤ EXISTING STRUCTURE	

LOCATION OF STRUCTURES:

THE CONTRACTOR WILL BE REQUIRED TO KEEP A RECORD OF THE LOCATIONS OF THE BURIED STRUCTURES ACCORDING TO THE STATION AND DISTANCE LEFT OR RIGHT OF THE CENTERLINE OF PAVEMENT. UPON COMPLETION OF THE WORK, THE CONTRACTOR WILL DELIVER THE RECORD TO THE ENGINEER.

BASIS OF PAYMENT: THIS WORK WILL BE PAID FOR AT THE CONTRACT UNIT PRICE PER EACH FOR "FRAMES AND LIDS TO BE ADJUSTED, SPECIAL"

NEW FRAMES AND LIDS, WHEN SPECIFIED, WILL BE PAID FOR SEPARATELY.

DETAILS FOR FRAMES AND LIDS ADJUSTMENT WITH MILLING

ALL DIMENSIONS ARE IN INCHES (MILLIMETERS) UNLESS OTHERWISE SHOWN

REVISIONS

NAME	DATE
R. SHAH	10/25/94
R. SHAH	01/30/95
R. SHAH	03/10/95
A. ABBAS	03/21/97
R. WIEDEMAN	05/14/04
R. BORO	01/01/07

ILLINOIS DEPARTMENT OF TRANSPORTATION

DETAILS FOR FRAMES AND LIDS ADJUSTMENT WITH MILLING

SCALE: VERT. NONE
HORIZ.

DRAWN BY
CHECKED BY
BD600-03 (BD-8)

F.A. RTE.	SECTION	COUNTY	TOTAL SHEETS	SHEET NO.
			21	16
STA.		TO STA.		
FED. ROAD DIST. NO. 1		ILLINOIS	FED. AID PROJECT	

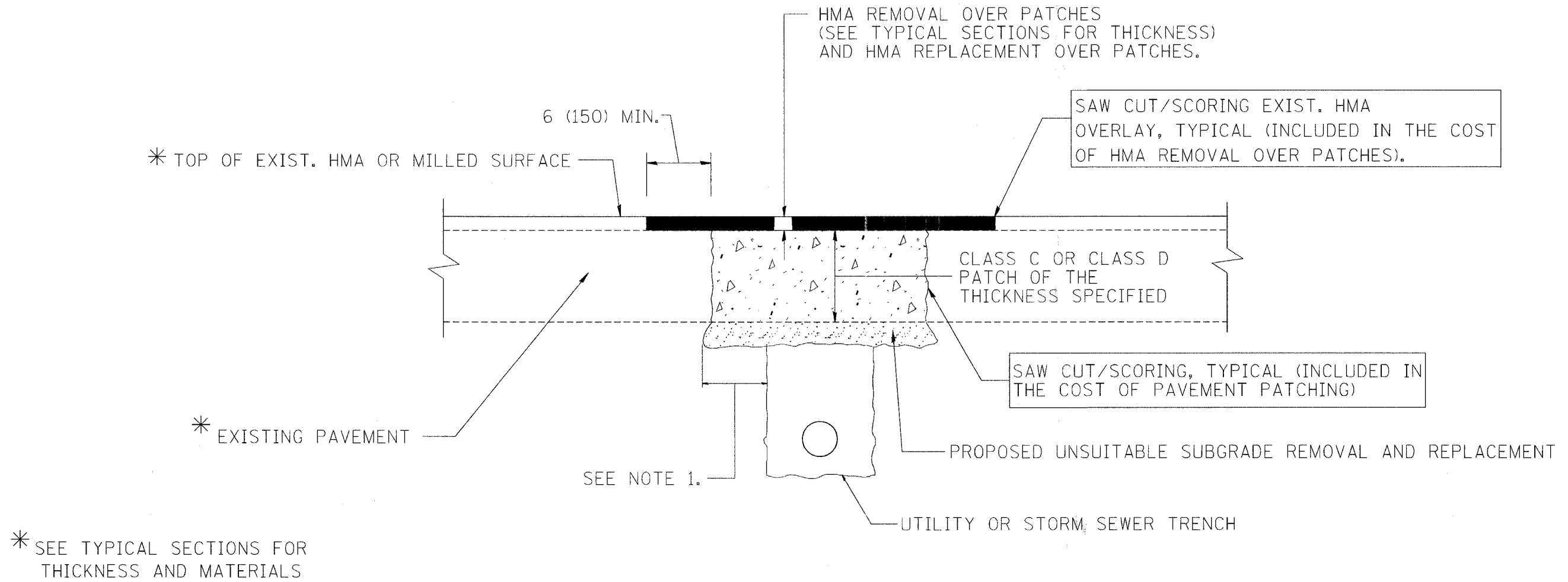

* SEE TYPICAL SECTIONS FOR THICKNESS AND MATERIALS

NOTES:

1. THE WIDTH OF THE FULL DEPTH PATCH OVER A TRENCH SHALL BE 12 (300) WIDER ON EACH SIDE OF THE TRENCH.
2. FOR METHOD OF MEASUREMENT AND BASIS OF PAYMENT, SEE RECURRING SPECIAL PROVISION "PATCHING WITH HOT-MIX ASPHALT OVERLAY REMOVAL".

SEQUENCE OF CONSTRUCTION

1. REMOVE THE EXISTING HMA MATERIAL OVER THE AREA TO BE PATCHED.
2. REMOVE AND REPLACE FULL DEPTH PATCHES
3. REPLACE HMA MATERIAL OVER THE AREA TO BE PATCHED.

ALL DIMENSIONS ARE IN INCHES (MILLIMETERS) UNLESS OTHERWISE SHOWN.

REVISIONS	
NAME	DATE
R. SHAH	10/25/94
R. SHAH	01/14/95
R. SHAH	03/23/95
R. SHAH	04/24/95
A. HOUSEH	03/15/96
A. ABBAS	03/21/97
A. ABBAS	01/20/98
ART ABBAS	04/27/98
R. BORO	01/01/07

ILLINOIS DEPARTMENT OF TRANSPORTATION

PAVEMENT PATCHING FOR HMA SURFACED PAVEMENT

SCALE: VERT. NONE
HORIZ.

DRAWN BY
CHECKED BY

BD400-04 (BD-22)

PLOT DATE = 3/5/2007
PLOT SCALE = 50/1000 IN.
USER NAME = bawnd

F.A. RTE.	SECTION	COUNTY	TOTAL SHEETS	SHEET NO.
			21	17
STA.		TO STA.		
FED. ROAD DIST. NO. 1 ILLINOIS FED. AID PROJECT				

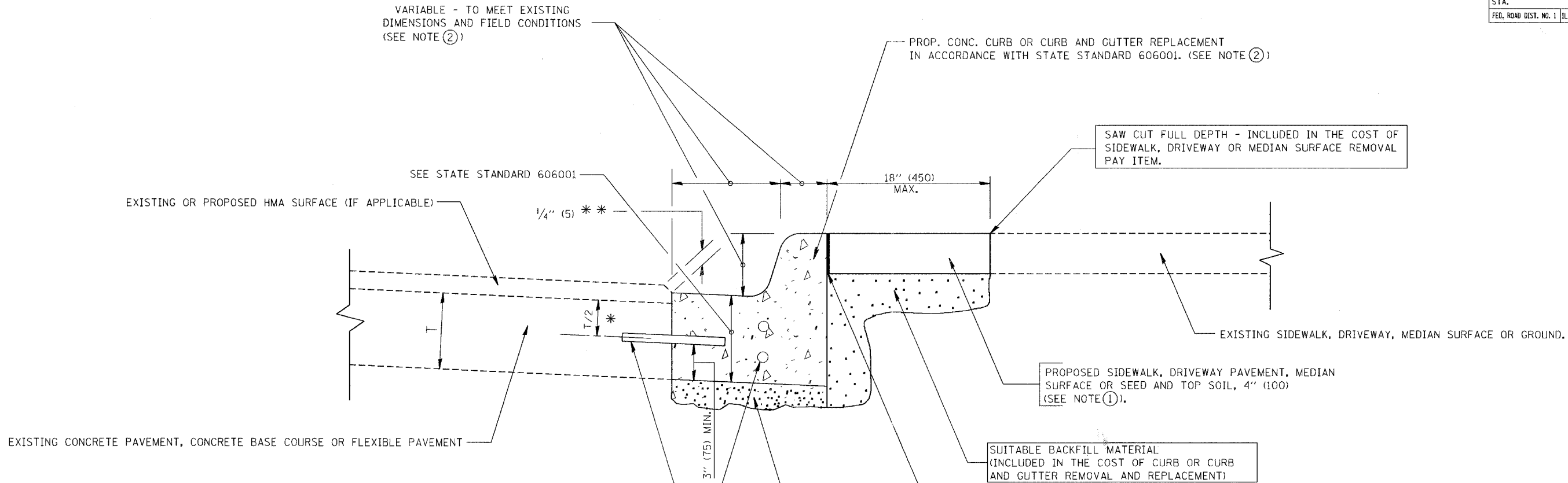

- * 3" (75) MINIMUM FROM TOP AND BOTTOM OF THE CONCRETE PAVEMENT OR BASE COURSE.
- ** IF THE FINAL SURFACE OF THE PAVEMENT IS CONCRETE, THE GUTTER IS TO BE FLUSH WITH THE PAVEMENT.

NOTE: ① SIDEWALK, DRIVEWAY PAVEMENT OR MEDIAN SURFACE SHALL BE SIMILAR TO THE MATERIAL BEING REMOVED AND WILL BE PAID FOR SEPARATELY.

SEED AND TOP SOIL, 4" (100) RESTORATION WILL NOT BE PAID FOR SEPARATELY, BUT SHALL BE INCLUDED IN THE COST OF CURB OR CURB AND GUTTER REMOVAL AND REPLACEMENT.

- ② CURB OR CURB AND GUTTER REPLACEMENT SHALL MATCH THE SHAPE OF THE EXISTING CURB OR CURB AND GUTTER UNLESS OTHERWISE SPECIFIED.
- ③ FOR CURB OR CURB AND GUTTER REMOVAL AND REPLACEMENT ADJACENT TO FLEXIBLE PAVEMENT DELETE EPOXY COATED TIE BARS.
- ④ LONGITUDINAL BARS, IF ENCOUNTERED IN THE EXISTING CURB OR CURB AND GUTTER, ARE NOT TO BE REPLACED. CUTTING AND REMOVING LONGITUDINAL BARS SHALL BE INCLUDED IN THE COST OF CURB OR CURB AND GUTTER REMOVAL AND REPLACEMENT.
- ⑤ THE COST OF HMA SURFACE REMOVAL IN THE EXISTING GUTTER FLAG SHALL BE INCLUDED IN THE COST OF THE CURB AND GUTTER REMOVAL AND REPLACEMENT.
- ⑥ THE REMOVAL AND REPLACEMENT OF THE EXISTING CURB OR CURB AND GUTTER SHALL BE DONE IN ACCORDANCE WITH THE APPLICABLE PORTIONS OF SECTION 440 AND 606 OF THE STANDARD SPECIFICATIONS.
- ⑦ THE LOCATIONS OF REMOVAL AND REPLACEMENT OF EXISTING CURB OR CURB AND GUTTER SHALL BE DETERMINED BY THE RESIDENT ENGINEER AT THE TIME OF CONSTRUCTION.

UNSUITABLE SUB-BASE MATERIAL TO BE REMOVED, IF DIRECTED BY THE ENGINEER, SHALL BE REPLACED WITH EITHER SUB-BASE GRANULAR MATERIAL, TYPE B OR ADDITIONAL THICKNESS OF CONCRETE.

REMOVAL AND REPLACEMENT 4" (100) OR LESS IS INCLUDED IN THE COST OF CURB OR CURB AND GUTTER REMOVAL AND REPLACEMENT.

REMOVAL AND REPLACEMENT IN EXCESS OF 4" (100) WILL BE PAID FOR IN ACCORDANCE WITH ARTICLE 109.04 OF THE STANDARD SPECIFICATIONS.

PROPOSED #6 (20) EPOXY COATED TIE BARS 24" (600) LONG AT 24" (600) CENTERS WILL NOT BE PAID FOR SEPARATELY. DELETE EPOXY COATED TIE BARS IF EXISTING TIE BARS ARE USUABLE AS DETERMINED BY THE ENGINEER. (SEE NOTE ③). TIE BARS TO BE INSTALLED AT LOCATIONS WHERE PROPOSED CURB AND GUTTER CONNECTS TO EXISTING CURB AND GUTTER

BASIS OF PAYMENT:
THIS WORK WILL BE PAID FOR AT THE CONTRACT UNIT PRICE PER FOOT (METER) FOR "CURB REMOVAL AND REPLACEMENT" OR "COMBINATION CONCRETE CURB AND GUTTER REMOVAL AND REPLACEMENT".

ALL DIMENSIONS ARE IN INCHES (MILLIMETERS) UNLESS OTHERWISE SHOWN.

CURB OR CURB AND GUTTER REMOVAL AND REPLACEMENT

REVISIONS	
NAME	DATE
A. HOUSEH	03/11/94
R. SHAH	02/24/95
R. SHAH	03/02/95
R. SHAH	08/19/96
R. SHAH	09/12/96
R. SHAH	09/19/96
R. SHAH	10/03/96
A. ABBAS	03/21/97
M. GOMEZ	01/22/01
R. BORO	01/01/07

ILLINOIS DEPARTMENT OF TRANSPORTATION
CURB OR CURB AND GUTTER REMOVAL AND REPLACEMENT

SCALE: VERT. NONE
HORIZ. NONE
DRAWN BY
CHECKED BY
BD600-06 (BD-24)

PLOT DATE = 3/6/2007
FILE NAME = K:\dashed\bd600.dgn
USER = RSHAH / JN.
USER NAME = RSHAH

F.A. RTE.	SECTION	COUNTY	TOTAL SHEETS	SHEET NO.
			21	18
STA.		TO STA.		
FED. ROAD DIST. NO.	ILLINOIS	FED. AID PROJECT		

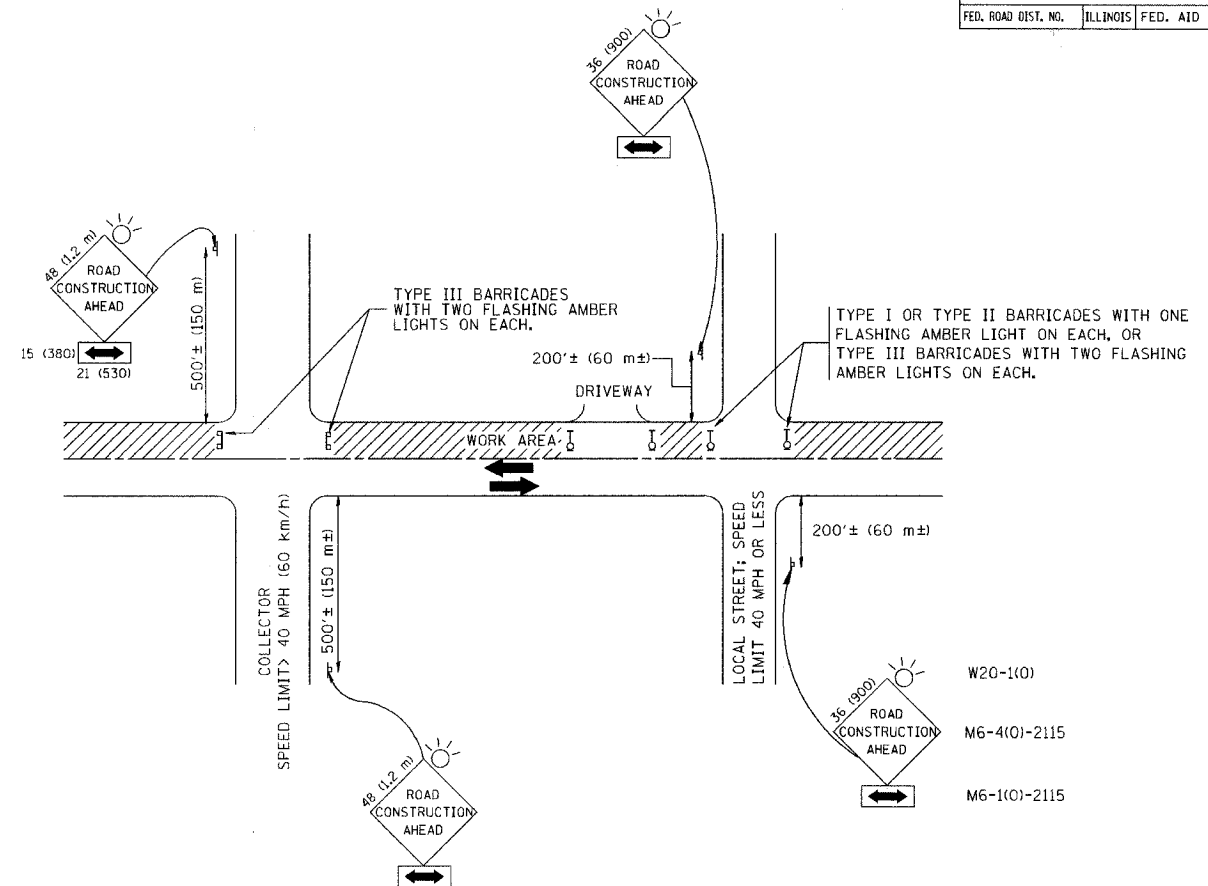

TRAFFIC CONTROL AND PROTECTION FOR SIDE ROADS, INTERSECTIONS, AND DRIVEWAYS

NOTES:

- A. FOR NO LANE RESTRICTION ON THE SIDE ROAD OR DRIVEWAYS
- SIDE ROAD WITH A SPEED LIMIT OF 40 MPH (60 km/h) OR LESS AS SHOWN ON THE DRAWING AND AS DIRECTED BY THE ENGINEER:
 - ONE **ROAD CONSTRUCTION AHEAD** SIGN 36 x 36 (900x900) WITH A FLASHER AND FLAG MOUNTED ON IT APPROXIMATELY 200' (60 m) IN ADVANCE OF THE MAIN ROUTE.
 - THE CLOSED PORTION OF THE MAIN ROUTE SHALL BE PROTECTED BY BLOCKING WITH TYPE I, TYPE II OR TYPE III BARRICADES, 1/3 OF THE CROSS SECTION OF THE CLOSED PORTION.
 - SIDE ROAD WITH A SPEED LIMIT GREATER THAN 40 MPH (60 km/h) AS SHOWN ON THE DRAWING AND AS DIRECTED BY THE ENGINEER:
 - ONE **ROAD CONSTRUCTION AHEAD** SIGN 48 x 48 (1.2 m x 1.2 m) WITH A FLASHER MOUNTED ON IT APPROXIMATELY 500' (150 m) IN ADVANCE OF THE MAIN ROUTE.
 - THE CLOSED PORTION OF THE MAIN ROUTE SHALL BE PROTECTED BY BLOCKING WITH TYPE III BARRICADES, 1/2 OF THE CROSS SECTION OF THE CLOSED PORTION.
 - WHEN THE SIDE ROAD LIES BETWEEN THE BEGINNING OF THE MAINLINE SIGNING AND THE WORK ZONE, A SINGLE HEADED ARROW (M6-1) SHALL BE USED IN LIEU OF THE DOUBLE HEADED ARROW (M6-4).
- B. FOR A LANE CLOSURE ON A SIDE ROAD OR DRIVEWAY:
- USE APPLICABLE PORTIONS OF THE TYPICAL APPLICATION OF TRAFFIC CONTROL DEVICES (STD. 701501, STD. 701606 OR THE APPROPRIATE STANDARD). THE SPACING OF SIGNS AND BARRICADES SHALL BE ADJUSTED FOR FIELD CONDITIONS AS DIRECTED BY THE ENGINEER. THE DIRECTIONAL ARROW SHALL BE COVERED OR REMOVED WHEN NO LONGER CONSISTENT WITH THE SIDE ROAD LANE CLOSURE.
- C. ADVANCE WARNING SIGNS ARE TO BE OMITTED ON DRIVEWAY UNLESS OTHERWISE NOTED.
- D. THE TRAFFIC CONTROL AND PROTECTION FOR SIDE ROADS, INTERSECTIONS, AND DRIVEWAYS SHALL BE INCIDENTAL TO THE COST OF SPECIFIED TRAFFIC CONTROL STANDARDS OR ITEMS.

All dimensions are in millimeters (inches) unless otherwise shown.

REVISIONS	
NAME	DATE
LHA	6/789
T. RAMMACHER	09/08/94
J. OBERLE	10/18/95
A. HOUSEH	03/06/96
A. HOUSEH	10/15/96
T. RAMMACHER	01/06/00

ILLINOIS DEPARTMENT OF TRANSPORTATION
TRAFFIC CONTROL AND PROTECTION FOR SIDE ROADS, INTERSECTIONS, AND DRIVEWAYS

SCALE: NONE
 DRAWN BY
 CHECKED BY

PLOT DATE = 3/6/2007
 FILE NAME = K:\hstest\c1\l18.dgn
 PLOT SCALE = 50.0000 / IN.
 USER NAME = bauerd

F.A. RTE.	SECTION	COUNTY	TOTAL SHEETS	SHEET NO.
			21	20
STA.		TO STA.		
FED. ROAD DIST. NO.	ILLINOIS	FED. AID PROJECT		

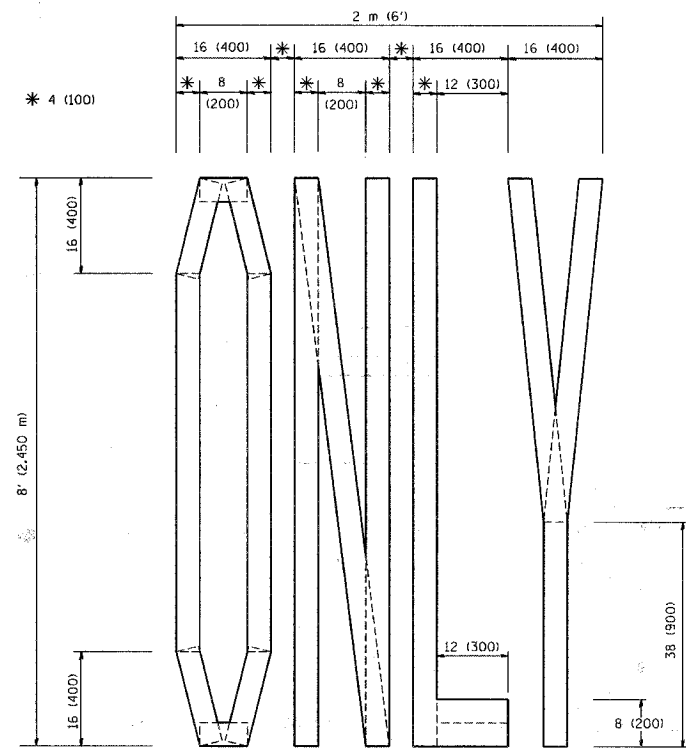

QUANTITY
 4 (100) LINE = 64.1 ft. (19.7 m)
 21.1 sq. ft. (1.97 sq. m)

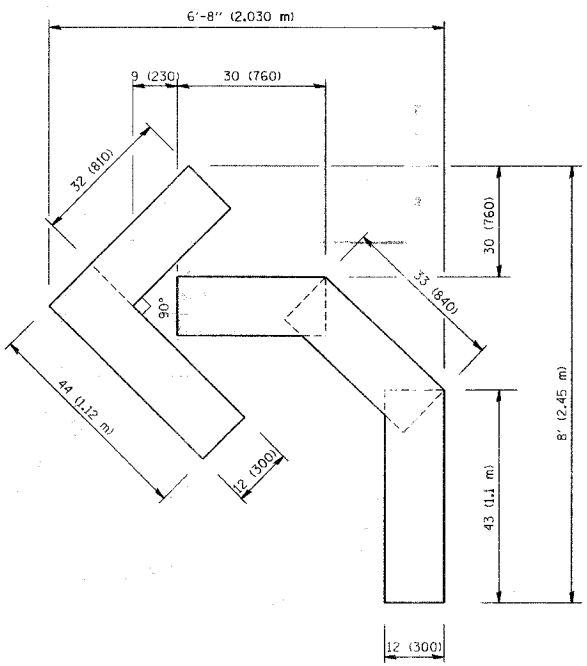

QUANTITY
 4 (100) LINE = 45.5 ft. (13.9 m)
 15.2 sq. ft. (1.39 sq. m)

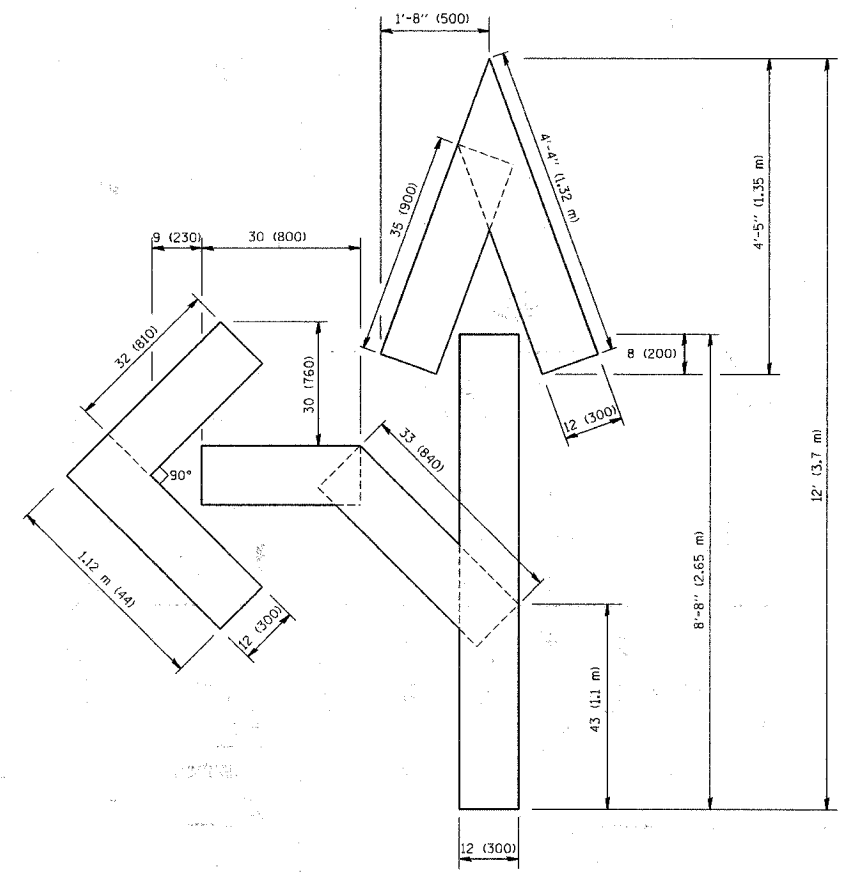

QUANTITY
 4 (100) LINE = 82.5 ft. (25.3 m)
 27.5 sq. ft. (2.53 sq. m)

All dimensions are in inches (millimeters) unless otherwise shown.

REVISIONS	
NAME	DATE
T. RAMMACHER	09/18/94
J. OBERLE	06/01/96
T. RAMMACHER	06/05/96
T. RAMMACHER	11/04/97
T. RAMMACHER	03/02/98
E. SOMEZ	08/28/00

ILLINOIS DEPARTMENT OF TRANSPORTATION

PAVEMENT MARKING
 LETTERS AND SYMBOLS
 FOR TRAFFIC STAGING

SCALE: NONE

DRAWN BY CADD

CHECKED BY

TC-16

F.A. RTE.	SECTION	COUNTY	TOTAL SHEETS	SHEET NO.
			21	21
STA.		TO STA.		
FED. ROAD DIST. NO.		ILLINOIS FED. AID PROJECT		

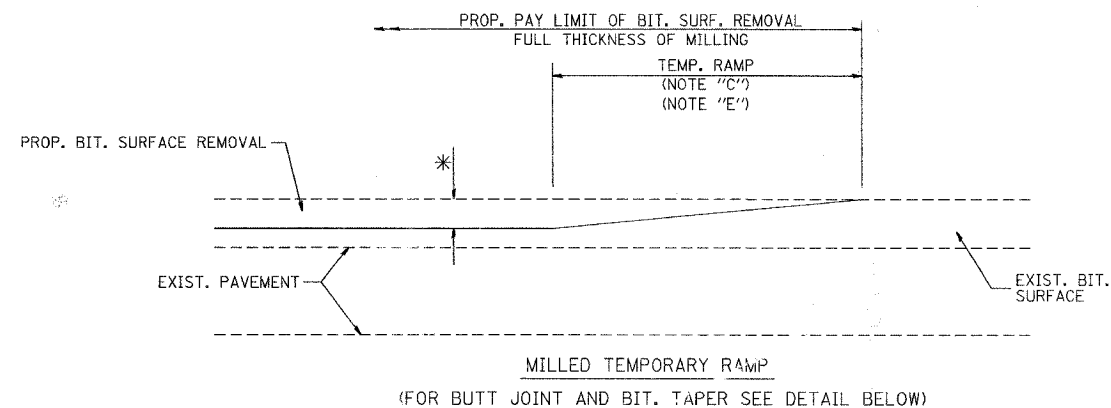

OPTION 1

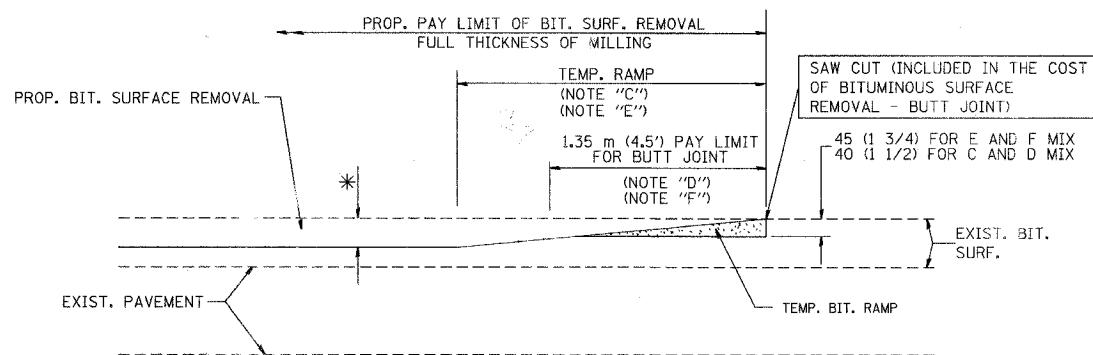

BITUMINOUS CONSTRUCTED TEMPORARY RAMP (FOR BUTT JOINT AND BIT. TAPER SEE DETAIL BELOW)

OPTION 2

TYPICAL TEMPORARY RAMP

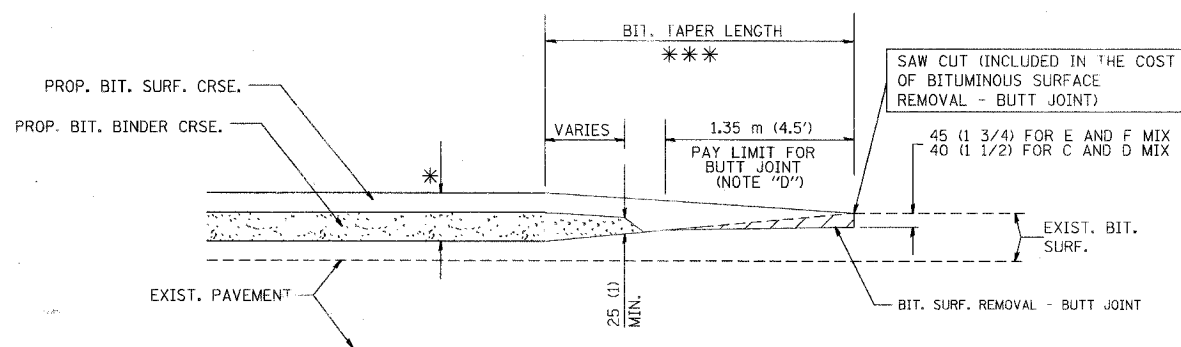

BUTT JOINT AND BITUMINOUS TAPER

TYPICAL BUTT JOINT AND BITUMINOUS TAPER FOR MILLING AND RESURFACING

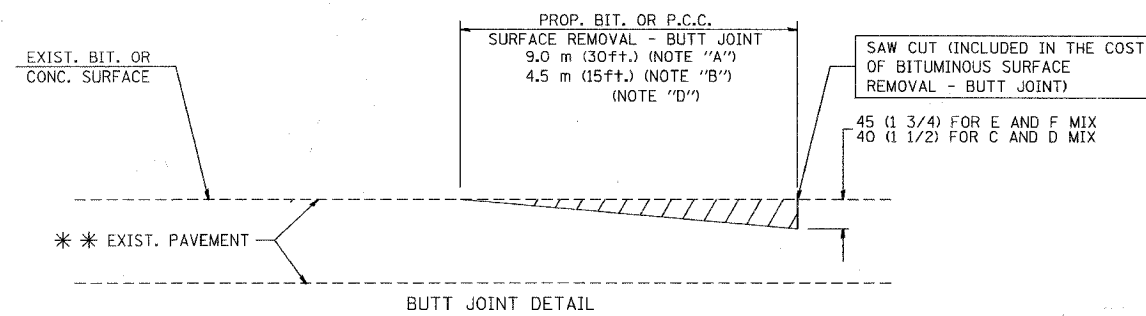

BUTT JOINT DETAIL

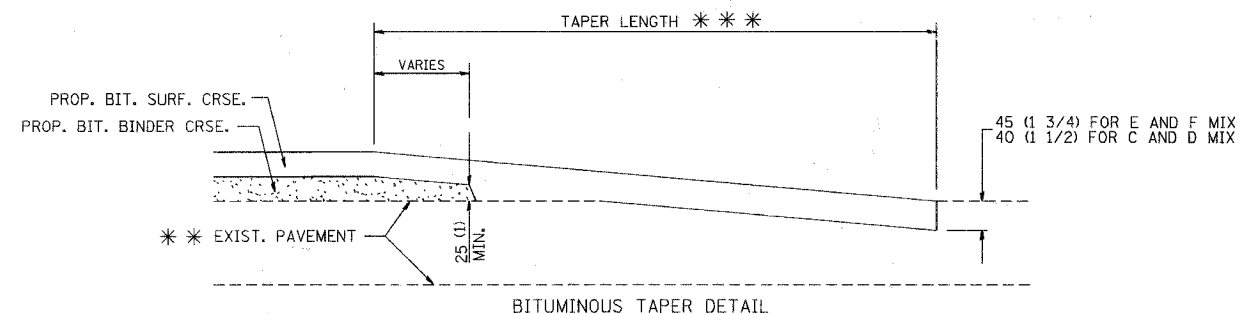

BITUMINOUS TAPER DETAIL

TYPICAL BUTT JOINT AND BITUMINOUS TAPER FOR RESURFACING ONLY

*** PC CONCRETE, BITUMINOUS OR BITUMINOUS RESURFACED PAVEMENT.

NOTES

- A: MAINLINE ROADWAYS AND MAJOR SIDE ROADS.
 - B: MINOR SIDE ROADS.
 - C: THE TEMP. RAMP SHALL BE CONSTRUCTED IMMEDIATELY UPON REMOVAL OF THE EXISTING BITUMINOUS SURFACE.
 - D: THE BUTT JOINT SHALL BE CONSTRUCTED IMMEDIATELY PRIOR TO PLACING THE PROPOSED BITUMINOUS COURSES.
 - E: TAPER THE TEMP. RAMP AT RATE OF 900 (3 ft.) PER INCH OF MILLING THICKNESS.
 - F: INSTALLATION AND REMOVAL OF THE 1.35 m (4.5') TEMP. BIT. RAMP WILL BE PAID AS "BITUMINOUS SURFACE REMOVAL - BUTT JOINT".
 - G: SEE ARTICLE 406.18 AND 406.24 OF THE STANDARD SPECIFICATIONS FOR "BITUMINOUS AND PCC SURFACE REMOVAL, BUTT JOINT".
- * SEE TYPICAL SECTIONS FOR MILLING THICKNESS.
- *** 6.1 m (20') PER 25 (1) RESURFACING (NOTE "A")
3.0 m (10') PER 25 (1) RESURFACING (NOTE "B")

ALL DIMENSIONS ARE IN MILLIMETERS (INCHES) UNLESS OTHERWISE SHOWN.

BASIS OF PAYMENT:

THE BUTT JOINT WILL BE PAID FOR PER SQUARE METER (SQUARE YARD.) AS "BITUMINOUS SURFACE REMOVAL - BUTT JOINT" OR AS "PORTLAND CEMENT CONCRETE SURFACE REMOVAL - BUTT JOINT".

REVISIONS	
NAME	DATE
M. DE YONG	6-13-90
M. DE YONG	7-3-90
M. DE YONG	3-27-92
R. SHAH	09/09/94
R. SHAH	10/25/94
A. ABBAS	03/21/97
M. COMEZ	04/06/01

ILLINOIS DEPARTMENT OF TRANSPORTATION

BUTT JOINT AND BITUMINOUS TAPER DETAILS

SCALE: VERT. HORIZ. DATE: 2/15/2006

DRAWN BY CHECKED BY

BD400-05 (VI-BD32)

REVISION DATE: 04/06/01