

ELEVATION OF NORTH BICYCLE RAILING

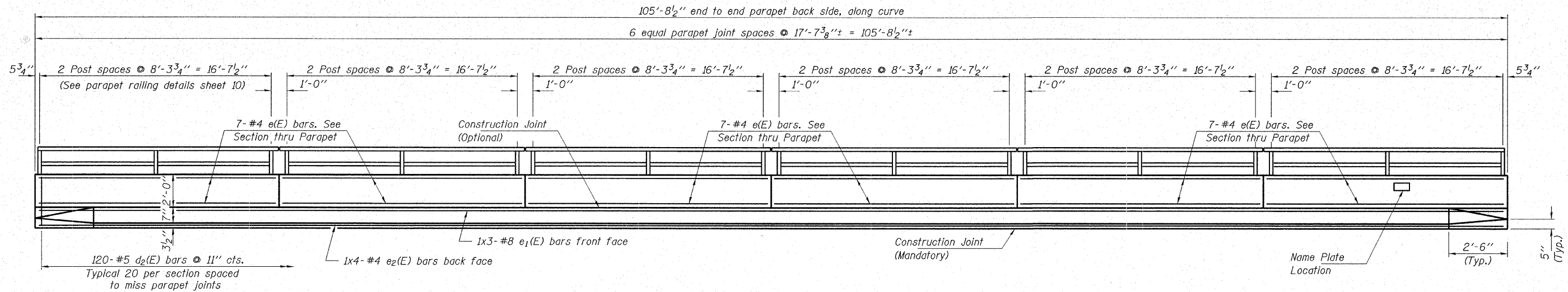

INSIDE ELEVATION OF NORTH PARAPET

(North Parapet of Westbound Structure)

MIN. BAR LAPS

#4 bars = 1'-8"
#8 bars = 4'-6"

Note: Space reinforcement to miss Bicycle Railing and Parapet Railing anchor bolts.

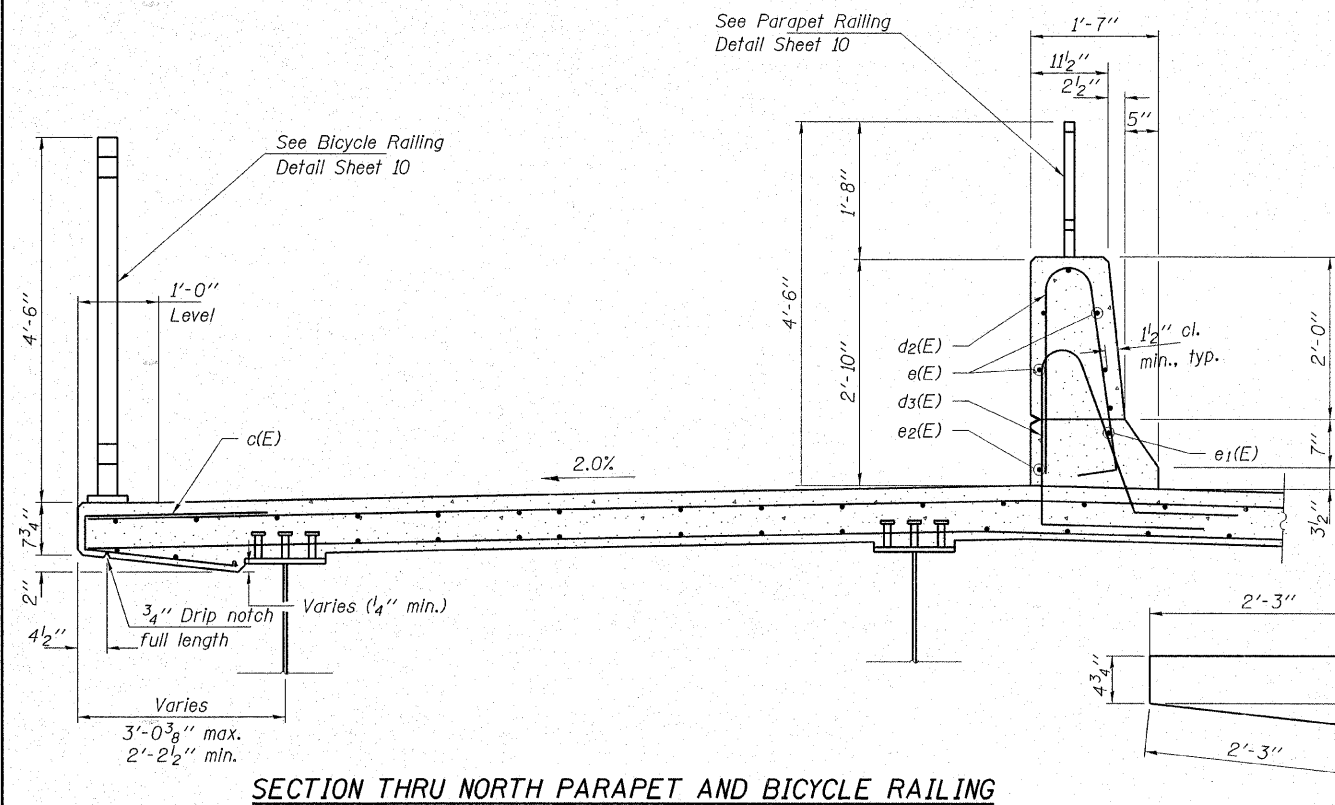

SECTION THRU NORTH PARAPET AND BICYCLE RAILING

BAR c(E)

BAR d2(E)

BAR d3(E)

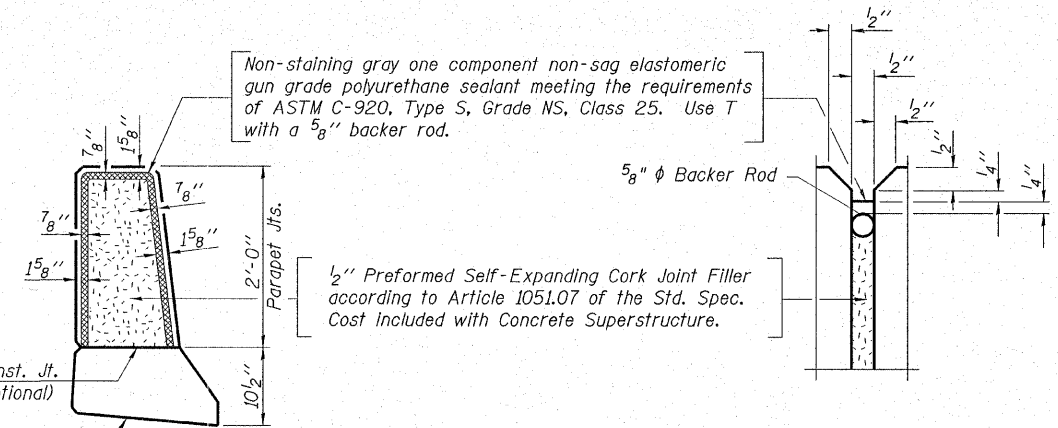

PARAPET JOINT DETAILS

Note:
See Sheet 7 of 18 W.B. for Superstructure Bill of Material

HAMPTON, LENZINI & RENWICK, INC.
CIVIL & STRUCTURAL ENGINEERS
LAND SURVEYORS

3085 STEVENSON DRIVE, SUITE 201
SPRINGFIELD, ILLINOIS 62703
(217) 546-3400

HLR ELGIN • SPRINGFIELD

PROJECT NUMBER: 12-05-0077-1 DATE: 09/20/07
DESIGNED: T.P.L. CHECKED: J.L.B. DRAWN: P.J.L.

SUPERSTRUCTURE DETAILS
SECTION 06-00214-08-BR
F.A.U. ROUTE 361 / NEW STEARNS ROAD
OVER THE NORTH ARM OF BREWSTER CREEK
KANE COUNTY

STRUCTURE NO. 045-3165 (W.B.) / STATION 590+18.15