

F.A.U. RTE.	SECTION	COUNTY	TOTAL SHEETS	SHEET NO.
3869	07-00009-00-RS	McHENRY	14	8
STA. 62+50		TO STA. 80+50		
FED. ROAD DIST. NO.	ILLINOIS	FED AID PROJECT		
C-91-340-07		M-8003 (840)		

CONTRACT: 83979

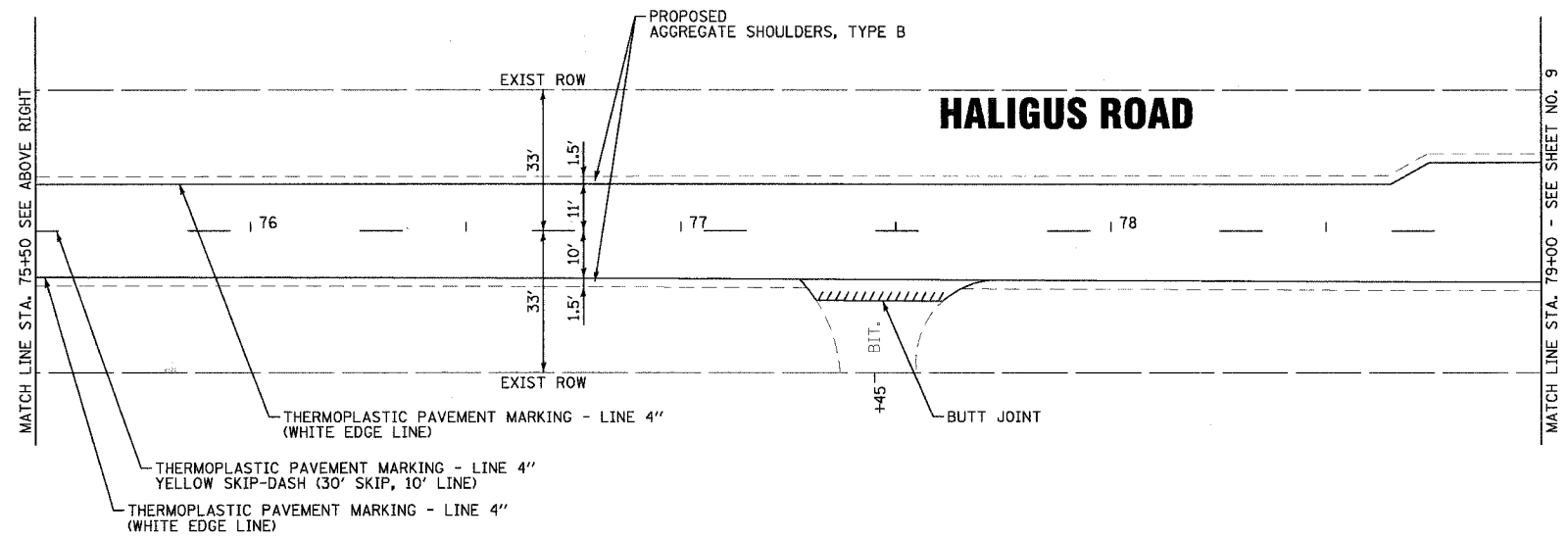
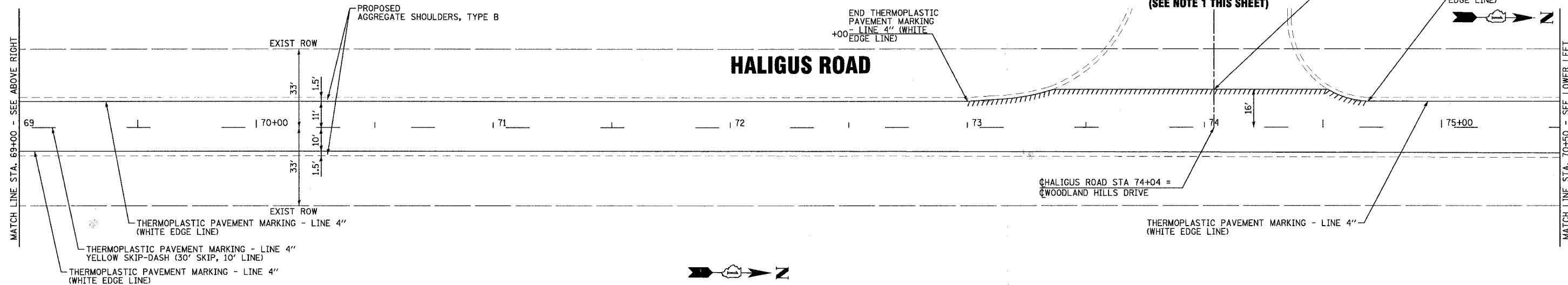
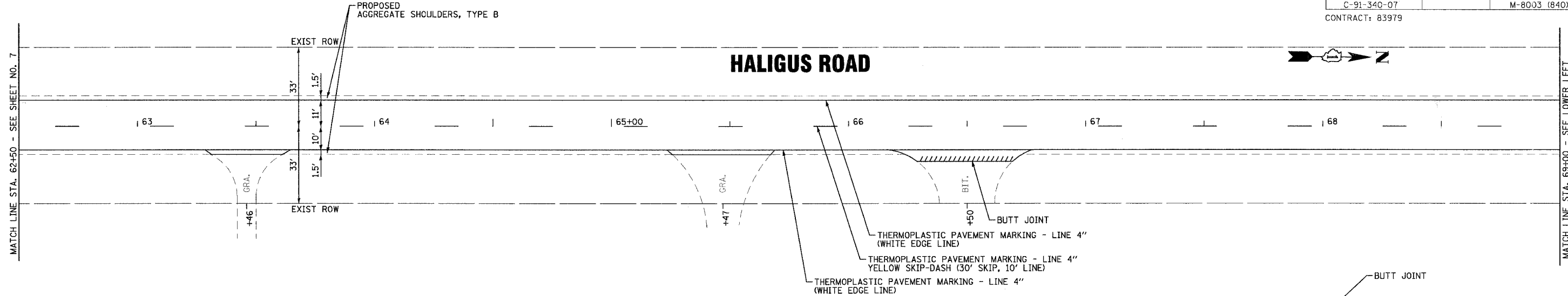

NOTES: 1. WOODLAND HILLS DRIVE IS CURRENTLY UNDER CONSTRUCTION. THIS ROADWAY WILL PROVIDE ACCESS TO THE NEW RESIDENTIAL SUBDIVISION "WOODLAND HILLS". THIS ROADWAY ALSO CONNECTS TO WOODLAND HILLS DRIVE SHOWN ON SHEET 7.

COPYRIGHT © 2007 BY BAXTER & WOODMAN, INC.
 LICENSE NO. - B4-00121 - EXPIRES 1/30/2008
 11/5/2007 9:50:58 AM I:\LKMD\070489-Haligus STA 62+50 to 79+00.DWG (070489-PLAN-4.BIT)

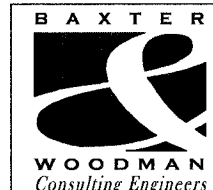

REVISIONS	
NAME	DATE
MWP	10/2/07
MWP	11/1/07

VILLAGE OF LAKEWOOD
F.A.U. ROUTE 3869 HALIGUS ROAD
STA 62+50 TO STA 79+00

PROJECT NO.: 070489 DESIGNED BY: (DJS)
 SCALE: 1" = 20' DRAWN BY: (RKM)
 DATE: 08/07/07 CHECKED BY: (MWP)