

F.A.U. RTE.	SECTION	COUNTY	TOTAL SHEETS	SHEET NO.
1338	05-00083-00-FF	COOK	167	94
STA.		TO STA.		
FED. ROAD DIST. NO. 7		ILLINOIS FED. AID PROJECT M-8003(512)		

TRAFFIC SIGNAL LEGEND

EXISTING		PROPOSED		EXISTING		PROPOSED	
CONTROLLER			DETECTOR LOOP				
SERVICE INSTALLATION			CAST IRON JUNCTION BOX				
SIGNAL HEAD			EMERGENCY VEHICLE SYSTEM DETECTOR				
SIGNAL HEAD WITH BACKPLATE			CONFIRMATION BEACON				
SIGNAL HEAD, PEDESTRIAN			SIGNAL HEAD PROGRAMMED				
SIGNAL POST			CONDUIT SPLICE				
MAST ARM ASSEMBLY AND POLE, STEEL			WOOD POLE				
MAST ARM ASSEMBLY AND POLE, ALUMINUM			RACEWAY FOR MAGNETIC DETECTOR, TYPE I OR TYPE II				
COMBINATION MAST ARM ASSEMBLY AND POLE, STEEL			VEHICLE DETECTOR, NON COMPENSATED MAGNETIC TYPE				
COMMON TRENCH		CT	RAILROAD CONTROLLER				
UNIT DUCT		UD	ILLUMINATED SIGN, FIBER OPTIC NO LEFT TURN				
HANDHOLE			ILLUMINATED SIGN, FIBER OPTIC NO RIGHT TURN				
HEAVY-DUTY HANDHOLE			TELEPHONE CONNECTION				
DOUBLE HANDHOLE			UNINTERRUPTIBLE POWER SUPPLY				
G.S. CONDUIT IN TRENCH OR PUSHED							
PEDESTRIAN PUSH-BUTTON DETECTOR							



MATCHLINE A

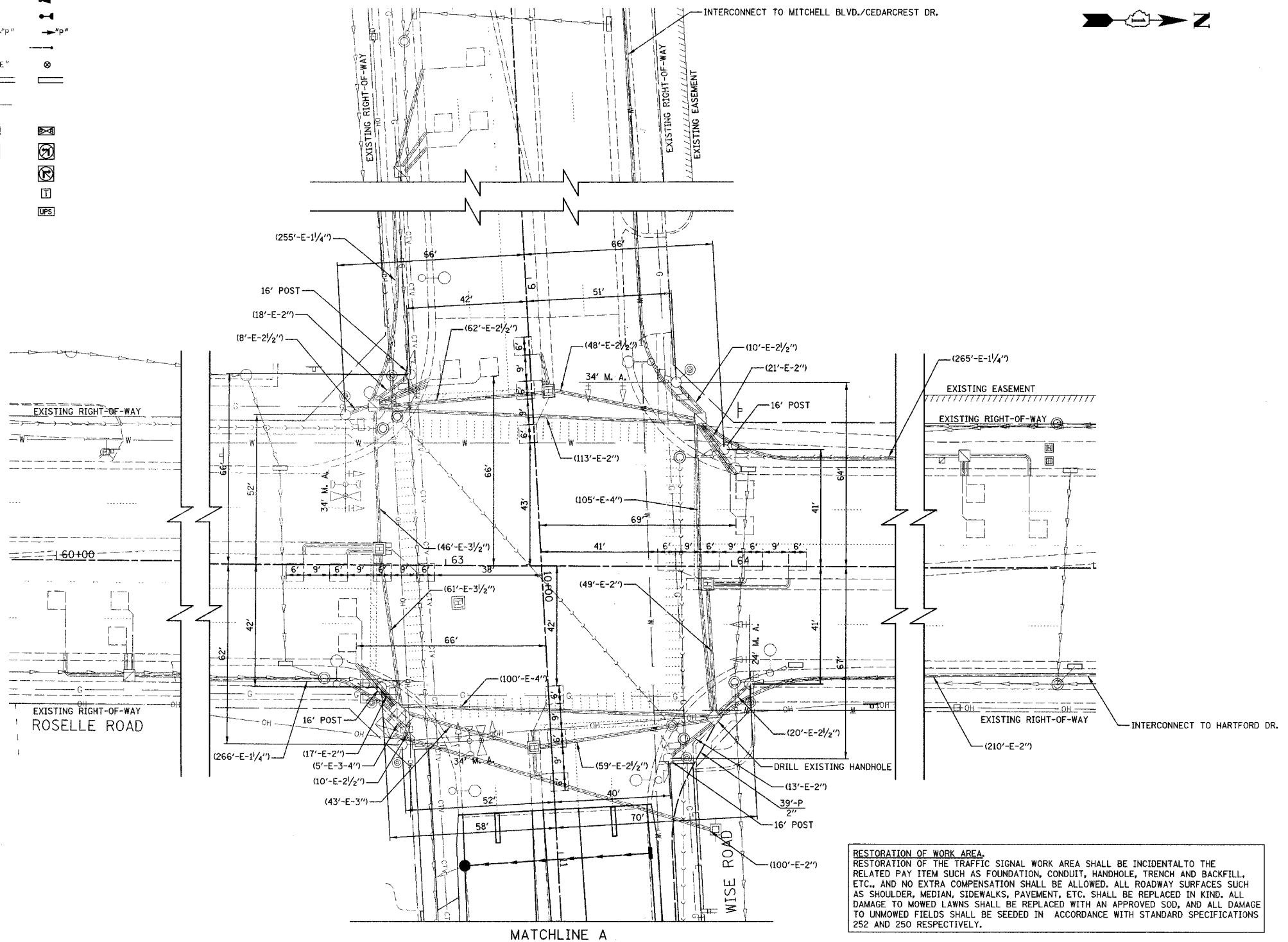
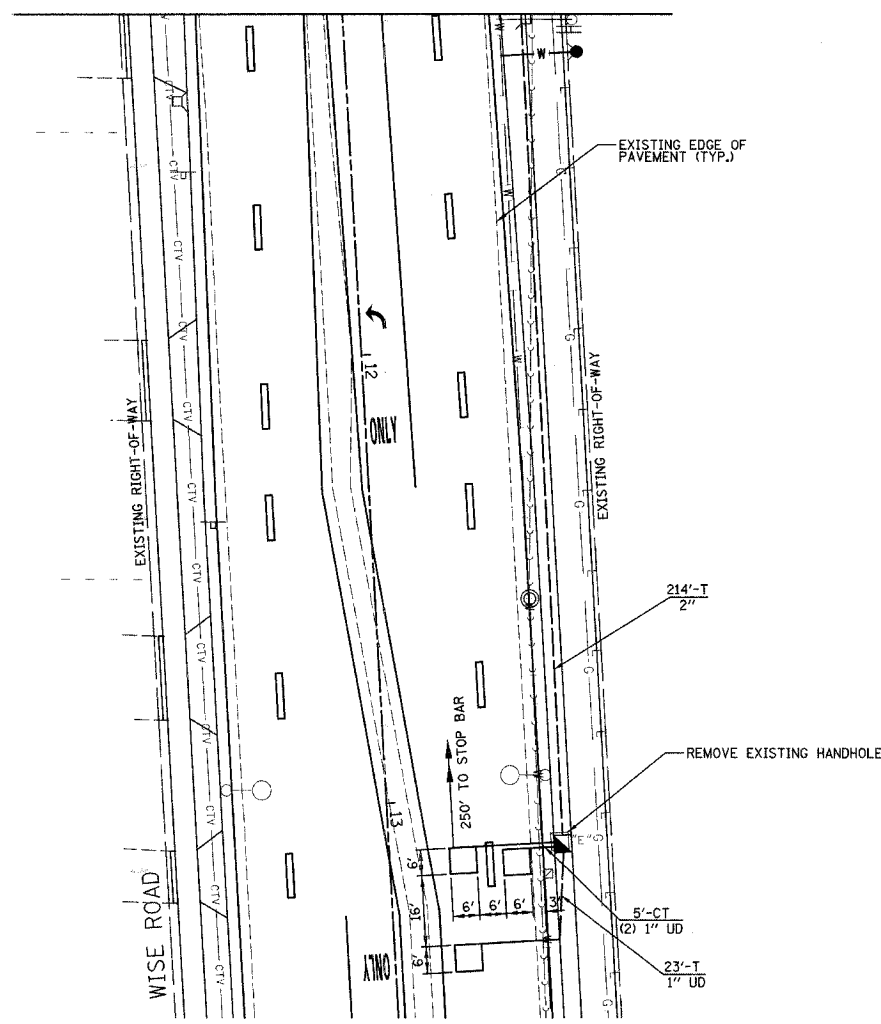

MATCHLINE A

RESTORATION OF WORK AREA.
 RESTORATION OF THE TRAFFIC SIGNAL WORK AREA SHALL BE INCIDENTAL TO THE RELATED PAY ITEM SUCH AS FOUNDATION, CONDUIT, HANDHOLE, TRENCH AND BACKFILL, ETC. AND NO EXTRA COMPENSATION SHALL BE ALLOWED. ALL ROADWAY SURFACES SUCH AS SHOULDER, MEDIAN, SIDEWALKS, PAVEMENT, ETC. SHALL BE REPLACED IN KIND. ALL DAMAGE TO MOWED LAWNS SHALL BE REPLACED WITH AN APPROVED SOD, AND ALL DAMAGE TO UNMOWED FIELDS SHALL BE SEEDED IN ACCORDANCE WITH STANDARD SPECIFICATIONS 252 AND 250 RESPECTIVELY.

ILLINOIS DEPARTMENT OF TRANSPORTATION

TRAFFIC SIGNAL MODIFICATION PLAN

WISE ROAD AND ROSELLE ROAD

SCALE IN FEET

DATE: 9/28/07
 DESIGNED BY: JJE
 CHECKED BY: JRJ