

F.A.U. RTE.	SECTION	COUNTY	TOTAL SHEETS	SHEET NO.
1338	05-0083-00-FP	COOK	167	106
LIGHTING PLAN - STA. 11+15 TO STA. 19+50				
FED. ROAD DIST. NO. 7 ILLINOIS FED. AID PROJECT W-80035121				

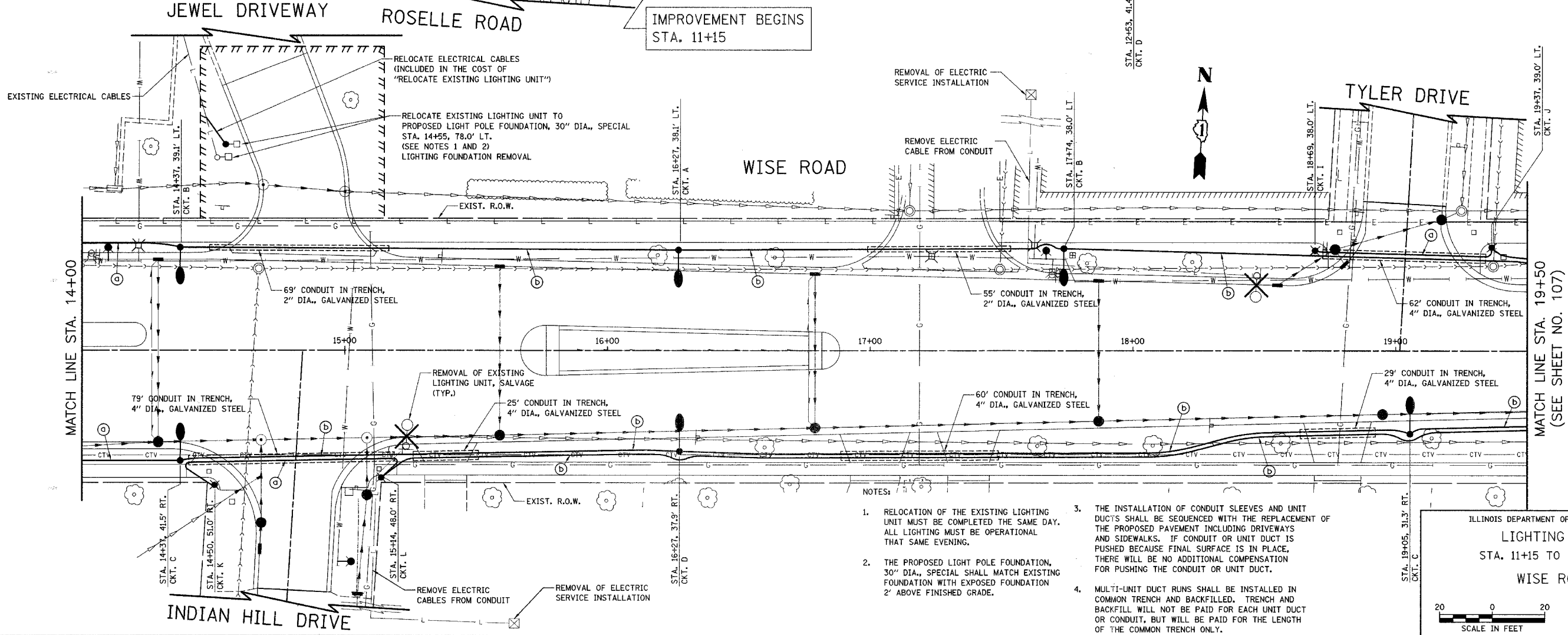

- LEGEND**
- PROPOSED LIGHTING UNIT
250 WATT HPS, 240 V, MS III, 30' MH, 12' MA
 - PROPOSED LIGHTING UNIT
250 WATT HPS, 240 V, MS III, 40' MH, 12' MA
 - PROPOSED LIGHTING UNIT
400 WATT HPS, 240 V, MS III, 40' MH, 12' MA
 - PROPOSED DECORATIVE LIGHTING UNIT
100 WATT HPS, 240 V, 12' MH
 - EXISTING LIGHTING UNIT
 - PROPOSED LIGHTING HANDHOLE
 - PROPOSED LIGHTING CONTROLLER, SPECIAL
200 AMP, 240/480 V
 - REMOVAL OF EXISTING LIGHTING UNIT, SALVAGE
 - PROPOSED CONDUIT IN TRENCH, GALVANIZED STEEL
(SIZE AS SPECIFIED)
 - PROPOSED UNIT DUCT
 - (a) 600V, 2-1C NO. 4, 1/C NO. 4 GROUND,
(XLP-TYPE USE), 1" DIA., POLYETHYLENE
 - (b) 600V, 3-1C NO. 4, 1/C NO. 4 GROUND,
(XLP-TYPE USE), 1/4" DIA., POLYETHYLENE

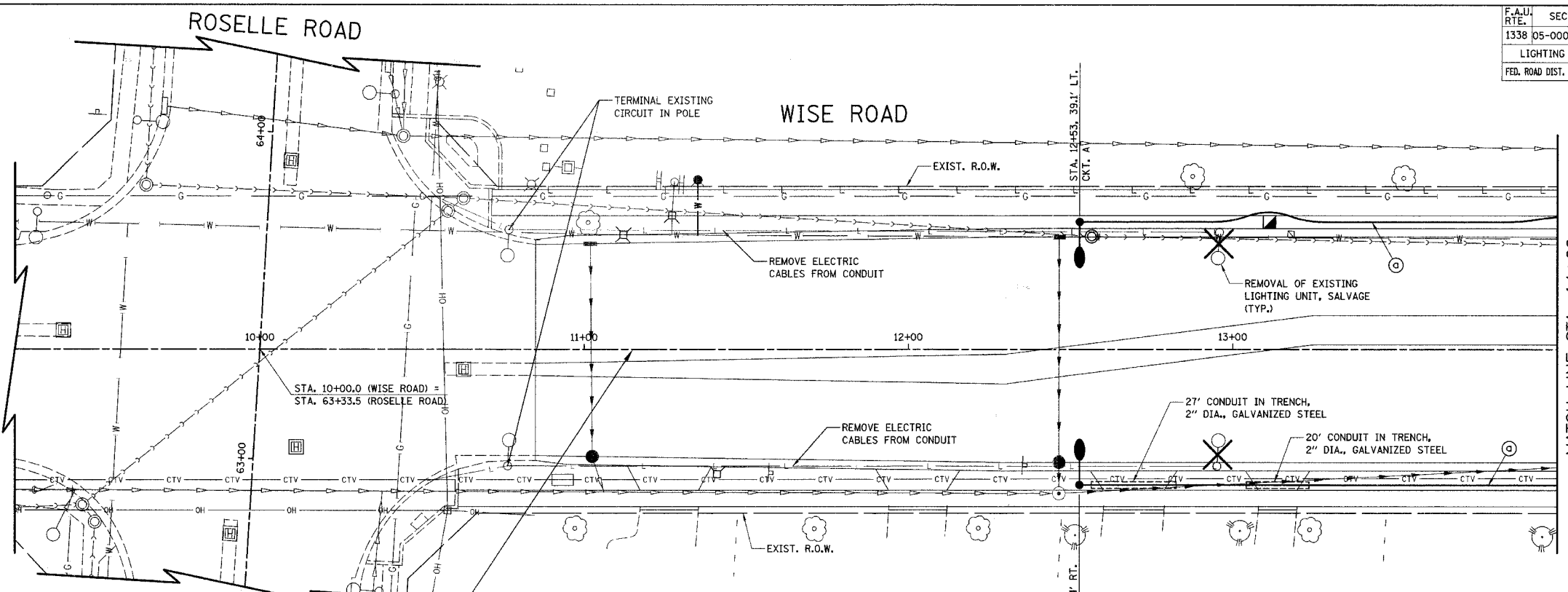

NOTES:

1. RELOCATION OF THE EXISTING LIGHTING UNIT MUST BE COMPLETED THE SAME DAY. ALL LIGHTING MUST BE OPERATIONAL THAT SAME EVENING.
2. THE PROPOSED LIGHT POLE FOUNDATION, 30" DIA., SPECIAL SHALL MATCH EXISTING FOUNDATION WITH EXPOSED FOUNDATION 2' ABOVE FINISHED GRADE.
3. THE INSTALLATION OF CONDUIT SLEEVES AND UNIT DUCTS SHALL BE SEQUENCED WITH THE REPLACEMENT OF THE PROPOSED PAVEMENT INCLUDING DRIVEWAYS AND SIDEWALKS. IF CONDUIT OR UNIT DUCT IS PUSHED BECAUSE FINAL SURFACE IS IN PLACE, THERE WILL BE NO ADDITIONAL COMPENSATION FOR PUSHING THE CONDUIT OR UNIT DUCT.
4. MULTI-UNIT DUCT RUNS SHALL BE INSTALLED IN COMMON TRENCH AND BACKFILLED. TRENCH AND BACKFILL WILL NOT BE PAID FOR EACH UNIT DUCT OR CONDUIT, BUT WILL BE PAID FOR THE LENGTH OF THE COMMON TRENCH ONLY.

ILLINOIS DEPARTMENT OF TRANSPORTATION
LIGHTING PLAN
 STA. 11+15 TO STA. 19+50
WISE ROAD

DATE: 9/28/07
 DESIGNED BY: SJC
 CHECKED BY: DNM