

EXISTING TOPOGRAPHY

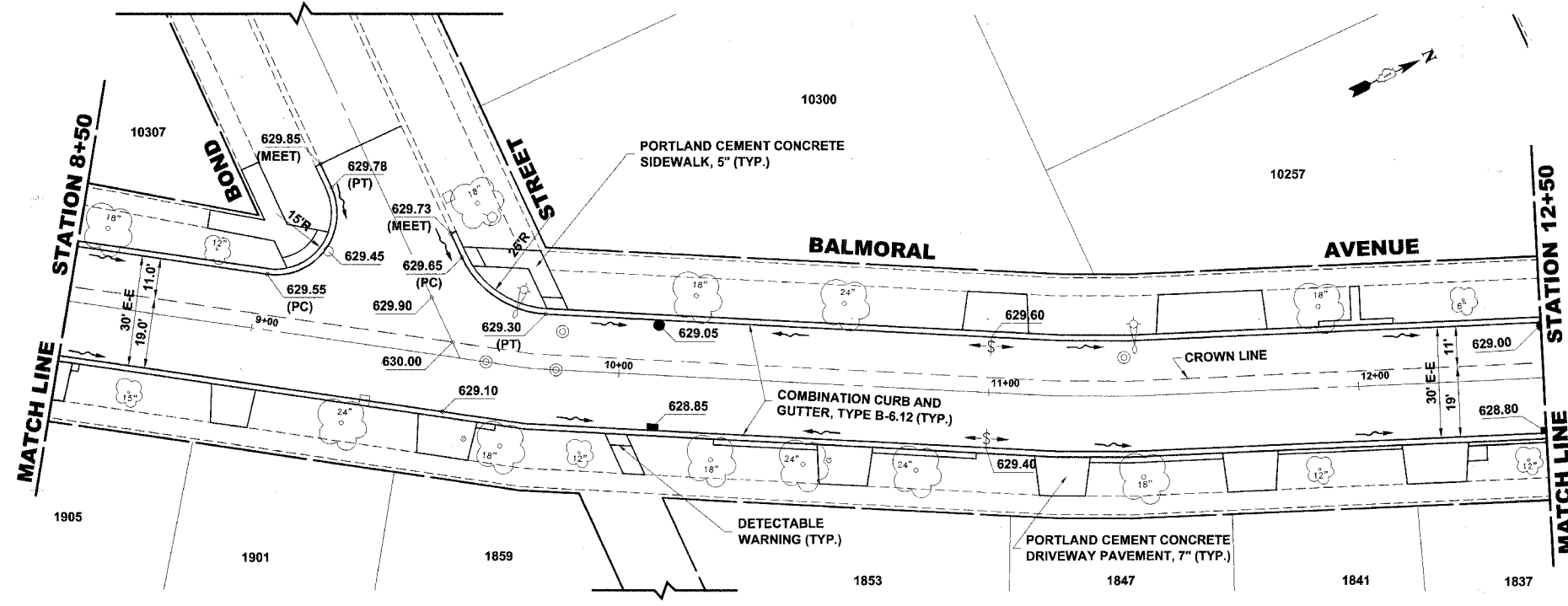

PROPOSED IMPROVEMENTS

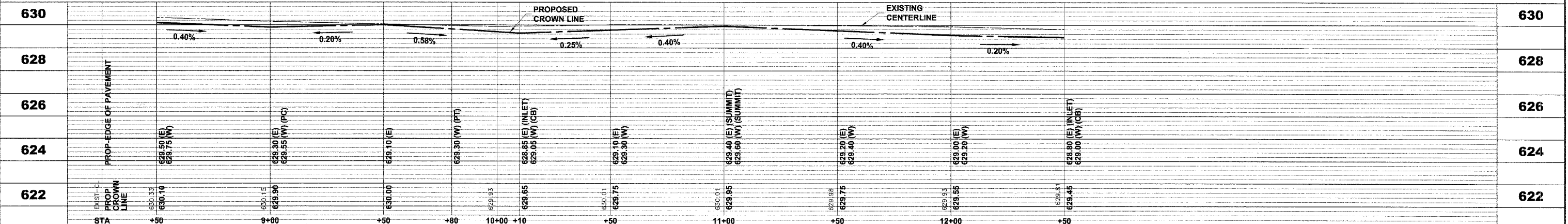

Drawing file: W:\Projects\83982\FEC - Balmoral Avenue Phase 1\BALMORAL_Balmoral.dwg Oct 04, 2007 - 8:15am

HANCOCK ENGINEERING ♦ Civil Engineers
 ♦ Municipal Consultants
 ♦ Established 1911

9933 Roosevelt Road
 Westchester, Illinois 60154-2780
 Phone: 708/865-0300
 Fax: 708/865-1212

**BALMORAL AVENUE IMPROVEMENTS
 VILLAGE OF WESTCHESTER, ILLINOIS**

**EXISTING AND PROPOSED
 PAVING PLAN AND PROFILE**

SCALE:	1"=20'H; 1"=2'V	SHEET 12 OF 36
DRAWN BY:	NAW/LEV/IMK	
BOOK NO.:	1394/1427/LS	
DATE:	10-3-07	
REVISION:	E.H.E. NO. 838-06-16601	