

EXISTING TOPOGRAPHY

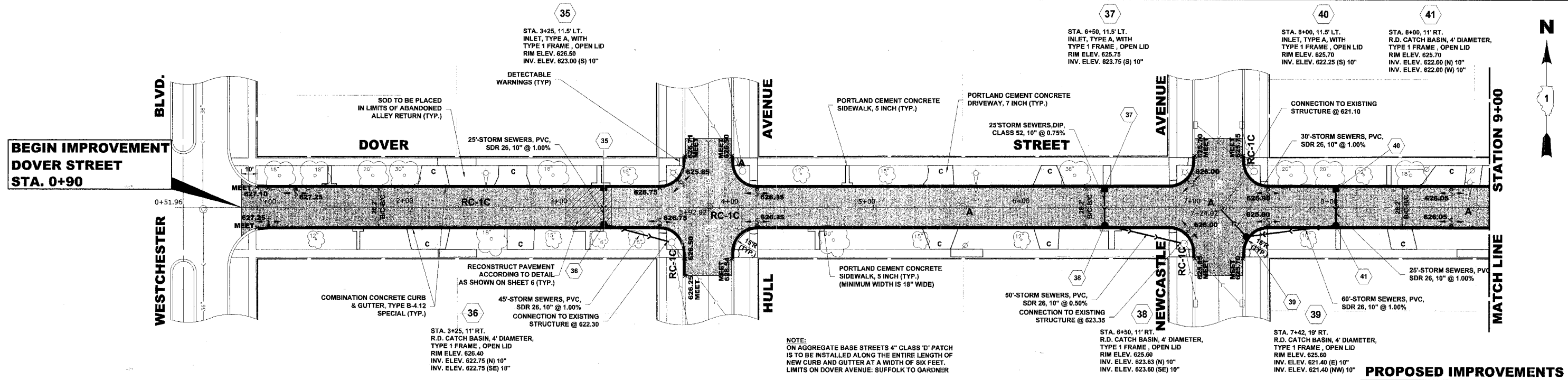

PROPOSED IMPROVEMENTS

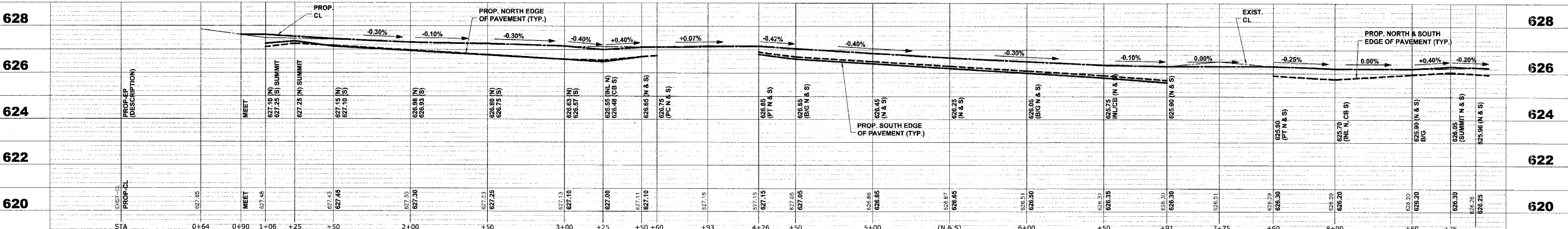

Drawing file: W:\Projects\33060293 - High Priority Project Bristol & Dover\Bristol And Dover.dwg Oct 03, 2007 11:02am

HANCOCK ENGINEERING

- Civil Engineers
- Municipal Consultants
- Established 1911

9933 Roosevelt Road
Westchester, Illinois 60154-2780
Phone: 708/865-0300
Fax: 708/865-1212

HIGH PRIORITY PROJECT HPP-2902 (002)
BRISTOL AVENUE & DOVER STREET
VILLAGE OF WESTCHESTER, ILLINOIS

DOVER STREET
PLAN & PROFILE

SCALE:	1"=30'H. & 1"=2'V.	SHEET	14
DRAWN BY:	ECW/LEV	BOOK NO.:	1541
DATE:	10-2-07	DATE:	10-2-07
REVISION:	E.H.E. NO.: 838-06-38501	OF	22