

F.A.U. RTE.	SECTION	COUNTY	TOTAL SHEETS	SHEET NO.
2993	05-00094-00-WR	DUPAGE	67	15
STA. 100+00		TO STA. 110+00		
FED. ROAD DIST. NO. 1 ILLINOIS FED. AID PROJECT				
PROJECT NO.: M-8003 (707)				



ADVANCE SIGNING FOR ROAD CLOSURE AND DETOUR ROUTE PER IDOT DISTRICT STD TC21

REFER TO DETOUR PLAN FOR DETOUR ROUTE AND SIGNING.

CONSTRUCTION ZONE FOR PROPOSED SIDEWALK AND DRIVEWAY APRONS (TYP)

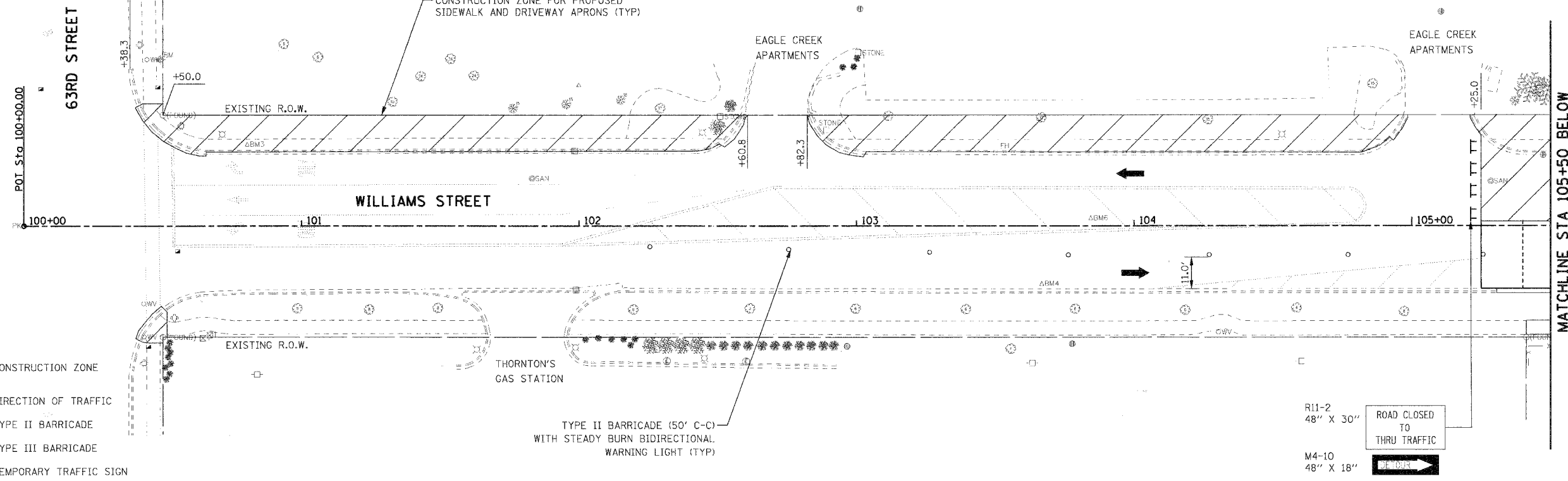

- LEGEND:**
- CONSTRUCTION ZONE
  - DIRECTION OF TRAFFIC
  - TYPE II BARRICADE
  - TYPE III BARRICADE
  - TEMPORARY TRAFFIC SIGN

R11-2  
48" X 30"  
ROAD CLOSED TO THRU TRAFFIC

M4-10  
48" X 18"  
DETOUR

PLAN	SURVEYED	DATE
	PLOTTED	BY
	CHECKED	
	DATE	
	NO. OF WAYS CHECKED	
	CADD FILE NAME	

PROFILE	SURVEYED	DATE
	PLOTTED	BY
	CHECKED	
	DATE	
	NO. OF WAYS CHECKED	
	STRUCTURE NOTATIONS (GRID)	

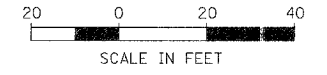
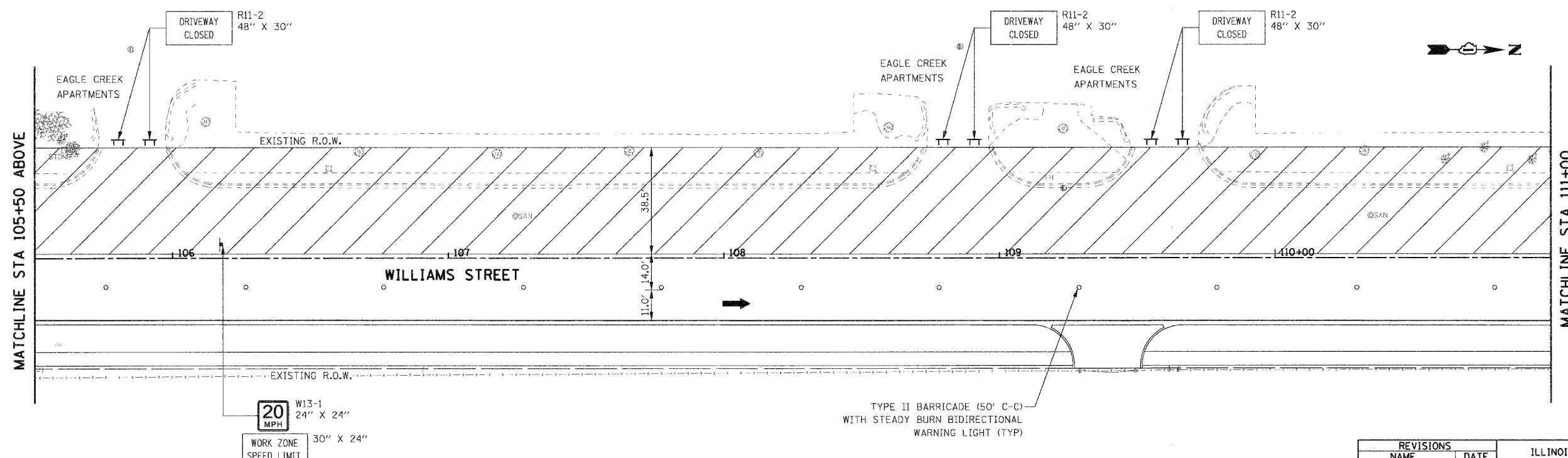

20 MPH  
W13-1  
24" X 24"  
WORK ZONE SPEED LIMIT

TYPE II BARRICADE (50' C-C) WITH STEADY BURN BIDIRECTIONAL WARNING LIGHT (TYP)

- NOTES:**
- WILLIAMS STREET CLOSED TO THRU TRAFFIC BETWEEN 63RD STREET AND 61ST STREET. REFER TO DETOUR PLAN FOR MORE INFORMATION.
  - FOUR DRIVEWAYS TO EAGLE CREEK APARTMENTS CLOSED DURING CONSTRUCTION OF THE WEST SIDE OF WILLIAMS STREET BETWEEN STA 105+25 AND STA 113+00.

REVISIONS		ILLINOIS DEPARTMENT OF TRANSPORTATION
NAME	DATE	
		VILLAGE OF WESTMONT WILLIAMS STREET RECONSTRUCTION MAINTENANCE OF TRAFFIC, STAGE 2 SHEET 1 OF 3

SCALE: 1:20  
DATE: 09/21/07  
DRAWN BY: JMT  
CHECKED BY: MAP

PLOT DATE = #DATE#  
FILE NAME = #FILE#  
PLOT SCALE = #SCALE#  
USER NAME = #USER#