

F.A.U. RTE.	SECTION	COUNTY	TOTAL SHEETS	SHEET NO.
2993	05-00094-00-WR	DUPAGE	67	16
STA. 110+00		TO STA. 122+00		
FED. ROAD DIST. NO. 1 ILLINOIS FED. AID PROJECT				
PROJECT NO.: M-8003 (707)				

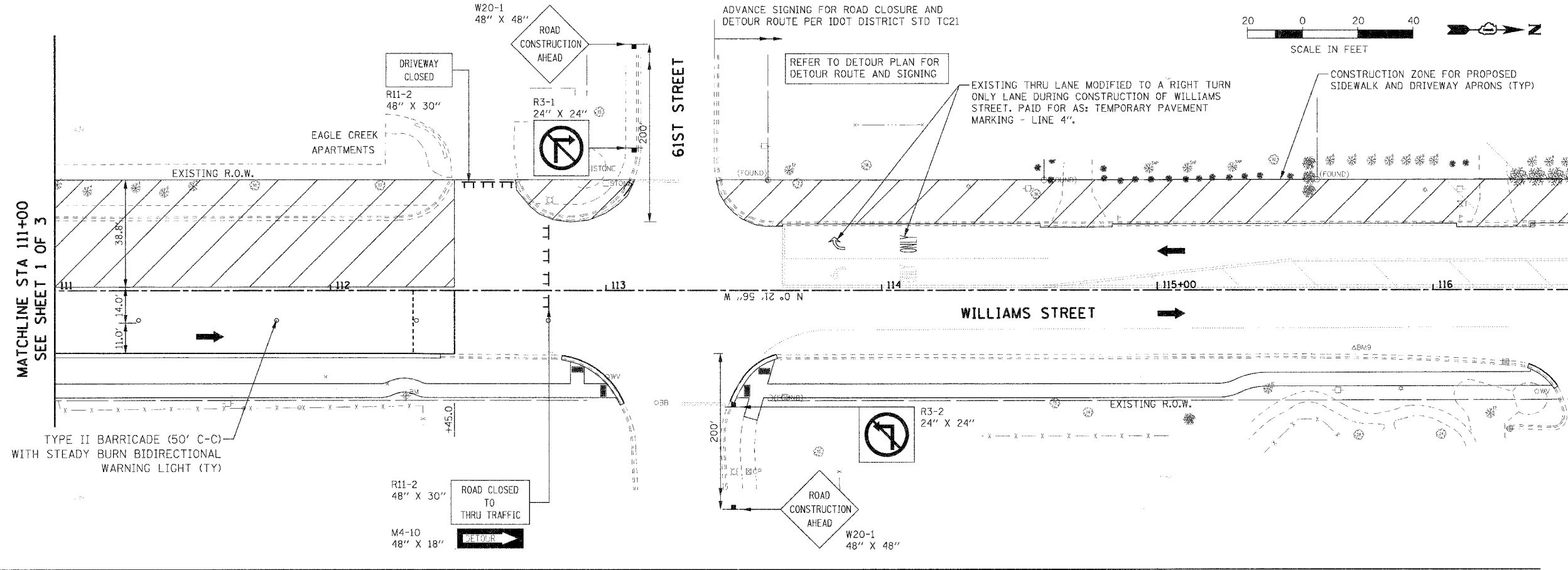

PLAN	SURVEYED	DATE
NO.	BY	
	CHECKED	
	DATE	
	BY	
	CHECKED	
	DATE	



LEGEND:

- CONSTRUCTION ZONE
- DIRECTION OF TRAFFIC
- TYPE II BARRICADE
- TYPE III BARRICADE
- TEMPORARY TRAFFIC SIGN

PROFILE	SURVEYED	DATE
NO.	BY	
	CHECKED	
	DATE	
	BY	
	CHECKED	
	DATE	

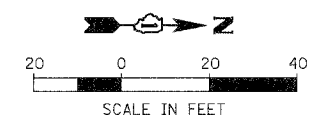
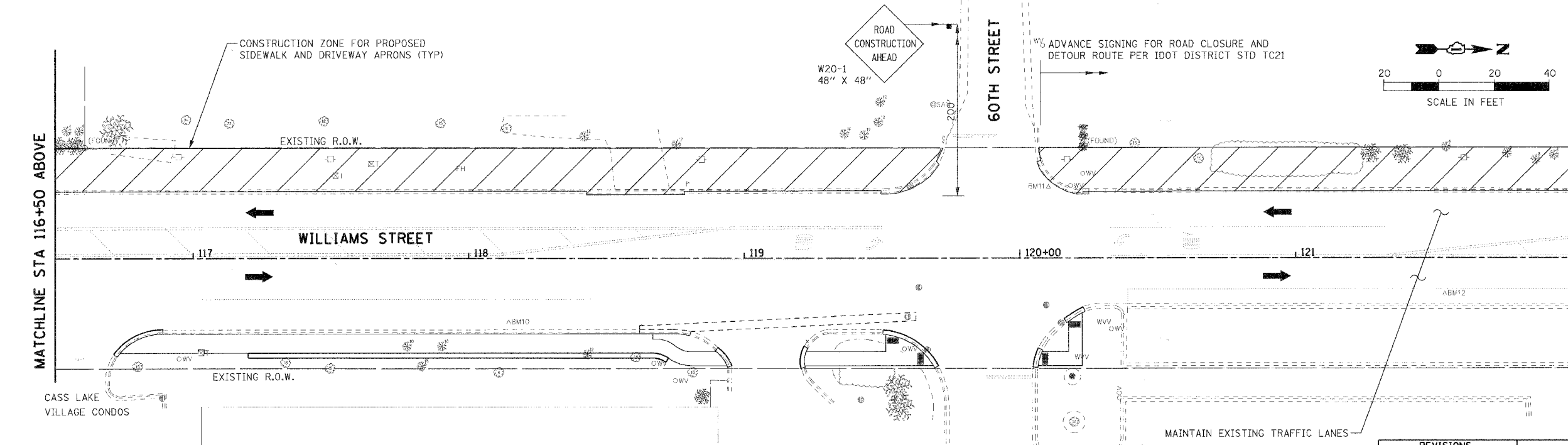

NOTES:

1. WILLIAMS STREET CLOSED TO THRU TRAFFIC BETWEEN 63RD STREET AND 61ST STREET. REFER TO DETOUR PLAN FOR MORE INFORMATION.
2. FOUR DRIVEWAYS TO EAGLE CREEK APARTMENTS CLOSED DURING CONSTRUCTION OF THE WEST SIDE OF WILLIAMS STREET BETWEEN STA 105+25 AND STA 113+00.
3. SOUTHBOUND THRU LANE AT 61ST STREET SHALL TEMPORARILY BE CONVERTED TO A RIGHT TURN ONLY LANE DURING CONSTRUCTION OF THE SOUTHBOUND WILLIAMS STREET PAVEMENT. STRIPING SHALL BE PAID FOR AS: TEMPORARY PAVEMENT MARKING - LINE 4".

REVISIONS	
NAME	DATE

ILLINOIS DEPARTMENT OF TRANSPORTATION

VILLAGE OF WESTMONT

WILLIAMS STREET RECONSTRUCTION

MAINTENANCE OF TRAFFIC, STAGE 2

SHEET 2 OF 3

SCALE: 1/2"=1'

DATE: 09/21/07

DRAWN BY: JMT

CHECKED BY: MAP

PLOT DATE = #DATE#  
 FILE NAME = #FILE#  
 PLOT SCALE = #SCALE#  
 USER NAME = #USER#