

F.A.U. RTE.	SECTION	COUNTY	TOTAL SHEETS	SHEET NO.
2993	05-00094-00-WR	DUPAGE	67	38
STA. 100+00		TO STA. 110+00		
FED. ROAD DIST. NO. 1 ILLINOIS FED. AID PROJECT				
PROJECT NO.: M-8003 (707)				

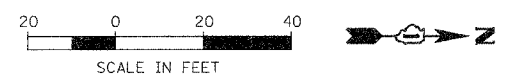

PLAN	SUBMITTED	DATE
	NOTED	
	BY	
	DATE	
	BY	
	DATE	
	BY	
	DATE	

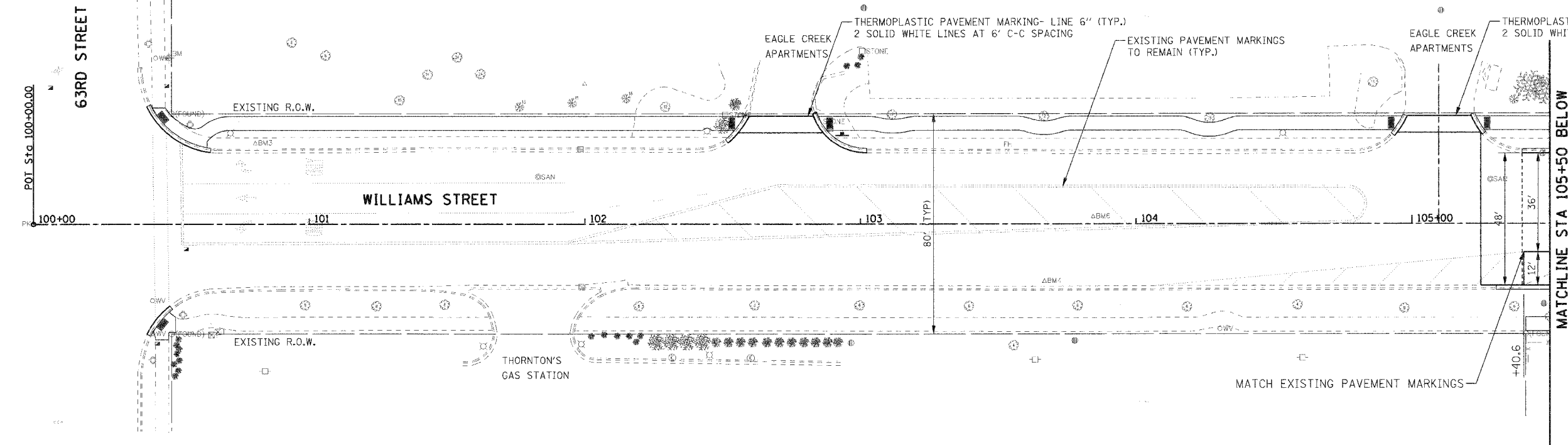

PROFILE	SUBMITTED	DATE
	NOTED	
	BY	
	DATE	
	BY	
	DATE	
	BY	
	DATE	

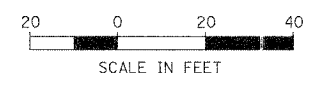
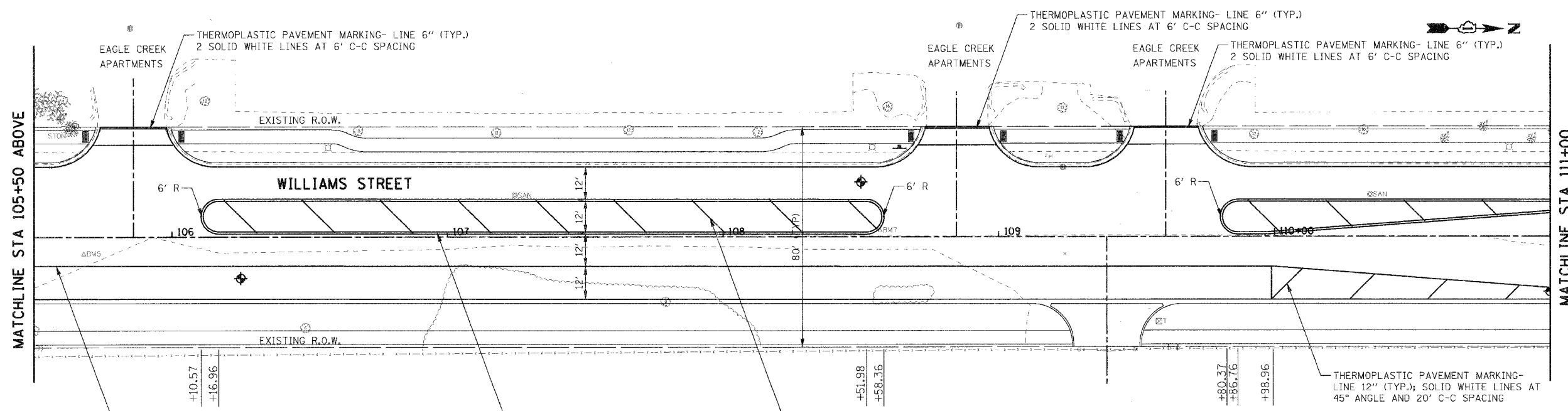

THERMOPLASTIC PAVEMENT MARKING- LINE 6" (TYP.); SOLID WHITE LINE

THERMOPLASTIC PAVEMENT MARKING- LINE 4" (TYP.); 2 SOLID YELLOW LINES AT 11" SPACING

THERMOPLASTIC PAVEMENT MARKING- LINE 12" (TYP.); SOLID YELLOW LINES AT 45° ANGLE AND 20' C-C SPACING

THERMOPLASTIC PAVEMENT MARKING- LINE 12" (TYP.); SOLID WHITE LINES AT 45° ANGLE AND 20' C-C SPACING

REVISIONS	
NAME	DATE

ILLINOIS DEPARTMENT OF TRANSPORTATION  
 VILLAGE OF WESTMONT  
 WILLIAMS STREET RECONSTRUCTION  
 PAVEMENT MARKING AND SIGNING PLAN  
 SHEET 1 OF 3  
 SCALE: 1:20  
 DATE: 09/21/07  
 DRAWN BY: JAL  
 CHECKED BY: JMT

PLOT DATE = #DATE#  
 FILE NAME = #FILE#  
 PLOT SCALE = #SCALE#  
 USER NAME = #USER#