

F.A.U. RTE.	SECTION	COUNTY	TOTAL SHEET SHEETS NO.
2993	05-00094-00-WR	DUPAGE	67 43
STA. 110+00		TO STA. 122+00	
FED. ROAD DIST. NO. 1 ILLINOIS FED. AID PROJECT			
PROJECT NO.: M-8003 (707)			



PLAN	SURVEYS	DATE
NO.	BY	
	CHECKED	
	DATE	
	BY	
	CHECKED	
	DATE	

MATCHLINE STA 111+00
SEE SHEET 1 OF 3

MATCHLINE STA 116+50 BELOW

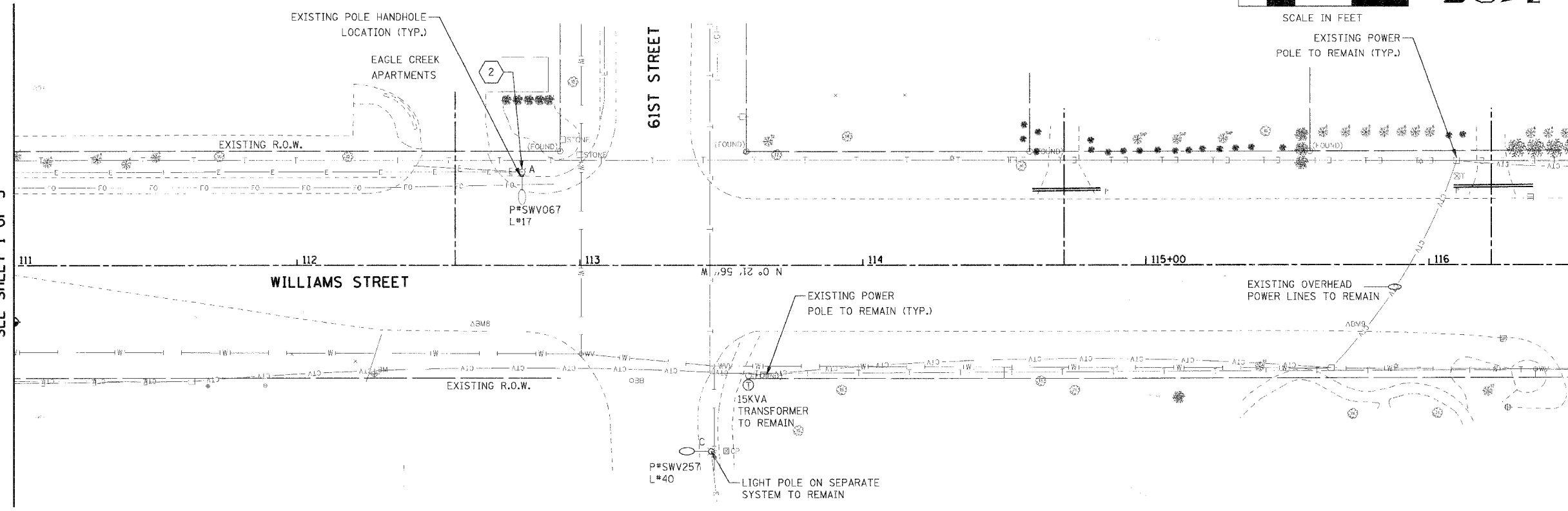

PROFILE	SURVEYS	DATE
NO.	BY	
	CHECKED	
	DATE	
	BY	
	CHECKED	
	DATE	

MATCHLINE STA 116+50 ABOVE

MATCHLINE STA 122+00
SEE SHEET 3 OF 3

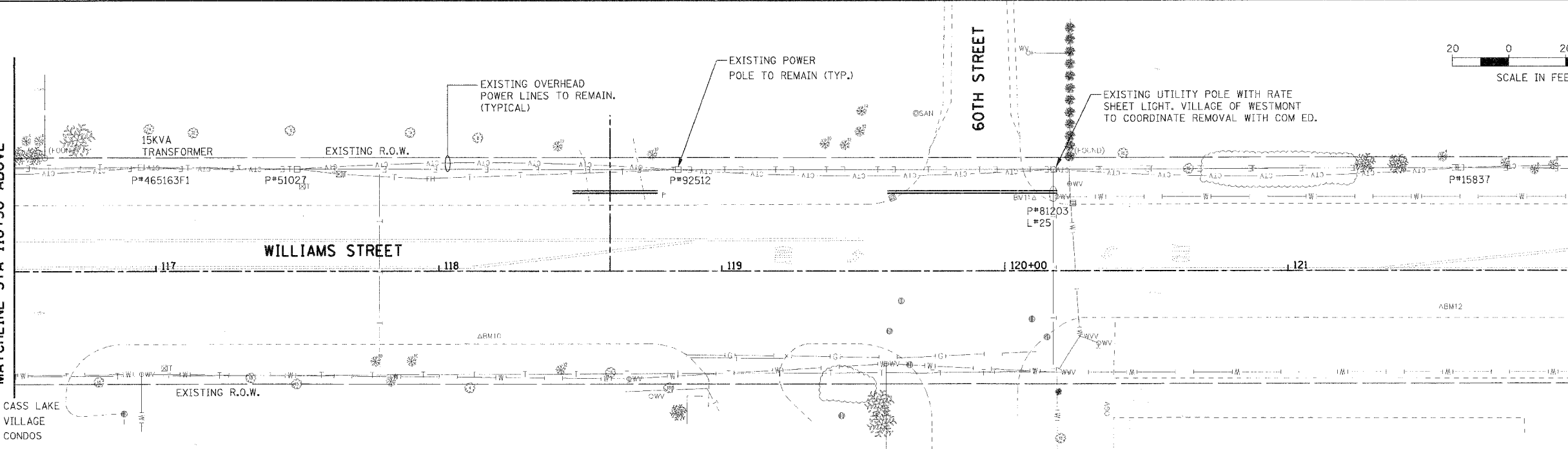

- KEY NOTES:**
- 1 EXISTING CONCRETE LIGHT POLE AND EXISTING LUMINAIRE TO BE REMOVED AND SALVAGE LIGHT FIXTURE.
 - 2 EXISTING ALUMINUM LIGHT POLE TO REMAIN. REMOVE AND SALVAGE EXISTING LUMINAIRE.

- GENERAL NOTES:**
- 1. REFER TO DRAWING E-01 FOR GENERAL NOTES, LEGEND AND ABBREVIATIONS.
 - 2. LOCATION OF EXISTING LIGHT POLES ARE APPROXIMATE. FIELD VERIFY EXACT LOCATION.

PLOT DATE = #DATE#
FILE NAME = #FILE#
PLOT SCALE = #SCALE#
USER NAME = #USER#

E-03 3 OF 12

REVISIONS		ILLINOIS DEPARTMENT OF TRANSPORTATION VILLAGE OF WESTMONT WILLIAMS STREET RECONSTRUCTION LIGHTING DEMOLITION PLAN SHEET 2 OF 3
NAME	DATE	

SCALE: 1:20
DATE: 09/21/07
DRAWN BY: FO
CHECKED BY: DEM