

F.A.U. RTE.	SECTION	COUNTY	TOTAL SHEETS	SHEET NO.
2993	05-00094-00-WR	DUPAGE	67	44
STA. 122+00		TO STA. 127+14.14		
FED. ROAD DIST. NO. 1 ILLINOIS FED. AID PROJECT				
PROJECT NO.: M-8003 (707)				



PLAN	DATE
SURVEYED	
PLOTTED	
CHECKED	
BY	
NOTE BOOK NO.	
DATE FILE NAME	

PROFILE	DATE
SURVEYED	
PLOTTED	
CHECKED	
BY	
NOTE BOOK NO.	
DATE FILE NAME	

MATCHLINE STA 122+00, SEE SHEET 2 OF 3

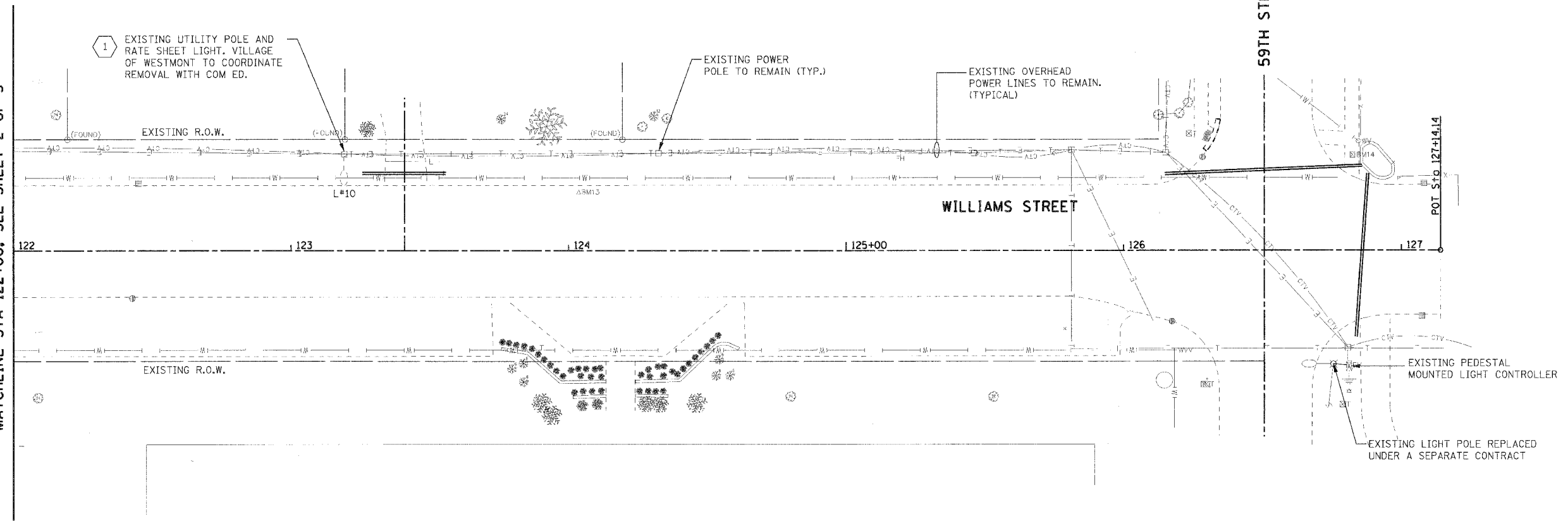

GENERAL NOTES:

- REFER TO DRAWING E-01 FOR GENERAL NOTES, LEGEND AND ABBREVIATIONS.
- EXISTING LIGHT POLE AND ASSOCIATED CIRCUIT, CABLE, FOUNDATION, FIXTURE, ETC. TO REMAIN.
- LOCATION OF EXISTING LIGHT POLES ARE APPROXIMATE. FIELD VERIFY EXACT LOCATION.

KEY NOTES:

- EXISTING PEDESTAL MOUNTED LIGHT CONTROLLER TO REMAIN.
- EXISTING OVERHEAD POWER LINES AND POWER POLES TO REMAIN. DISCONNECT AND REMOVE EXISTING LIGHTING LUMINAIRE AND ASSOCIATED MAST ARM AND CIRCUIT. TURN OVER ALL REMOVED ITEMS TO THE VILLAGE.

PLOT DATE = #DATE#
 FILE NAME = #FILE#
 PLOT SCALE = #SCALE#
 USER NAME = #USER#

E-04 4 OF 12

REVISIONS		ILLINOIS DEPARTMENT OF TRANSPORTATION VILLAGE OF WESTMONT WILLIAMS STREET RECONSTRUCTION LIGHTING DEMOLITION PLAN SHEET 3 OF 3
NAME	DATE	

SCALE: 1:20
 DATE: 09/21/07
 DRAWN BY: FO
 CHECKED BY: DEM